

GENERAL HVAC NOTES

1. CONCEALED DUCTWORK TO BE GALVANIZED SHEET METAL LINED WITH FIBROUS GLASS DUCT LINER, MIN R-6, INSTALLED PER SMACNA STANDARDS.
2. EXPOSED DUCTWORK TO BE GALVANIZED SHEET METAL LINED WITH FIBROUS GLASS DUCT LINER, MIN R-6, INSTALLED PER SMACNA STANDARDS.
3. ROUND FLEXIBLE DUCT TO BE UL-181 CLASS 1, AIR DUCT MATERIALS.
4. DUCT SIZES SHOWN ARE CLEAR INSIDE DIMENSIONS.
5. IN ALL SYSTEMS OVER 2000 CFM AND LESS THAN 15,000 CFM, SMOKE TESTING SHALL BE REQUIRED FOR ALL DUCTWORK. IN ALL SYSTEMS LESS THAN 2000 CFM, SMOKE TESTING SHALL BE REQUIRED FOR ALL DUCTWORK. SMOKE TESTING SHALL BE PERFORMED DOWNSTREAM OF THE AIR HANDLING UNIT AND ALL FILTERS TO AUTOMATICALLY STOP THE FAN.
6. PROVIDE UL LISTED 125° F. FRESH AIR INTAKE AIR OF EACH SYSTEM UNDER 2000 CFM TO SHUT DOWN THE FAN IN THE EVENT OF FIRE.
7. PROVIDE UL RATED FIRE DAMPERS WHERE REQUIRED AT ALL DUCT PENETRATIONS OF FIRE-RATED ASSEMBLIES AND WHERE REQUIRED BY CODE, INCLUDING OUTSIDE AIR INTAKES AND EXHAUST FANS.
8. CONDENSATE DRAINS TO BE PVC PIPE RUN TO FLOWERS P-TRAP WITHIN FIVE FEET OF AIR HANDLING UNITS.
9. ALL AIR HANDLING SYSTEMS TO BE BALANCED TO ASSURE PROPER AIR FLOWS PER PLANS.
10. ALL THERMOSTATS TO BE AUTOMATIC CHANGED/OVER WITH HEAT SWITCH.
11. EXHAUST FAN SHALL BE CONTROLLED BY A SWITCH ON THE WALL IN THE SAME LOCATION AS LIGHT SWITCH(S). PROVIDE BACK DRAFT DAMPER, PROVIDE AND INSTALL WATER PROOF GULLIE VENT IN PROPER ROOF LOCATION FOR PUMPING FIXTURE EXHAUST.
12. LOCATION FOR PUMPING FIXTURE EXHAUST.
13. ALL SUPPLY AIR VENTS SHALL BE EQUIPPED WITH AIR CONTROL DAMPERS AT THE REGISTER.
14. LOCATE OUTDOOR UNITS AS SHOWN ON ARCHITECTURAL DRAWINGS.
15. REFRIGERANT LINES SHALL BE SIZED BY UNIT MANUFACTURER AND INSTALLED ACCORDING TO MANUFACTURER'S INSTRUCTIONS.
16. FRESH AIR SHALL BE SUPPLIED TO EACH AIR HANDLER THROUGH EXTERIOR WALL DUCT SUPPLIED WITH A CONTROL DAMPER.
17. ALL ELECTRICAL, MECHANICAL, AND PUMPING PENETRATING FIRE WALLS SHALL BE FIRE CALKED. (PENETRATIONS THROUGH RATED CONSTRUCTION SHALL BE SEALED WITH A MATERIAL CAPABLE OF PREVENTING THE PASSAGE OF FLAMES AND HOT GASES WHEN TESTED IN ACCORDANCE WITH ASTM E9-14).
18. ALL MECHANICAL SYMBOLS ARE DRAWN DISGRAMMATICALLY. CONTRACTOR TO VERIFY WITH OWNER LOCATIONS OF VENTS, DAMPERS, REGISTERS, ETC.
19. FLEXIBLE DUCTWORK LENGTH NOT TO EXCEED 12'-0".
20. REFER TO REFLECTED CEILING PLAN FOR FINAL GRILLE AND DIFFUSER LOCATION AND COORDINATE AS REQUIRED.
21. FINAL LOCATION OF TEMPERATURE CONTROLS TO BE COORDINATED WITH OWNER AT JOB SITE.
22. PROVIDE AND INSTALL SMOKE DETECTORS AS APPROVED BY LOCAL A.U.S. PLACE NEAR R/A AND S/A OPENINGS OF A/U AND PROVIDE WITH ACCESS PANEL, WIRING BY ELECTRICAL CONTRACTOR.
23. FRESH AIR INTAKES ARE REQUIRED TO HAVE WINDWARD OR GRAVITY DAMPERS TO SHUT OFF WHEN SYSTEM IS NOT RUNNING.
24. PROVIDE BRID SCREENS AT ALL EXTERIOR MECHANICAL PENETRATIONS.
25. CONDENSATE WALL MOUNTED THERMOSTAT LOCATIONS WITH ALL OWNER FURNISHED ITEMS EITHER WALL MOUNTED OR FLOOR MOUNTED AGAINST PARTITIONS. REFER TO ARCHITECTURAL DRAWINGS.
26. SEE ROOF PLAN FOR ALL ROOF PENETRATIONS.
27. PROVIDE MIN 18 GA GALVANIZED SHEET METAL TO BLANK-OFF GABLE VENTS WHERE IN TAKE/EXHAUST DUCTS OCCUR.

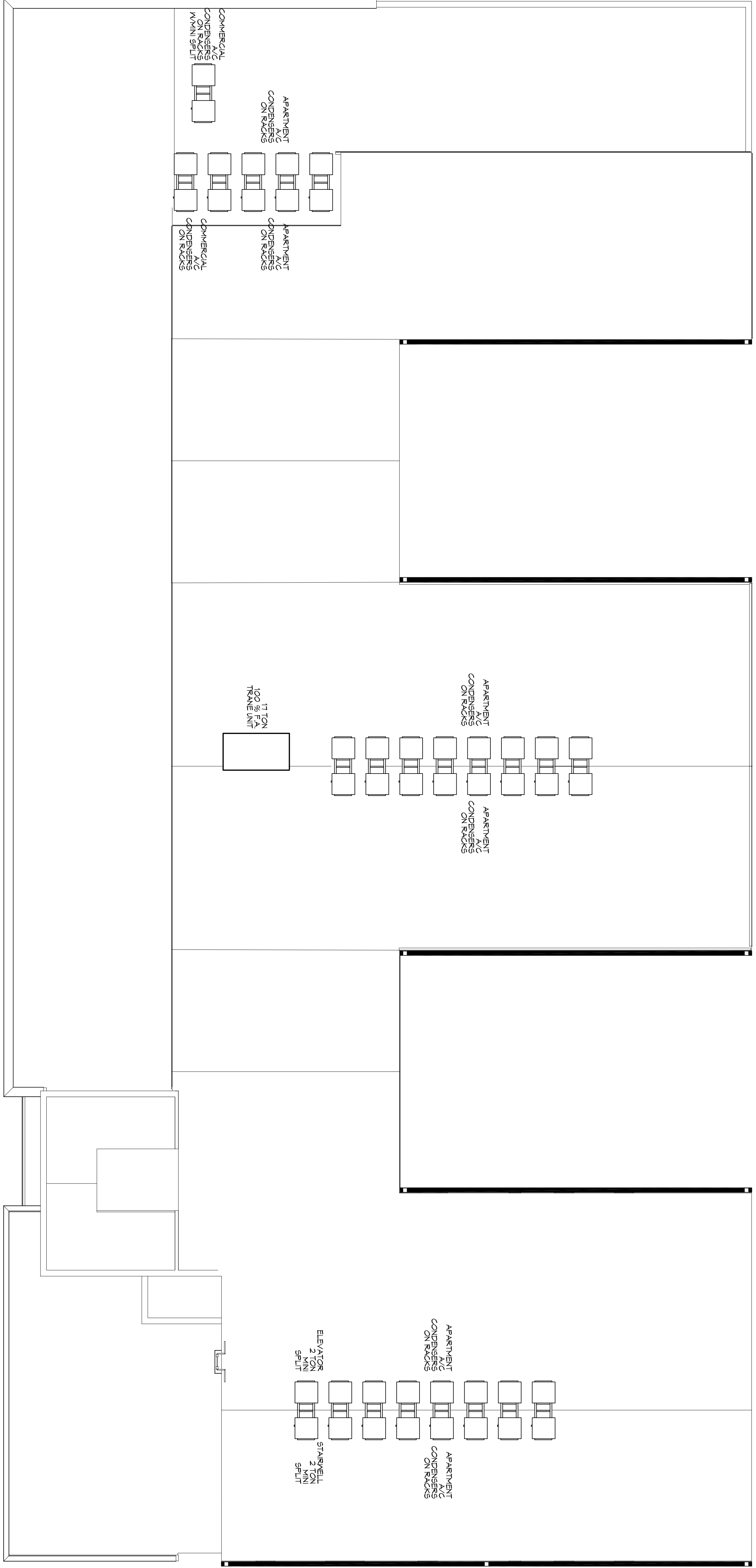

MECHANICAL ROOF PLAN

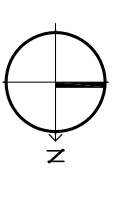

SCALE



In Joint Venture With:

A/C UNIT SCHEDULE		COMMENTS
NO. TOTAL	CFM	0.4 HEAT
57	125	1.250
57	125	1.250
24	50	50
2	50	50

STARWELL #1 15 AND ELEVATOR EQUIPMENT ROOM SHALL BE METABISHI INDOOR UNITS. MODEL #MS6562AKN. OUTDOOR UNITS MODEL #MZ62AKN.

TRANE, 11 TON 100% FRESH AIR UNIT.

HORIZON (B/G) PACKAGED CABE MOUNTED MULTI-FUNCTION HEATING, COOLING AND VENTILATION INT. MODEL #KAG5210AS-D10000-000B0000

DAMMON
ENGINEERING, INC.

Architects & Engineers

Chief Engineer: Brian Mistich, PE

534 Old Spanish Trail
Suite 1, LA 70058

www.dammonengineering.com
info@dammonengineering.com
PH: 985.649.5832
F: 985.641.5950

Permit Documents

MECHANICAL ROOF PLAN

7/09/2015

M107

©2014 STUDIOVA

1581 MAGAZINE STREET
New Orleans, Louisiana 70130

architecture + planning + interiors

1511 Tchoupitoulas Street
New Orleans, LA 70130
504.593.9074 tel
www.studiova.com

Drawn By:
Auditor:
Sheet:
Comments:

Revisions:
Issue Purpose:
Date: