

TYP. NO. 8 AGGREGATE IN OPENINGS

CONCRETE PAVERS MIN. 3 1/8 IN. (80 MM) THICK

CURB/EDGE RESTRAINT WITH CUT-OUTS FOR OVERFLOW DRAINAGE (CURB SHOWN)

BEDDING COURSE 1 1/2 TO 2 IN. (40 TO 50 MM) THICK (TYP. NO. 8 AGGREGATE)

4 IN. (100 MM) THICK NO. 57 STONE OPEN-GRADED BASE

GEOTEXTILE ON SIDE AND TOP OF SUBBASE

MIN. 6 IN. (150 MM) THICK NO. 2 STONE SUBBASE

OPTIONAL GEOTEXTILE ON BOTTOM

SOIL SUBGRADE

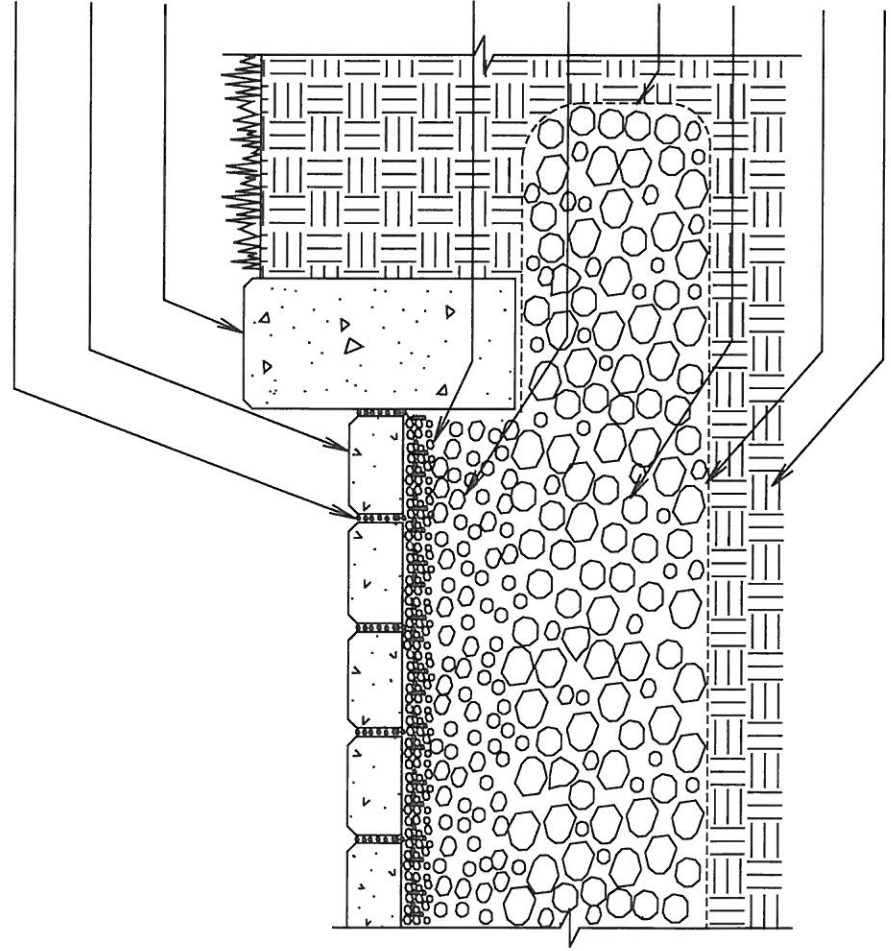

- NOTES:
- 2 3/8 IN. (60 MM) THICK PAVERS MAY BE USED IN PEDESTRIAN APPLICATIONS.
  - NO. 2 STONE SUBBASE THICKNESS VARIES WITH DESIGN. CONSULT ICPI PERMEABLE INTERLOCKING CONCRETE PAVEMENT MANUAL.

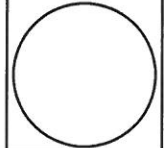

**PERMEABLE PAVEMENT WITH FULL EXFILTRATION TO SOIL SUBGRADE**

DRAWING NO.	ICPI-68
SCALE	NO SCALE