

**DAMMON**  
ENGINEERING, INC.

CHIEF ENGINEER  
DAMON, F.E.  
CHIEF ARCHITECT  
ROBERT WILTSE

1095 FLORIDA AVENUE  
SILVER LAKE, FL 34489  
OFFICE: 954-649-5852  
FAX: 954-641-5930

WWW.DAMMONENGINEERING.COM  
EMAIL: DAMMON@BLSOLUTIONS.NET

ARCHITECTURE  
ENGINEERING  
STUDIES  
PLANNING  
INVESTIGATION  
EXPERT WITNESS

NEW  
APARTMENT  
COMPLEX

CROSSWINDS  
APARTMENTS  
HAMMOND, LA

BIDGS. 1, 2, 5 & 6  
FLOORS 1 - 3  
OVERALL  
ELECTRICAL PLAN

REV: 1/1-15-10

SCALE: AS NOTED

JOB#: 08112.13

DATE: 12-16-09

SHEET

E-3

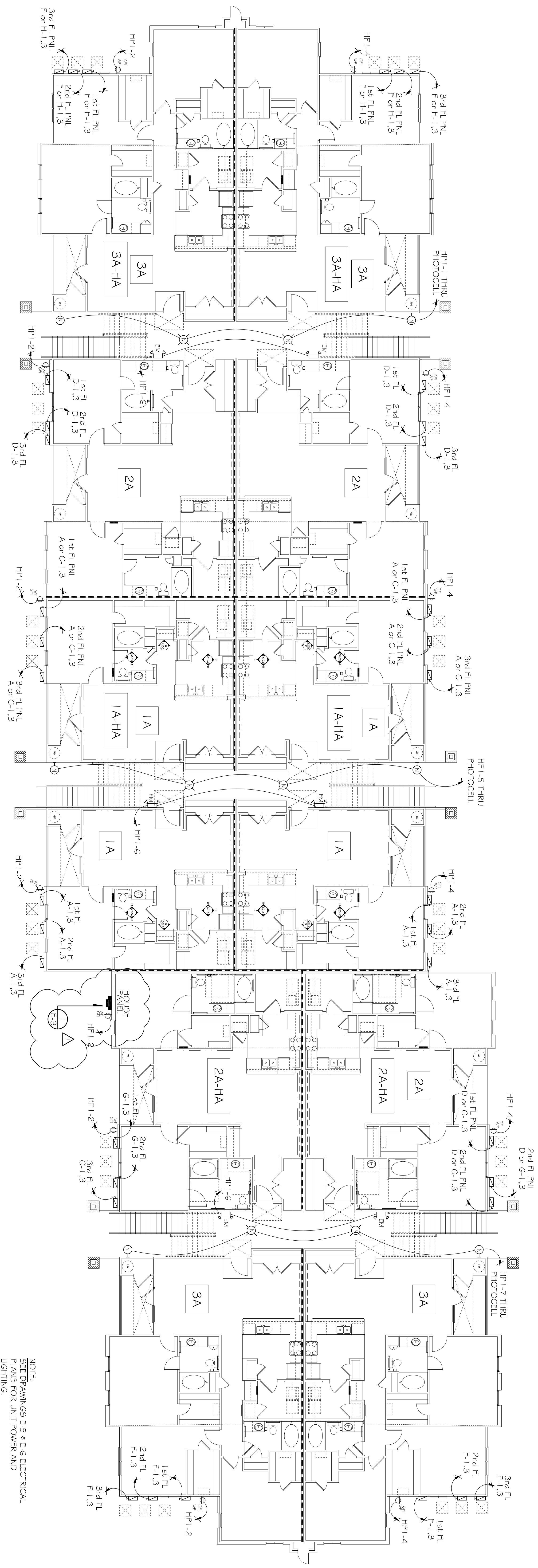

BIDGS. 1, 2, 5 & 6 1ST FLOOR  
OVERALL ELECTRICAL PLAN  
SCALE: 1/8"=1'-0"

NOTE:  
SEE DRAWINGS E-5 & E-6 ELECTRICAL  
PLANS FOR UNIT POWER AND  
LIGHTING.

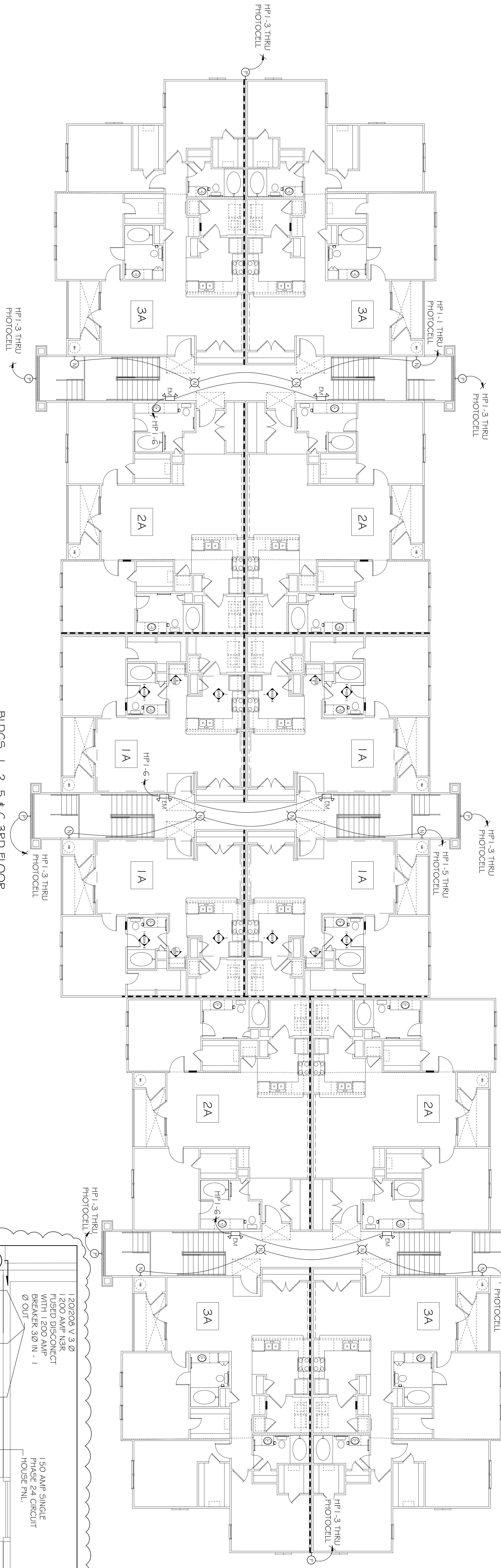

BIDGS. 1, 2, 5 & 6 3RD FLOOR  
OVERALL ELECTRICAL PLAN  
SCALE: 1/8"=1'-0"

NOTE: 2ND FLOOR IS SIMILAR TO 3RD FLOOR.

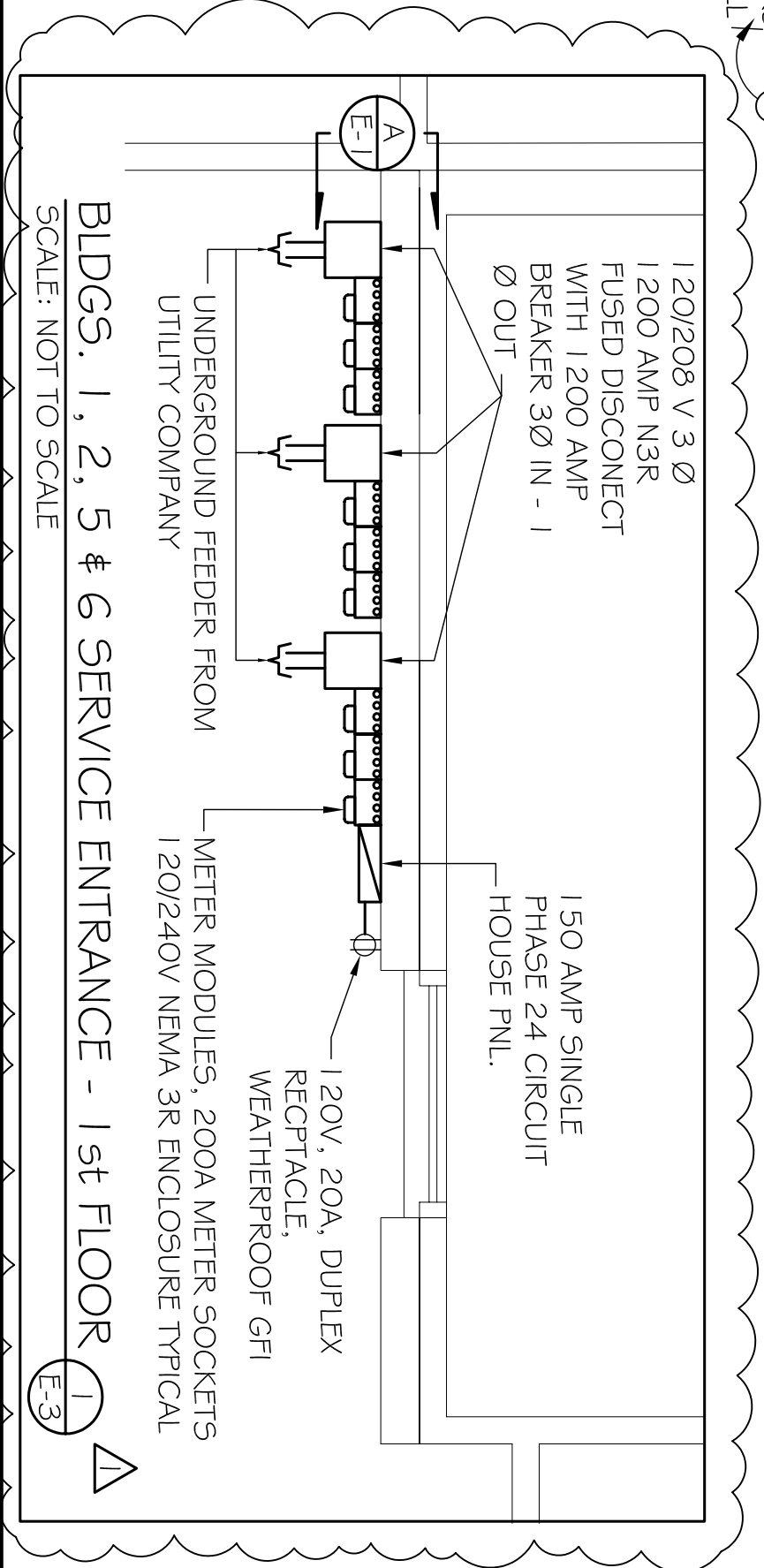

OF