

DAMMON
ENGINEERING, INC.

CHIEF ENGINEER
ENNETT
DAMMON, P.E.
CHIEF ARCHITECT
ROBERT
WILTSE

1095 FLORIDA AVENUE
SLIDELL, LA. 70458
OFFICE: 985-649-5832
FAX: 985-641-5950

WEBSITE:
WWW.DAMMONENGINEERING.COM
EMAIL:
DAMMONENR@BELL.SOUTH.NET

ARCHITECTURE
ENGINEERING
STUDIOS
PLANNING
INVESTIGATION
EXPERT WITNESS

NEW
APARTMENT
COMPLEX

CROSSWINDS
APARTMENTS
HAMMOND, LA

BUDGS. 1, 2, 5 & 6
FLOORS 1 - 3
OVERALL
ELECTRICAL PLAN

REV:

SCALE: AS NOTED

JOB#: 08112.13

DATE: 12-16-09

SHEET

E-3

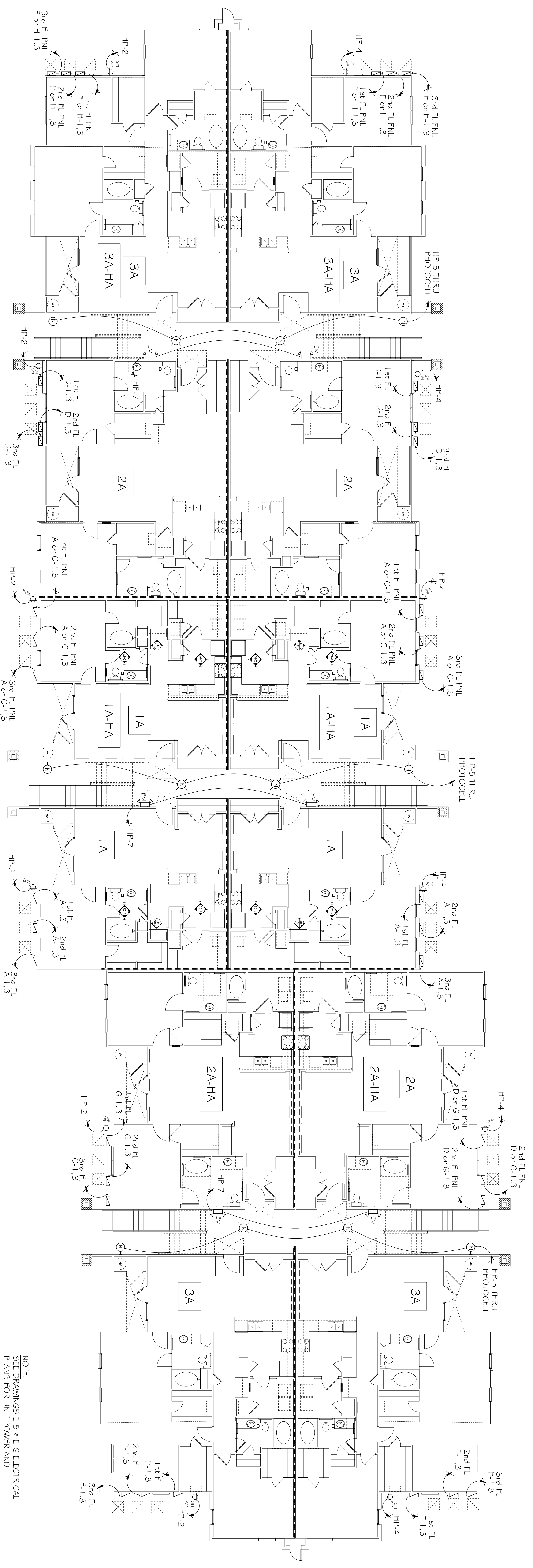

NOTE:
SEE DRAWINGS E-5 & E-6 ELECTRICAL
PLANS FOR UNIT POWER AND
LIGHTING.

BUDGS. 1, 2, 5 & 6 1ST FLOOR
OVERALL ELECTRICAL PLAN
SCALE: 1/8" = 1'-0"

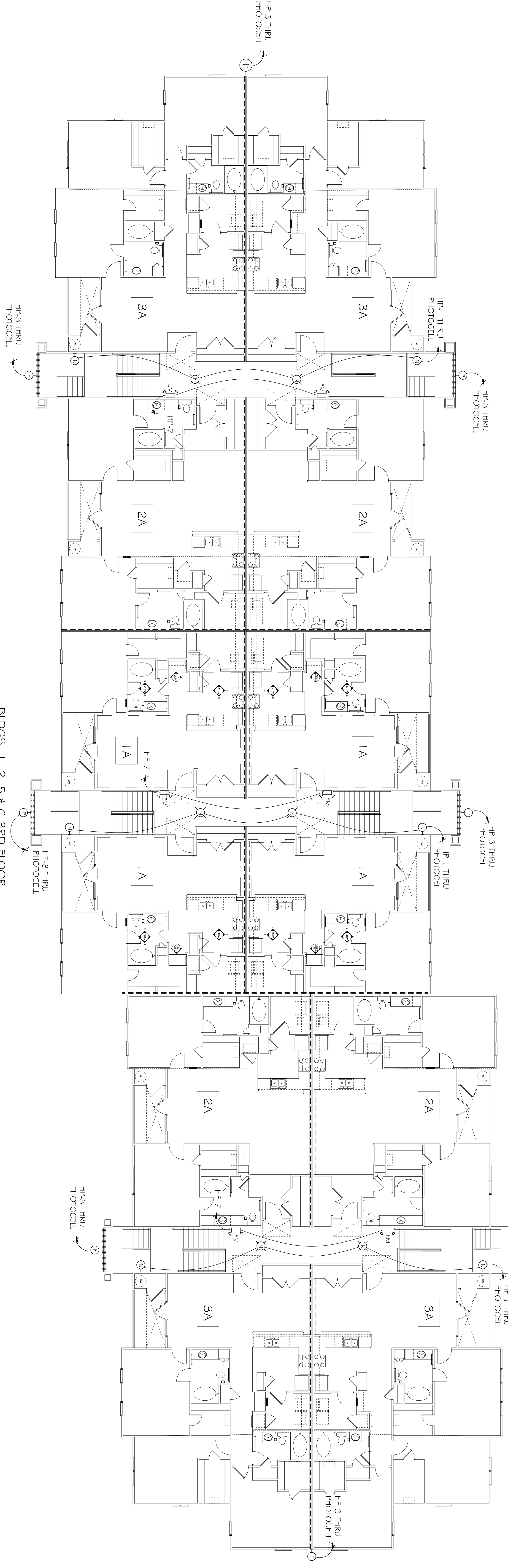

BUDGS. 1, 2, 5 & 6 3RD FLOOR
OVERALL ELECTRICAL PLAN
SCALE: 1/8" = 1'-0"
NOTE: 2ND FLOOR IS SIMILAR TO 3RD FLOOR.