

8" THICK CONCRETE DUMPMSTER PAD WITH 6" WOODEN FENCE ENCLOSURE WITH GATES

**LEGEND**

- PROPERTY LINE
- SETBACK
- NEW BUILDING OUTLINE
- NEW 6" WOODEN FENCE
- HANDICAP PARKING
- HANDICAP PARKING SIGN
- TRAFFIC FLOW DIRECTION
- NEW CATCH BASIN

**SITE PLAN**

SCALE: 1" = 20'-0"

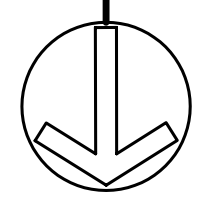

**SITE LIGHTING**

EXTERIOR LIGHTING SHALL BE SHADOED OR UNIMPAIREDLY DIRECTED IN SUCH A MANNER SO THAT NO DIRECT LIGHTING OR GLARE BE CAST BEYOND THE PROPERTY LINE. THE INTENSITY OF SUCH LIGHTING SHALL NOT EXCEED ONE FOOT CANDLE AS MEASURED AT THE ADJUTING PROPERTY LINE.

**HANDICAP SYMBOL DETAIL**

NOTE: SIGNAGE SHALL COMPLY WITH SIGNAGE GUIDELINES

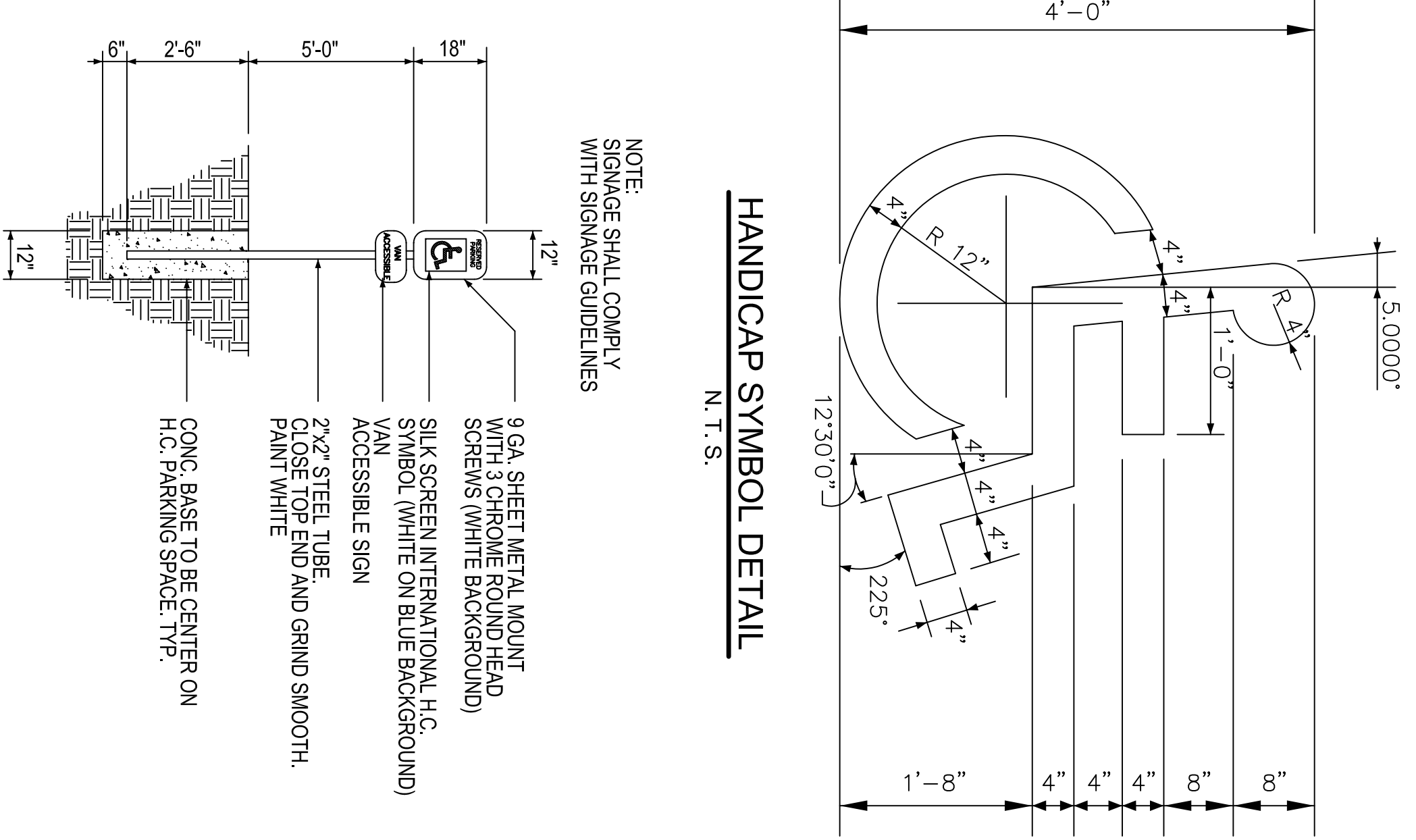

**HANDICAP PARKING SIGN**

N.T.S.

**OCCUPANT LOAD** (FROM SHEETS A-1(A)-2)

1st FLOOR OCCUPANT LOAD	160 NON-FIXED SEATING	2,210 SQ.FT. @ 15 SQ.FT. / OCCUPANT = 147
	100 SQ.FT. KITCHEN @ 100 SQ.FT. / OCCUPANT = 1	
TOTAL 1st FLOOR OCCUPANT LOAD = 308		
2nd FLOOR:	3,000 SQ.FT. @ 15 SQ.FT. / OCCUPANT = 200	
TOTAL 2nd FLOOR OCCUPANT LOAD = 200		
TOTAL OCCUPANT LOAD FOR ALL FLOORS = 508		

**PARKING REQUIREMENTS:**

508 OCCUPANTS @ 1 PARKING SPACES / 4 OCCUPANTS = 127 SPACES  
 127 PARKING SPACES @ 1 HCP SPACE / 25 NORMAL SPACES = 5 HCP SPACES  
 TOTAL PARKING SPACES REQUIRED = 127 SPACES (6 HCP)  
 PARKING PROVIDED:  
 122 REGULAR SPACES AND 5 HCP SPACES  
 TOTAL PARKING PROVIDED: 127

NOTE: ALL PARKING AREAS SHALL BE 6" THICK REINFORCED CONCRETE PAVEMENT

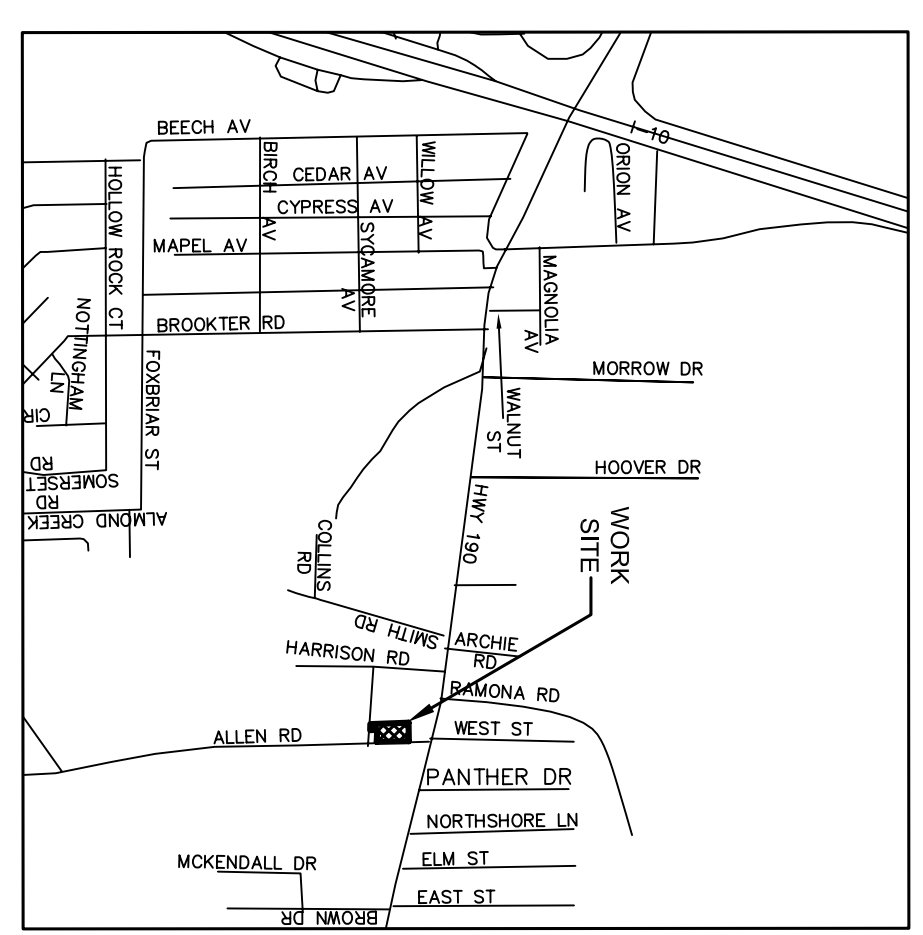

**VICINITY MAP**

N.T.S.

**SITE PLAN**  
 EUGENE WELLINGTON  
 ALLEN ROAD  
 SLIDELL, LOUISIANA

EL-BETHEL PENTECOSTAL CHURCH  
**DAMMON ENGINEERING, INC.**  
 1095 FLORIDA AVENUE 985-649-5832 SLIDELL, LA. 70458  
 DAMMONENGINEERING.COM

SCALE: AS NOTED

FILE:

JOB NO. 1819

DATE: 3-29-07

SHEET 3

OF 22  
 C-2