

DAMMON ENGINEERING, INC.

CHIEF ENGINEER
EMMETT DAMMON, P.E.
CHIEF ARCHITECT
ROBERT WILTSE

1095 FLORIDA AVENUE
SLIDELL, LA, 70436
OFFICE: 985-649-5332
FAX: 985-641-5950

WEBSITE: WWW.DAMMONENGINEERING.COM
EMAIL: DAMMONENG@BELL.SOUTH.NET

ARCHITECTURE
ENGINEERING
STUDIES
PLANNING
INVESTIGATION
EXPERT WITNESS

**EL-BETHEL
PENTECOSTAL
CHURCH**

REV. EUGENE
WELLINGTON
ALLEN ROAD
SLIDELL, LA

**FLOOR
PLAN**

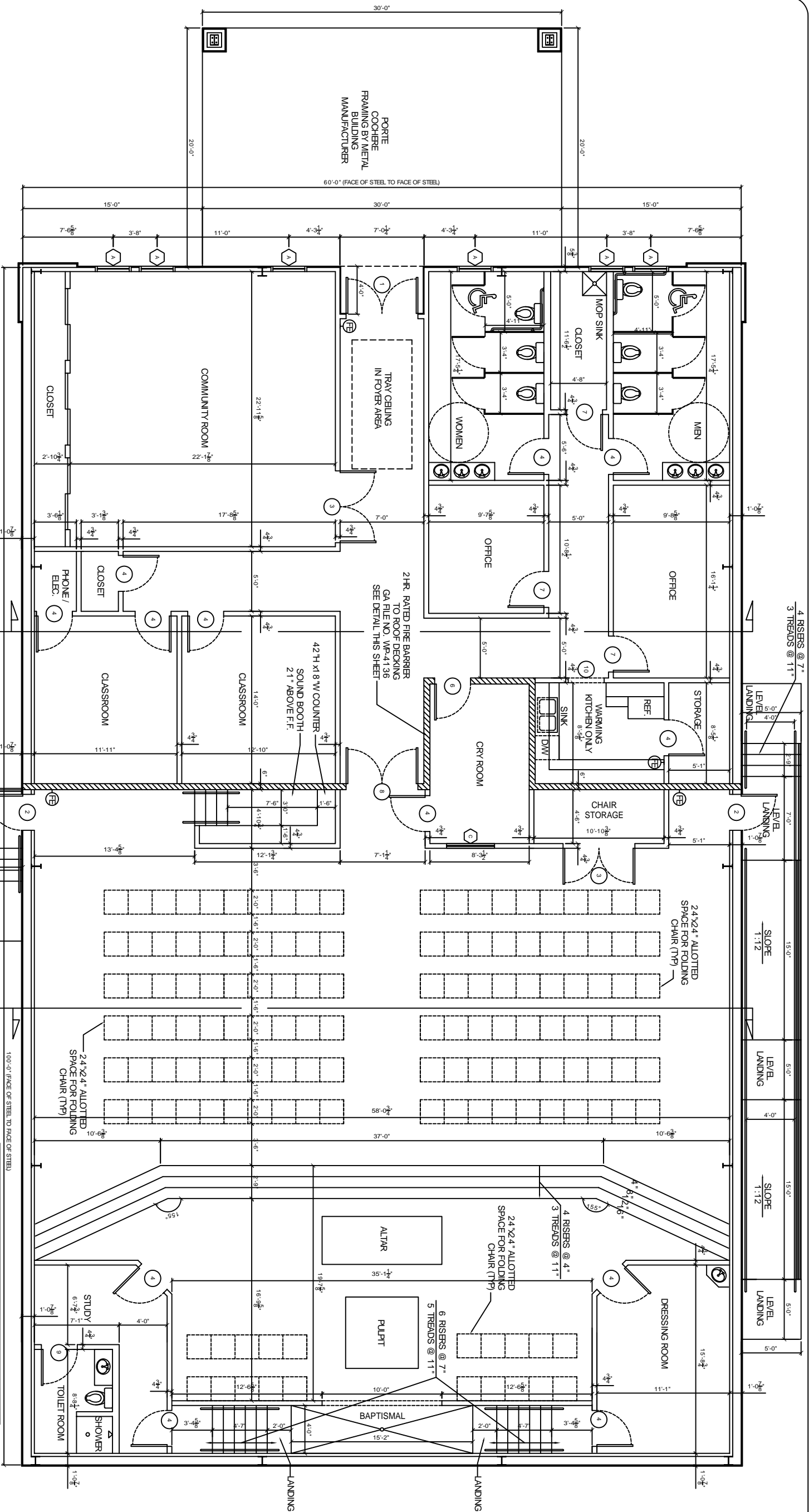

TOTAL s.f.: 6,000

FLOOR PLAN
SCALE 1/4" = 1'-0"

GA FILE NO. WP 4136 GENERIC 2 HOUR FIRE 40 TO 44 STC SOUND

BASE LAYER 5/8" TYPE X GYPSUM WALLBOARD OR VENEER BASE APPLIED PARALLEL OR AT RIGHT ANGLES TO EACH SIDE OF 2 X 4 WOOD STUDS 16" O.C. WITH 1 1/4" TYPE W DRYWALL SCREWS 12" O.C. FACE LAYER 5/8" TYPE X GYPSUM WALLBOARD OR VENEER BASE APPLIED PARALLEL OR AT RIGHT ANGLES TO EACH SIDE WITH 1 7/8" TYPE W DRYWALL SCREWS 12" O.C. AND OFFSET 6" FROM SCREWS IN BASE LAYER. JOINTS STAGGERED 16" EACH LAYER AND SIDE (LOAD BEARING)



THICKNESS: 6 1/8"
APPROX WEIGHT: 12 PSF
FIRE TEST: SWM 01-5920-614, 12-5-94
SEE WP 4135
SOUND TEST: (MGC 2363, 4-1-70)

LEGEND

- NEW FIRE BARRIER, GA FILE NO. WP 3514 SEE DETAIL THIS SHEET
- NEW WOOD STUD WALL 2x4 OR 2x6 STUDS @ 16" O.C. W/ ONE LAYER 5/8" GYP. BOARD ON EACH SIDE SEE PLAN
- NEW FIRE EXTINGUISHER IN ACCORDANCE W/ NFPA 10

OCCUPANT LOAD CALCULATIONS

NAME	FLOOR	BASE	WALLS	Ceilings	REMARKS
OFFICES		CARPET			
COMMUNITY ROOM		CONCRETE			
CLASSROOMS		CERAMIC TILE			
DRIVING AREA		CERAMIC TILE			
TOILET		RUBBER WALL BASE			
STUDY		WOOD RAIS			
SHOWER		FRP PANEL			
BAPTISMAL		5/8" GYP. BOARD			
TOILET ROOM		2x4 ACOUSTIC TILE			
CLASSROOM		GYPSUM BOARD			

PROVIDE MOISTURE RESISTANT GYP. BO. IN ALL DAMP AREAS.
OWNER TO SELECT STYLE, COLOR, AND BRAND.

OCCUPANCY CLASSIFICATION PER IBC 2006 (SECTION 304.1)
MIXED OCCUPANCY: GROUP A-3 (SANCTUARY-CLASSROOMS-COMMON AREAS), GROUP B (OFFICES)
OCCUPANT LOADS ARE CALCULATED PER VALUES GIVEN BY NFPA 101, 2006, TABLE 7.3.1.2

TOTAL BUILDING FOOTPRINT = 6,000 s.f.
SANCTUARY: 2,809 NET S.F. / 15 S.F. = 188 OCCUPANTS
COMMUNITY ROOM + CRY ROOM = 885 NET S.F. / 15 S.F. = 59 OCCUPANTS
CLASSROOMS = 350 S.F. / 15 S.F. = 23 OCCUPANTS
KITCHEN = 108 S.F. / 100 S.F. = 1 OCCUPANT
OFFICES = 278 S.F. / 100 S.F. = 3 OCCUPANTS
TOTAL BUILDING OCCUPANT LOAD = 274

REV:

SCALE: AS NOTED

JOB#: 1819A

DATE: 11-19-08

SHEET 10

A-1

OF 20