

DAMMON ENGINEERING, INC.

CHIEF ENGINEER
EMMETT DAMMON, P.E.
CHIEF ARCHITECT
ROBERT WILTSE

1095 FLORIDA AVENUE
SUDELL, LA. 70458
OFFICE: 985-649-5832
FAX: 985-641-5950

WEBSITE
WWW.DAMMONENGINEERING.COM

EMAIL
DAMMONENG@BLSOUTH.NET

ARCHITECTURE
ENGINEERING
STUDIES
PLANNING
INVESTIGATION
EXPERT WITNESS

**NEW
CHURCH**

TABERNACLE
BAPTIST CHURCH
2445 FOURTH AVE.
SUDELL, LA

**SITE
PLAN**

| | |
|--------|------------|
| REV: | |
| SCALE: | AS NOTED |
| JOB#: | 1978 |
| DATE: | 8-27-08 |
| SHEET | |
| OF | C-2 |

INTERNATIONAL BUILDING CODE 2006 REQUIREMENTS

OCCUPANCY CLASSIFICATION
ASSEMBLY (A-3) 7,364 s.f. (SEC. 303.1)
BUSINESS (B) 2,380 s.f. (SEC. 304.1)
OCCUPANT LOAD: (A) 1004.4 (1)
(A-3) 1004.7 (7) FETTER SEATING = 229
(B) 1004.1 (1) UNCONCENTRATED 15 s.f./OCCUPANT = 159
TOTAL LOAD = 412

EXIT ACCESS REQUIREMENTS: (SEC. 1014)
1. EXIT REQUIRED FOR LESS THAN 49 OCCUPANTS IN BUSINESS / ASSEMBLY OCCUPANCY (TBL 1015.1) (6 EXITS PROVIDED)
EXIT ACCESS TRAVEL DISTANCE = 200 UNRESTRICTED
EXIT ACCESS TRAVEL DISTANCE = 250 UNRESTRICTED
TABLE 1016.1

ALLOWABLE HEIGHT AND BLDG. AREA: (TBL 503)
A-3 = 9,500 s.f./7.2 STORY ALLOWED, THIS PROJECT 7,264 s.f., 1 STORY
B = 23,000 s.f./4 STORY, THIS PROJECT 2,380 s.f., 1 STORY
CONSTRUCTION CLASSIFICATION: (SEC. 602.2)
TYPE IIB

FIRE RESISTANCE RATING REQUIREMENTS FOR BLDG. ELEMENTS: (TBL 601)
STRUCTURAL FRAME: 0 HRS
BEARING WALLS (INTERIOR AND EXTERIOR): 0 HRS
NON-BEARING WALLS: 0 HRS
FLOOR CONSTRUCTION: 0 HRS
ROOF CONSTRUCTION: 0 HRS

FIRE RESISTANCE RATING REQUIREMENTS FOR EXTERIOR WALLS: (TBL 602)
EXTERIOR WALLS WITH $t \leq X < 30$ FIRE SEPARATION DISTANCE: 0 HRS.
MAX. AREA OF EXTERIOR WALL OPENINGS: (TBL 704)
BLDG. W/ AUTOMATIC SPRINKLER SYSTEM, MAXIMUM ALLOWABLE AREA OF UNPROTECTED OPENINGS SHALL BE THE SAME AS FOR PROTECTED OPENINGS (SECTION 704.9.1). BLDG. W/ > 20' FIRE SEPARATION DISTANCE ALLOWED UNLIMITED PROTECTED & UNPROTECTED OPENINGS. (TABLE 704.8).

FIRE ALARM SYSTEM REQUIREMENTS: (SEC. 907)
THIS BLDG. DOES REQUIRE A FIRE ALARM SYSTEM IN ACCORDANCE WITH SECTION 907.2.1

FIRE PROTECTION SYSTEM REQUIREMENTS: (SEC. 903)
THIS BLDG. DOES REQUIRE A FIRE PROTECTION SYSTEM IN ACCORDANCE WITH SECTION 903.2.1.3 GROUP A-3

CONSTRUCTION DOCUMENTS: (SEC. 1603)
THIS BLDG. SHALL BE DESIGNED IN ACCORDANCE WITH IBC SECTION 1609 AS A FULLY ENCLOSED BLDG. USING THE FOLLOWING INFORMATION:
BASIC WIND SPEED (3 SECOND GUSTS) = 130 MPH (FG 1609)
IMPROVANCE FACTOR: CATEGORY III BLDG., IE = 1.00, IS = 1.0, IW = 1.00 (TBL 1604.5)
DIRECTION OF WIND LOADS SHALL BE IN ACCORDANCE WITH IBC SEC. 1609.4
MINIMUM LIVE LOADS SHALL BE DETERMINED IN ACCORDANCE WITH TBL 1607.1
GROUND SNOW LOADS = 5 PSF (FIG. 1608.2)

BASED ON THE SURVEY OF THIS PROPERTY BY J.V. BURGESS & ASSOC., INC. REGISTERED LAND SURVEYOR NO. 4785 F.L.R.M. COMMUNITY NO. 220202, PANEL NO. 0010, SURF. C. F.L.R.M. DATE 4/21/1999. BUILDING IS NOT LOCATED IN A SPECIAL FLOOD HAZARD AREA. IT IS LOCATED IN FLOOD ZONE DE BASE FLOOD ELEVATION 51.

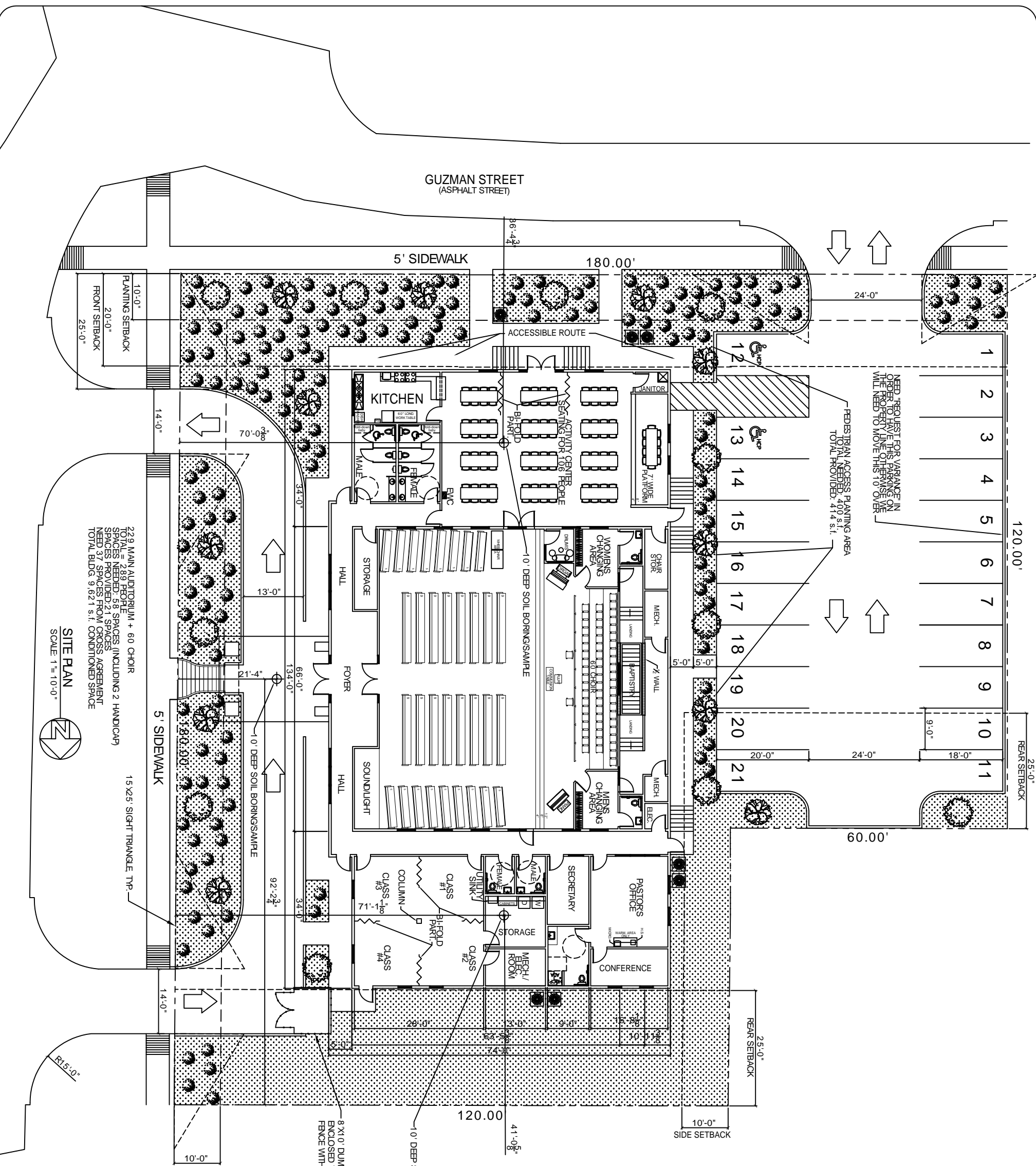

229 MAIN AUDITORIUM + 60 CHOIR
TOTAL = 289 PEOPLE
SPACES NEEDED: 388 SPACES (INCLUDING 2 HANDICAP)
SPACES PROVIDED: 21 SPACES
NEED 37 SPACES FROM CROSS AGREEMENT
TOTAL BLDG. 9,621 s.f. CONDITIONED SPACE

SITE PLAN
SCALE 1" = 10'-0"

