

**DAMMON**  
ENGINEERING, INC.  
CHIEF ENGINEER  
EMMETT  
DAMMON, P.E.  
CHIEF ARCHITECT  
ROBERT  
WILTSE

554 OLD SPANISH TRAIL  
SLIDELL, LA, 70458  
OFFICE: 985-649-5632  
FAX: 985-641-5950

WEBSITE:  
WWW.DAMMONENGINEERING.COM  
EMAIL:  
DAMMONENG@BELL.SOUTH.NET

ARCHITECTURE  
ENGINEERING  
STUDIES  
PLANNING  
INVESTIGATION  
EXPERT WITNESSES

LIVING  
THE  
WORD  
CHURCH

2528 OLD  
SPANISH  
TRAIL  
SLIDELL, LA

REV.:

SCALE: AS NOTED

JOB#: 2128

DATE: 12-22-11

SHEET

C-1

OF

- SITE LEGEND**
- - - PROPERTY LINE
  - - - SETBACK LINE
  - - - BUFFER ZONE LINE
  - - - UTILITY EASEMENT LINE
  - 6" OPAQUE BUFFER FENCE
  - HANDICAP PARKING
  - HANDICAP PARKING SIGN
  - LITTER RECEPTACLE
  - TRAFFIC ARROW

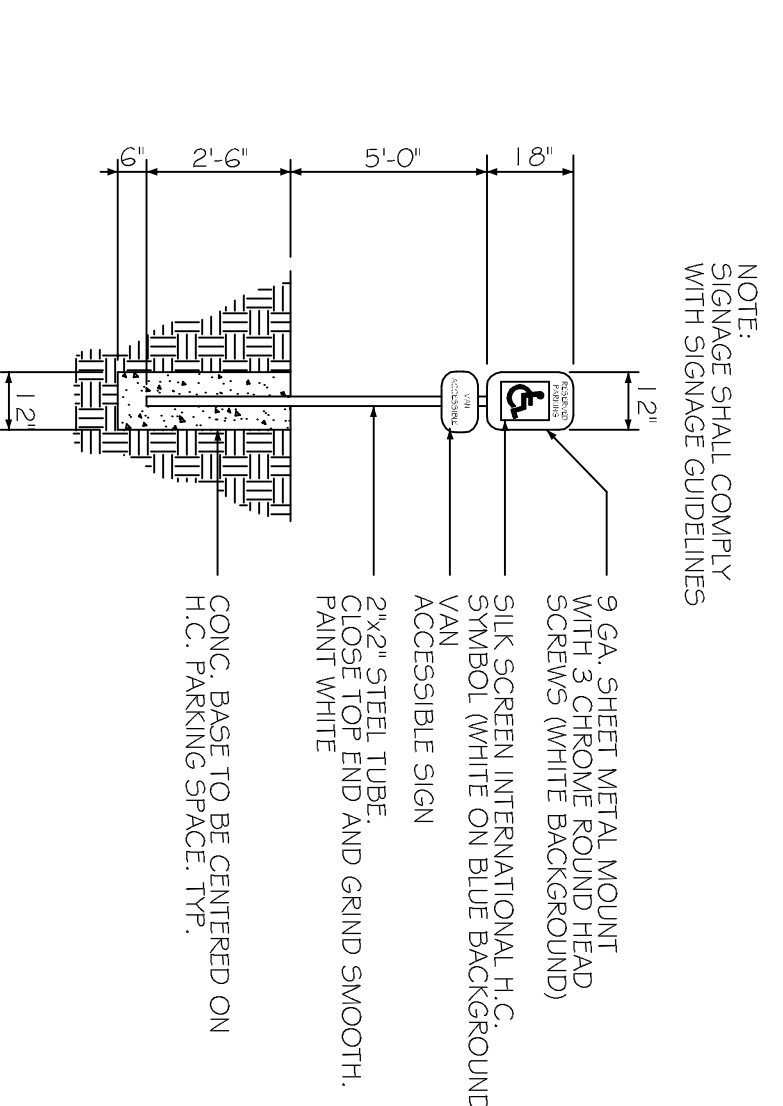
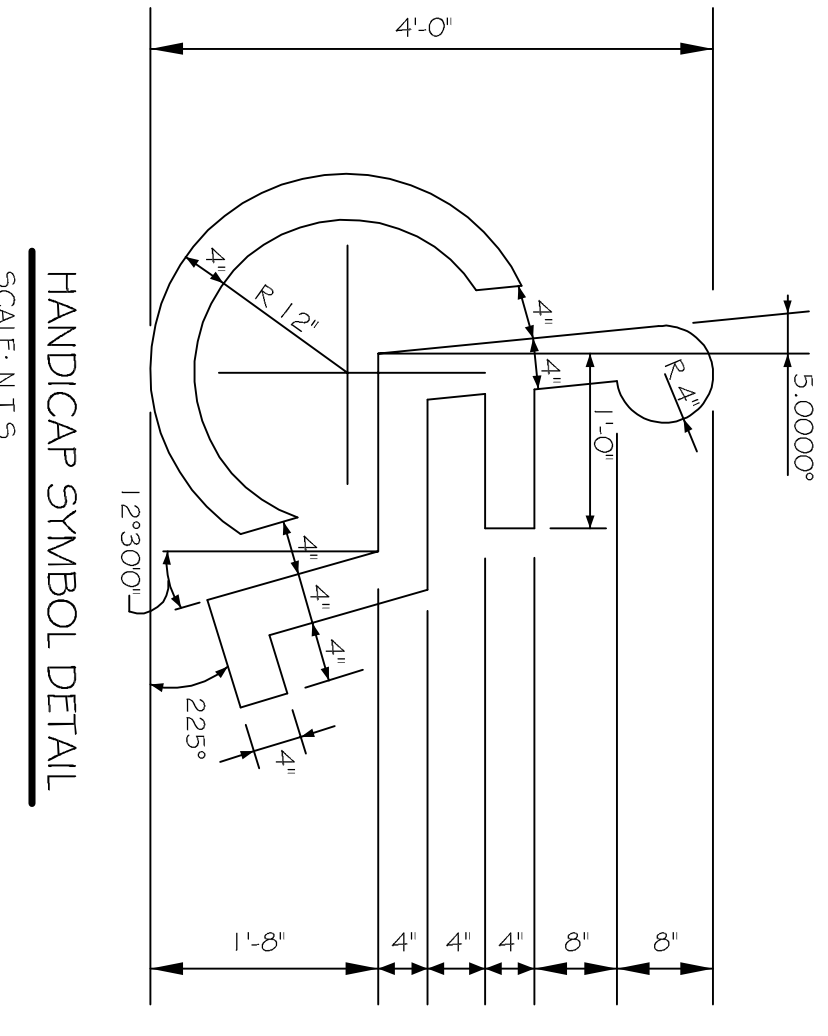

HCP RAMP NOTE:  
PROVIDE DETECTABLE WARNING ON RAMP CUT 1/4"  
RAMP SLOPE TO BE 1:12 @ ALL RAMP SLOPES INTO  
AND PAVED TO BE 1:48 @ ALL RAMP SLOPES INTO  
VEHICULAR AREAS. (MAX SLOPE 1:12)

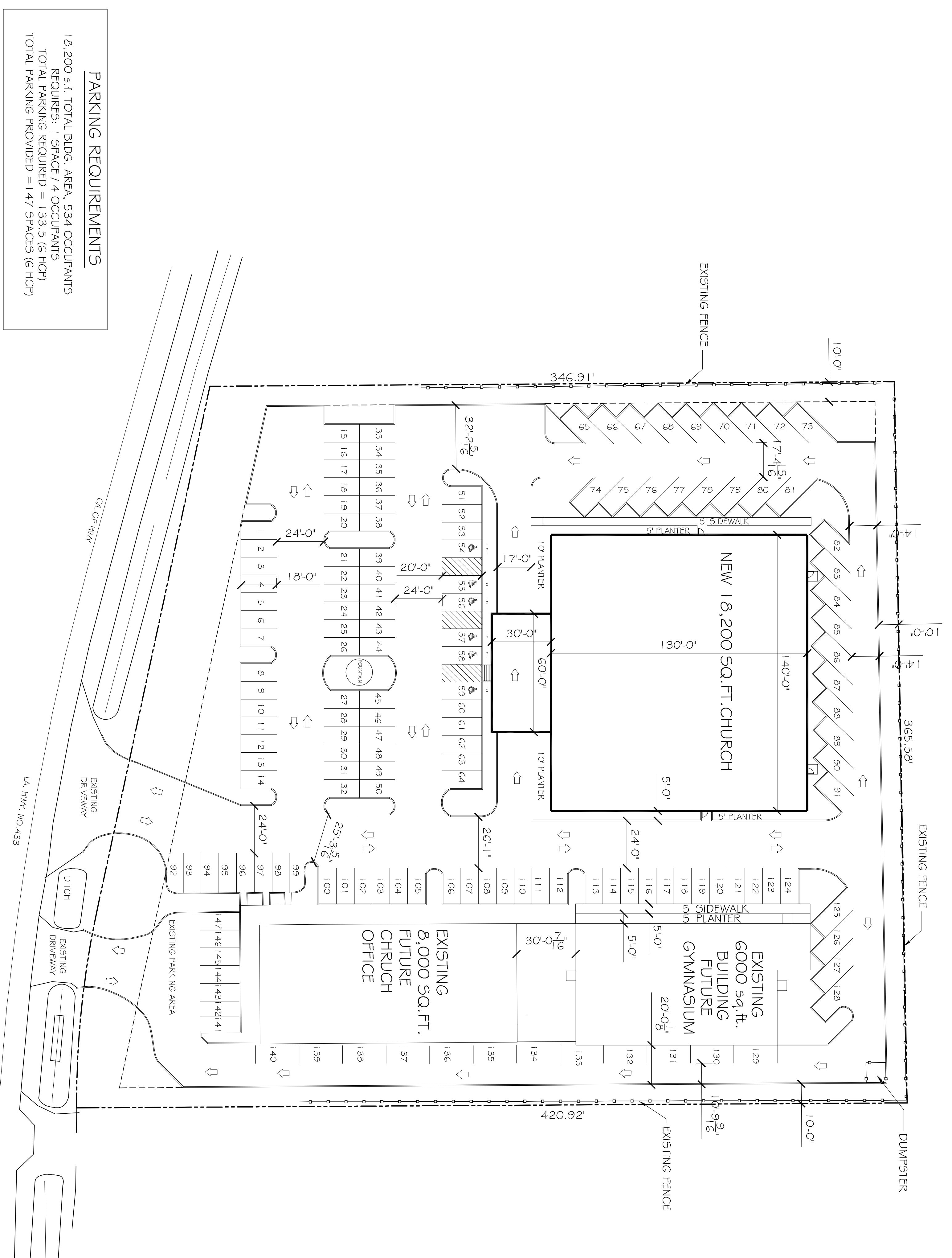

**PARKING REQUIREMENTS**  
18,200 s.f. TOTAL BLDG. AREA, 534 OCCUPANTS  
REQUIRES: 1 SPACE / 4 OCCUPANTS  
TOTAL PARKING REQUIRED = 133.5 (6 HCP)  
TOTAL PARKING PROVIDED = 147 SPACES (6 HCP)

**SITE LIGHTING**  
EXTERIOR LIGHTING SHALL BE SHADED OR INWARDLY  
DIRECTED IN SUCH A MANNER SO THAT NO DIRECT  
LIGHTING OR GLARE BE CAST BEYOND THE PROPERTY  
LINE. THE INTENSITY OF SUCH LIGHTING SHALL NOT  
EXCEED ONE FOOT CANDLE AS MEASURED AT THE  
ABUTTING PROPERTY LINE. (MVA)

**SITE PLAN NOTES**  
1. ROOFING MATERIAL: METAL S9R  
2. SIDING MATERIAL: STUCCO FRONT  
METAL SIDING ON SIDES AND REAR  
UNDERGROUND.  
3. UTILITIES: ALL UTILITIES SHALL BE PLACED  
UNDERGROUND.

