

2 REFLECTED CEILING PLAN PHASE B
SCALE: 1/16"=1'-0"

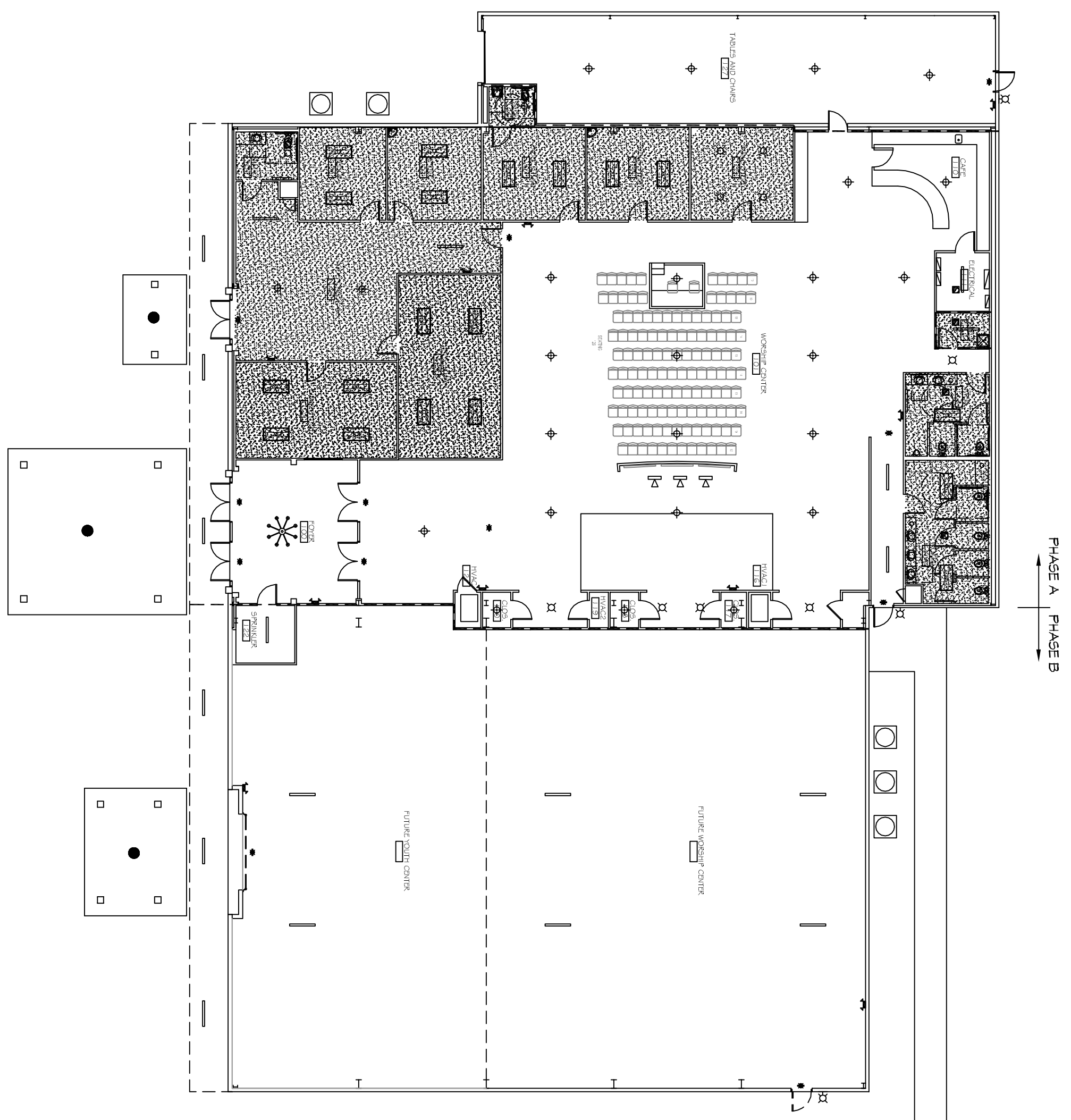

1 REFLECTED CEILING PLAN PHASE A
SCALE: 1/16"=1'-0"

GENERAL NOTES
RCP NOTES
ACTUAL CEILING HEIGHT TO BE DETERMINED BY STRUCTURE ELEVATION AND CEILING ASSEMBLY THICKNESS; HOWEVER, OCCUPYABLE SPACES SHALL NOT HAVE A CEILING HEIGHT LESS THAN 7'-6" (PER IBC 1209.2)

DAMMON ENGINEERING, INC.
LOUISIANA & MISSISSIPPI
Chief Engineer: Brian Mistich, PE
554 Old Spanish Trail
Suidell, LA 70458
www.dammonengineering.com
info@dammonengineering.com
PH: 985.649.5832 F: 985.641.5950

REVISIONS	
#	DESCRIPTION

GRACE FELLOWSHIP
24492 WILLIS ALLEY
PEARL RIVER LA.
JOB No: 2340 DATE: 04/30/2018
DRAWN BY: JHM CHECKED BY: JMS
No other drawings, specifications, design, or engineering information should be used without the express written consent of Dammon Engineering, Inc. This drawing is the property of Dammon Engineering, Inc. and shall remain the property of Dammon Engineering, Inc. in perpetuity. No part of this drawing may be reproduced, stored in a retrieval system, or transmitted in any form or by any means, electronic, mechanical, photocopying, recording, or by any information storage and retrieval system, without the prior written permission of Dammon Engineering, Inc. All other drawings, specifications, design, or engineering information should be used without the express written consent of Dammon Engineering, Inc.

SHEET TITLE:
REFLECTED CEILING PLAN
PHASE A & B
DRAWING NUMBER:
A105
SHEET No. 2 of 13