

1 FLOOR PLAN
SCALE: 3/16"=1'-0"

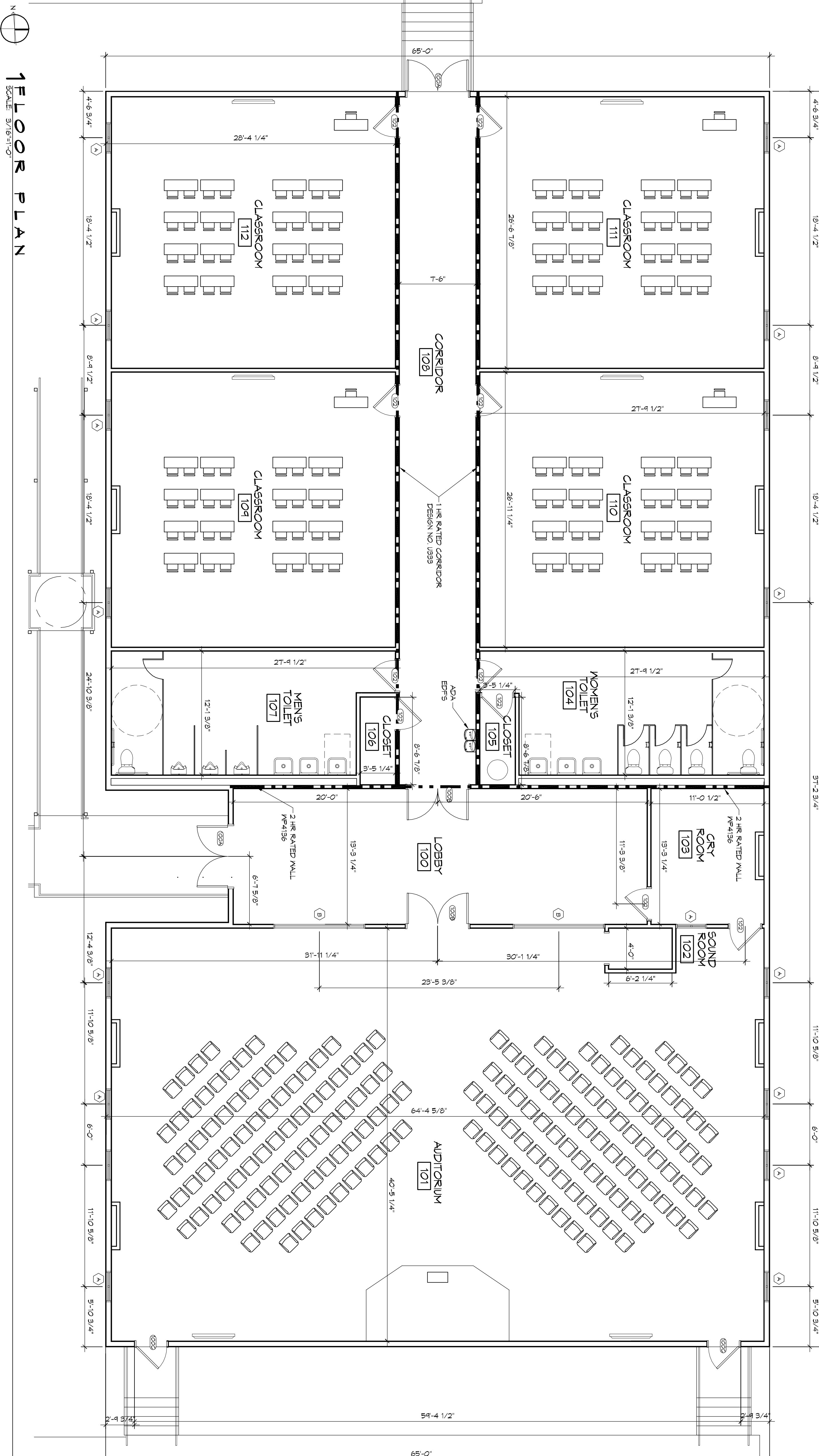

123'-0"

37'-2 3/4"

11'-10 5/8"

6'-0"

11'-10 5/8"

5'-10 3/4"

6'-0"

11'-10 5/8"

5'-10 3/4"

6'-0"

11'-10 5/8"

5'-10 3/4"

6'-0"

NO.	ROOM NAME	ROOM NO.	FLOOR	BASE	WALL	CEILING	REMARKS
100A	LOBBY	100	VCT	5/8" GYP BD	ACT		
100B	AUDITORIUM	101	VCT	5/8" GYP BD	ACT		
100C	SOUND ROOM	102	VCT	5/8" GYP BD	ACT		
101	CRY ROOM	103	VCT	5/8" GYP BD	ACT		
102	WOMEN'S TOILET	104	CERAMIC TILE	5/8" GYP BD	ACT		
103	MEN'S TOILET	105	VCT	5/8" GYP BD	ACT		
104	CLOSET	106	VCT	5/8" GYP BD	ACT		
105	WOMEN'S TOILET	107	CERAMIC TILE	5/8" GYP BD	ACT		
106	MEN'S TOILET	108	VCT	5/8" GYP BD	ACT		
107	CORRIDOR	109	VCT	5/8" GYP BD	ACT		
108	CLASSROOM	110	VCT	5/8" GYP BD	ACT		
109	CLASSROOM	111	VCT	5/8" GYP BD	ACT		
110	CLASSROOM	112	VCT	5/8" GYP BD	ACT		

NO.	ROOM NAME	ROOM NO.	FLOOR	BASE	WALL	CEILING	REMARKS
100A	LOBBY	100	VCT	5/8" GYP BD	ACT		
100B	AUDITORIUM	101	VCT	5/8" GYP BD	ACT		
100C	SOUND ROOM	102	VCT	5/8" GYP BD	ACT		
101	CRY ROOM	103	VCT	5/8" GYP BD	ACT		
102	WOMEN'S TOILET	104	CERAMIC TILE	5/8" GYP BD	ACT		
103	MEN'S TOILET	105	VCT	5/8" GYP BD	ACT		
104	CLOSET	106	VCT	5/8" GYP BD	ACT		
105	WOMEN'S TOILET	107	CERAMIC TILE	5/8" GYP BD	ACT		
106	MEN'S TOILET	108	VCT	5/8" GYP BD	ACT		
107	CORRIDOR	109	VCT	5/8" GYP BD	ACT		
108	CLASSROOM	110	VCT	5/8" GYP BD	ACT		
109	CLASSROOM	111	VCT	5/8" GYP BD	ACT		
110	CLASSROOM	112	VCT	5/8" GYP BD	ACT		

NO.	ROOM NAME	ROOM NO.	FLOOR	BASE	WALL	CEILING	REMARKS
100A	LOBBY	100	VCT	5/8" GYP BD	ACT		
100B	AUDITORIUM	101	VCT	5/8" GYP BD	ACT		
100C	SOUND ROOM	102	VCT	5/8" GYP BD	ACT		
101	CRY ROOM	103	VCT	5/8" GYP BD	ACT		
102	WOMEN'S TOILET	104	CERAMIC TILE	5/8" GYP BD	ACT		
103	MEN'S TOILET	105	VCT	5/8" GYP BD	ACT		
104	CLOSET	106	VCT	5/8" GYP BD	ACT		
105	WOMEN'S TOILET	107	CERAMIC TILE	5/8" GYP BD	ACT		
106	MEN'S TOILET	108	VCT	5/8" GYP BD	ACT		
107	CORRIDOR	109	VCT	5/8" GYP BD	ACT		
108	CLASSROOM	110	VCT	5/8" GYP BD	ACT		
109	CLASSROOM	111	VCT	5/8" GYP BD	ACT		
110	CLASSROOM	112	VCT	5/8" GYP BD	ACT		

GENERAL PLAN NOTES

- INSULATION AND INSULATION ASSEMBLIES SHALL MEET THE REQUIREMENTS OF IBC 2015 SECTION 120.
- CONCEALED INSULATION SHALL HAVE A FLAME SPREAD OF 0-25 AND SMOKE DEVELOPED INDEX OF 0-450, EXCEPT THAT IN COMBUSTIBLE (WOOD FRAME) CONSTRUCTION:
 - WOOD SHALL COMPLY WITH IBC 2015.
 - ALL MATERIALS SHALL BE NEW AND UL LISTED.
- NO WORK SHALL BE CONCEALED UNTIL APPROVED BY LOCAL INSPECTORS.
- CONSTRUCTION SHALL COMPLY WITH ALL PARISH, STATE AND LOCAL CODES.
- CONTRACTOR SHALL GUARANTEE WORK FOR ONE YEAR FROM DATE OF SUBSTANTIAL COMPLETION.
- EXTERIOR CAULKING SHALL BE THICK CAULK.
- PAINT SHALL BE SHERWIN WILLIAMS OR EQUIVALENT AND APPROPRIATE FOR THE SUBSTRATE TO WHICH IT IS COAT. TWO FINISH COATS (UNLESS OTHERWISE RECOMMENDED BY PAINT MANUFACTURER) SHOULD BE SELECTED BY OWNER.
- PROVIDE CLEANUP ON A REGULAR BASIS. NO TRASH SHALL BE STORED INSIDE BUILDING PREMISES.
- ALL BATT INSULATION SHALL HAVE A CLASS 'X' (0-28) FLAME SPREAD IN COMPLIANCE WITH IBC 2015.
- USE 2x6 WOOD STUDS, OR TWO 2x4 WOOD STUDS SPACED STUDS WITH 2x6 SILL PLATE AT ALL WALLS WHERE # 4 PIPE IS INDICATED. SEE PLUMBING REER DIAGRAM FOR PIPE SIZE.
- PROVIDE GALVANIZED METAL PAN WITH DRAIN AT ALL WATER HEATERS.
- ALL FLOORING SHALL MEET OR EXCEED ADA GUIDELINES REQUIREMENTS FOR SLIP RESISTANCE.
- INTERIOR LOCKS ON DOORS SHALL REQUIRE THE USE OF A KEY, SPECIAL KNOWLEDGE OR SPECIAL DEVICE TO OPEN IN THE DIRECTION OF EGRESS. ALL DOORS SHALL HAVE LEVER TYPE HANDLES.
- INTERIOR WALLS AND CEILING SHALL HAVE A FLAME SPREAD OF 0-200 AND A SMOKE DEVELOPMENT RATING OF 0-450.
- ALL NETWORK SHALL COMPLY WITH THE LATEST EDITION OF ALL LOCAL, STATE AND NATIONAL CODES COVERING THE TYPE OF WORK BEING PERFORMED.
- PROVIDE PORTABLE FIRE EXTINGUISHERS IN ACCORDANCE WITH NFPA 101. SEE APPENDIX 'E' OF NFPA 101 FOR DISTRIBUTION OF EXTINGUISHERS.
- ALL ELECTRICAL, MECHANICAL, AND PLUMBING MATERIALS PENETRATING FIRE WALLS SHALL BE FIRE CALLED (PENETRATING THROUGH RATED CONSTRUCTION SHALL BE SEALED WITH A MATERIAL CAPABLE OF PREVENTING THE PASSAGE OF FLAMES AND HOT GASES UNDER TESTED IN ACCORDANCE WITH ASTM E814).
- SERVICE COUNTERS SHALL HAVE AN ACCESSIBLE FINISH SURFACE IN COMPLIANCE WITH ADA'S ACCESSIBILITY GUIDELINES 2010, SECTION 902.3.

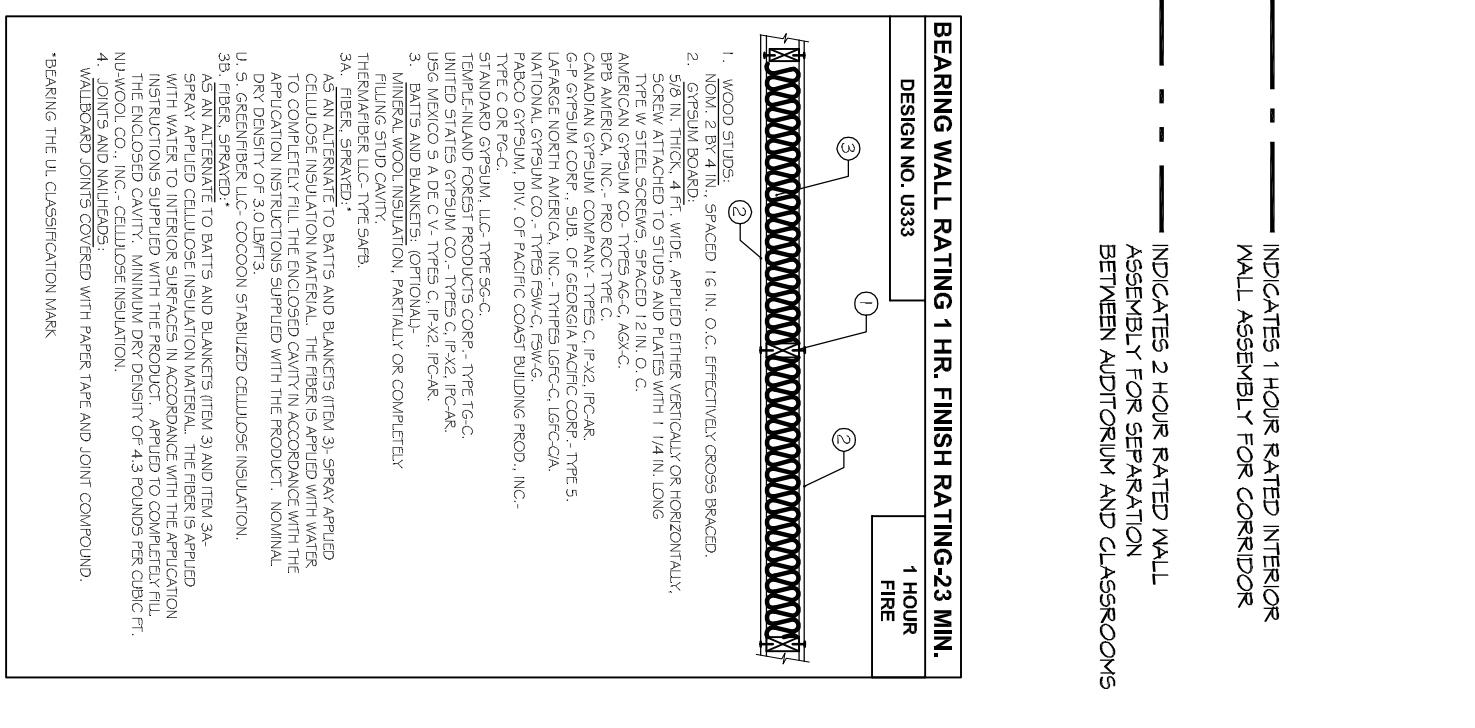

GA FILE NO. WP 4136 GENERIC

BASE LAYER 5/8" TYPE Y CORNISH WALLBOARD OR VENEER BASE APPLIED PARALLEL OR AT RIGHT ANGLES TO EACH SIDE OF 2 X 4 WOOD STUDS 16" O.C. WITH 1/4" TYPE W DRYWALL SCREWS 12" O.C. FACE LAYER 5/8" TYPE X GYPSUM WALLBOARD OR VENEER BASE APPLIED PARALLEL OR AT RIGHT ANGLES TO EACH SIDE WITH 1 7/8" TYPE W DRYWALL SCREWS 12" O.C. AND OFFSET 6" FROM SCREWS IN BASE LAYER.

JOINTS STAGGERED 16" EACH LAYER AND SIDE. (LOAD BEARING)

2 HOUR FIRE 40 TO 44 STC SOUND

THICKNESS: 6 1/8"

APPROX. WEIGHT: 2 PSF

FIRE TEST: SWRI 01-5920-614, 12-5-94

SOUND TEST: SEE WP 4135 (NICC 2363, 4-1-70)

CROSSING

SHEET TITLE: FLOOR PLAN

64492 HIGHWAY 41, PEARL, KYRG, LA 70452

JOB NO: 2389 DATE: 9/15/2017

DRAWN BY: KCD CHECKED BY: JMS

Chief Engineer: Brian Mistich, PE
554 Old Spanish Trail
Slidell, LA 70458

www.dammonengineering.com
info@dammonengineering.com
PH: 985.649.5832 F: 985.641.5950

A101

SHEET NO: 1 OF 15