

| FINISH SCHEDULE | | | |
|---|-------|---------|-------------------|
| NAME | FLOOR | BASE | REMARKS |
| | | WALLS | |
| | | CEILING | |
| OFFICE | | | CARPET |
| BATHROOM | | | CONCRETE |
| WAREHOUSE | | | VCT |
| OWNER TO SELECT STYLE, COLOR, AND BRAND | | | CERAMIC TILE |
| | | | NONE |
| | | | CERAMIC TILE |
| | | | RUBBER WALL BASE |
| | | | WOOD BASE |
| | | | NONE |
| | | | CERAMIC TILE |
| | | | 5/8" GYPSUM BOARD |
| | | | 2x2 LAY-IN PANELS |
| | | | GYPSUM BOARD |
| | | | CEILING HEIGHT... |

| WINDOW SCHEDULE | | | |
|-----------------|-------|--------------|---------|
| TYPE | FRAME | GLASS | REMARKS |
| | | LITES | |
| | | ACCESSORIES | |
| FIXED | | | |
| S. HUNG | | | |
| D. HUNG | | | |
| HORIZ. SLIDE | | | |
| VERT. SLIDE | | | |
| STEEL | | | |
| ALUMINUM* | | | |
| WOOD | | | |
| | | TINTED | |
| | | INSUL. LOW E | |
| | | TEMPERED | |
| | | WIREGLASS | |
| | | NONE | |
| | | 2/2 | |
| | | 2/4 | |
| | | 6/6 | |
| | | SEE ELEV. | |
| | | ALARM | |
| | | SCREEN | |
| | | SHUTTER | |

*ALL ALUMINUM FRAMES TO HAVE DARK BRONZE FINISH.

| DOOR & HARDWARE SCHEDULE | | | |
|--------------------------|-------|-------|-------------|
| TYPE | FRAME | HINGE | LOCK |
| | | | ACCESSORIES |
| | | | REMARKS |
| SOLID WOOD | | | |
| HOLLOW METAL | | | |
| SLIDING | | | |
| STOREFRONT | | | |
| OVERHEAD | | | |
| STEEL | | | |
| ALUMINUM | | | |
| WOOD | | | |
| CASED OPENING | | | |
| DBL SWING | | | |
| BUTT 1-1/2 PR | | | |
| BURGLERPRF | | | |
| FIXED | | | |
| PASSAGE | | | |
| PRIVACY | | | |
| DEADBOLT | | | |
| KEYED HANDLE | | | |
| OFFICE/ENTRANCE | | | |
| STOREROOM | | | |
| PANIC BAR | | | |
| THRESHOLD | | | |
| WEATHERSTRIP | | | |
| DOOR STOP | | | |
| ALARM | | | |
| SILENCER | | | |
| CLOSER | | | |

- DOOR & HARDWARE NOTES:
- ALL GLAZING TO BE LAMINATED SAFETY GLASS.
 - DOOR HINGES TO BE STANLEY FULL MORITSE STANDARD WEIGHT. BALL BEARING HINGES. STAINLESS STEEL WITH DARK BRONZE FINISH @ EXTERIOR & MATCHING DARK BRONZE FINISH ON STANDARD STEEL @ INTERIOR.
 - PROVIDE LEVER HANDLE ADA APPROVED LOCKSETS WITH MATCHING DARK BRONZE FINISH, TO BE SELECTED BY OWNER.
 - COORDINATE KEYS SCHEDULE WITH OWNER.
 - DOOR STOPS TO BE EQUAL TO IES NO. 436 OR 437, AS REQUIRED IN MATCHING DARK BRONZE FINISH.
 - WEATHER-STRIP & THRESHOLD FINISH TO COMPLEMENT OTHER HARDWARE.
 - WD. DOOR, TRIM, & BASE TO BE SELECTED BY OWNER.

GA FILE NO. WP 1072 GENERIC

ONE LAYER 5/8" TYPE X GYPSUM WALLBOARD OR GYPSUM VENEER BASE APPLIED PARALLEL OR AT RIGHT ANGLES TO EACH SIDE OF 3-5/8" STEEL STUDS 24" O.C. WITH 1" TYPE S DRYWALL SCREWS 8" O.C. AT VERTICAL JOINTS AND 12" O.C. AT FLOOR AND CEILING RUNNERS AND INTERMEDIATE STUDS.

JOINTS STAGGERED 24" ON EACH SIDE AND ON OPPOSITE SIDES. SOUND TESTED WITH 3-12" GLASS FIBER FRICTION FIT IN STUD SPACE. (NON-LOAD BEARING)

1 HOUR FIRE 45 TO 49 STC SOUND



THICKNESS: 4-7/8"

APPROX. WEIGHT: 6 PSF

FIRE TEST: (FM WP-45, 6-19-68); OSU T-1770, 8-6-1; UIC 797484, 797500, 797497, 8-12-81; UIC DESIGN (W415)

SOUND TEST: NRC 0.816-1M, 2-3-81

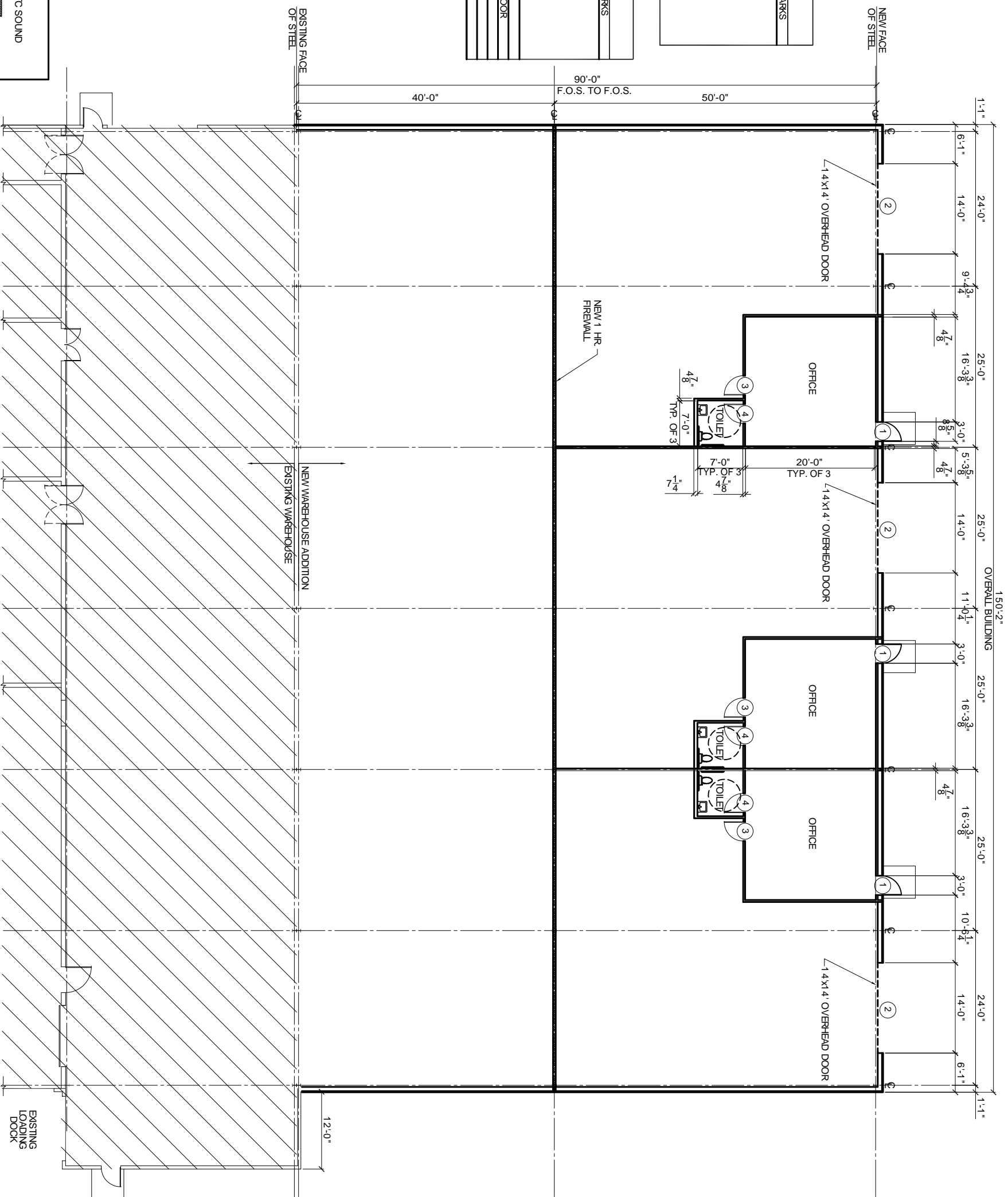

NEW ADDITION FLOOR PLAN



FOR GENERAL NOTES SEE A-3

- NEW INTERIOR WALL CONSTRUCTION TYPICAL INTERIOR SHALL HAVE 5/8" SHEETROCK WITH SOUND BATT INSULATION AND 16" O.C. FIREWALL CONSTRUCTION TYPICAL SHALL BE GA WP 1072. DENISE TO ROOF DECK
- EXISTING AREA (HATCHED)

| | |
|---|---|
| <p>DAMMON ENGINEERING, INC. CHIEF ENGINEER EMMETT DAMMON, P.E. CHIEF ARCHITECT ROBERT WILTSE</p> | 1095 FLORIDA AVENUE SUITE LL, LA. 70458 OFFICE: 985-649-5832 FAX: 985-641-5950 WWW.DAMMONENGINEERING.COM WEBSITE: DAMMONENG@BELLFLOWER.NET |
| | ARCHITECTURE ENGINEERING STUDIES PLANNING INVESTIGATION EXPERT WITNESS |
| SAL & JUDY'S 501 J.F. SMITH AVE SUDELL, LA 70460 | WAREHOUSE ADDITION |
| REV: SCALE: AS NOTED JOB#: 1938 DATE: 2-29-08 | SHEET A-2 |