

**DAMMON**  
ENGINEERING, INC.

CHIEF ENGINEER  
EMMETT  
DAMMON, P.E.

CHIEF ARCHITECT  
ROBERT  
WILTSE

1095 FLORIDA AVENUE  
SLIDELL, LA. 70458  
OFFICE: 985-649-5832  
FAX: 985-641-5950

WEBSITE:  
WWW.DAMMONENGINEERING.COM

EMAIL:  
DAMMONENG@BELLSOUTH.NET

- ARCHITECTURE
- ENGINEERING
- STUDIES
- PLANNING
- INVESTIGATION
- EXPERT WITNESS

GREEN  
OFFICE COMPLEX  
GAUSE  
BLVD., WEST  
SLIDELL, LA

FLOOR  
PLAN

REV:

SCALE: AS NOTED

JOB#: 2057

DATE: 03-31-10

SHEET

**A-1**

OF

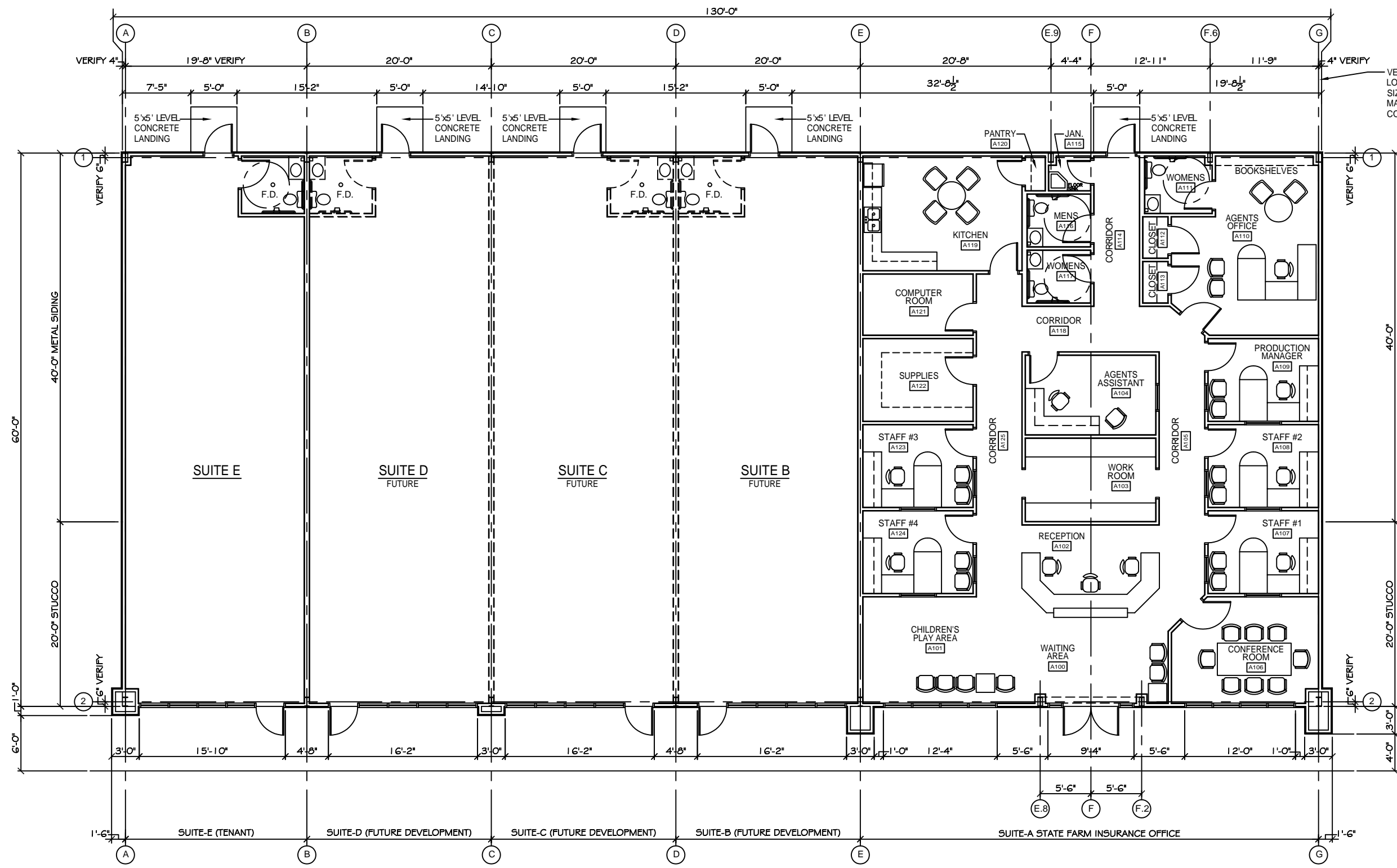

VERIFY CORNER COLUMN  
LOCATIONS AND ALL STEEL  
SIZES WITH METAL BUILDING  
MANUFACTURER PRIOR TO  
CONSTRUCTION.

FLOOR PLAN  
SCALE: 3/16"=1'