

DAMMON ENGINEERING, INC.

CHIEF ENGINEER
EMMETT DAMMON, P.E.

CHIEF ARCHITECT
ROBERT WILTSE

554 OLD SPANISH TRAIL
SLIDELL, LA. 70458
OFFICE: 985-649-5832
FAX: 985-641-5950

WEBSITE:
WWW.DAMMONENGINEERING.COM

EMAIL:
DAMMONENG@BELLSOUTH.NET

ARCHITECTURE
ENGINEERING
STUDIES
PLANNING
INVESTIGATION
EXPERT WITNESS

PAUL REES
OFFICE BUILDING
2275 8TH. ST.
MANDEVILLE, LA
70471

REFLECTED
CEILING PLAN

Robert Wiltse

REV:

SCALE: AS NOTED

JOB#: 2104

DATE: 05-20-11

SHEET 14

A-5

OF 20

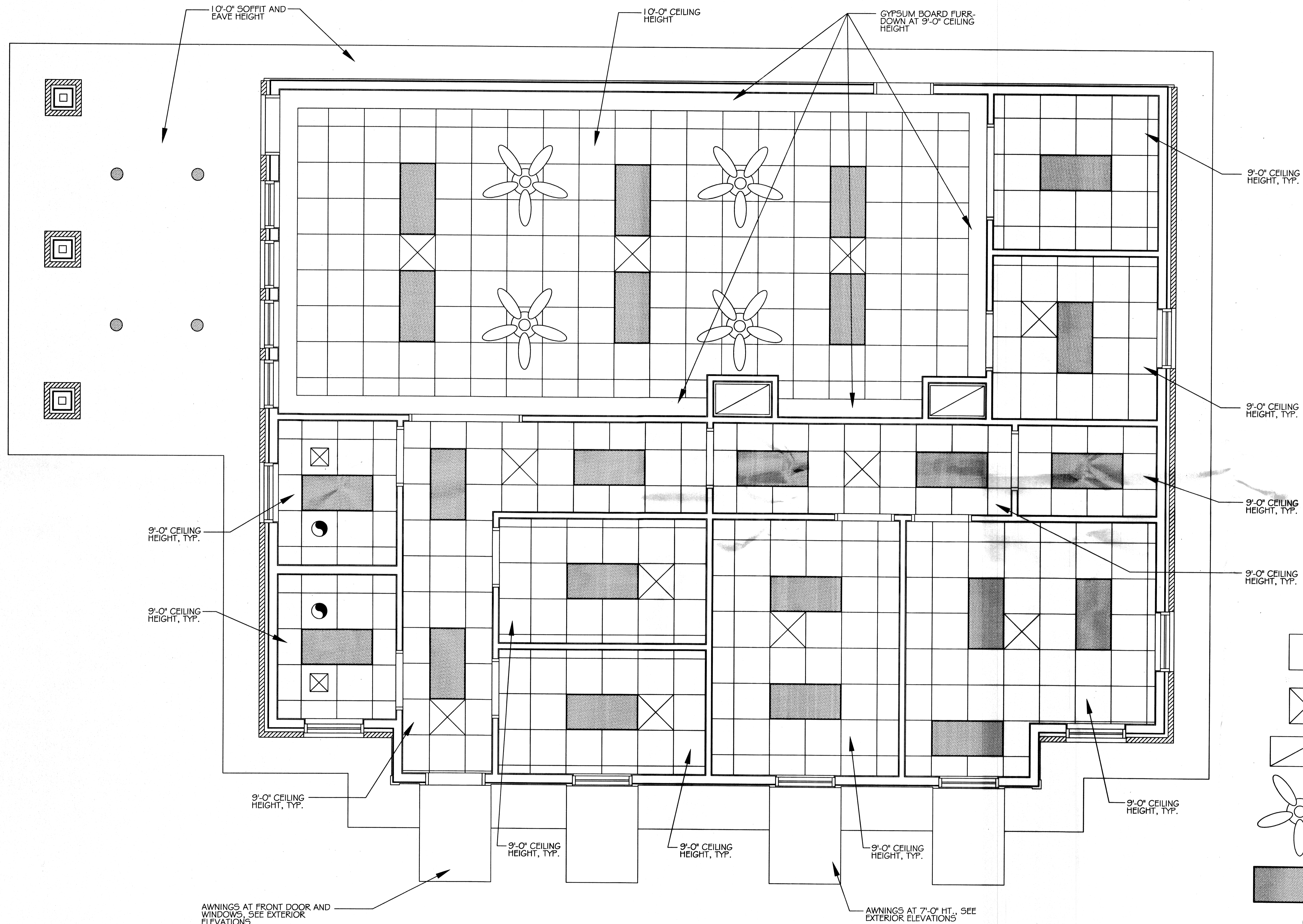

LEGEND

- A.C.T. CEILING GRID (2x2)
- SUPPLY AIR
- RETURN AIR
- CEILING FAN
- 2x4' FLUORESCENT LIGHT
- EXHAUST FAN
- EXTERIOR CAN LIGHT FIXTURE

REFLECTED CEILING PLAN
SCALE: 3/8" = 1'

AWNINGS AT FRONT DOOR AND WINDOWS, SEE EXTERIOR ELEVATIONS

AWNINGS AT 7'-0" HT., SEE EXTERIOR ELEVATIONS