

← COUSIN STREET →

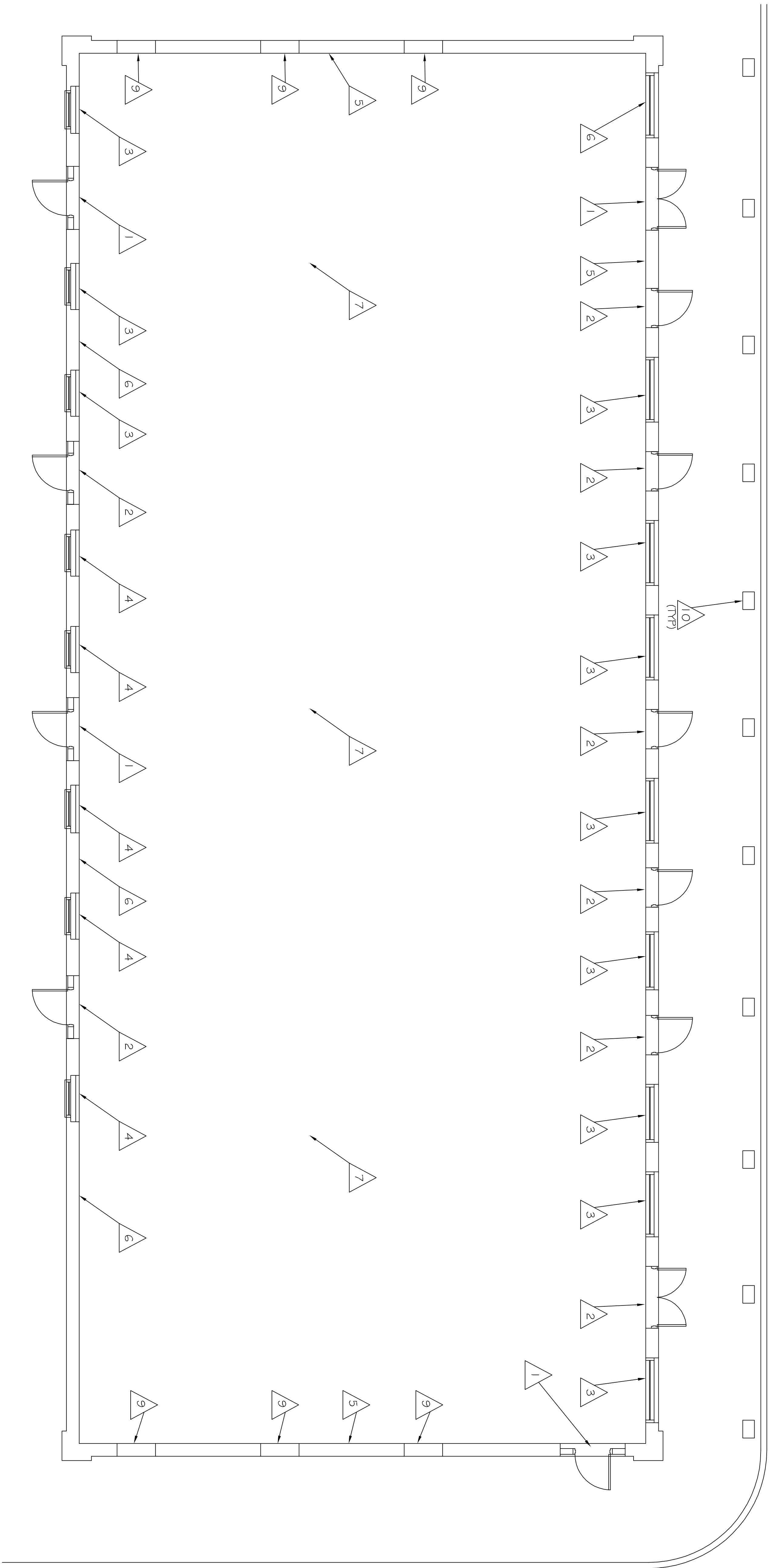

← FIRST STREET →

DEMOLITION PLAN
SCALE: 3/16" = 1'-0"

DEMOLITION NOTES:

1. DOOR SHALL BE REPLACED WITH NEW.
2. REMOVE EXISTING DOOR AND INFILL OPENING WITH SALVAGED BRICK. MATCH EXISTING 3-WYTHE MASONRY.
3. REMOVE EXISTING WINDOW. CLEAN AND PREPARE SURFACES FOR NEW WINDOW.
4. REMOVE EXISTING WINDOW AND INFILL OPENING WITH SALVAGED BRICK. MATCH EXISTING 3-WYTHE MASONRY.
5. AT NORTH, EAST AND WEST WALLS, REMOVE EXISTING 3-WYTHE BRICK WALL ABOVE 15'-1" +/- (AT HORIZONTAL BRICK JOINT) VERTICAL FROM EXISTING F.F.E. CLEAN AND PREPARE NEWLY EXPOSED TOP COURSE FOR NEW CMU BOND BEAM. SEE SECTION, SHEET A-2. SALVAGE BRICKS FOR NEW MASONRY CONSTRUCTION.
6. AT SOUTH WALL, REMOVE EXISTING 3-WYTHE BRICK WALL ABOVE 13'-8" +/- (AT HORIZONTAL BRICK JOINT) VERTICAL FROM EXISTING F.F.E. CLEAN AND PREPARE NEWLY EXPOSED TOP COURSE FOR NEW CMU BOND BEAM. SEE SECTION, SHEET A-2. SALVAGE BRICKS FOR NEW MASONRY CONSTRUCTION.
7. REMOVE ALL EXISTING FLOOR COVERINGS # PREP FOR NEW FLOOR.
8. CLEAN ALL EXISTING MASONRY TO REMAIN.
9. INFILL EXISTING OPENINGS WITH SALVAGED BRICK. MATCH EXISTING 3-WYTHE MASONRY TO PROVIDE 1 HR FIRE RATED WALL SYSTEM. UL#
10. REBUILD CONCRETE BASE FOR NEW DECORATIVE COLUMNS. (TYP)

REVISIONS	
#	DESCRIPTION

**OLDE TOWN SLIDELL
FIRE DAMAGE REHABILITATION**
227 & 2856 COLEIN STREET
SLIDELL, LA
70458

JOB No:	2146	DATE:	07-27-2012
DRAWN BY:	BSN	CHECKED BY:	BSN

J:\DAMMON\Dammon Logo\Dammon Logo.jpg

CHIEF ENGINEER: EMMETT DAMMON, P.E.
CHIEF ARCHITECT: ROBERT WILTSE
554 OLD SPANISH TRAIL
SLIDELL, LA 70458

dammonengineering.com
dammoneng@bellsouth.net
PHONE: 985-649-5832
FAX: 985-641-5950

DEMOLITION
FLOOR
PLAN

SHEET No: 2 OF 9

D-1