



DAMMON
ENGINEERING, INC.

CHIEF ENGINEER
EMMETT
DAMMON, P.E.
CHIEF ARCHITECT
ROBERT
WILTSE

554 OLD SPANISH TRAIL
SUDDLE, LA. 70458
OFFICE: 985-649-5832
FAX: 985-641-15950

WEBSITE:
WWW.DAMMONENGINEERING.COM
EMAIL:
DAMMONENG@BELLSOUTH.NET

ARCHITECTURE
ENGINEERING
STUDIES
PLANNING
INVESTIGATION
EXPERT WITNESS

-
-
-

MINACAPPELLUS

DEMOLITION
PLAN

REV:

SCALE: AS NOTED

JOB#:

DATE: XX-XX-07

SHEET

D-1

OF

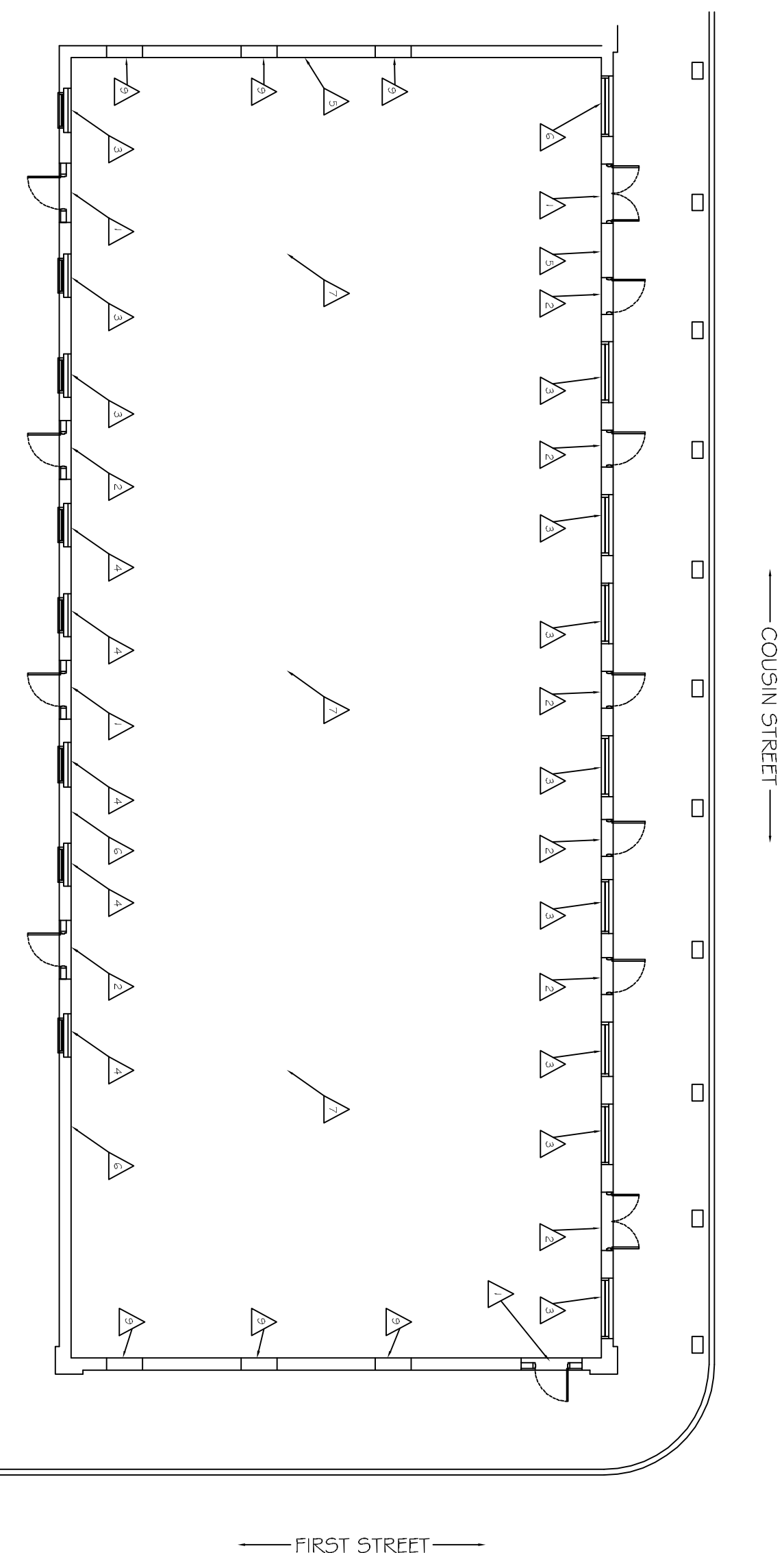

DEMOLITION PLAN
SCALE: 3/16"=1'-0"

DEMOLITION NOTES:

1. DOOR SHALL BE REPLACED WITH NEW.
2. REMOVE EXISTING DOOR AND INFILL OPENING WITH SALVAGED BRICK. MATCH EXISTING 3-WYTHE MASONRY.
3. REMOVE EXISTING WINDOW. CLEAN AND PREPARE SURFACES FOR NEW WINDOW.
4. REMOVE EXISTING WINDOW AND INFILL OPENING WITH SALVAGED BRICK. MATCH EXISTING 3-WYTHE MASONRY.
5. AT NORTH, EAST AND WEST WALLS, REMOVE EXISTING 3-WYTHE BRICK WALL ABOVE 15'-0" VERTICAL FROM EXISTING F.F.E. CLEAN AND PREPARE NEWLY EXPOSED TOP COURSE FOR NEW CMU BOND BEAM. SEE SECTION, SHEET A-2. SALVAGE BRICKS FOR NEW MASONRY CONSTRUCTION.
6. AT SOUTH WALL, REMOVE EXISTING 3-WYTHE BRICK WALL ABOVE 13'-8" VERTICAL FROM EXISTING F.F.E. CLEAN AND PREPARE NEWLY EXPOSED TOP COURSE FOR NEW CMU BOND BEAM. SEE SECTION, SHEET A-2. SALVAGE BRICKS FOR NEW MASONRY CONSTRUCTION.
7. REMOVE ALL EXISTING FLOOR COVERINGS & PREP FOR NEW FLOOR.
8. CLEAN ALL EXISTING MASONRY TO REMAIN.
9. INFILL EXISTING OPENINGS WITH SALVAGED BRICK. MATCH EXISTING 3-WYTHE MASONRY TO PROVIDE 1HR FIRE RATED WALL SYSTEM.