

← COUSIN STREET →

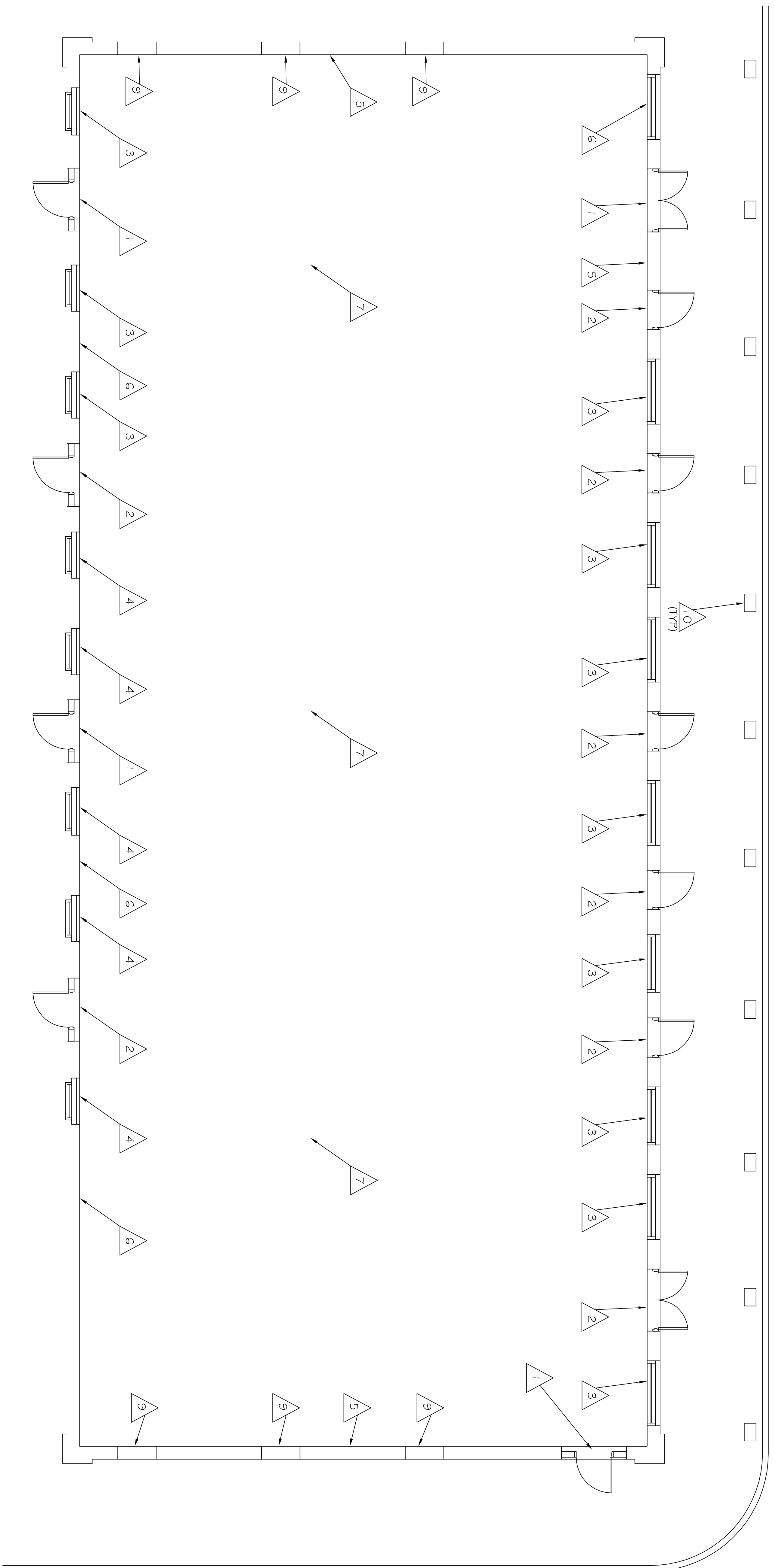

← FIRST STREET →

DEMOLITION PLAN

SCALE: 3/16" = 1'-0"

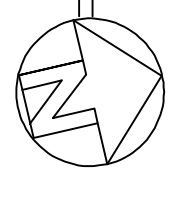

DEMOLITION NOTES: #

1. DOOR SHALL BE REPLACED WITH NEW.
2. REMOVE EXISTING DOOR AND INFILL OPENING WITH SALVAGED BRICK. MATCH EXISTING 3-WYTHE MASONRY.
3. REMOVE EXISTING WINDOW. CLEAN AND PREPARE SURFACES FOR NEW WINDOW.
4. REMOVE EXISTING WINDOW AND INFILL OPENING WITH SALVAGED BRICK. MATCH EXISTING 3-WYTHE MASONRY.
5. AT NORTH, EAST AND WEST WALLS, REMOVE EXISTING 3-WYTHE BRICK WALL ABOVE 1'-5 1/2" +/- (AT HORIZONTAL BRICK JOINT) VERTICAL FROM EXISTING F.F.E. CLEAN AND PREPARE NEWLY EXPOSED TOP COURSE FOR NEW CMU BOND BEAM. SEE SECTION, SHEET A-2. SALVAGE BRICKS FOR NEW MASONRY CONSTRUCTION.
6. AT SOUTH WALL, REMOVE EXISTING 3-WYTHE BRICK WALL ABOVE 1'-3'-8" +/- (AT HORIZONTAL BRICK JOINT) VERTICAL FROM EXISTING F.F.E. CLEAN AND PREPARE NEWLY EXPOSED TOP COURSE FOR NEW CMU BOND BEAM. SEE SECTION, SHEET A-2. SALVAGE BRICKS FOR NEW MASONRY CONSTRUCTION.
7. REMOVE ALL EXISTING FLOOR COVERINGS & PREP FOR NEW FLOOR.
8. CLEAN ALL EXISTING MASONRY TO REMAIN.
9. INFILL EXISTING OPENINGS WITH SALVAGED BRICK. MATCH EXISTING 3-WYTHE MASONRY TO PROVIDE 1 HR FIRE RATED WALL SYSTEM. U/#
10. REBUILD CONCRETE BASE FOR NEW DECORATIVE COLUMNS. (TYP)

REVISIONS		DATE
#	DESCRIPTION	

**OLDE TOWN SLIDELL
FIRE DAMAGE REHABILITATION**
227 & 285 COUSIN STREET
SLIDELL, LA
70458

JOB No:	2146	DATE:	07-27-2012
DRAWN BY:	BSN	CHECKED BY:	BSN

The above drawings and specifications, designs and arrangements represent the property of Dammon Engineering, Inc. and shall remain the property of Dammon Engineering, Inc. and shall not be used in connection with any work or project other than the specific project for which they have been prepared and approved without written consent of Dammon Engineering, Inc. All contact with these drawings or specifications shall constitute a complete and final acceptance of these restrictions.

**DAMMON
ENGINEERING, INC.**
Architects & Engineers

CHIEF ENGINEER, EMMETT DAMMON, P.E.
CHIEF ARCHITECT, ROBERT WILTSE
554 OLD SPANISH TRAIL
SLIDELL, LA 70458

dammonenginc.com
dammoneng@bellsouth.net
PHONE: 985-649-5832
FAX: 985-641-5950

DEMOLITION
FLOOR
PLAN

SHEET No: 2 OF 9

D-1