

SITE LIGHTING
 EXTERIOR LIGHTING SHALL BE SHADOWED OR INWARDLY DIRECTED IN SUCH A MANNER SO THAT NO DIRECT LIGHTING OR GLARE BE CAST BEYOND THE PROPERTY LINE. THE INTENSITY OF SUCH LIGHTING SHALL NOT EXCEED ONE FOOT CANDLE AS MEASURED AT THE ADJUTING PROPERTY LINE.

NOTE
 PAINT IN ALL PARKING AREAS SHALL BE 6" THICK CONCRETE.

- SITE PLAN NOTES**
1. ROOFING MATERIAL: METAL ROOFING PANEL
 2. SIDING MATERIAL: SPUN FACE BLOCK
 3. UTILITIES: ALL UTILITIES SHALL BE PLACED UNDERGROUND

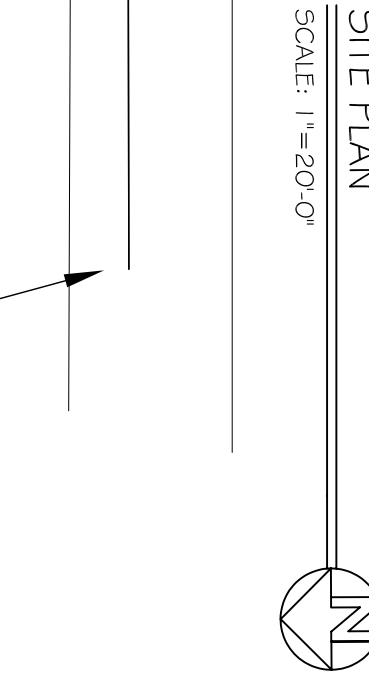

POINT OF COMMENCEMENT
 FOUND RR SPIKE
 SW CORNER OF THE SE 1/4 OF THE SE 1/4, S31.15N, R13W, FOREST COUNTY, MS

POINT OF BEGINNING
 SET IRON PIN

CAMPBELL DRIVE
 WEST 210.88'
 1318.84' (APR & ARS)

FOUND CONCRETE MONUMENT
 SE 1/4 CORNER OF THE SE 1/4, S31.15N, R13W, FOREST COUNTY, MS

SHEET No: 00 OF 00

C1

SITE PLAN

REVISIONS		DATE
#	DESCRIPTION	

RAINFOREST CARWASH #2
 6485 U.S. HWY. 49

HATTIESBURG, MISSISSIPPI

JOB No: 2212 DATE: 07-28-2014

DRAWN BY: CKD CHECKED BY: CKD

DAMMON
 ENGINEERING, INC.
Architects & Engineers

CHIEF ENGINEER: BRIAN MISTICH, P.E.
 CHIEF ARCHITECT: KEVIN KINCHEN
 554 OLD SPANISH TRAIL
 SLIDELL, LA 70458

dammonengineering.com
 dammoneng@bellsouth.net
 PHONE: 985-649-5832
 FAX: 985-641-5990

The above drawings and specifications, designs and arrangements represented hereby are and shall remain the property of Dammon Engineering, and no part thereof shall be copied, disposed to others, or used in connection with any work or project other than the specific project for which they have been prepared and developed without written consent of Dammon Engineering. Your contact with these drawings or specifications shall constitute conclusive evidence of acceptance of these restrictions.