

These documents are the property of
Bailey & Associates Architects LLC.
Any duplication in whole or in part
must be done with the written consent
of Bailey & Associates Architects, LLC

© Bailey & Associates
PROFESSIONAL SEAL

SHEET TITLE

SHEET NUMBER

PROJECT NUMBER
0149.11.07

DATE: August 05, 2008
DRAWN BY: R.E.B.
CHECKED BY:

REVISIONS

No. Date By

SHEET

TOTAL SHEETS

DOOR SCHEDULE

TK	WIDTH	HGT	THK	TYPE	HARDWARE	MATERIAL	FINISH	DETAILS: HD / JB / SILL	NOTES	SET	DESCRIPTION
1	3'-0"	8'-0"	1-3/4"	A	1	UD. S.C. EXT. CLAD	FACTORY FN. EXT. / NT. PAINTED	1 / A-12	3 / A-12	1	1/2 PAIR OF BUTTS
2	3'-0"	8'-0"	1-3/8"	B	2	UD. S.C. PANEL / UD.	CLEAR / CLEAR	4 / A-12	6 / A-12	2	
3	3'-0"	8'-0"	1-3/8"	B	2	UD. S.C. PANEL / UD.	CLEAR / CLEAR	4 / A-12	6 / A-12	2	
4	3'-0"	8'-0"	1-3/8"	B	2	UD. S.C. PANEL / UD.	CLEAR / CLEAR	4 / A-12	6 / A-12	2	
5	3'-0"	8'-0"	1-3/4"	D	4	UD. S.C. EXT. CLAD	FACTORY FN. EXT. / NT. PAINTED	1 / A-12	3 / A-12	3	1/2 PAIR OF BUTTS
6	3'-0"	8'-0"	1-3/4"	D	5	UD. S.C. EXT. CLAD	FACTORY FN. EXT. / NT. PAINTED	1 / A-12	3 / A-12	4	
7	3'-0"	8'-0"	1-3/4"	D	5	UD. S.C. EXT. CLAD	FACTORY FN. EXT. / NT. PAINTED	1 / A-12	3 / A-12	4	
8	3'-0"	8'-0"	1-3/8"	A	1	UD. S.C. EXT. CLAD	FACTORY FN. EXT. / NT. PAINTED	4 / A-12	6 / A-12	1	
9	3'-0"	8'-0"	1-3/8"	B	2	UD. S.C. PANEL / UD.	CLEAR / CLEAR	4 / A-12	6 / A-12	2	
10	3'-0"	8'-0"	1-3/8"	B	2	UD. S.C. PANEL / UD.	CLEAR / CLEAR	4 / A-12	6 / A-12	2	
11	3'-0"	8'-0"	1-3/8"	E	6	UD. S.C. PANEL / UD.	CLEAR / CLEAR	3 / A-12	6 / A-12	5	
12	3'-0"	8'-0"	1-3/8"	B	2	UD. S.C. PANEL / UD.	CLEAR / CLEAR	4 / A-12	6 / A-12	2	
13	2'-4"	8'-0"	1-3/8"	B	2	UD. S.C. PANEL / UD.	CLEAR / CLEAR	4 / A-12	6 / A-12	2	
14	3'-0"	8'-0"	1-3/8"	B	2	UD. S.C. PANEL / UD.	CLEAR / CLEAR	4 / A-12	6 / A-12	2	
15	3'-0"	8'-0"	1-3/8"	B	2	UD. S.C. PANEL / UD.	CLEAR / CLEAR	4 / A-12	6 / A-12	2	
16	3'-0"	8'-0"	1-3/8"	B	2	UD. S.C. PANEL / UD.	CLEAR / CLEAR	4 / A-12	6 / A-12	2	
17	5'-0"	7'-0"	1-3/8"	F	1	UD. S.C. BIFOLD / UD.	CLEAR / CLEAR	6 / A-12	17 / A-12	6	
18	4'-0"	7'-0"	1-3/8"	B	2	UD. S.C. PANEL / UD.	CLEAR / CLEAR	4 / A-12	6 / A-12	2	
19	4'-0"	7'-0"	1-3/8"	F	1	UD. S.C. BIFOLD / UD.	CLEAR / CLEAR	6 / A-12	17 / A-12	6	

HARDWARE SCHEDULE

SET	DESCRIPTION
1	SCREENS
2	SCREENS
3	SCREENS
4	SCREENS
5	SCREENS

WINDOW SCHEDULE

TK	WIDTH	HGT	OPF	TYPE	HARDWARE	MATERIAL	FINISH	DETAILS: HD / JB / SILL	NOTES	SET	DESCRIPTION
A	2'-6"	5'-0"	0	DBL. HG. A	1	UD. S.C. EXT. CLAD	FACTORY FN. EXT. / NT. PAINTED	1 / A-11	3 / A-11	1	SCREENS
B	2'-6"	5'-0"	0	DBL. HG. A	1	UD. S.C. EXT. CLAD	FACTORY FN. EXT. / NT. PAINTED	1 / A-11	3 / A-11	1	SCREENS
C	2'-6"	5'-0"	0	DBL. HG. A	1	UD. S.C. EXT. CLAD	FACTORY FN. EXT. / NT. PAINTED	1 / A-11	3 / A-11	1	SCREENS
D	5'-0"	5'-0"	0	DBL. HG. B	2	UD. S.C. EXT. CLAD	FACTORY FN. EXT. / NT. PAINTED	4 / A-11	6 / A-11	2	SCREENS
E	1'-5"	5'-0"	0	DBL. HG. C	3	UD. S.C. EXT. CLAD	FACTORY FN. EXT. / NT. PAINTED	1 / A-11	3 / A-11	3	SCREENS
F	3'-0"	8'-0"	0	FIXED D	4	UD. S.C. EXT. CLAD	FACTORY FN. EXT. / NT. PAINTED	1 / A-10	12 / A-10	3	SCREENS
G	3'-0"	8'-0"	0	FIXED D	4	UD. S.C. EXT. CLAD	FACTORY FN. EXT. / NT. PAINTED	1 / A-10	12 / A-10	3	SCREENS
H	3'-0"	8'-0"	0	FIXED E	2	UD. S.C. EXT. CLAD	FACTORY FN. EXT. / NT. PAINTED	1 / A-11	12 / A-11	4	SCREENS
I	3'-0"	8'-0"	0	FIXED E	2	UD. S.C. EXT. CLAD	FACTORY FN. EXT. / NT. PAINTED	1 / A-11	12 / A-11	4	SCREENS
J	3'-0"	8'-0"	0	FIXED E	2	UD. S.C. EXT. CLAD	FACTORY FN. EXT. / NT. PAINTED	1 / A-11	12 / A-11	4	SCREENS
K	3'-0"	8'-0"	0	FIXED E	2	UD. S.C. EXT. CLAD	FACTORY FN. EXT. / NT. PAINTED	1 / A-11	12 / A-11	4	SCREENS
L	3'-0"	8'-0"	0	FIXED E	2	UD. S.C. EXT. CLAD	FACTORY FN. EXT. / NT. PAINTED	1 / A-11	12 / A-11	4	SCREENS
M	3'-0"	8'-0"	0	FIXED E	2	UD. S.C. EXT. CLAD	FACTORY FN. EXT. / NT. PAINTED	1 / A-11	12 / A-11	4	SCREENS
N	3'-0"	8'-0"	0	FIXED E	2	UD. S.C. EXT. CLAD	FACTORY FN. EXT. / NT. PAINTED	1 / A-11	12 / A-11	4	SCREENS
O	3'-0"	8'-0"	0	FIXED E	2	UD. S.C. EXT. CLAD	FACTORY FN. EXT. / NT. PAINTED	1 / A-11	12 / A-11	4	SCREENS
P	3'-0"	8'-0"	0	FIXED E	2	UD. S.C. EXT. CLAD	FACTORY FN. EXT. / NT. PAINTED	1 / A-11	12 / A-11	4	SCREENS
Q	4'-6"	3'-6"	0	DBL. HG. C	3	UD. S.C. EXT. CLAD	FACTORY FN. EXT. / NT. PAINTED	1 / A-11	9 / A-11	5	SCREENS
R	4'-6"	3'-6"	0	DBL. HG. C	3	UD. S.C. EXT. CLAD	FACTORY FN. EXT. / NT. PAINTED	1 / A-11	9 / A-11	5	SCREENS
S	2'-6"	5'-0"	0	DBL. HG. A	1	UD. S.C. EXT. CLAD	FACTORY FN. EXT. / NT. PAINTED	1 / A-11	3 / A-11	1	SCREENS
T	2'-6"	5'-0"	0	DBL. HG. A	1	UD. S.C. EXT. CLAD	FACTORY FN. EXT. / NT. PAINTED	1 / A-11	3 / A-11	1	SCREENS
U	2'-6"	5'-0"	0	DBL. HG. A	1	UD. S.C. EXT. CLAD	FACTORY FN. EXT. / NT. PAINTED	1 / A-11	3 / A-11	1	SCREENS
V	1'-9"	3'-6"	0	DBL. HG. A	1	UD. S.C. EXT. CLAD	FACTORY FN. EXT. / NT. PAINTED	3 / A-11	14 / A-11	1	SCREENS
W	1'-9"	3'-6"	0	DBL. HG. A	1	UD. S.C. EXT. CLAD	FACTORY FN. EXT. / NT. PAINTED	3 / A-11	14 / A-11	1	SCREENS
X	1'-9"	3'-6"	0	DBL. HG. C	6	UD. S.C. EXT. CLAD	FACTORY FN. EXT. / NT. PAINTED	3 / A-11	14 / A-11	1	SCREENS
Y	1'-9"	3'-6"	0	DBL. HG. C	6	UD. S.C. EXT. CLAD	FACTORY FN. EXT. / NT. PAINTED	3 / A-11	14 / A-11	1	SCREENS

FINISH SCHEDULE

ROOM NO.	ROOM NAME	FLOOR	BASE	WALLS	TRIM	CEILING	NOTES
101	ENTRY	10	20 CLEAR	30	30	40	10'-0"
102	MASTER BEDROOM	10	20 CLEAR	30	30	40	10'-0"
103	MASTER BATH	11 AND 12	N/A	30/32	30	40	10'-0"
104	MASTER CLOSET	10	20 CLEAR	30	30	40	10'-0"
105	DINING	10	20 CLEAR	31	31	40	10'-0"
106	DEN	10	20 CLEAR	31	31	40	10'-0"
107	DINING ROOM	10	20 CLEAR	31	31	40	10'-0"
108	KITCHEN	14	20 CLEAR	N/A	30	40	9'-0"
109	OWNER'S ENTRY	13	23 N/A	30	30	40	10'-0"
110	PAINTER / LAUNDRY	13	23 N/A	30	30	40	10'-0"
111	BATH NO. 2	13	23 N/A	30/32	30/32	40	10'-0"
112	BEDROOM NO. 2	13	20 N/A	30	30	40	10'-0"
113	CLOSET	13	20 N/A	30	30	40	10'-0"
114	CLOSET	13	20 N/A	30	30	40	10'-0"
115	HALL	10	20 CLEAR	31	31	40	10'-0"
120	STUDY / GUEST ROOM	15	23 N/A	30/32	30/32	40	9'-0"
203	BATH NO. 3	15	23 N/A	30/32	30/32	40	9'-0"
203	HALL	15	21 CLEAR	30	30	40	9'-0"
204	CLOSET	15	21 CLEAR	30	30	40	9'-0"
209	CLOSET	15	23 N/A	30	30	40	9'-0"

ROOM FINISH KEY

FLOORS	BASE	WALLS	CEILING
1	WOOD FLANK LAMINATE FLOOR	1/2" GYP. BCP. PAINTED SMOOTH FINISH	1/2" GYP. BCP. PAINTED SMOOTH FINISH
2	WOOD B-1	1/2" GYP. BCP. PAINTED SMOOTH FINISH	1/2" GYP. BCP. PAINTED SMOOTH FINISH
3	2" X 2" X 3/8" PORCELAIN TILE	CROWN MOULD AND SKOVIS CYPRESS PANELING	4" F. MOULD AND SKOVIS BIFOLD AND BOARD
4	6" X 6" X 3/8" PORCELAIN TILE	20 PORCELAIN TILE ON CERAMIC TILE BACKER BOARD	30 1/2" TYPED GLASS
5	20" X 20" X 3/8" PORCELAIN TILE	30 1/2" TYPED GLASS	
6	CROWN		

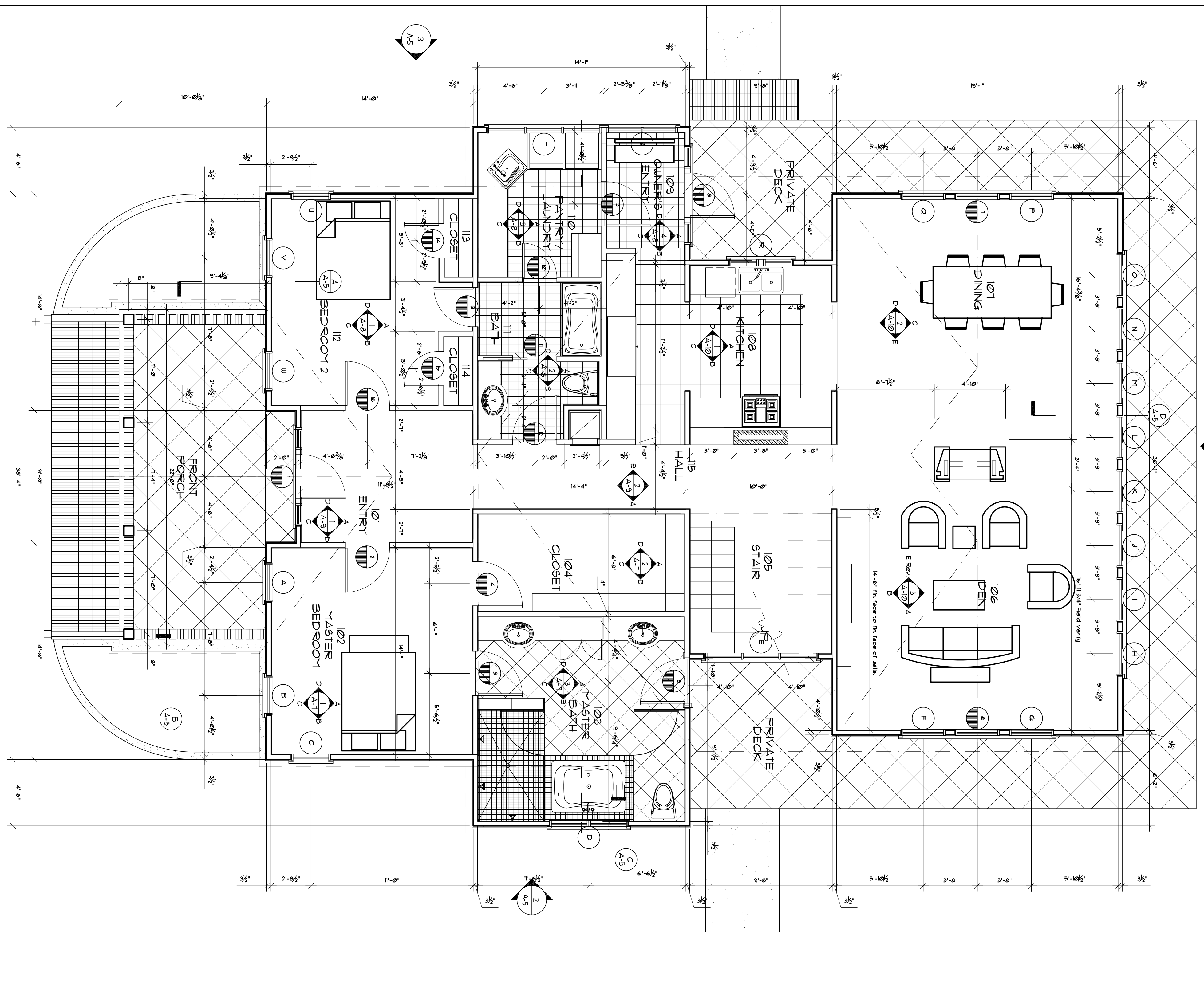

Floor Plan
Scale: 1/4" = 1'-0"
NORTH