

LONGITUDINAL SECTION TOWARDS SIDE WALLS

FOOTING SECTION AT H. H.

FOOTING SECTION A. A.

FOOTING SECTION D. D.

FOOTING SECTION C. C.

FOOTING SECTION D. D.

FOOTING SECTION AT E. E.

FOOTING SECTION AT F. F.

FOOTING SECTION AT G. G.

LONGITUDINAL SECTION THRU CENTER LINE

METHOD OF BENDING BARS IN SLABS

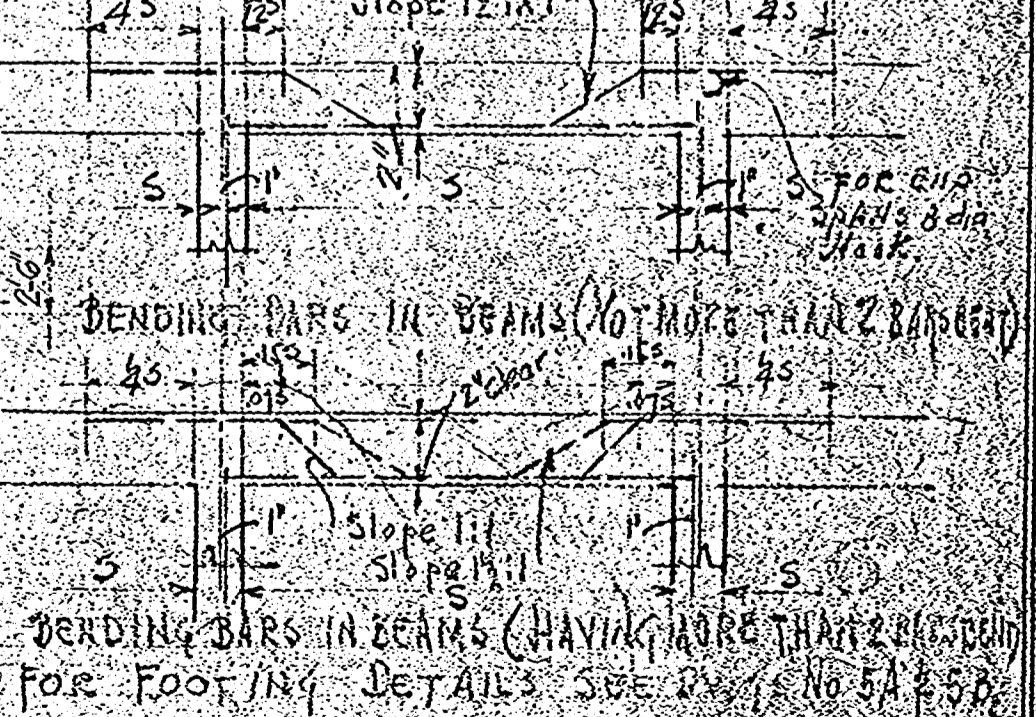

CANAL STREET THEATRE
 FOR
 SAINGER THEATRES, INC.
 CANAL ST. RANDART, IBERVILLE & N. SARATOGA STREETS
 NEW ORLEANS, LA.

REVISED DEC. 10/25
 EMILE WEIL ARCHITECTS
 WHITNEY CENTRAL BUILDING
 NEW ORLEANS, LA.

DATE NOV. 25, 1925