

**GENERAL CONTRACTOR OR
CONSTRUCTION MANAGER NOTE:**
ALL STRUCTURE, DUCTWORK, SPRINKLER PIPING AND
ROOF DRAINS MUST BE COORDINATED WITH SECTION
11064 RIGGING CONTRACTOR. VERIFY ALL REQUIRED
CONDITIONS AND CLEARANCES PRIOR TO INSTALLATION.

THIS DRAWING INDICATES
THEATRE EQUIPMENT
LAYOUT AND DESIGN OF
THEATRE SYSTEMS.
REVIEW BY A QUALIFIED
ENGINEER IS NECESSARY
TO ASSURE SAFETY AND
CODE COMPLIANCE.

REFER TO E-SERIES
DRAWINGS FOR ELECTRICAL
FEEDS, DISCONNECT
SWITCHES, CONDUIT, AND
WIRE FOR ALL RIGGING
EQUIPMENT.
DIVISION 16 CONTRACTOR
SHALL PROVIDE AND
INSTALL ALL ELECTRICAL
EQUIPMENT AND CONTROL
WIRING INDICATED FOR A
COMPLETE AND OPERABLE
SYSTEM.

PRELIMINARY
NOT FOR CONSTRUCTION

**THE SAENGER
THEATRE RENEWAL
PROJECT**

142 North Rampart Street
New Orleans, LA

Client
Saenger Theatre Redevelopment Company
200 West Loop South, Suite
1040 Houston TX 77027

Architect
MARTINEZ+JOHNSON
ARCHITECTURE

1412 Eye St., NW
Washington, DC 20005
202.333.4480

Structural Engineer
Shawn J. Franke, P.E.
549 Heimer Road San
Antonio TX 78232
210.979.7900

Theatre Consultant
Schuler Shook
123 Third Street North #210
Minneapolis, MN 55401
612.339.9958

Acoustical Engineer
Akustiks
93 North Main Street South
Norwalk, CT 06854
202.299.1904

MEP Engineer
JBA Consulting Engineers, Inc.
3525 N. Causeway Blvd. Suite
500 Metairie, LA 70002
504.830.0139

Civil Engineer
Linfield, Hunter, & Junius, Inc.
3608 18th Street Suite 200
Metairie, LA 70002
504.833.5300

Architectural Historian
EHT Traceries, Inc.
1121 Fifth Street NW
Washington, DC 20001
202.393.1199

**THEATRE PLANNERS
LIGHTING DESIGNERS**
Schuler Shook

THESE DRAWINGS, SPECIFICATIONS, AND OTHER
DOCUMENTS, COLLECTIVELY, THE "DOCUMENTS",
INCLUDING WITHOUT LIMITATION ELECTRONIC VERSIONS
THEREOF AND THE IDEAS, DESIGNS, AND
ARRANGEMENTS REPRESENTED THEREIN, ARE AND
SHALL REMAIN THE PROPERTY OF MARTINEZ & JOHNSON
ARCHITECTURE P.C. AS DEFINED BY APPLICABLE
CONTRACTUAL AGREEMENTS ("THE AGREEMENTS") AND
AS PROTECTED BY THE COPYRIGHT STATUTES OF THE
UNITED STATES. USE OF THE DOCUMENTS SHALL BE
STRICTLY LIMITED TO THE PROJECT FOR WHICH THEY
WERE PREPARED AND DEVELOPED ("THE PROJECT")
PER THE TERMS OF THE AGREEMENTS. NO PART OF
THE DOCUMENTS SHALL BE COPIED, DISCLOSED TO
OTHERS, OR USED IN CONNECTION WITH ANY OTHER
WORK OR PROJECT, OR BY ANY OTHER PERSONS FOR
ANY PURPOSES OTHER THAN THE COMPLETION OF THE
PROJECT, WITHOUT THE SPECIFIC WRITTEN
AUTHORIZATION OF MARTINEZ & JOHNSON
ARCHITECTURE P.C. THE DOWNLOADING, OPENING, OR
VIEWING OF ELECTRONIC VERSIONS OF THE
DOCUMENTS OR VISUAL CONTACT WITH ANY PRINTED
FORM THEREOF SHALL CONSTITUTE CONCLUSIVE
EVIDENCE OF ACCEPTANCE OF THESE RESTRICTIONS.

7502

DATE:	No.:	ISSUE:
02.19.10	1	PERMIT SET
04.02.10	2	GMP CONTRACT SET
11.11.10	-	CONTRACT SET

DATE:	No.:	REVISION:

SHEET TITLE:
**THEATRE RIGGING
ADVISORY DETAILS**

TR-0.00

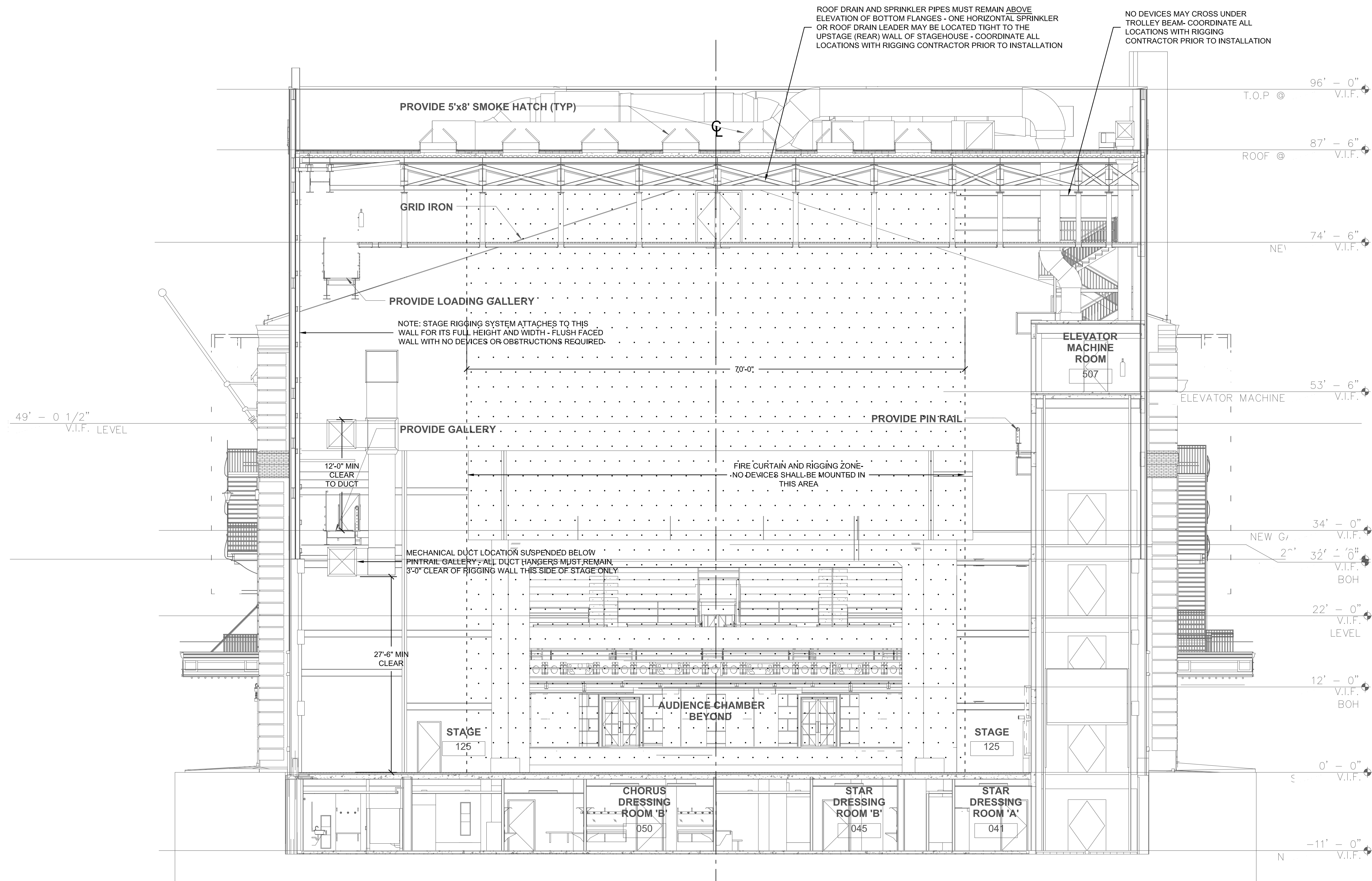

1 THEATRE RIGGING ADVISORY ELEVATION
TR-0.00 SCALE: 3/32" = 1'-0"

GENERAL NOTES:
A. INSTALLATION SHALL CONFORM TO ALL
APPLICABLE NEC, UL, STATE AND LOCAL CODES.
B. STRUCTURAL MEMBERS ARE SHOWN FOR
DESIGN INTENT ONLY.
C. FIELD VERIFY ALL DIMENSIONS AND
MOUNTING CONDITIONS PRIOR TO
INSTALLATION.

KEYED NOTES:
1. NOT USED.