

# ELEVATION CERTIFICATE

**Important:** Follow the instructions on pages 1-9.

Copy all pages of this Elevation Certificate and all attachments for (1) community official, (2) insurance agent/company, and (3) building owner.

SECTION A – PROPERTY INFORMATION					FOR INSURANCE COMPANY USE
A1. Building Owner's Name KENNETH GERARD OTILLIO & MICHELLE EBEIER OTILLIO					Policy Number:
A2. Building Street Address (including Apt., Unit, Suite, and/or Bldg. No.) or P.O. Route and Box No. 425 CARROLL STREET					Company NAIC Number:
City MANDEVILLE		State Louisiana		ZIP Code 70448	
A3. Property Description (Lot and Block Numbers, Tax Parcel Number, Legal Description, etc.) LOT 4-A, TOWN OF MANDEVILLE, SQUARE 34, CITY OF MANDEVILLE					
A4. Building Use (e.g., Residential, Non-Residential, Addition, Accessory, etc.)					RESIDENTIAL
A5. Latitude/Longitude: Lat. N/A		Long. N/A		Horizontal Datum: <input type="checkbox"/> NAD 1927 <input checked="" type="checkbox"/> NAD 1983	
A6. Attach at least 2 photographs of the building if the Certificate is being used to obtain flood insurance.					
A7. Building Diagram Number <u>5</u>					
A8. For a building with a crawlspace or enclosure(s):					
a) Square footage of crawlspace or enclosure(s) <u>0</u> sq ft					
b) Number of permanent flood openings in the crawlspace or enclosure(s) within 1.0 foot above adjacent grade <u>0</u>					
c) Total net area of flood openings in A8.b <u>0</u> sq in					
d) Engineered flood openings? <input type="checkbox"/> Yes <input checked="" type="checkbox"/> No					
A9. For a building with an attached garage:					
a) Square footage of attached garage <u>0</u> sq ft					
b) Number of permanent flood openings in the attached garage within 1.0 foot above adjacent grade <u>0</u>					
c) Total net area of flood openings in A9.b <u>0</u> sq in					
d) Engineered flood openings? <input type="checkbox"/> Yes <input checked="" type="checkbox"/> No					
SECTION B – FLOOD INSURANCE RATE MAP (FIRM) INFORMATION					
B1. NFIP Community Name & Community Number CITY OF MANDEVILLE - LOUISIANA 220202			B2. County Name ST. TAMMANY PARISH		B3. State Louisiana
B4. Map/Panel Number 220202 0427	B5. Suffix D	B6. FIRM Index Date 05/16/2012	B7. FIRM Panel Effective/ Revised Date 05/16/2012	B8. Flood Zone(s) AE	B9. Base Flood Elevation(s) (Zone AO, use Base Flood Depth) 10' **
B10. Indicate the source of the Base Flood Elevation (BFE) data or base flood depth entered in Item B9: <input type="checkbox"/> FIS Profile <input checked="" type="checkbox"/> FIRM <input type="checkbox"/> Community Determined <input type="checkbox"/> Other/Source: _____					
B11. Indicate elevation datum used for BFE in Item B9: <input type="checkbox"/> NGVD 1929 <input checked="" type="checkbox"/> NAVD 1988 <input type="checkbox"/> Other/Source: _____					
B12. Is the building located in a Coastal Barrier Resources System (CBRS) area or Otherwise Protected Area (OPA)? <input type="checkbox"/> Yes <input checked="" type="checkbox"/> No Designation Date: _____ <input type="checkbox"/> CBRS <input type="checkbox"/> OPA					

# ELEVATION CERTIFICATE

OMB No. 1660-0008  
Expiration Date: November 30, 2018

<b>IMPORTANT: In these spaces, copy the corresponding information from Section A.</b>			<b>FOR INSURANCE COMPANY USE</b>
Building Street Address (including Apt., Unit, Suite, and/or Bldg. No.) or P.O. Route and Box No. 425 CARROLL STREET			Policy Number:
City MANDEVILLE	State Louisiana	ZIP Code 70448	Company NAIC Number

## SECTION C – BUILDING ELEVATION INFORMATION (SURVEY REQUIRED)

C1. Building elevations are based on:  Construction Drawings\*  Building Under Construction\*  Finished Construction  
\*A new Elevation Certificate will be required when construction of the building is complete.

C2. Elevations – Zones A1–A30, AE, AH, A (with BFE), VE, V1–V30, V (with BFE), AR, AR/A, AR/AE, AR/A1–A30, AR/AH, AR/AO. Complete Items C2.a–h below according to the building diagram specified in Item A7. In Puerto Rico only, enter meters.

Benchmark Utilized: GPS Vertical Datum: NAVD 1988

Indicate elevation datum used for the elevations in items a) through h) below.

NGVD 1929  NAVD 1988  Other/Source: \_\_\_\_\_

Datum used for building elevations must be the same as that used for the BFE.

Check the measurement used.

- |   |             |  |                                 |
|---|-------------|--|---------------------------------|
| a) Top of bottom floor (including basement, crawlspace, or enclosure floor)   | <u>12.5</u> | <input checked="" type="checkbox"/> feet | <input type="checkbox"/> meters |
| b) Top of the next higher floor   | <u>N/A</u>  | <input checked="" type="checkbox"/> feet | <input type="checkbox"/> meters |
| c) Bottom of the lowest horizontal structural member (V Zones only)   | <u>N/A</u>  | <input checked="" type="checkbox"/> feet | <input type="checkbox"/> meters |
| d) Attached garage (top of slab)  | <u>N/A</u>  | <input checked="" type="checkbox"/> feet | <input type="checkbox"/> meters |
| e) Lowest elevation of machinery or equipment servicing the building<br>(Describe type of equipment and location in Comments) | <u>N/A</u>  | <input checked="" type="checkbox"/> feet | <input type="checkbox"/> meters |
| f) Lowest adjacent (finished) grade next to building (LAG)  | <u>3.4</u>  | <input checked="" type="checkbox"/> feet | <input type="checkbox"/> meters |
| g) Highest adjacent (finished) grade next to building (HAG)   | <u>6.2</u>  | <input checked="" type="checkbox"/> feet | <input type="checkbox"/> meters |
| h) Lowest adjacent grade at lowest elevation of deck or stairs, including structural support                                  | <u>N/A</u>  | <input checked="" type="checkbox"/> feet | <input type="checkbox"/> meters |

## SECTION D – SURVEYOR, ENGINEER, OR ARCHITECT CERTIFICATION

This certification is to be signed and sealed by a land surveyor, engineer, or architect authorized by law to certify elevation information. I certify that the information on this Certificate represents my best efforts to interpret the data available. I understand that any false statement may be punishable by fine or imprisonment under 18 U.S. Code, Section 1001.

Were latitude and longitude in Section A provided by a licensed land surveyor?  Yes  No  Check here if attachments.

Certifier's Name  
JOHN E. BONNEAU

License Number  
4423

Title  
PROFESSIONAL LAND SURVEYOR

Company Name  
JOHN E. BONNEAU & ASSOCIATES, INC.

Address  
1011 NORTH CAUSEWAY BLVD., SUITE 34

City  
MANDEVILLE

State  
Louisiana

ZIP Code  
70471

Signature  

Date  
03/26/2019

Telephone  
(985) 845-1012

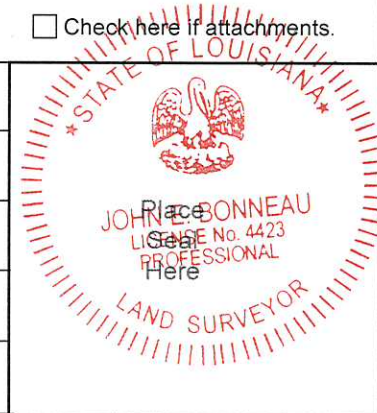

Copy all pages of this Elevation Certificate and all attachments for (1) community official, (2) insurance agent/company, and (3) building owner.

Comments (including type of equipment and location, per C2(e), if applicable)

NOTE: ELEVATIONS SHOWN IN SECTION C WERE DERIVED USING GPS EQUIPMENT IN WHICH DATA COLLECTED WAS SENT TO WWW.NGS.NOAA.GOV/OPUS/ FOR CALCULATIONS. UNDERSIGNED DOES NOT CERTIFY TO CALCULATED RESULTS OBTAINED FROM "OPUS". NOTE: ELEVATIONS ON THIS CERTIFICATE ARE ONLY GOOD FOR THE DATE SHOWN.

NOTE: C.B.M. IS A PAINT DOT AT CENTER LINE OF STREET IN FRONT OF LOT, ELEV.= 4.75'.

NOTE: ITEM B9 IS 10'+2'=12' AS PER THE CITY OF MANDEVILLE.



LAFITTE ST. (SIDE)

NOT A PART

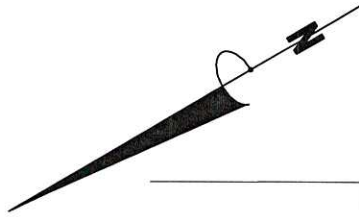

MONROE ST.

JEFFERSON ST. (SIDE)

LOT 3-A

"SQ."

"34"

5.5'



LOT 4-A

LOT 5-A

LOT 7A-1

LOT 6-A

S60°03'51"E 166.68'

166.95'

N60°03'50"W

S30°03'26"W

74.50'

\*6.2' \*6.2' \*5.8'

\*6.2' \*6.1'

\*6.0' \*4.9'

\*4.5' \*4.0'

\*3.6'

1.2' \*4.4' \*4.5' \*4.0' \*3.4'

N30°15'43"E 74.50'

\*4.9' E.O.A. \*4.7' 5.0' (S)

\*4.9' \*4.75' (P.D.) \*4.9'

- ⊙ = SEWER MANHOLE
- ⊗ = POWER POLE
- = 3/4" IRON PIPE FOUND
- = FENCE POST FOUND

COPYRIGHT © 2019  
ALL RIGHTS RESERVED  
JOHN E. BONNEAU & ASSOCIATES, INC.

#425 CARROLL ST.

**BUILDING SETBACKS:**

FRONT: N/A  
SIDE: N/A  
SIDE STREET: N/A  
REAR: N/A

**REFERENCE SURVEY:**

The recorded subdivision map.

**BASIS FOR BEARINGS:**

The Reference survey.

**FLOODZONE NOTE:** This is to certify that I have consulted the Federal Insurance Administration Flood Hazard Boundary Maps and found the property described is located in Flood Zone(s) "AE" with a Base Flood Elevation of 10'+2'=12' in accordance with Community Panel No. 2202020427D ; Revised: MAY 16, 2012

**NOTE:** Setback lines shall be verified by owner or contractor prior to any construction, as an abstract has not been performed by the undersigned.

**NOTE:** Servitudes shown hereon are not necessarily exclusive. Servitudes of record as shown on title opinion or title policy will be added hereto upon request, as surveyor has not performed any title search or abstract.

**NOTE:** This is to certify that I have done an actual ground survey and found that no encroachments exist either way across any property lines except as shown.

THIS IS TO CERTIFY THAT THIS SURVEY WAS DONE UNDER MY DIRECT SUPERVISION AND CONTROL; AND THAT THE SURVEY WAS DONE ON THE GROUND AND IS IN ACCORDANCE WITH THE "STANDARDS OF PRACTICE FOR BOUNDARY SURVEYS" AS ADOPTED BY THE STATE OF LOUISIANA, BOARD OF REGISTRATION FOR PROFESSIONAL ENGINEERS AND LAND SURVEYORS FOR A CLASS C SURVEY.

SURVEY MAP OF

LOT 4-A, TOWN OF MANDEVILLE, SQUARE 34,

located in

City of Mandeville,

in

St. Tammany Parish, Louisiana,

for

KENNETH GERARD OTILLO & MICHELLE EBELER OTILLO

Survey No. 2019 142

Drawn by: JCW

Scale: 1" = 30'

Date: MARCH 26, 2019

Revised:

This Survey is Certified True and Correct By

JOHN E. BONNEAU & ASSOCIATES, INC.

Professional Land Surveyors • Planners and Consultants

1011 NORTH CAUSEWAY BLVD. • SUITE 34 • MANDEVILLE, LA 70471

(985)845-1012 • (985)845-1013 • FAX NO. (985)845-1778

www.JEBCOLandSurveying.com • e-mail: info@jebcosurvey.com

