

# CONSTRUCTION NOTES

1. THE STRUCTURAL PLANS, TO THE BEST OF OUR KNOWLEDGE, COMPLY WITH THE APPLICABLE REQUIREMENTS OF THE INTERNATIONAL RESIDENTIAL CODE 2015 WITH STATE OF LOUISIANA AMENDMENTS.
2. THE CONTRACTOR SHALL COMPLY WITH THE REQUIREMENTS OF THE INTERNATIONAL RESIDENTIAL CODE 2015 WITH STATE OF LOUISIANA AMENDMENTS AND ALL APPLICABLE FEDERAL AND STATE CODES, STANDARDS, REGULATIONS AND LAWS.
3. THE CONTRACTOR SHALL FIELD VERIFY ALL DIMENSIONS.
4. THE CONTRACTOR SHALL PROTECT EXISTING FACILITIES, STRUCTURES AND UTILITY LINES FROM ALL DAMAGE.
5. JOB SAFETY AND CONSTRUCTION PROCEDURES ARE THE RESPONSIBILITY OF THE CONTRACTOR.
6. THE STRUCTURAL SUPPORT HAVE BEEN DESIGNED USING THE FOLLOWING LOADS:

RESIDENTIAL LIVE LOADS: 40 PSF  
 ATTIC LIVE LOADS: 20 PSF  
 ROOF LIVE LOADS: 20 PSF  
 WIND LOADS: 23 PSF

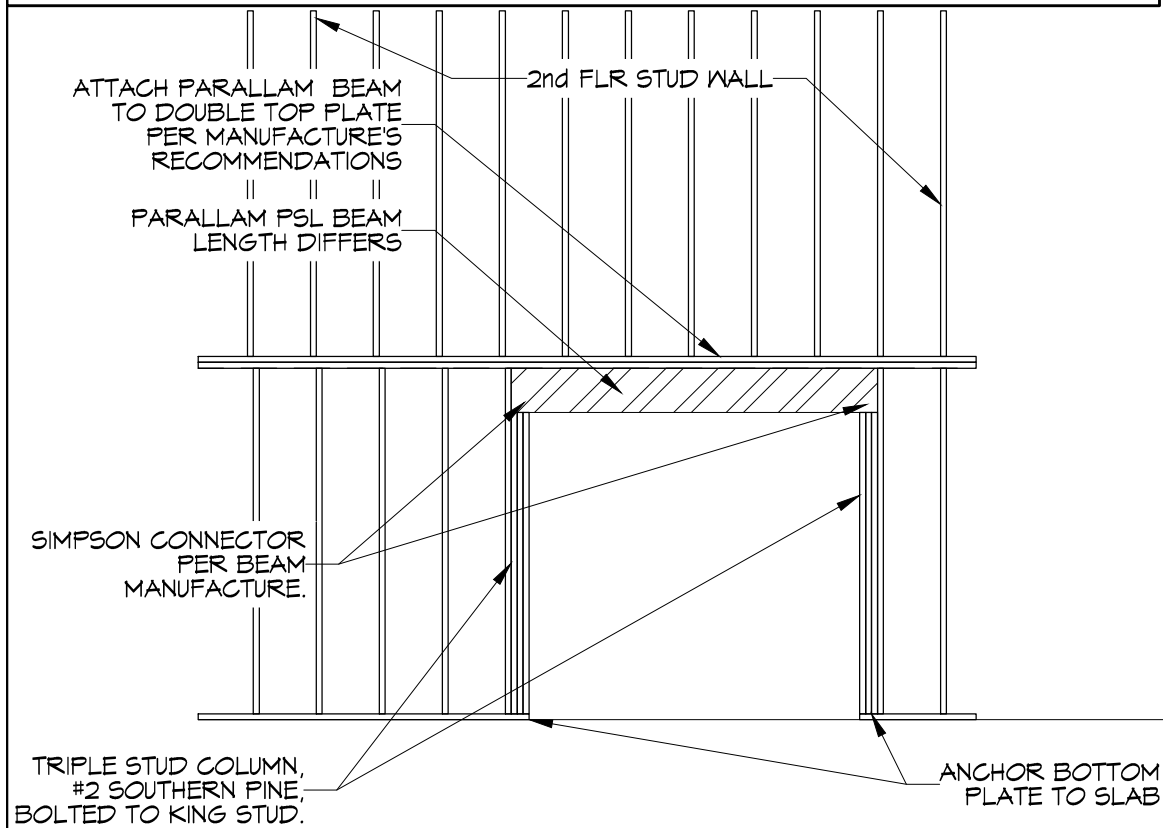

**A** **HEADER ELEVATION**  
 S101/S101 SCALE: N.T.S. STRUCTURAL HEADER

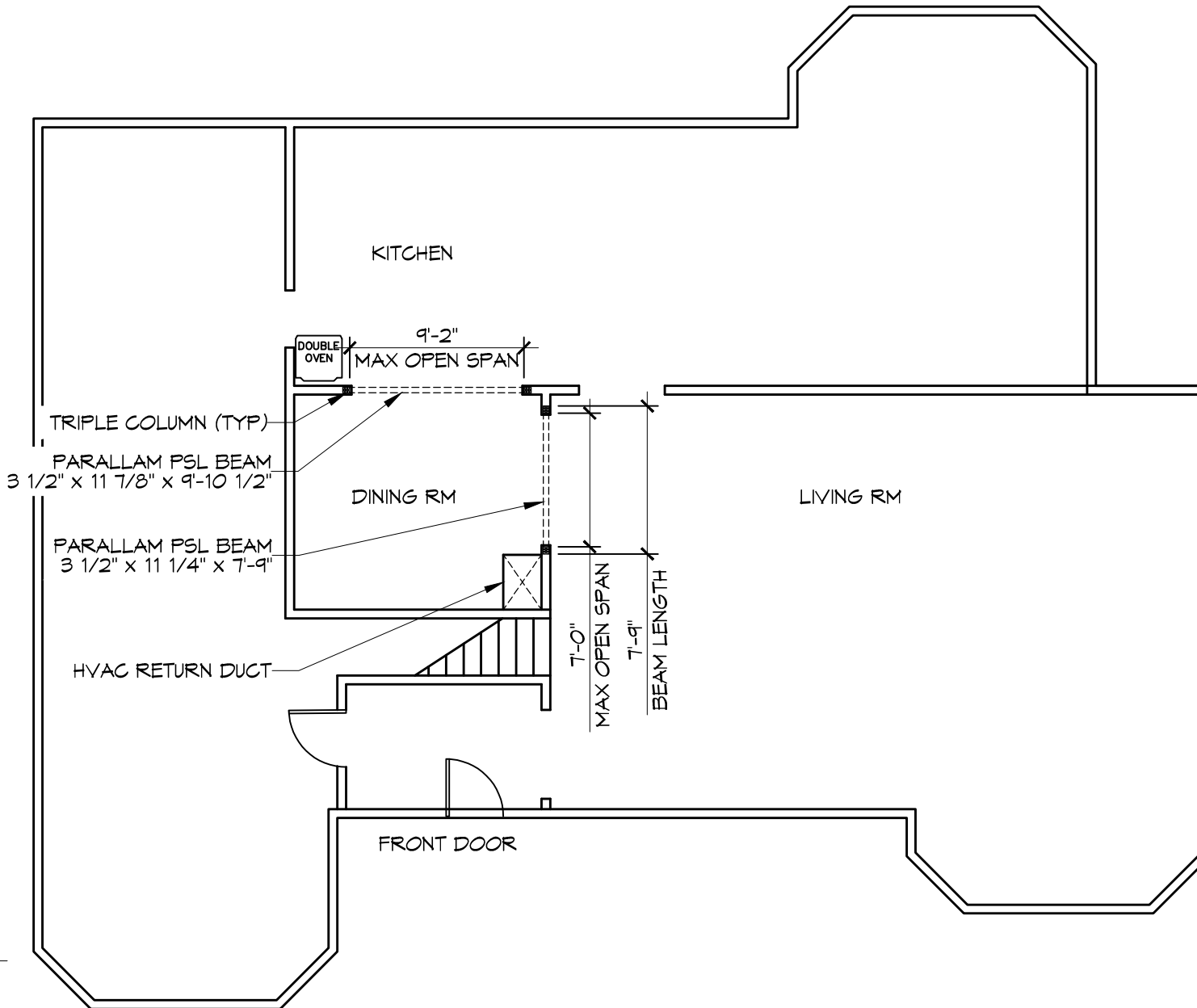

**1** **PLAN VIEW**  
 S101/S101 SCALE: N.T.S. STRUCTURAL HEADER



554 Old Spanish Trail Slidell, LA 70458 (985) 649-5832  
 dammonengineering.com  
 info@dammonengineering.com  
 PHONE: 985-649-5832  
 CHIEF ENGINEER: BRIAN A. MISTICH, P.E.  
 554 OLD SPANISH TRAIL  
 SLIDELL, LA 70458

STRUCTURAL SUPPORT BEAMS

**JENNY GREMILLION**  
 115 GOLPHERS DRIVE  
 COVINGTON LA

JOB #: 2378 DATE: 4/16/2019

DRAWN BY: DD

S101