

FILE NAME: J:\Projects\24 Cabirac\24 Cabirac\24 Cabirac.dwg DATE: 11/15/2025 10:53:11 AM

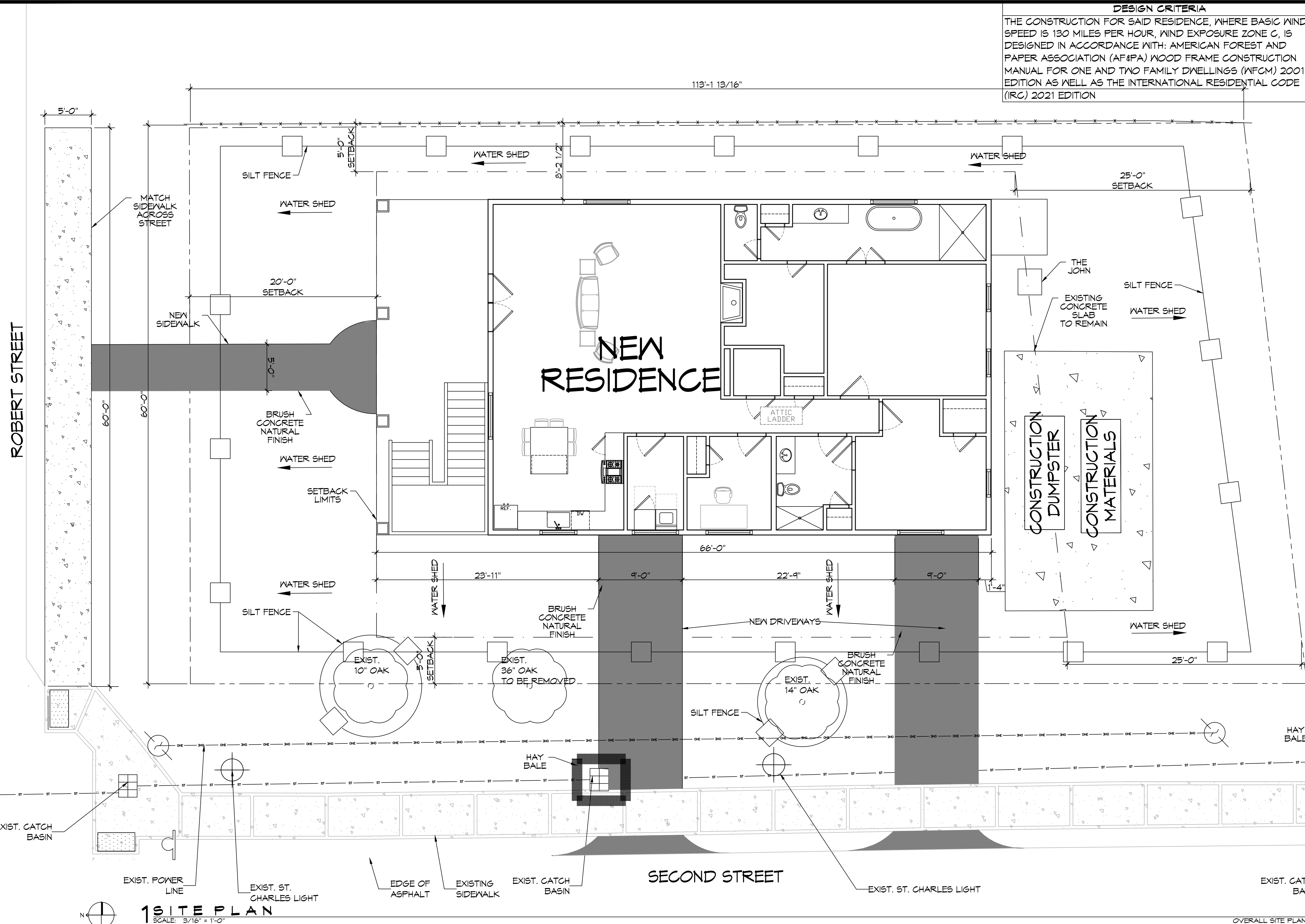

DESIGN CRITERIA
THE CONSTRUCTION FOR SAID RESIDENCE, WHERE BASIC WIND SPEED IS 130 MILES PER HOUR, WIND EXPOSURE ZONE C, IS DESIGNED IN ACCORDANCE WITH: AMERICAN FOREST AND PAPER ASSOCIATION (AF&PA) WOOD FRAME CONSTRUCTION MANUAL FOR ONE AND TWO FAMILY DWELLINGS (WFCM) 2001 EDITION AS WELL AS THE INTERNATIONAL RESIDENTIAL CODE (IRC) 2021 EDITION

PLANNING
ZONED C3 DISTRICT
FLOOD ZONE
ZONE "AE"
BUILDING ELEVATION
BASE FLOOD ELEVATION "AE" = 11.0' FINISHED FLOOR ELEVATION = 13.0'
SETBACK LIMITS
FRONT - 20 FT. SIDES - 20% LOT WIDTH WITH 5FT. MINIMUM REAR - 20% LOT DEPTH WITH 25FT. MINIMUM AND 50FT. MAX
LEGEND
--- PROPERTY LINE - - - SETBACK LINE --- STORMDRAIN LINE --- POWER LINE --- FENCE LINE

SHEET INDEX	
SHEET #	SHEET TITLE
C101	SITE PLAN
A101	FLOOR PLAN
A102	GROUND FLOOR PLAN
A103	ELEVATION PLAN
A104	INTERIOR ELEVATION PLAN
S101	FOUNDATION PLAN
S102	FRAMING PLAN
S103	TYPICAL CONNECTION DETAILS

DAMMON ENGINEERING, INC.
LOUISIANA & MISSISSIPPI

Chief Engineer: Brian Mistich, PE
www.dammonengineering.com
info@dammonengineering.com
554 Old Spanish Trail
Sibley, LA 70468
PH: 985.649.9332

#	DESCRIPTION	DATE



1 SITE PLAN
SCALE: 3/16" = 1'-0"

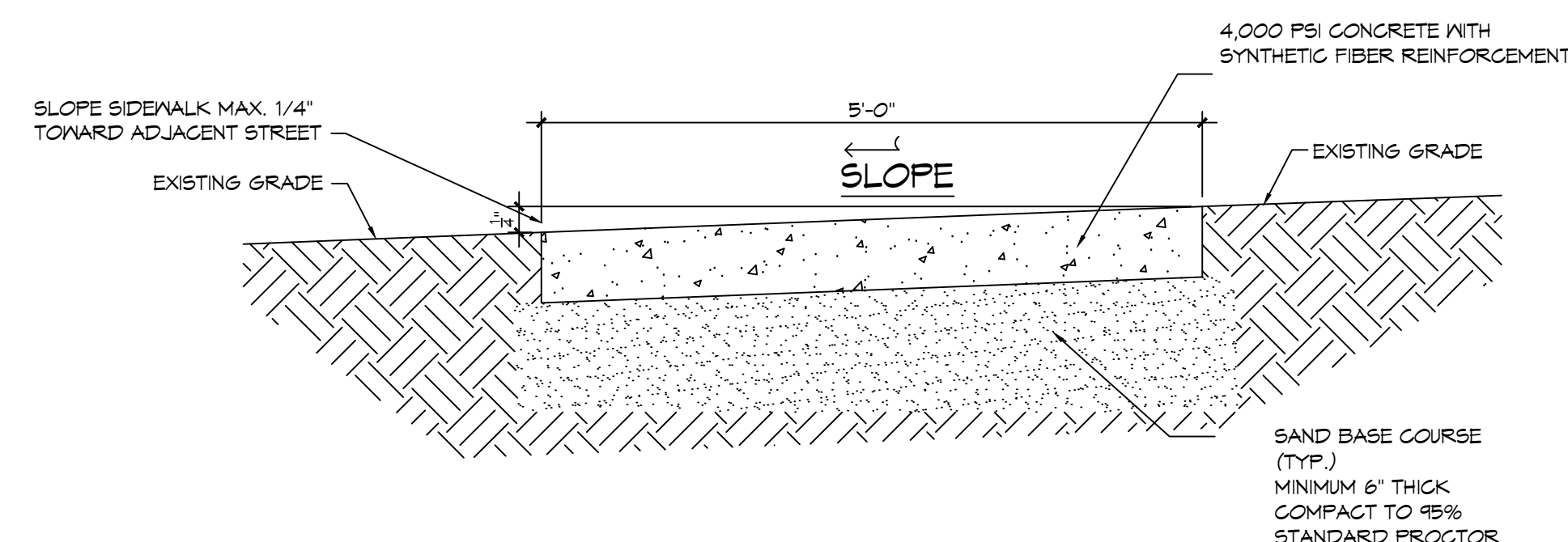

2 TYPICAL SIDEWALK DETAILS
SCALE: N.T.S.

SIDEWALK NOTES

CONCRETE MIX DESIGN
MIX FOR ONE CUBIC YARD OF FIBER-REINFORCED CONCRETE

28 DAY STRENGTH	4,000 PSI
CEMENT (ASTM C-150, TYPE I/II)	4.64 SACKS (436 LBS.)
FLY ASH (ASTM C-618)	1.16 SACKS (109 LBS.)
GRAVEL (ASTM C-33, GRADE A)	1175 LBS.
SAND (ASTM C-33)	1226 LBS.
WATER (POTABLE)	30 GALLONS (250 LBS.) TYPE A WATER REDUCER (ASTM C-494)
16.35 LBS.	
AIR ENTRAINMENT	5% BY VOLUME, USE PER MANUFACTURER'S SPECS.
FIBER REINFORCEMENT SPECIFIED BELOW	1.5 LBS./CY MICROFIBERS, AS

FIBER REINFORCEMENT FOR ALL CONCRETE SIDEWALKS AND DRIVEWAYS SHALL BE MATRIX MONOFILAMENT MICROFIBER AS MANUFACTURED BY FRG INDUSTRIES OR APPROVED EQUAL, APPLIED THROUGHOUT THE CONCRETE MIXTURE WITH 6X6 WELDED WIRE FABRIC. ALTERNATE PRODUCTS MUST BE PREAPPROVED BY THE CITY ENGINEER IN WRITING. CELLULOSE (TREATED OR UNTREATED), AR GLASS, NYLON AND POLYESTER FIBERS ARE SPECIFICALLY PROHIBITED FROM USE.

BRETT CABIRAC

LOT 5 SQUARE 24
ROBERT STREET
SILPELL, LA 70469

JOB No: 11-15-2025
DATE: 11-15-2025
DRAWN BY: BAW
CHECKED BY: C&D

SHEET TITLE:
SITE PLAN

DRAWING NUMBER:
C101

SHEET No: 1 of 2