

SPECIFICATIONS

1. BEARING SOIL TYPE Native
2. FOOTINGS see Foundation Plan
3. REINFORCING see Foundation Plan
4. WATERPROOFING see Foundation Plan
5. TERMITE PROOFING see Foundation Plan
6. CABLE FOUNDATION see Foundation Plan
7. FIREPLACE
8. FIREPLACE FACING
9. FIREPLACE MANTLE
10. EXTERIOR WALLS Const. Grade sup Studs
11. CORNER BRACING 15/32 OSB
12. SHEATHING 1/2" Dow Board
13. STUCCO
14. MASONRY VENEER
15. SIDING
16. DOOR SILLS
17. EXTERIOR PAINT 1 base coat 2 top coats
18. GABLE WALLS same as main walls
19. FLOOR JOISTS
20. BRIDGING Solid
21. FLOORS - FIRST
22. FLOORS - SECOND
23. ATTIC 5/8" CDX Ply
24. FINISH WOOD FLOORS - ROOMS
25. INTERIOR PAINT 2 coats latex
26. PARTITION FRAMING Const. Grade 2x4 @ 16"
27. CEILING FRAMING #2 SYP see plan
28. ROOF SHEATHING 1/2" OSB
29. ROOF UNDERLAY 30# Felt
30. ROOFING Shingles
31. GUTTERS AND DOWNSPOUTS
32. DRYWALL CEILINGS 1/2" Sheetrock - Orange Peel
33. DRYWALL WALLS 1/2" Sheetrock - Orange Peel
34. GARAGE CEILING Blown Acoustic
35. WALLPAPER
36. INTERIOR DOORS Raised Panel Masonite
37. INTERIOR TRIM Molded 3 1/2"
38. INTERIOR BASE 4 1/2" & 5 1/2"
39. WINDOWS Vinyl Insulated SH
40. SPECIAL WINDOWS
41. ENTRANCE DOORS Allow \$ w/frame
42. GARAGE DOOR
43. FACTORY CABINETS Aristocraft or equal
44. FACTORY VANITIES
45. COUNTERTOPS Granite
46. COUNTERTOP EDGING Granite
47. COLUMNS see plan
48. ROOF VENTILATION SUPPLY Cont. Ridge Vent
49. ATTIC STAIRS Wood
50. MAIN STAIRS Wood
51. MAIN STAIR RAIL Wood
52. MAIN STAIR BALUSTER Wood
53. VINYL FLOOR N/A
54. CARPET FLOORS allow \$ per yard
55. CERAMIC FLOORS allow \$ per yard
56. WOOD FLOORS allow \$ per foot
57. PLUMBING
58. PLUMBING - KITCHEN SINK Elger or equal
59. PLUMBING - LAVATORIES
60. PLUMBING - WATER CLOSETS 3 - standard 1 - ADA
61. PLUMBING - BATHTUBS 1 - standard 1 - jetted
62. PLUMBING - SHOWER 1 - ADA
63. PLUMBING - LAUNDRY TUB
64. PLUMBING - FAUCETS Delta Chrome/Brass
65. WATER SUPPLY Public
66. SEWERAGE Public
67. WATER HEATING Rudd or equal 52 Gal.
68. HEATING SYSTEM Forced Air
69. AIR CONDITIONING SYSTEM Forced Air
70. VENTILATION EQUIPMENT HVL in Baths
71. ELECTRIC WIRING SERVICE Circuit Breaker
72. DOOR BELL LOCATION Front
73. INSULATION - CEILINGS R-30 FLOORS R-13
74. INSULATION - WALLS R-13
75. HARDWARE Quickset or equal \$ allowance
76. SHELVING Wire Coated
77. SMOKE DETECTORS & CMM Install per code
78. DISHWASHER
79. GARBAGE DISPOSER
80. RANGE
81. MICROWAVE
82. OTHER APPLIANCES
83. APPLIANCE ALLOWANCE \$
84. PHONE AND CABLE OUTLETS Locate by Owner
85. MIRRORS Standard Cut
86. GARAGE/CARPORT Brush Conc. Finish
87. WALK WIDTH AND MATERIAL 2' - 4" Conc.
88. DRIVE WIDTH AND MATERIAL see plan Conc.
89. OTHER IMPROVEMENTS
90. LANDSCAPING ALLOWANCE \$
91. SOD
92. OTHER INFORMATION
93. OTHER INFORMATION
94. OTHER INFORMATION
95. OTHER INFORMATION
96. SIGNATURE - OWNER

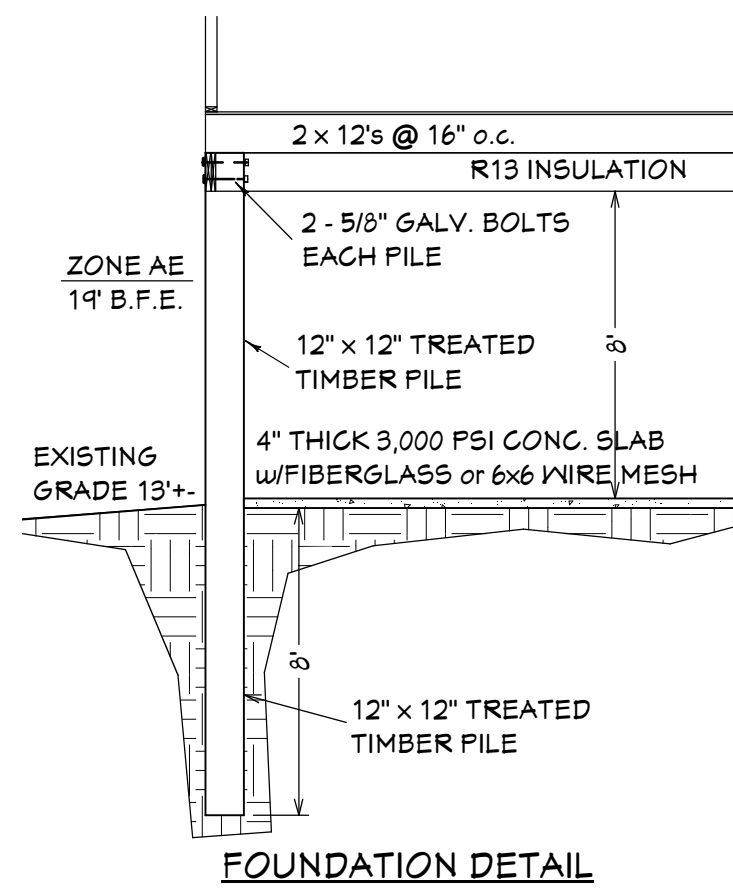

TREATED TIMBER PILE NOTES

1. Treated timber piles shall conform to A.S.T.M. Specifications D-25. Piling shall be treated in accordance to Federal Specs TT-W-571. Preservative retention shall be 0.8 lbs./cu ft.
2. Drive piles with a Pile Master 24-900 or equal providing: Ram weight of 900 lbs: Hammer weight of 2500 lbs: Energy rating minimum 450 ft. lbs, max 1800 ft. lbs. blows per minimum 15-72.
3. Discontinue driving at refusal (>25 blows per foot) Minimum pile bearing capacity 15 kips: 8' minimum embedment. Pile driven to verify pile capacity and blow counts during pile driving operations.
4. Drive piling to within 12" of the final elevation or refusal. Cut off but at required elevation. Seal butts with three coats copper naphthenate.

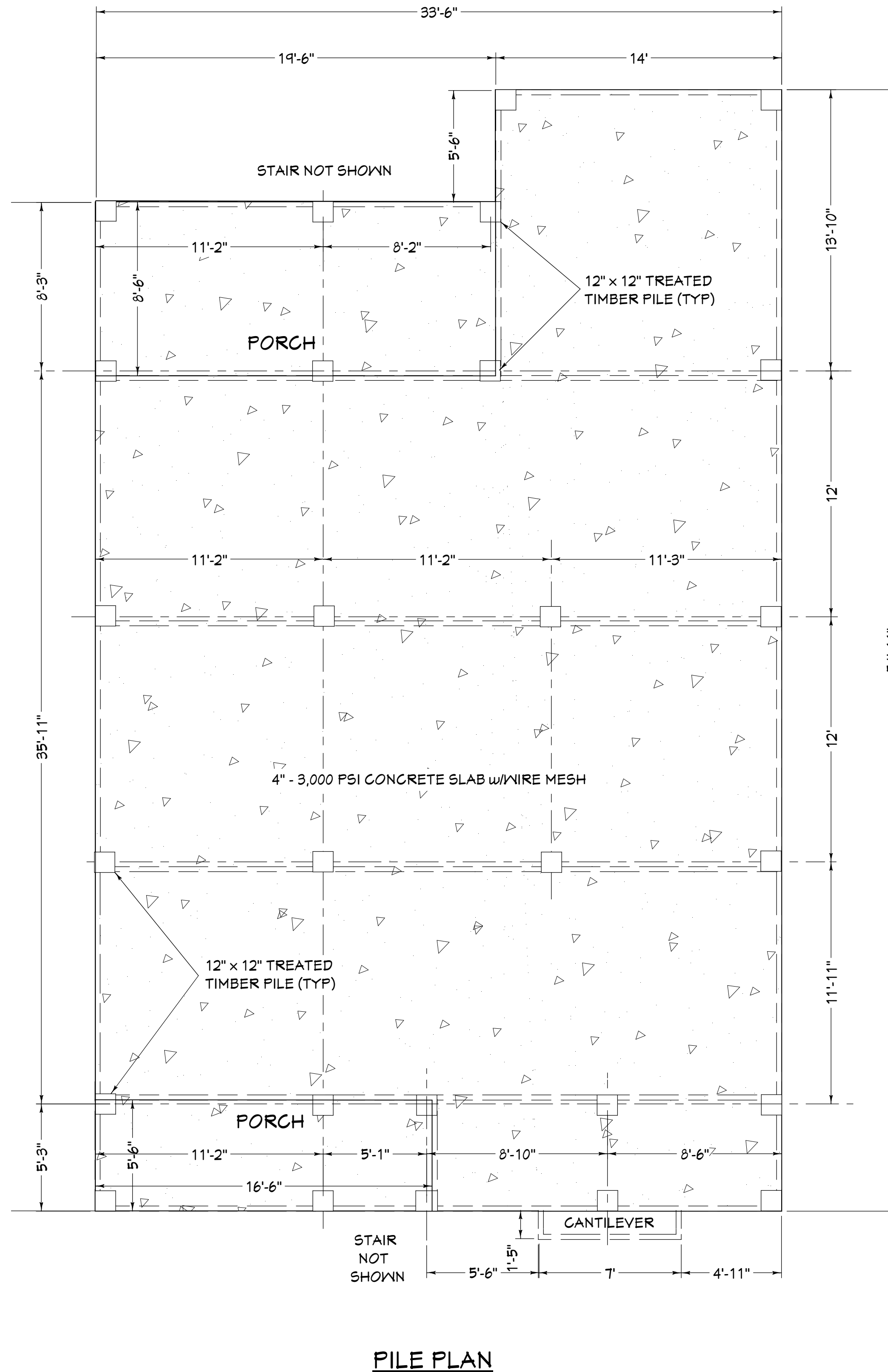

FILE PLAN

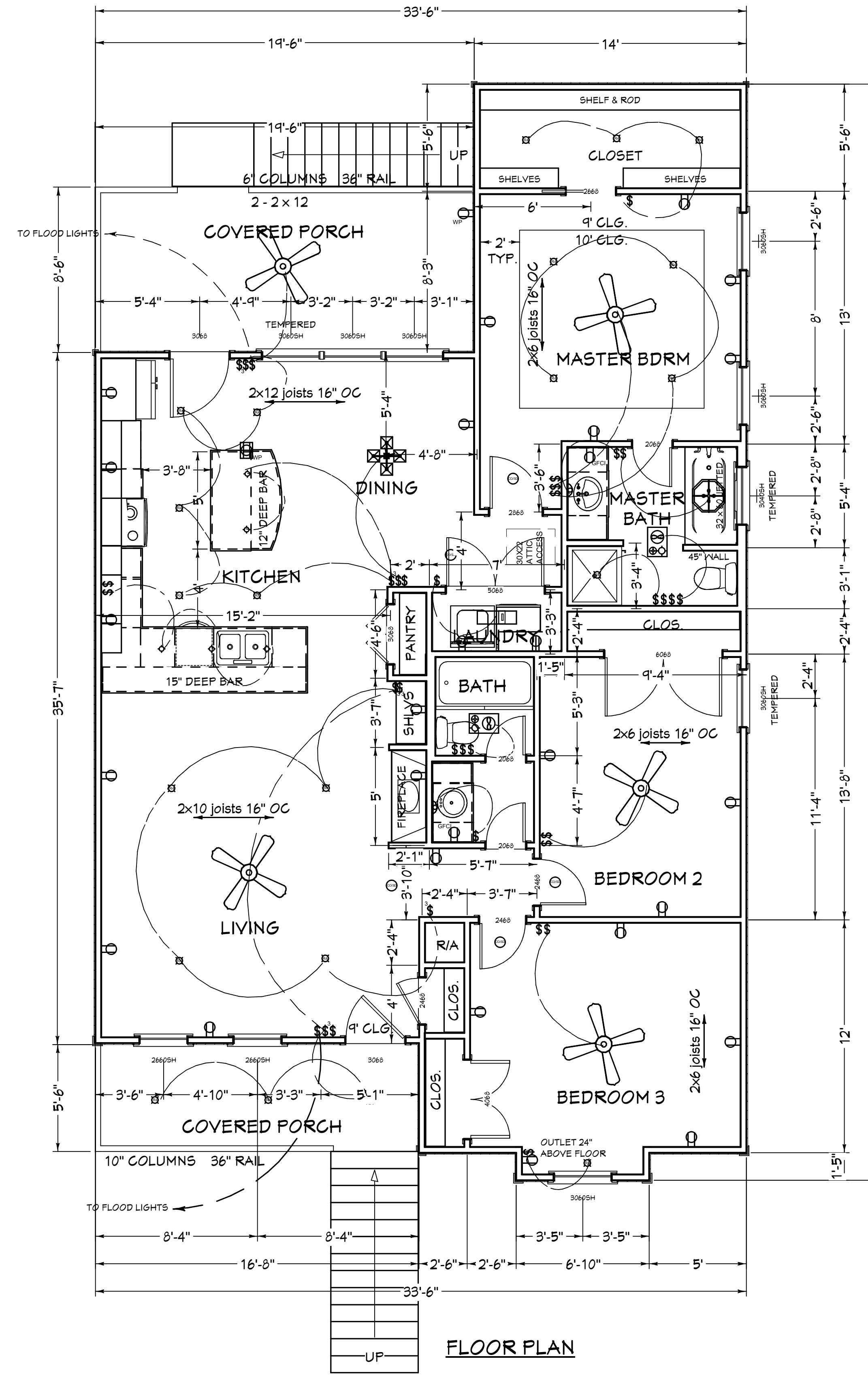

FLOOR PLAN

ELECTRICAL - DATA - AUDIO LEGEND

SYMBOL	DESCRIPTION
[Symbol]	Living Fan
[Symbol]	Refrigerator Fan, Ceiling Mounted, Wall Mounted
[Symbol]	Ceiling Mounted Light Fixture, Subsurface, Recessed, Drop Ceiling, Low Voltage
[Symbol]	Recessed Light Fixture, Wall Mounted, Wall Scribe
[Symbol]	Recessed Light Fixture
[Symbol]	Recessed Light Fixture
[Symbol]	100 Watt Incandescent, Quartz, Weather Proof, GFI
[Symbol]	Recessed Single Pole, Weather Proof, 3-Way, 4-Way
[Symbol]	Recessed Double, Triple
[Symbol]	Auto Meter Control Panel, Switch
[Symbol]	Recessed Ceiling Mounted, Wall Mounted
[Symbol]	Wall Joints, GFI's, GFI's - TV, TV/Games
[Symbol]	Recessed Jack
[Symbol]	Recessed
[Symbol]	Recessed
[Symbol]	Door Open, Door Bell Station
[Symbol]	Shower Enclosure, Ceiling Mounted, Wall Mounted
[Symbol]	Electrical Breaker Panel

DESIGN CRITERIA:
INTERNATIONAL RESIDENTIAL
CODE 2015 FOR ONE AND TWO
FAMILY DWELLINGS, WIND
SPEED 130 MPH, EXPOSURE B

-DESIGN ASSOCIATES-
ROBERT SOLLBERGER, ARCHITECT
905.643.4364
CHRISTAL DRESSEL KILGORE, DESIGNER
905.643.0577

Living Area 1485 sq. ft.
Porches 262 sq. ft.
Total Under Beam 1747 sq. ft.

PLANS FOR
FRED RICHARDSON
FINK STREET
PARCEL 2 @ ROBERTS STREET
MAYLAND, MS

REVISIONS

SCALE: 1/4" = 1'-0"
DATE: 12-6-2022
JOB NO:

SPECS, CABINETS,
FOUNDATION &
FLOOR PLANS

SHEET NO.