

**A**  
SECTION  
SCALE: 1/4" = 1'-0"

FRAMING

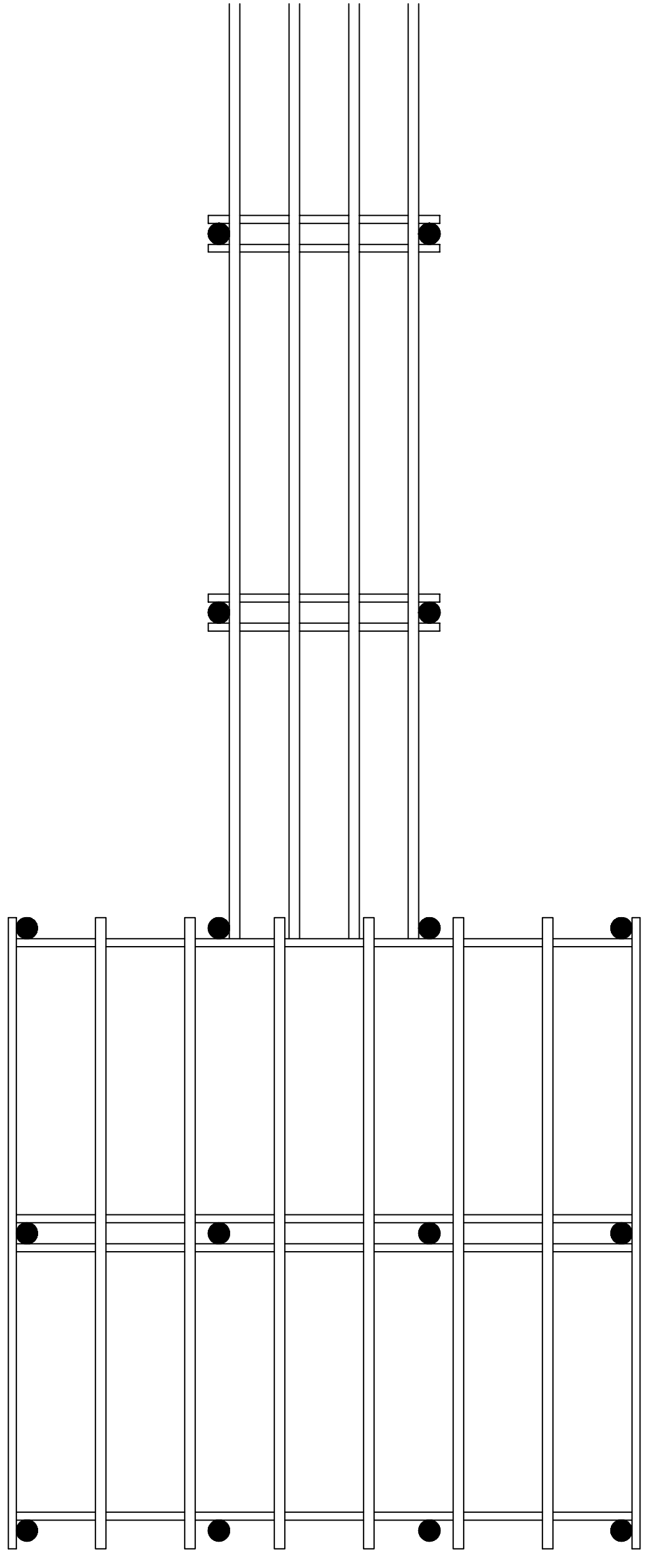

**1**  
WALKWAY AND UPPER DECK  
SCALE: 1/4" = 1'-0"

FRAMING

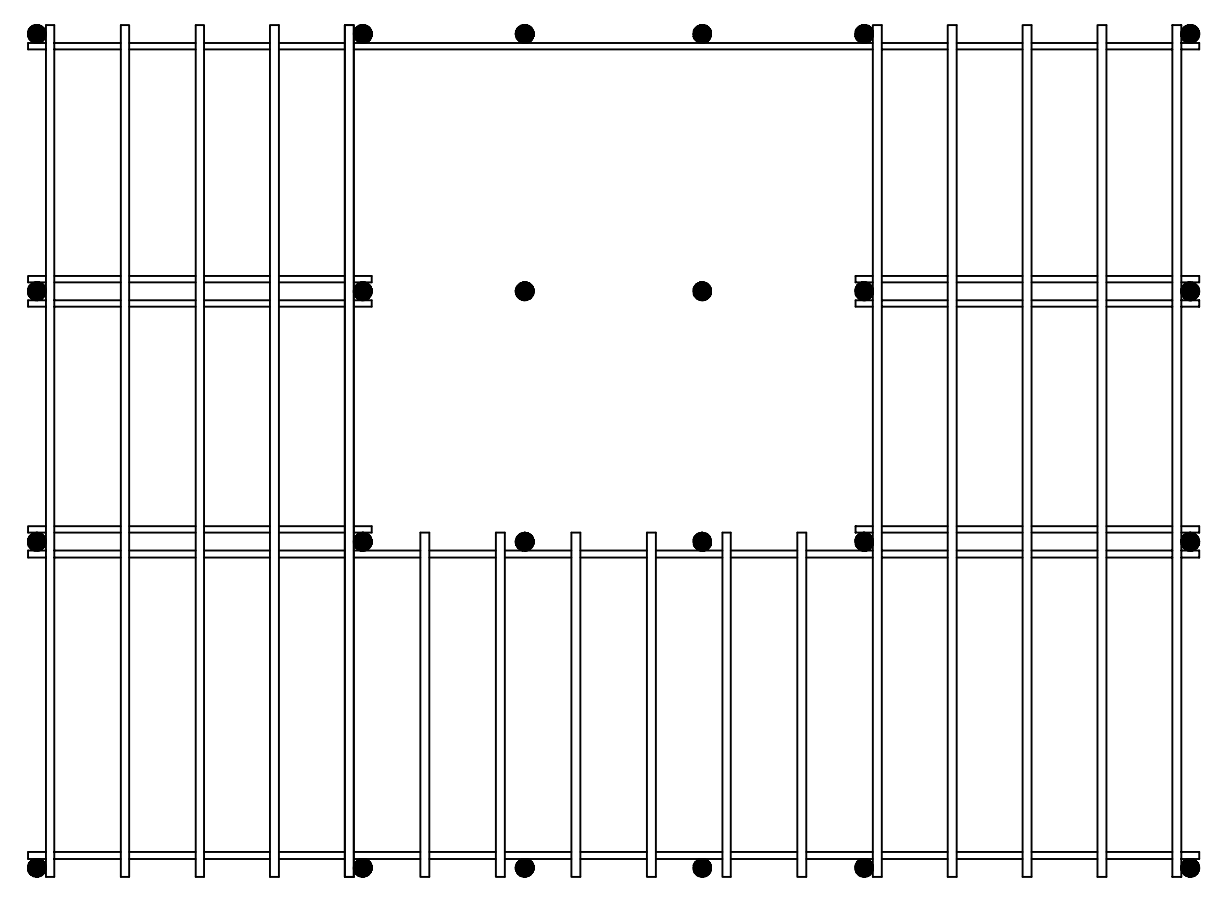

**1**  
LOWER DECK  
SCALE: 1/4" = 1'-0"

FRAMING

**PILING NOTES**

1. PILES ARE TO BE CLASS B PRESSURE TREATED 50 FT. IN LENGTH WITH A 6 INCH TIP AND 12" BUTT AND CLASS 5 PRESSURE TREATED TIMBERS SHALL BE 6 INCH TIP AND 8 INCH BUTT.
2. ALL PILES SHALL BE DRIVEN TO REFUSAL.
3. CONTRACTOR SHALL DRIVE TEST PILE.
4. NO FIELD SUPERVISION OR INSPECTION PROVIDED UNDER THIS SEAL UNLESS OTHERWISE NOTED.
5. PILE LOADS MAY BE MODIFIED DUE TO ACTUAL DRIVING CONDITIONS.
6. PILES ON CENTERLINE OF ALL PILES TO BE SUBMITTED TO THE ENGINEER OF RECORD. FAILURE TO SUBMIT SAID LOGS WILL RELEASE THE ENGINEER OF ALL RESPONSIBILITY AFTER 5 DAYS OF INSTALLING.

**GENERAL NOTES**

1. ALL LUMBER SHALL BE PRESSURE TREATED WITH A RETENTION OF 4 PER C.F.
2. ALL FASTENERS SHALL BE HOT DIPPED GALVANIZED (HDS) PER ASTM A153.
3. ALL CONNECTORS SHALL BE HDG PER ASTM A653, CLASS 6185 SHEET WITH 125 OZ/FT<sup>2</sup> ZINC COATING.
4. DISTANCE FROM VEAN SEA LEVEL TO RIDGE OF BOATHOUSE ROOF NOT TO EXCEED 22'-0".



554 Old Spanish Trail  
Slidell, LA 70458  
PH: 985.649.5832

www.dammonengineering.com  
info@dammonengineering.com  
Fax: 985.641.5950

REVISIONS		DATE
#	DESCRIPTION	



NEW BOAT HOUSE AND PIER FOR;  
**M CUBED PROPERTIES**  
429 CARR DRIVE  
SLIDELL, LA 70458  
JOB No: 2343 DATE: 02-21-18  
DRAWN BY: CKD CHECKED BY: BAM

SHEET TITLE:  
BOAT HOUSE FRAMING  
PLAN

DRAWING NUMBER:

**S101**