

- ### PILING NOTES
- ALL PILES SHALL BE CLASS 5 PRESSURE TREATED 6 INCH TIP AND 8 INCH BUTT.
30' PILES FOR WALKWAY
40' PILES FOR COVERED PIER
 - ALL PILES SHALL BE DRIVEN TO REFUSAL.
 - CONTRACTOR SHALL DRIVE TEST PILE.
 - NO FIELD SUPERVISION OR INSPECTION PROVIDED UNDER THIS SEAL
UNLESS OTHERWISE NOTED.
 - PILE LAYOUT MAY BE MODIFIED DUE TO ACTUAL DRIVING CONDITIONS.
ENGINEER TO BE NOTIFIED ON ANY MODIFICATION.
 - A PILE BLOW COUNT LOG OF ALL PILES IS TO BE SUBMITTED TO THE
ENGINEER OF RECORD. FAILURE TO SUBMIT SAID LOG WILL RELEASE THE
ENGINEER OF ALL RESPONSIBILITY AFTER 5 DAYS OF INSTALLING.

- ### GENERAL NOTES
- ALL LUMBER SHALL BE PRESSURE TREATED WITH A RETENTION OF .4 PER C.F.
 - ALL FASTENERS SHALL BE HOT DIPPED GALVANIZED (HDG) PER ASTM A153.
 - ALL CONNECTORS SHALL BE HDG PER ASTM A653, CLASS G185 SHEET WITH 1.85 OZ/SF ZINC COATING.

1 TYPICAL SECTION
SCALE: 1/4" = 1'-0"

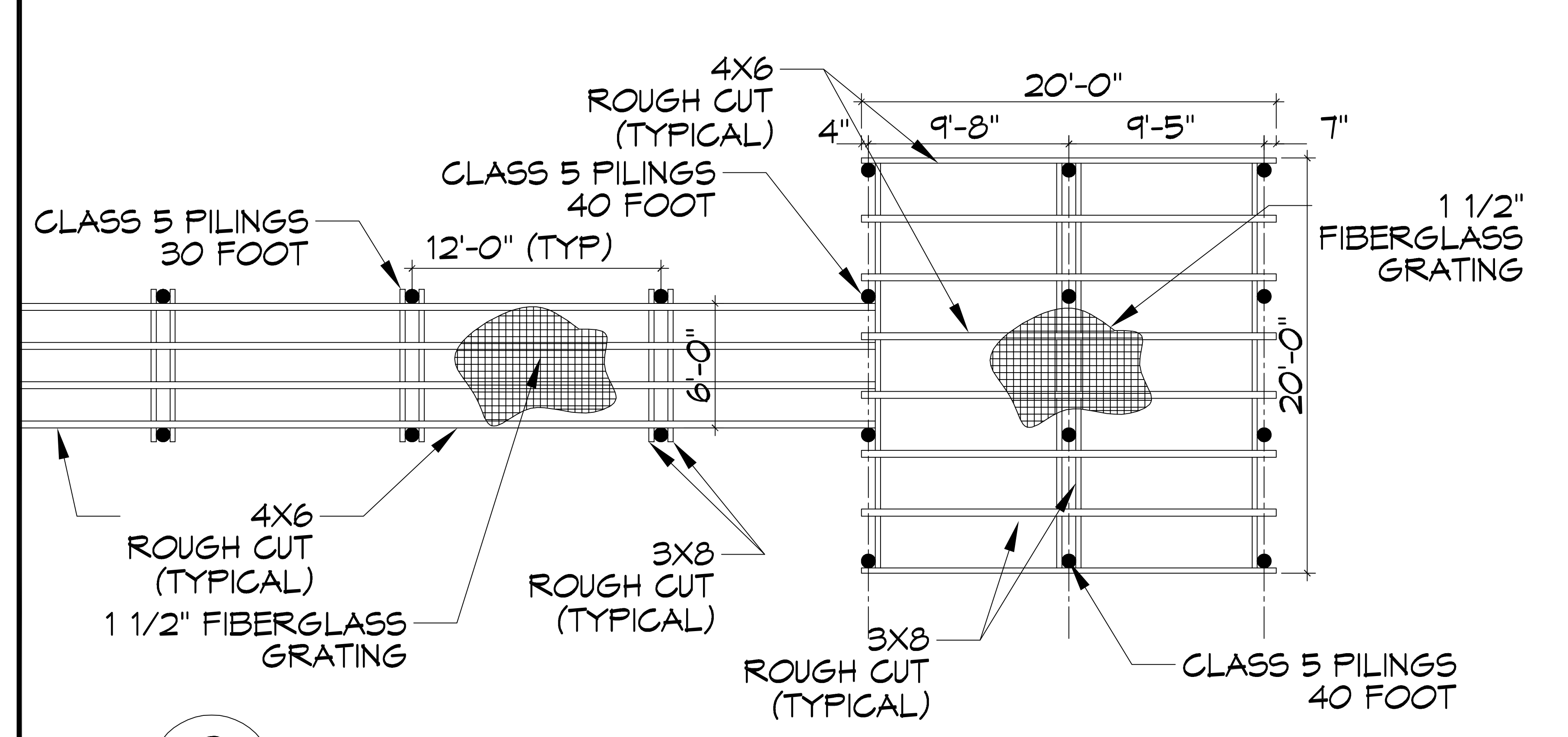

2 WALKWAY AND UPPER DECK
SCALE: 1/4" = 1'-0"

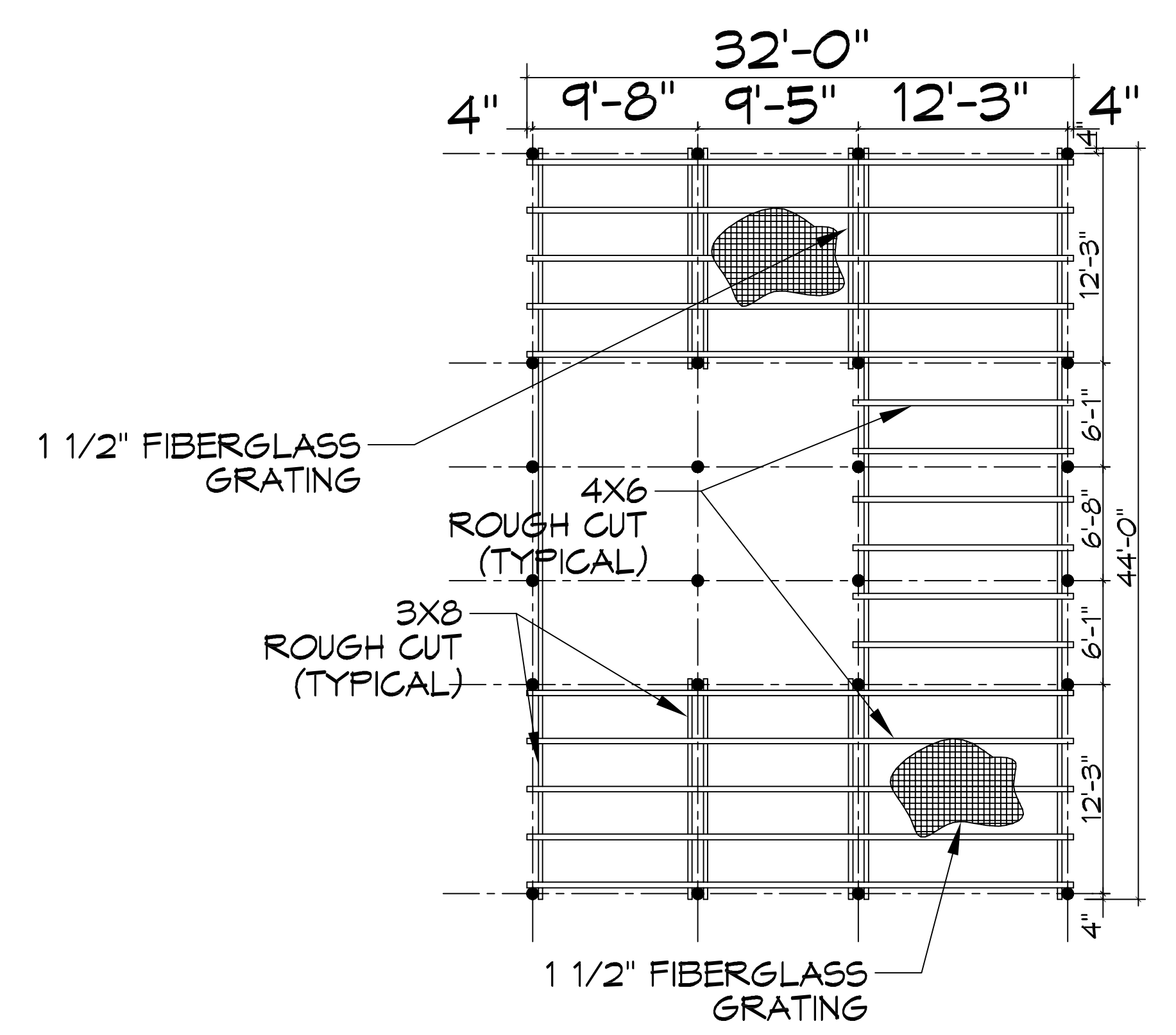

3 LOWER DECK
SCALE: 1/4" = 1'-0"

DAMMON
ENGINEERING, INC.
www.dammonengineering.com
info@dammonengineering.com
554 Old Spanish Trail
Slidell, LA 70458
Ph: 985.647.5832
Fax: 985.647.1950

| # | DESCRIPTION | DATE |
|---|-------------|------|
| | | |
| | | |
| | | |
| | | |
| | | |
| | | |
| | | |
| | | |
| | | |
| | | |



NEW BOAT HOUSE AND PIER FOR:
M CUBERTIES
 429 CARR DRIVE
 SLIDELL, LA 70458
 JOB No: 2543 DATE: 02-25-2016
 DRAWN BY: BAW CHECKED BY:

SHEET TITLE:
 BOAT HOUSE FRAMING PLAN
 DRAWING NUMBER:
S101
 SHEET No: 2 of 3

