

FILE NAME: C:\Users\adam\OneDrive\Documents\Delta Pet Store\Delta Pet Store\Delta Pet Store.dwg DATE: 10/08/14 10:08 AM

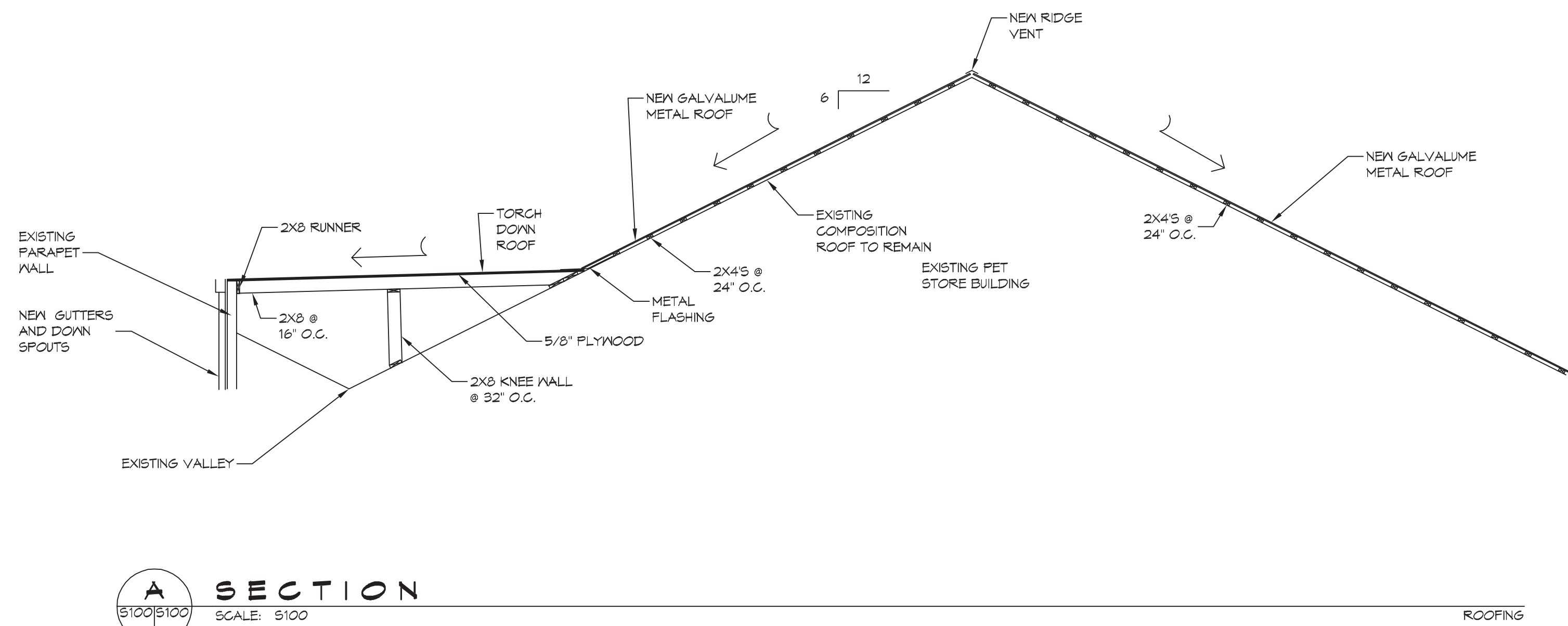
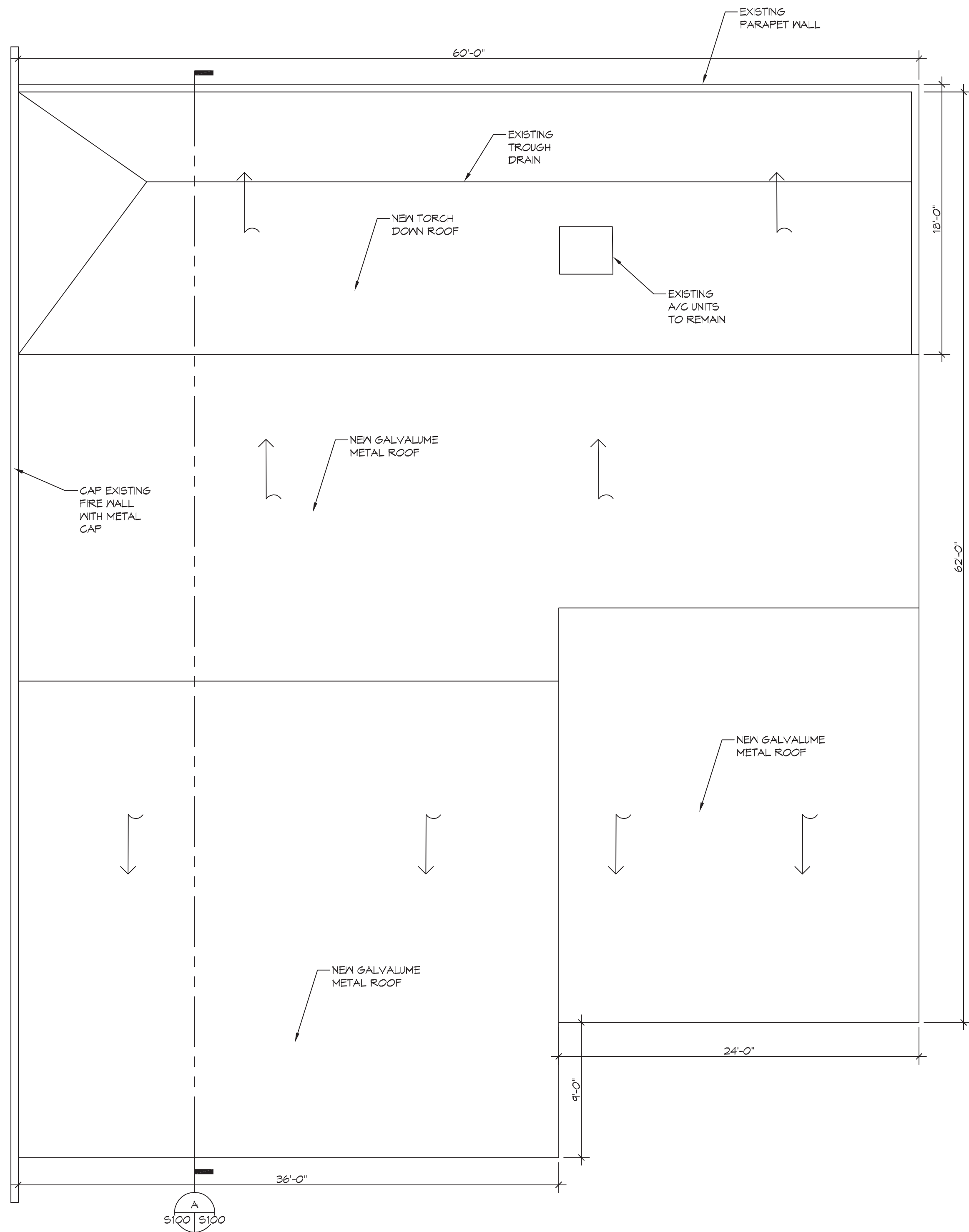

A SECTION
SCALE: 3/16" = 1'-0"

NOTES

1) ALL LUMBER SHALL BE TREATED

DAMMON
ENGINEERING, INC.
LOUISIANA & MISSISSIPPI

www.dammonengineering.com
info@dammonengineering.com
554 Old Spanish Trail
Slidell, LA 70668
Ph: 985.640.5632



STRUCTURAL DWS
DELTA PET STORE
LOT 20
ISLAND DRIVE
LACOMBE, LA
JOB NO: 10-08-14
DATE: 10-08-14
DRAWN BY: CKD
CHECKED BY: CKD

SHEET TITLE:
FLOOR
FRAMING PLAN

DRAWING NUMBER:
S100

SHEET No: 3 of 1



1 ROOF FRAMING PLAN
SCALE: 3/16" = 1'-0"

DESIGN CRITERIA:

THE CONSTRUCTION FOR SAID RESIDENCE, WHERE BASIC WIND SPEED IS 130 MILES PER HOUR, WIND EXPOSURE ZONE C, IS DESIGNED IN ACCORDANCE WITH: AMERICAN FOREST AND PAPER ASSOCIATION (AF&PA) WOOD FRAME CONSTRUCTION MANUAL FOR ONE AND TWO FAMILY DWELLINGS (WFCM) 2001 EDITION AS WELL AS THE INTERNATIONAL RESIDENTIAL CODE (IRC) 2015 EDITION