

# LOUISIANA ARMY NATIONAL GUARD

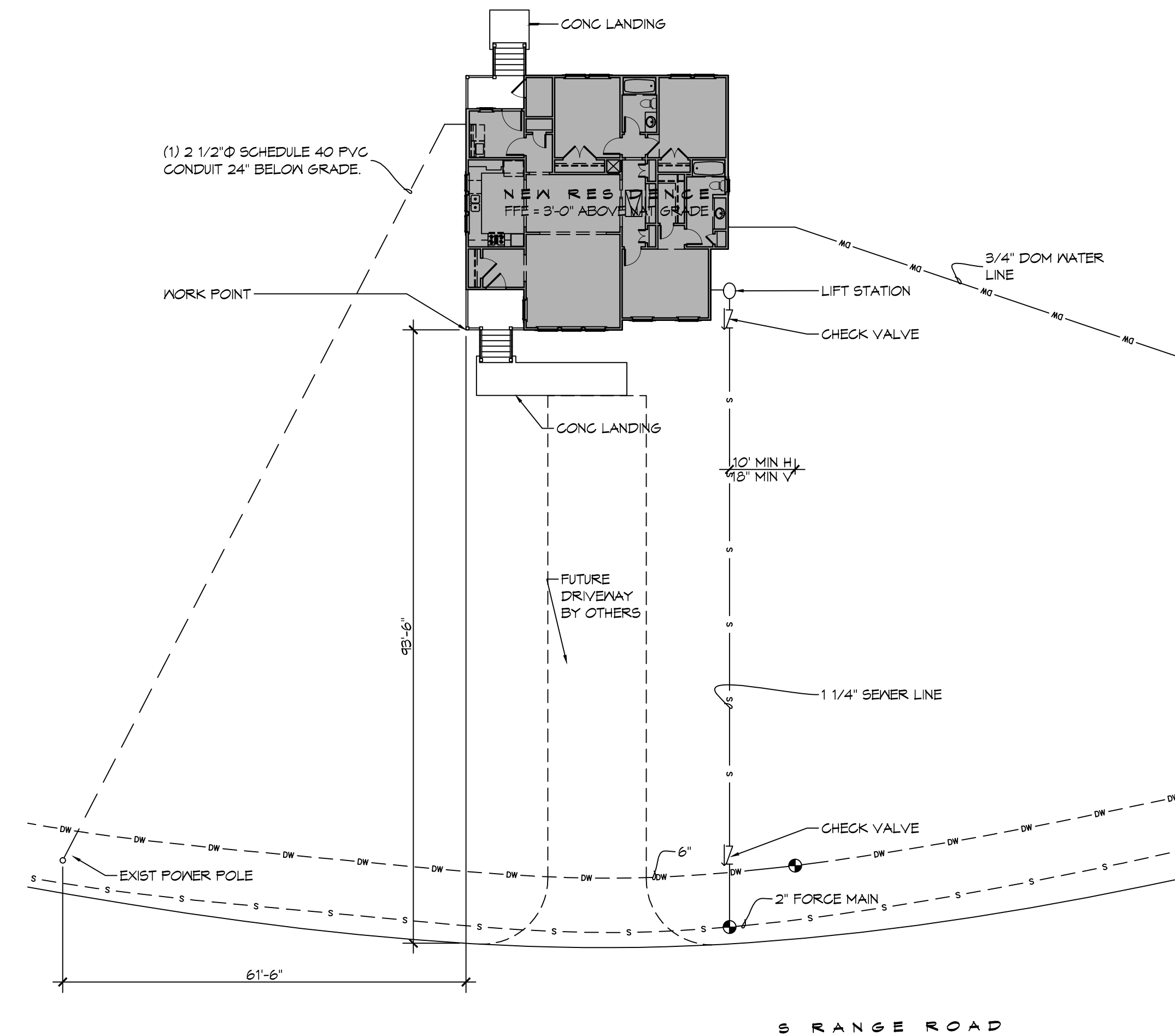

## CAMP VILLERE NEW HOME CONSTRUCTION SLIDELL, LOUISIANA



1 SITE PLAN  
SCALE: 1" = 16'

### GRAPHIC SYMBOLS

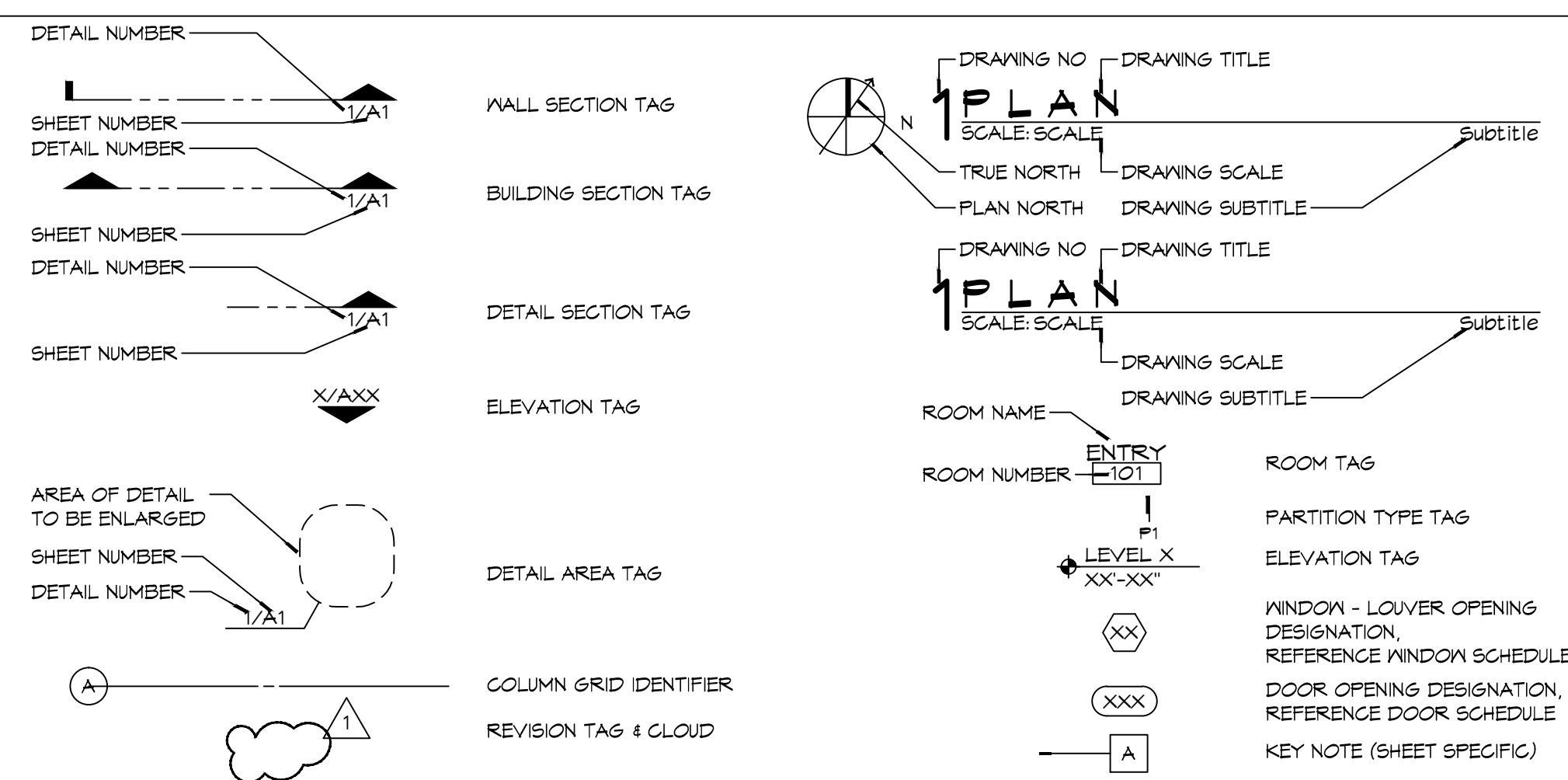

### VICINITY MAP

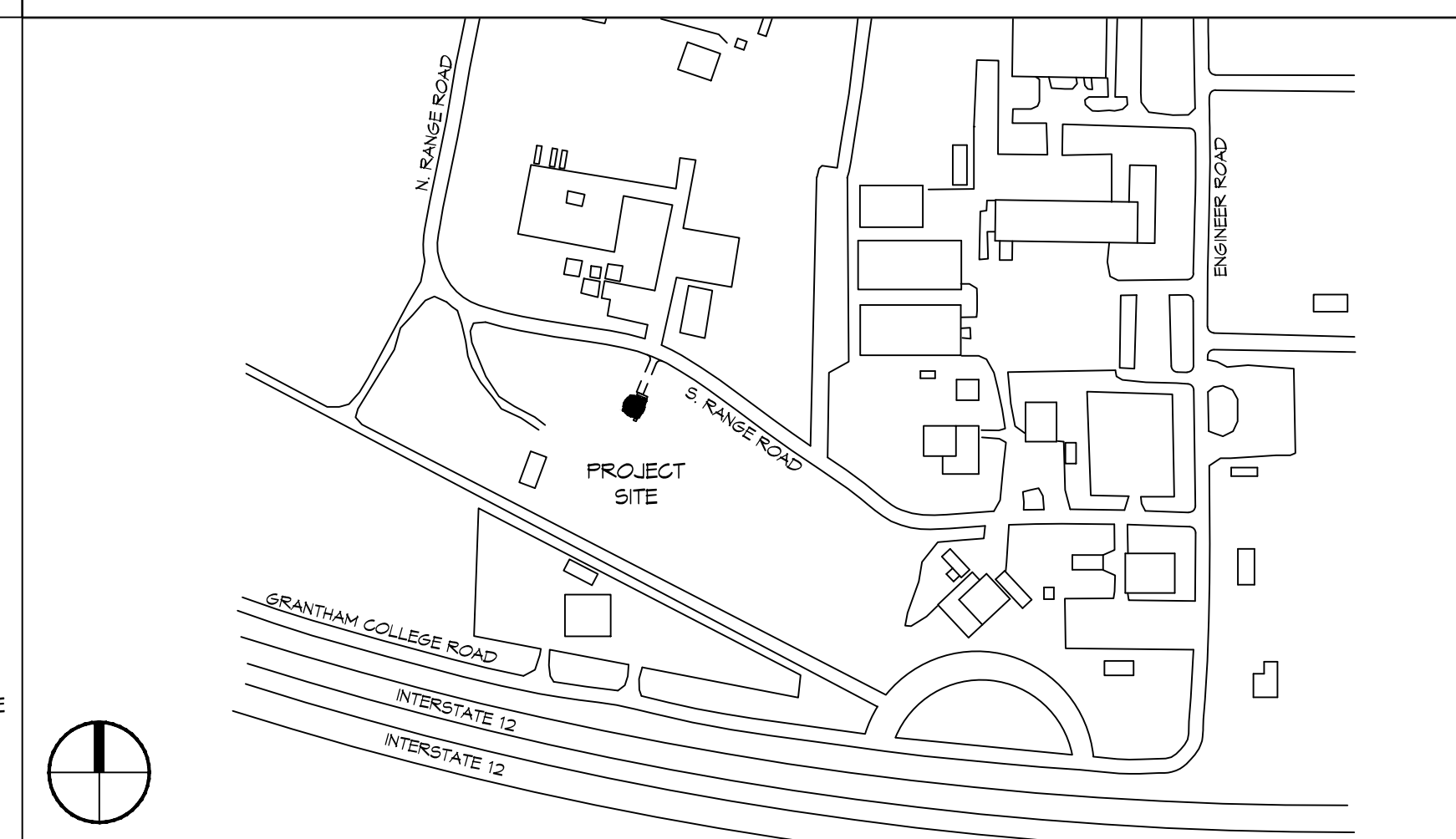

### SHEET INDEX

SHEET #	SHEET TITLE
G1	GENERAL INFORMATION SHEET & SITE PLAN
S1	PILING PLAN - DETAILS AND NOTES
S2	FRAMING PLAN - DETAILS AND NOTES
S3	STRAPPING AND CONNECTION DETAILS
A1	ARCHITECTURAL FLOOR & ROOF PLANS, OPENING & FINISH SCHEDULES
A2	EXTERIOR ELEVATIONS, OPENING TYPES AND DETAIL
A3	SECTIONS AND DETAILS
A4	REFLECTED CEILING PLAN, INTERIOR ELEVATIONS & INTERIOR DETAILS
M1	MECHANICAL PLAN - HVAC, DETAILS AND NOTES
E1	ELECTRICAL PLANS - POWER, LIGHTING, AND PANEL DIAGRAMS
P1	PLUMBING PLANS, RISER DIAGRAMS AND NOTES
P2	PLUMBING DOMESTIC WATER PLAN, RISER DIAGRAM AND NOTES

**PROJECT LOCATION:**  
CAMP VILLERE  
34045 GRANTHAM COLLEGE ROAD  
SLIDELL, LA 70460  
(985) 645-3514

**PROJECT STATISTICS:**

SQUARE FOOTAGE	
TOTAL ENCLOSED	1,400 SF
FRONT PORCH	54 SF
REAR PORCH	45 SF
TOTAL UNDER ROOF	1,499 SF

### GENERAL NOTES

- ALL MATERIALS AND WORK, INCIDENTAL TO THE CONSTRUCTION OF THIS PROJECT, SHALL CONFORM TO ALL GOVERNING CODES, AND REGULATIONS OF AGENCIES IN AUTHORITY.
- CONTRACTOR SHALL PROVIDE ALL PUBLIC PROTECTIONS NECESSARY AS REQUIRED BY LAW.
- THE DRAWINGS, SPECIFICATIONS AND ANY SUBSEQUENTLY ISSUED ADDENDA, AMENDMENTS OR SUCH CHANGE ORDERS APPROVED BY THE OWNER AND THE CONTRACTOR ARE PART OF THESE CONTRACT DOCUMENTS.
- DO NOT SCALE DRAWINGS.** CONSULT WITH THE ARCHITECT REGARDING ANY ITEMS IN THE CONTRACT DOCUMENTS THAT REQUIRE CLARIFICATION.
- TRASH SHALL BE REMOVED FROM THE SITE NOT LESS THAN TWICE MONTHLY.
- THE GENERAL CONTRACTOR SHALL VERIFY EXISTING CONDITIONS PRIOR TO COMMENCING WORK AND REPORT ANY AND ALL DISCREPANCIES TO THE ARCHITECT.
- CONTRACTOR VEHICLES AND EQUIPMENT NECESSARY FOR CONSTRUCTION MAY BE PARKED ON THE SITE. OTHER VEHICLES PARKED ON THE SITE REQUIRE THE OWNER'S PERMISSION.
- NAMING A CERTAIN BRAND, MAKE OR MANUFACTURER IS TO DESIGNATE THE GENERAL STYLE, TYPE, CHARACTER AND QUALITY STANDARD OF THE PRODUCT DESIRED. SUBSTITUTION REQUESTS MUST BE SUBMITTED PRIOR TO BIDDING.
- ALL MATERIALS/EQUIPMENT SHALL BE INSTALLED PER MANUFACTURER'S RECOMMENDATIONS. WORK NOT CONSISTENT WITH MANUFACTURER'S RECOMMENDATIONS WILL BE REJECTED BY OWNER/ARCHITECT.

**DAMMON ENGINEERING, INC.**  
LOUISIANA & MISSISSIPPI

www.dammonengineering.com  
info@dammon.com  
504.649.5832  
PH: 985.649.5832

Chief Engineer: Brian Mitchell, PE  
504.649.5832  
brian@dammon.com  
Slidell, LA 70458

#	DESCRIPTION	DATE
AS BUILTS		10/6/2017

SEAL:

LOUISIANA ARMY NATIONAL GUARD

**CAMP VILLERE  
NEW HOME CONSTRUCTION**

CAMP VILLERE, LOUISIANA  
LA 144-031

JOB No: 2210  
DATE: OCTOBER 6, 2014  
DRAWN BY: KJK  
CHECKED BY: KJK

SHEET TITLE:  
GENERAL INFORMATION SHEET AND SITE PLAN

DRAWING NUMBER:  
**G1**

SHEET No: 1 of 12