

## DESV – Enlarged Casing

Single Duct Terminal Unit, Enlarged Casing for Larger Water Coils, Lower Temperature Water  
Direct Digital Control, Pressure Independent

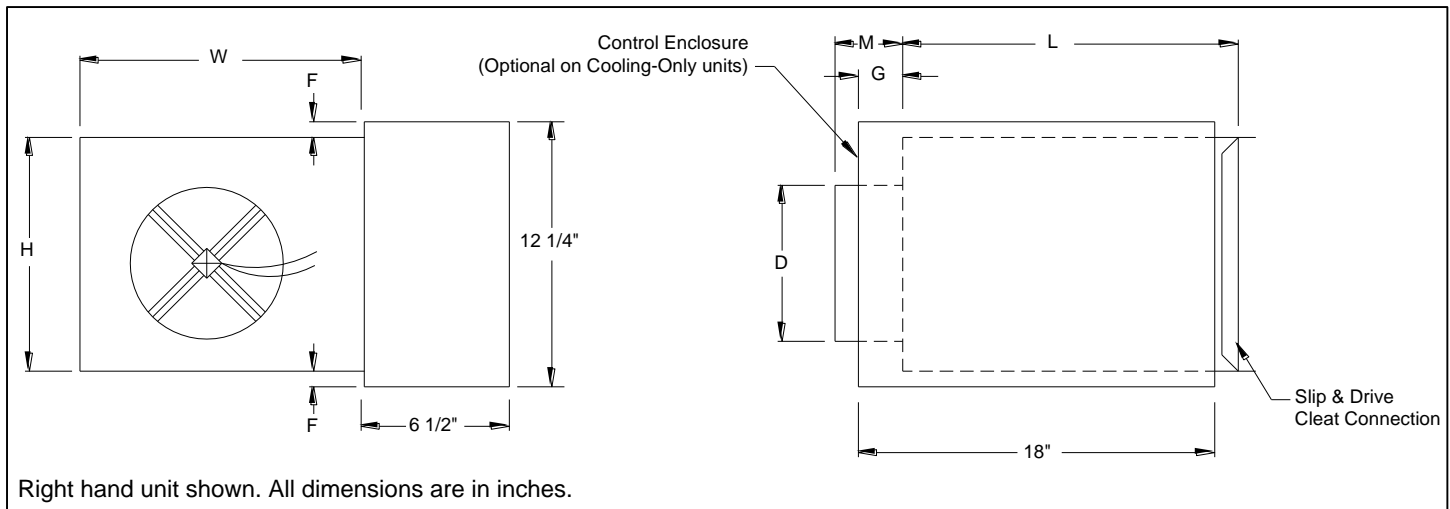

Code	Nom. Inlet	CFM Range	D Inlet Dia.	F	G	H	L	M	W	Equivalent Standard Case Size
5E	5"	0-350	4 $\frac{5}{8}$ "	2 $\frac{1}{8}$ "	7 $\frac{3}{8}$ "	10"	15 $\frac{1}{2}$ "	5 $\frac{3}{8}$ "	12"	7, 8
6E	6"	0-500	5 $\frac{5}{8}$ "	2 $\frac{1}{8}$ "	7 $\frac{3}{8}$ "	10"	15 $\frac{1}{2}$ "	3 $\frac{3}{8}$ "	12"	7, 8
7E	7"	0-650	6 $\frac{5}{8}$ "	1 $\frac{1}{8}$ "	7 $\frac{3}{8}$ "	12 $\frac{1}{2}$ "	15 $\frac{1}{2}$ "	3 $\frac{3}{8}$ "	14"	9, 10
8E	8"	0-900	7 $\frac{5}{8}$ "	1 $\frac{1}{8}$ "	7 $\frac{3}{8}$ "	12 $\frac{1}{2}$ "	15 $\frac{1}{2}$ "	3 $\frac{3}{8}$ "	14"	9, 10
1E	10"	0-1400	9 $\frac{5}{8}$ "	-	5 $\frac{3}{8}$ "	15"	15 $\frac{1}{2}$ "	3 $\frac{3}{8}$ "	16"	12
2E	12"	0-2000	11 $\frac{5}{8}$ "	-	5 $\frac{3}{8}$ "	17 $\frac{1}{2}$ "	15 $\frac{1}{2}$ "	3 $\frac{3}{8}$ "	20"	14



### Accessories (Optional)

- Check  if provided.
- |  |  |   |  |
|--|--|---|--|
| <input type="checkbox"/> 24 V Control Transformer  | <input type="checkbox"/> 1" Fiberglass Liner           | <input type="checkbox"/> UltraLoc Liner                   | <input type="checkbox"/> Removable Air Flow Sensor             |
| <input type="checkbox"/> Dust Tight Enclosure Seal | <input type="checkbox"/> 1" EcoShield Liner            | <input type="checkbox"/> 1/2" EcoShield Liner (Foil Face) | <input type="checkbox"/> Bottom Access Door                    |
| <input type="checkbox"/> Fibre Free Liner          | <input type="checkbox"/> 1" Fibre Free Liner           | <input type="checkbox"/> 1" EcoShield Liner (Foil Face)   | <input type="checkbox"/> OSP & IBC Certification               |
| <input type="checkbox"/> 1/2" EcoShield Liner      | <input type="checkbox"/> Low Leakage Seal/Test/Certify | <input type="checkbox"/> Disconnect Switch                | <input type="checkbox"/> Red List Compliant "Google" Gasketing |
| <input type="checkbox"/> 1/2" Fibre Free Liner     | <input type="checkbox"/> SteriLoc Liner                | <input type="checkbox"/> Hanger Brackets                  | <input type="checkbox"/> _____                                 |

### General Description

- Heavy gauge steel housing. Mechanically sealed and gasketed, leak resistant construction. Less than 2% of nominal cfm at 1.5" sp wg.
- Dual density internal insulation, treated to resist air erosion. Meets requirements of NFPA 90A and UL 181.
- Rectangular discharge opening is designed for slip and drive cleat duct connection.
- Multipoint center averaging inlet velocity sensor.
- Digital control packages can be factory mounted by Titus.
- Choice of right hand or left hand control location.
- Model DESV without coils can be installed horizontally, vertically, or at any angle. Operation is not affected by position. For units with coils, consult technical support.
- Gauge tees for cfm measurement.
- OSHPD Seismic Certification: OSP-0352-10
- Only Titus Alpha digital controls package approved for seismic installation.

This submittal is meant to demonstrate general dimensions of this product. The drawings are not meant to detail every aspect of the product. Drawings are not to scale. Titus reserves the right to make changes without written notice.

## Accessories (Optional)

Hot Water Coil Section

- Aluminum ripple fins, 10 per inch
- Coil pipe connections are male, sweat, type "L" copper. Connection sizes are 1/2" OD for 1 row coil unit size 5E. All other coils have 7/8" OD.
- Coil is installed at discharge of unit.
- On units with attenuators, coil are installed at the discharge of attenuator.

- 1 Row
- 2 Row
- 3 Row
- 4 Row

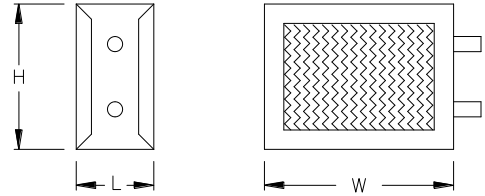

Integral Sound Attenuator

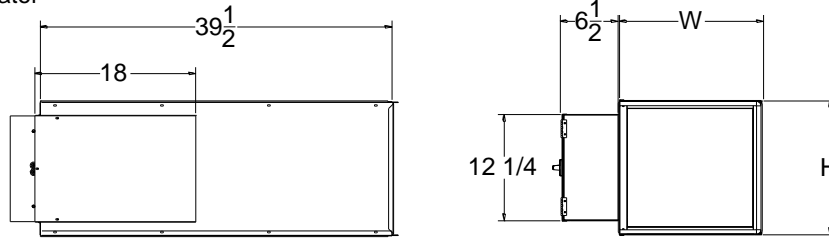

Code	H	W	Water Coil
			L (3-4 Row)
5E	10	12	7 1/4
6E	10	12	7 1/4
7E	12 1/2	14	7 1/4
8E	12 1/2	14	7 1/4
1E	15	16	7 1/4
2E	17 1/2	20	9 3/4

The total length of the DESVE unit is the summation of the unit length (with or without attenuator) and the length of the optional water coil.

This submittal is meant to demonstrate general dimensions of this product. The drawings are not meant to detail every aspect of the product. Drawings are not to scale. Titus reserves the right to make changes without written notice.

All rights reserved. No part of this work may be reproduced or transmitted in any form or by any means, electronic or mechanical, including photocopying and recording, or by any information storage retrieval system without permission in writing from Air Distribution Technologies, Inc.