

PLS. MAIL TO: COMMUNITY SERVICES DIVISION, 500 PINE ST., SUITE 100, NEW ORLEANS, LA 70112
 TEL: 504-685-1000 FAX: 504-685-1001
 WWW.NOLA.GOV

KENILWORTH ST

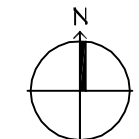

1 LANDSCAPING PLAN
SCALE: 1" = 10'-0"

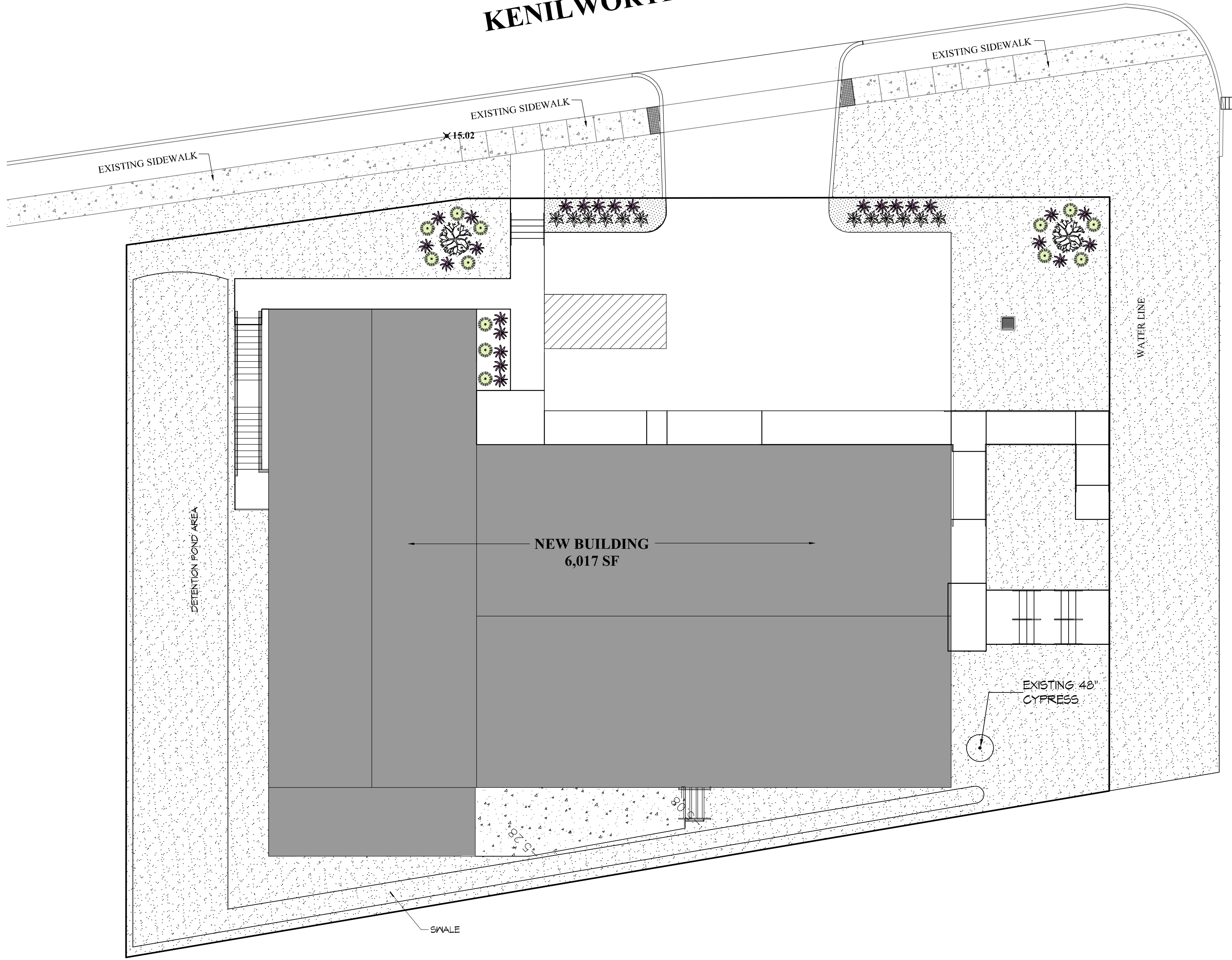
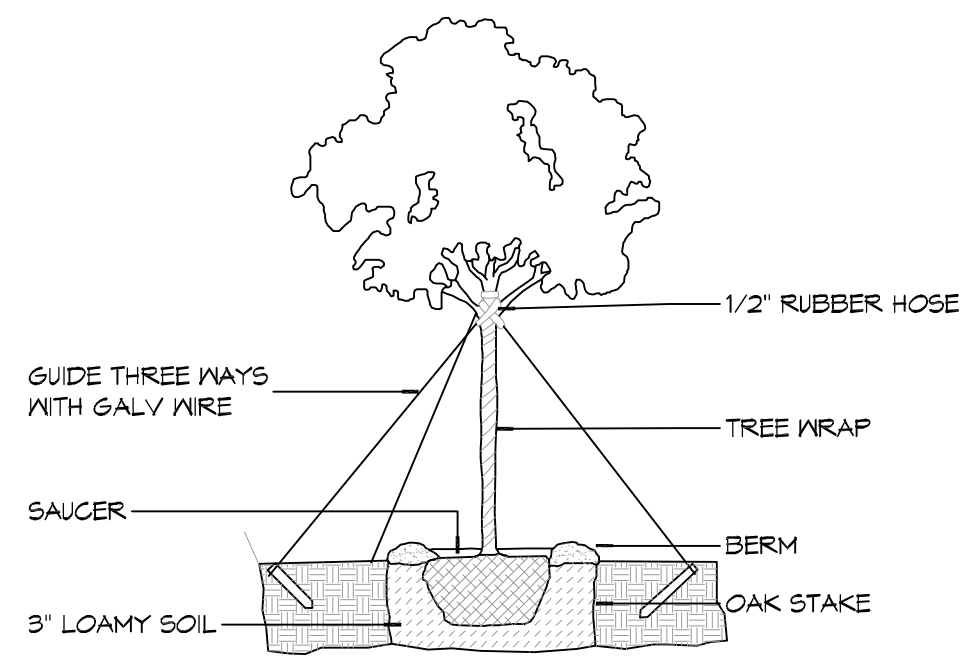

NOTE:
ALWAYS PLANT EQUAL TO OR 1" - 2" ABOVE GROUND.

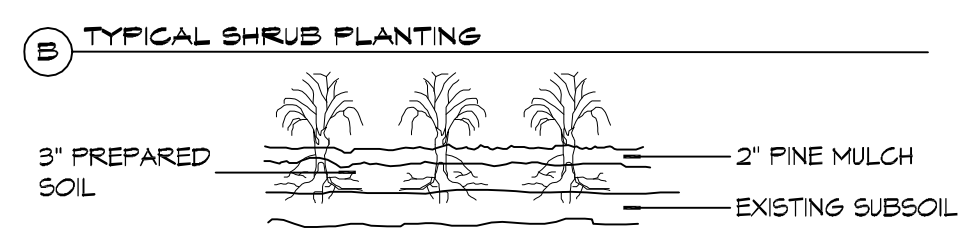
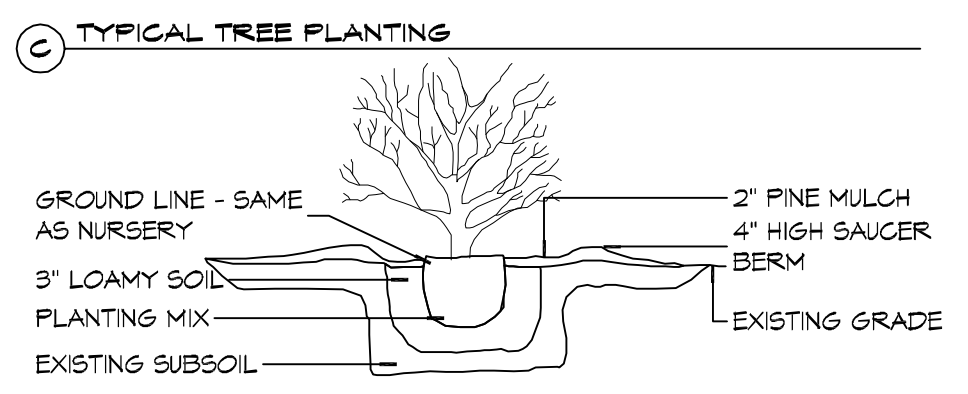

2 DETAILS
SCALE: NTS

LANDSCAPING NOTES

- ALL LANDSCAPING SHALL BE INSTALLED BY A LANDSCAPING COMPANY LICENSED IN THE STATE OF LOUISIANA.
- CONTACT LOCAL UNDERGROUND UTILITY SERVICES FOR UTILITY LOCATION AND IDENTIFICATION, PRIOR TO COMMENCING WORK.
- PERFORM EXCAVATIONS IN THE VICINITY OF UNDERGROUND UTILITIES WITH CARE AND BY HAND. IF NECESSARY, THE CONTRACTOR BEARS FULL RESPONSIBILITY FOR THIS WORK AND DISRUPTION OR DAMAGE TO UTILITIES AND SHALL BE IMMEDIATELY REPAIRED AND AT NO EXPENSE TO THE OWNER.
- ITEMS ENCOUNTERED BELOW GRADE AND NOT SHOWN ON THE DRAWINGS SHALL BE BROUGHT TO THE ATTENTION OF THE CONTRACTOR.
- CONTACT THE LOCAL UNDERGROUND SERVICE UPDATE FOR UTILITY LOCATION AND IDENTIFICATION PRIOR TO DEMOLITION.
- DESIGNING PLANTING AREAS, ESPECIALLY THOSE BY PASSING TREATMENT SYSTEMS, TO ENCOURAGE INFILTRATION TO THE DEGREE POSSIBLE.
- IN ORDER TO ENCOURAGE INFILTRATION OF STORMWATER, AND TO MINIMIZE THE MIGRATION OF SEDIMENTS, THE FINISHED GRADE FOR ALL LANDSCAPING AREAS SHALL BE SET 3/8" AMP, QUIT, MINIMUM BELOW SURROUNDING HARDCAPE CONTAINMENTS (CURBING, SIDEWALKS, FOUNDATIONS ETC.). THIS STANDARD MAY BE WAIVED IF NECESSARY TO PROMOTE THE PRESERVATION OF TREES SHOWN AS SUCH.

LEGEND

- DD BLANCHARD MAGNOLIA
ALL CLASS "A" TREES, AT THE TIME OF PLANTING, SHALL HAVE A MINIMUM CALIPER OF AT LEAST ONE AND ONE-HALF (1-1/2) TO TWO (2) INCHES, MEASURED SIX (6") INCHES ABOVE THE ROOT BALL, AND A MINIMUM HEIGHT OF 8 FEET AT TIME OF PLANTING AND A MATURE AVERAGE CROWN SPREAD OF 20 FEET.
 - AZALEA
SHRUB: A RELATIVELY LOW-GROWING BUSHY PLANT, USUALLY WITH WOODY STEMS. FOR THE PURPOSE OF THIS DEFINITION, GROUND COVER, TREES AND ANNUALS ARE NOT CONSIDERED SHRUBS. ALL SHRUBS, AT THE TIME OF PLANTING, SHALL HAVE A MINIMUM HEIGHT OF TWO (2) FEET.
 - DRIFT ROSE
SHRUB: A RELATIVELY LOW-GROWING BUSHY PLANT, USUALLY WITH WOODY STEMS. FOR THE PURPOSE OF THIS DEFINITION, GROUND COVER, TREES AND ANNUALS ARE NOT CONSIDERED SHRUBS. SHALL HIDE BACKFLOW PREVENTER.
 - AFRICAN IRIS
SHRUB: A RELATIVELY LOW-GROWING BUSHY PLANT. FOR THE PURPOSE OF THIS DEFINITION, GROUND COVER, TREES AND ANNUALS ARE NOT CONSIDERED SHRUBS.
 - GRASS
 - PINE MULCH
- NOTE: ALL TREES & SHRUBS TO BE MULCHED 1/3" DEPTH, ALL OTHER AREAS TO BE COVERED IN LIVE GROUND COVER OR SOD.

HARD & GREEN SPACE

EXISTING PERMEABLE AREA = 14,313 SQ. FT.
 BUILDING AREA = 6,017 SQ. FT.
 PARKING AREA & SIDEWALKS = 2,480 SQ. FT.
 NEW PERMEABLE AREA = 5,816 SQ. FT.
 TOTAL AREA = 14,319.00 SQ. FT.

LICENSED LANDSCAPER

BILL BROWN JR.
LUXURY LANDSCAPE SERVICES 985-774-5211
HORT. #2377

DAMMON ENGINEERING, INC.
LOUISIANA & MISSISSIPPI

www.dammonengineering.com
info@dammonengineering.com
PH: 782.447.2524

Chief Engineer: Brian Masch, PE
556 Old Spanish Trail
Bossier, LA 70604

#	DESCRIPTION	REVISIONS	DATE

SEAL:

NEW ORLEANS FIREFIGHTERS ASSOCIATION

NEW FACILITY

5710 GENERAL HAG STREET
NEW ORLEANS, LA 70124

JOB No: 2493 DATE: 3/25/2021
DRAWN BY: BB JR. CHECKED BY: CACD

SHEET TITLE:
LANDSCAPING PLAN

DRAWING NUMBER:
L100

SHEET No: 1 of 1