

FILE NAME: \\C:\Government\Projects\10101\10101.dwg DATE: 03/25/2021 10:45:00 AM

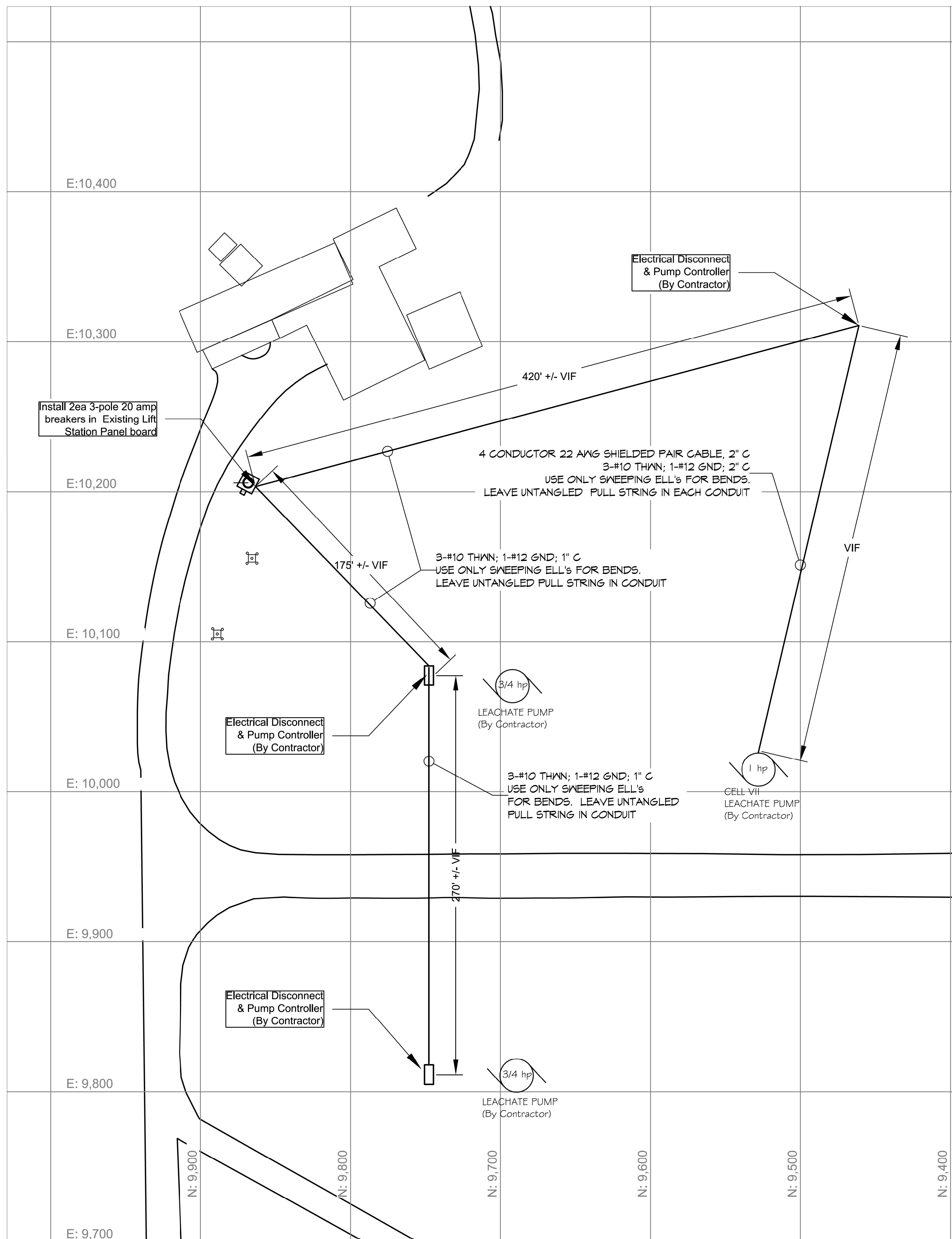

1 CELL IX ELECTRICAL PLAN
SCALE: N.T.S.

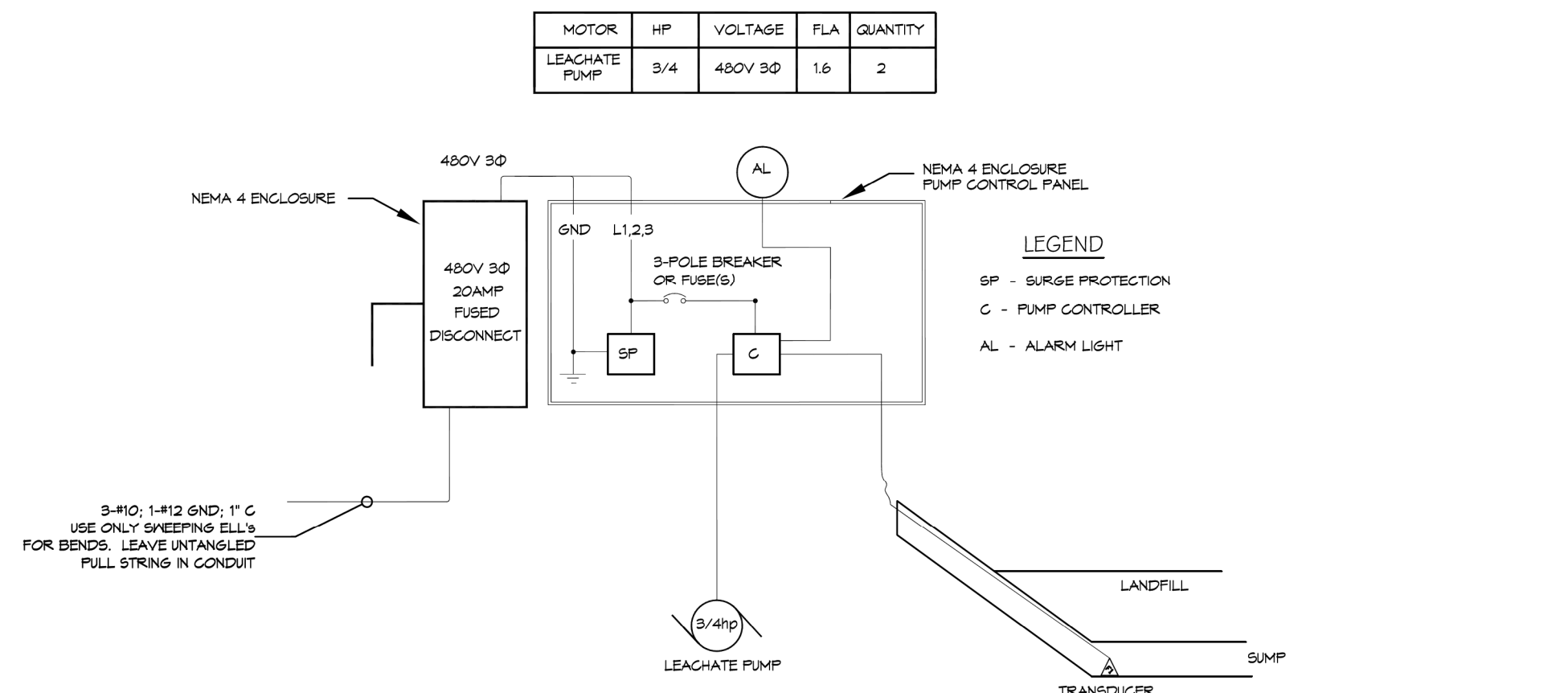

2 CELL IX SUMP PUMP
SCALE: N.T.S.

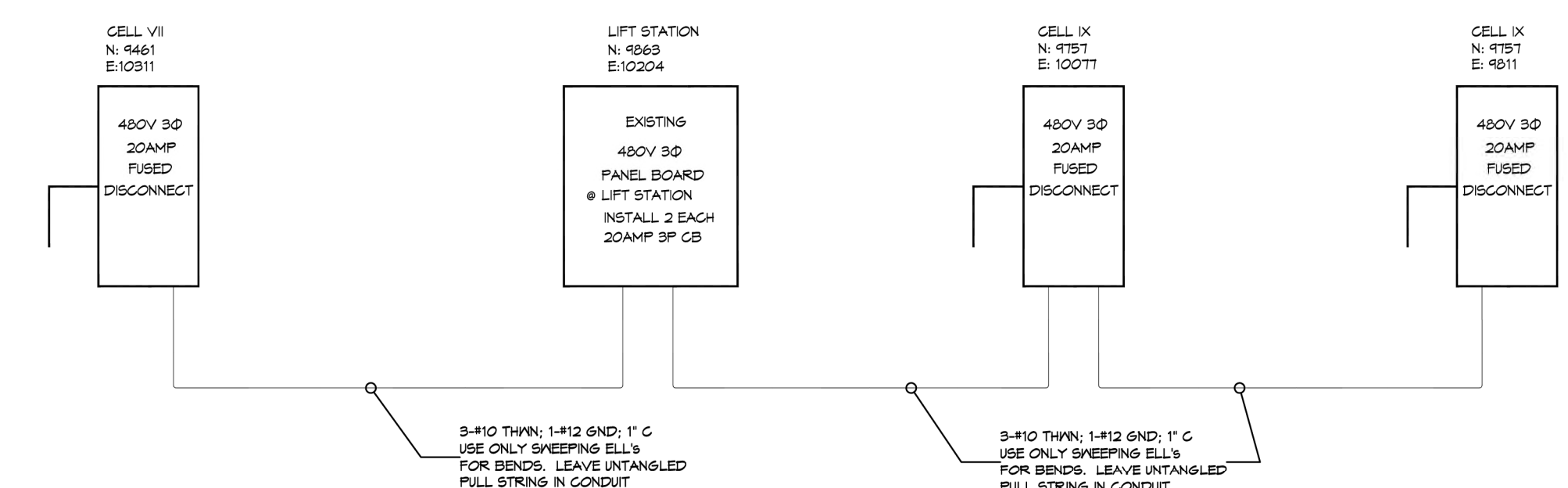

3 ELECTRICAL ONE LINE DIAGRAM
SCALE: N.T.S.

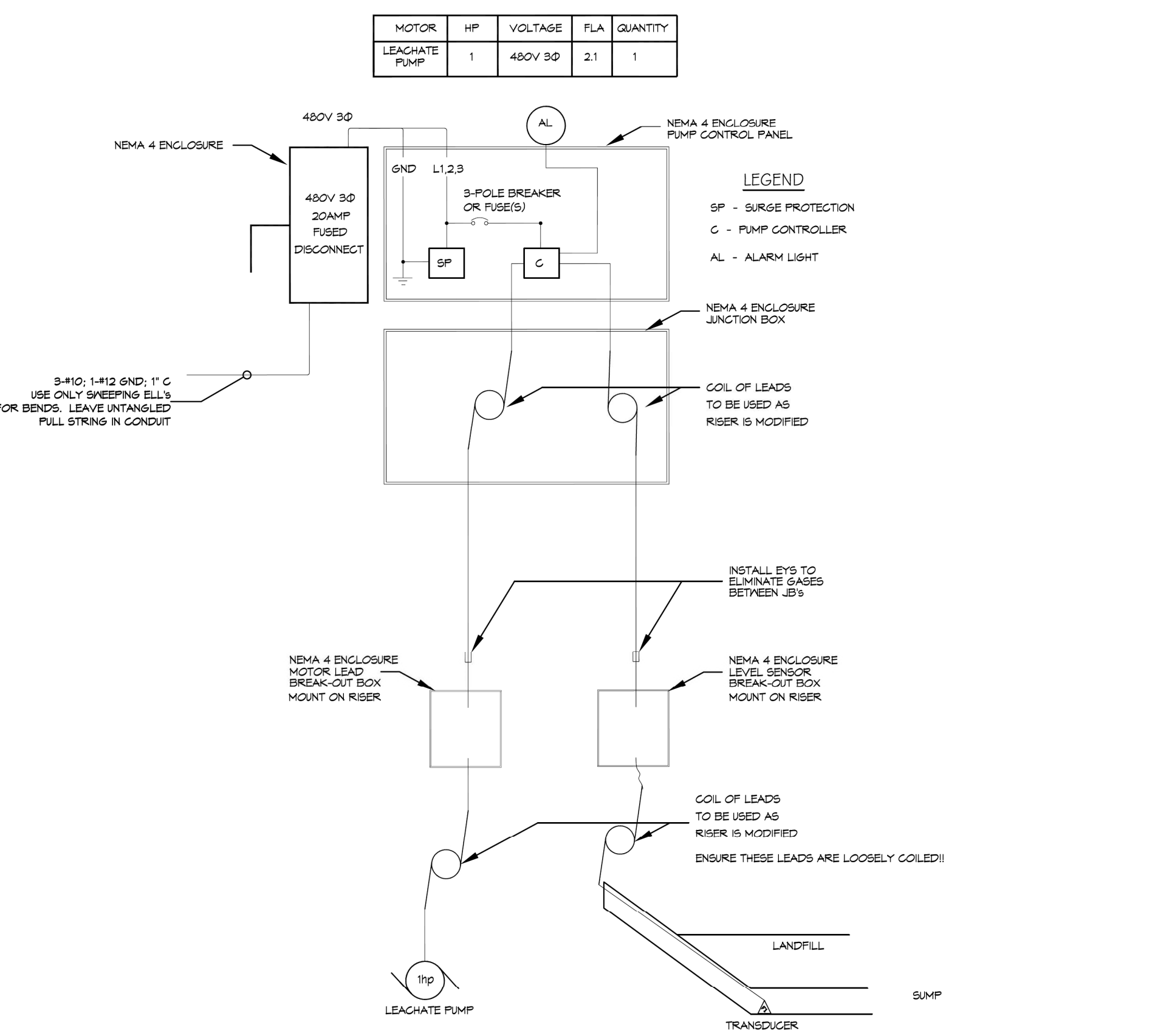

4 CELL VII RETRO FIT RISER & SUMP PUMP
SCALE: N.T.S.

ELECTRICAL NOTES

- ALL WORK SHALL CONFORM TO THE LATEST EDITION OF THE NATIONAL ELECTRICAL CODE, THE GOVERNING ELECTRICAL CODE AND ALL OTHER INSPECTION DEPARTMENTS HAVING JURISDICTION. OBTAIN CERTIFICATES OR APPROVAL WHERE REQUIRED.
- ALL MATERIALS FURNISHED SHALL BE NEW AND SHALL BE U.L. LISTED.
- THE DRAWINGS INDICATE SIZE AND GENERAL LOCATION OF WORK. SCALE DIMENSIONS SHALL NOT BE USED. THE EXACT LOCATION OF ALL RISERS SHALL BE DETERMINED BY ACTUAL CONDITIONS IN THE FIELD.
- PRIOR TO BIDDING, CONTRACTOR SHALL VISIT THE JOB SITE AND FAMILIARIZE THEMSELVES WITH THE EXISTING CONDITIONS.
- ELECTRICAL CONTRACTOR SHALL COORDINATE HIS WORK WITH OTHER TRADES AND WITH OTHER CONTRACTORS WHOSE WORK MAY AFFECT THIS INSTALLATION.
- PERFORM TEST REQUIRED BY THE OWNER OR THE ENGINEER IN CONNECTION WITH THE OPERATION OF THE ELECTRICAL SYSTEM IN THE BUILDING.
- ALL TESTS SHALL BE MADE IN ACCORDANCE WITH THE LATEST STANDARD OF THE IEEE AND THE NATIONAL ELECTRICAL CODE.
- MINIMUM CONDUCTOR SIZE SHALL BE #12, 600V INSULATION. MINIMUM SIZE CONDUIT SHALL BE 1" SCH 80 FOR EXTERIOR USE, UNLESS OTHERWISE SHOWN.
- CONTRACTOR SHALL INSTALL WIRING AND OTHER CIRCUIT COMPONENTS TO MATCH EQUIPMENT ACTUALLY INSTALLED.
- INSTALL GROUND FAULT RECEPTACLES AT RECEPTACLE LOCATIONS AT EXTERIOR LOCATIONS. EXTERIOR RECEPTACLES SHALL ALSO BE WATERPROOF.
- BONDING AND GROUNDING SHALL BE IN ACCORDANCE WITH NFPA 70:230-63, NFPR 250-23, 250-71 & 250-72.
- GROUND NEUTRAL IN ACCORDANCE WITH NFPA 70:250-23b.
- FUSES SHALL BE ITT CLASS K5, 250 VOLT, 200,000 AMP INTERRUPTING CAP.
- ALL CIRCUIT BREAKERS SHALL BE THERMAL-MAGNETIC FOR ALL MOTORS.
- ALL ELECTRICAL CONDUIT SHALL BE SCHEDULE 40 PIPE BELOW GRADE AND SCHEDULE 80 PIPE ABOVE GRADE.

DAMMON ENGINEERING, INC.
LOUISIANA & MISSISSIPPI

www.dammonengineering.com
info@dammoneng.com
PH: 985.649.8337

Chief Engineer: Brian Misticch, PE
101 Franklin Street
Mansfield, Louisiana 71052
Siceloff, LA 70458

REVISIONS	DATE
#	DESCRIPTION

SEAL:

CONSTRUCTION OF WASTE DISPOSAL CELL IX

MUNDY LANDFILL

PIERRE PARISH, LOUISIANA
101 FRANKLIN STREET
MANSFIELD, LOUISIANA 71052

JOB No: 2491 DATE: 3/25/2021
DRAWN BY: [Signature] CHECKED BY: [Signature]

SHEET TITLE:
ELECTRICAL PLAN

DRAWING NUMBER:
E101

SHEET No: of 8