

CMU INTEL SCHEDULE

WIDTH (W)	CLEAR SPAN	DEPTH (D)	HORIZ. REINF.
8" TYPE AT WALL CMU	UP TO 3'-4"	8"	(1) #6 TB@ BOTTOM
8" TYPE AT WALL CMU	UP TO 6'-4"	16"	(1) #6 TB@ BOTTOM
8" TYPE AT WALL CMU	UP TO 14'-0"	24"	(2) #6 TB@ BOTTOM

PROVIDE 3000 PSI FEASGRAVEL CONCRETE FILL FOR ALL INTELS.

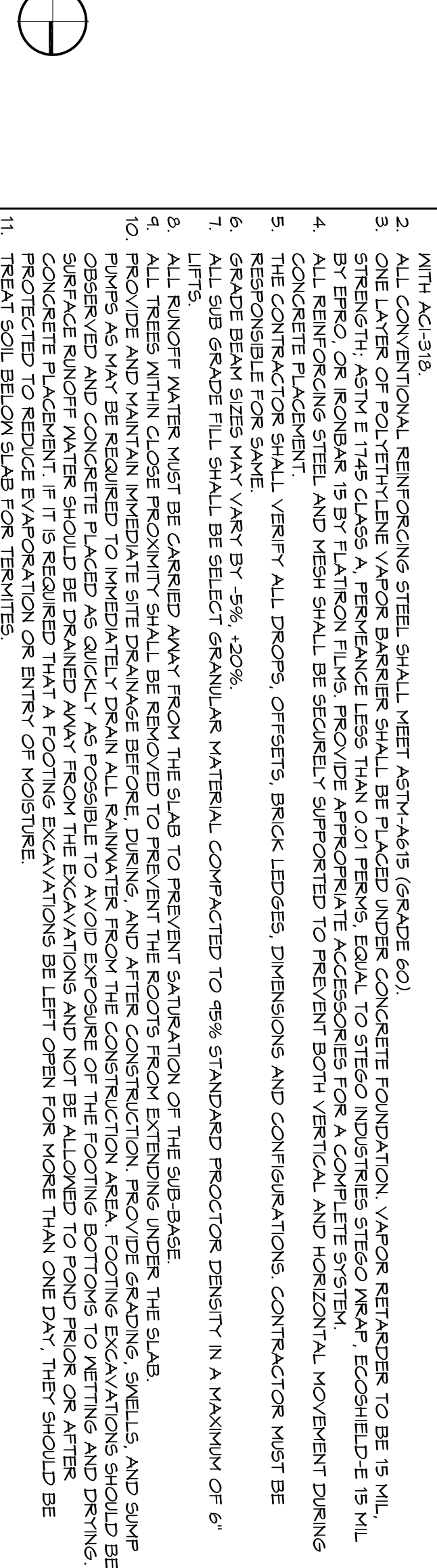
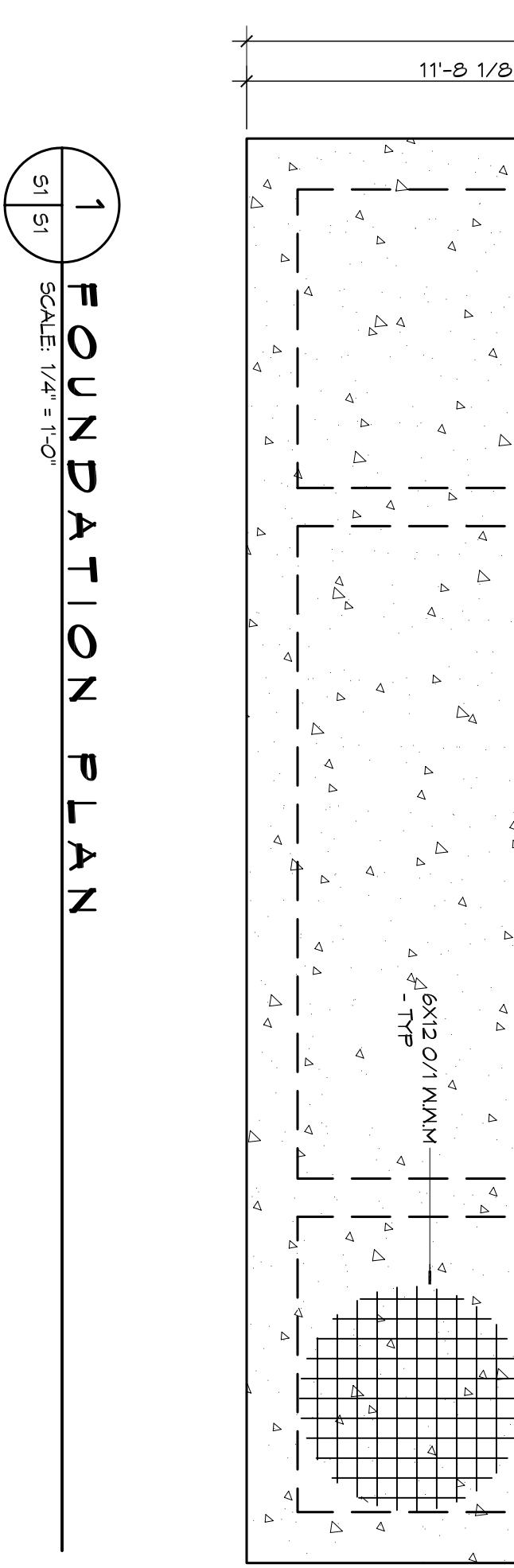
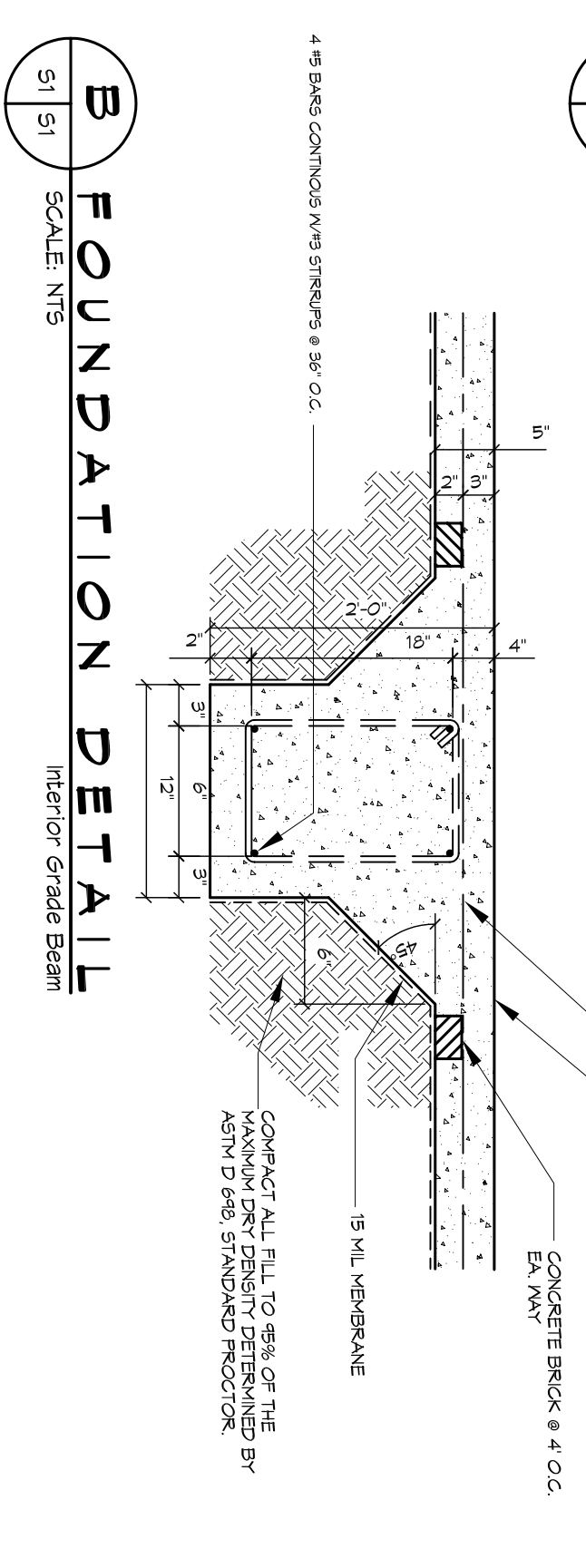
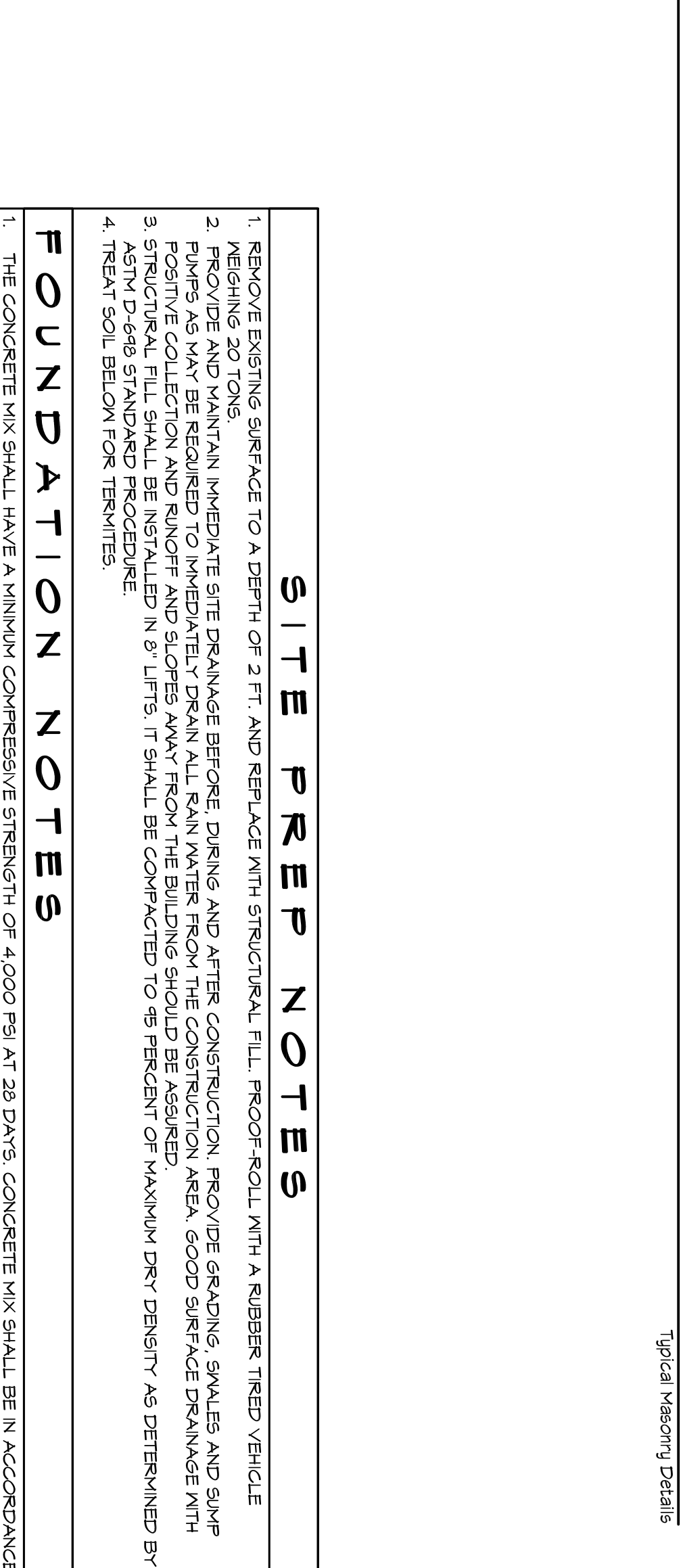
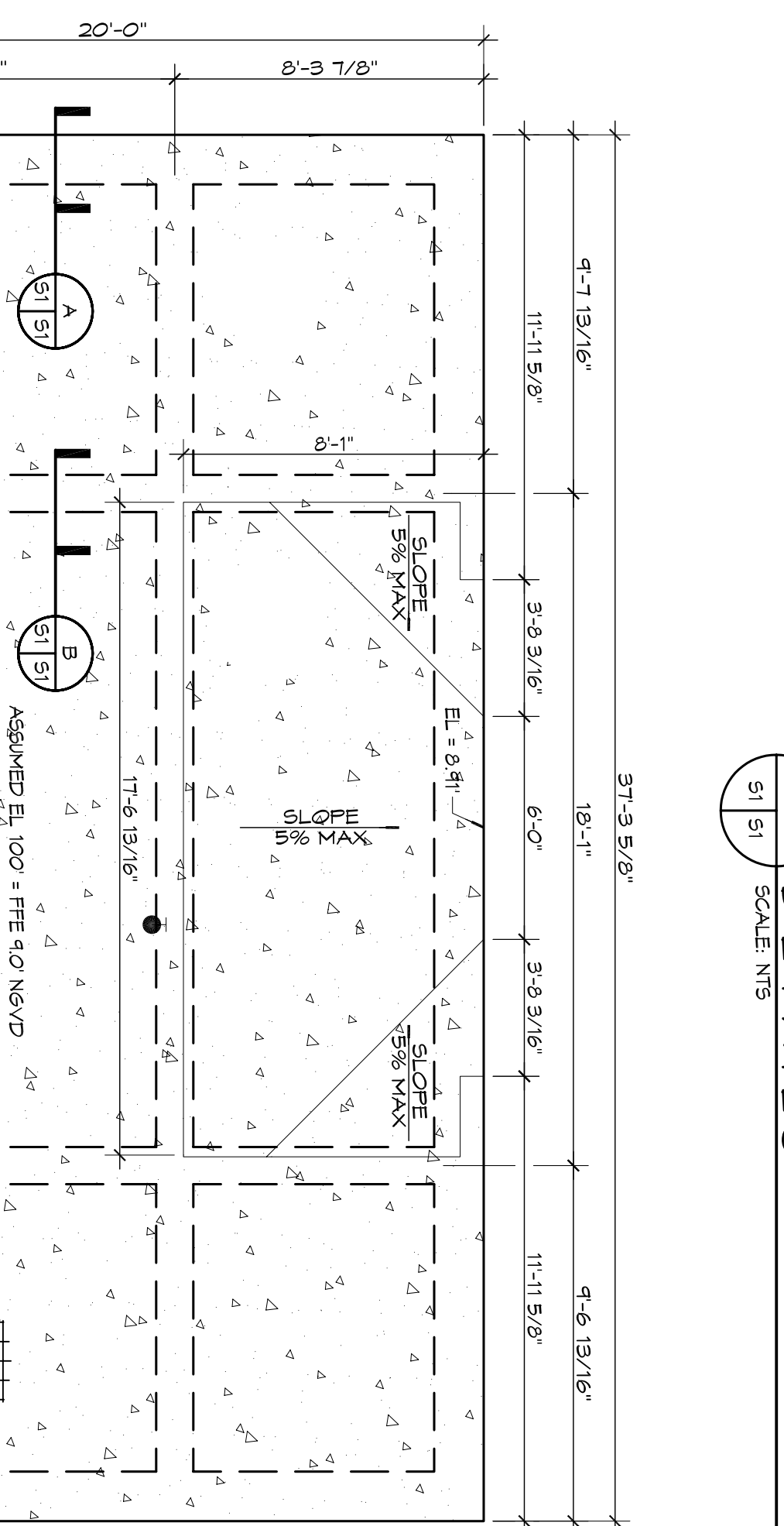
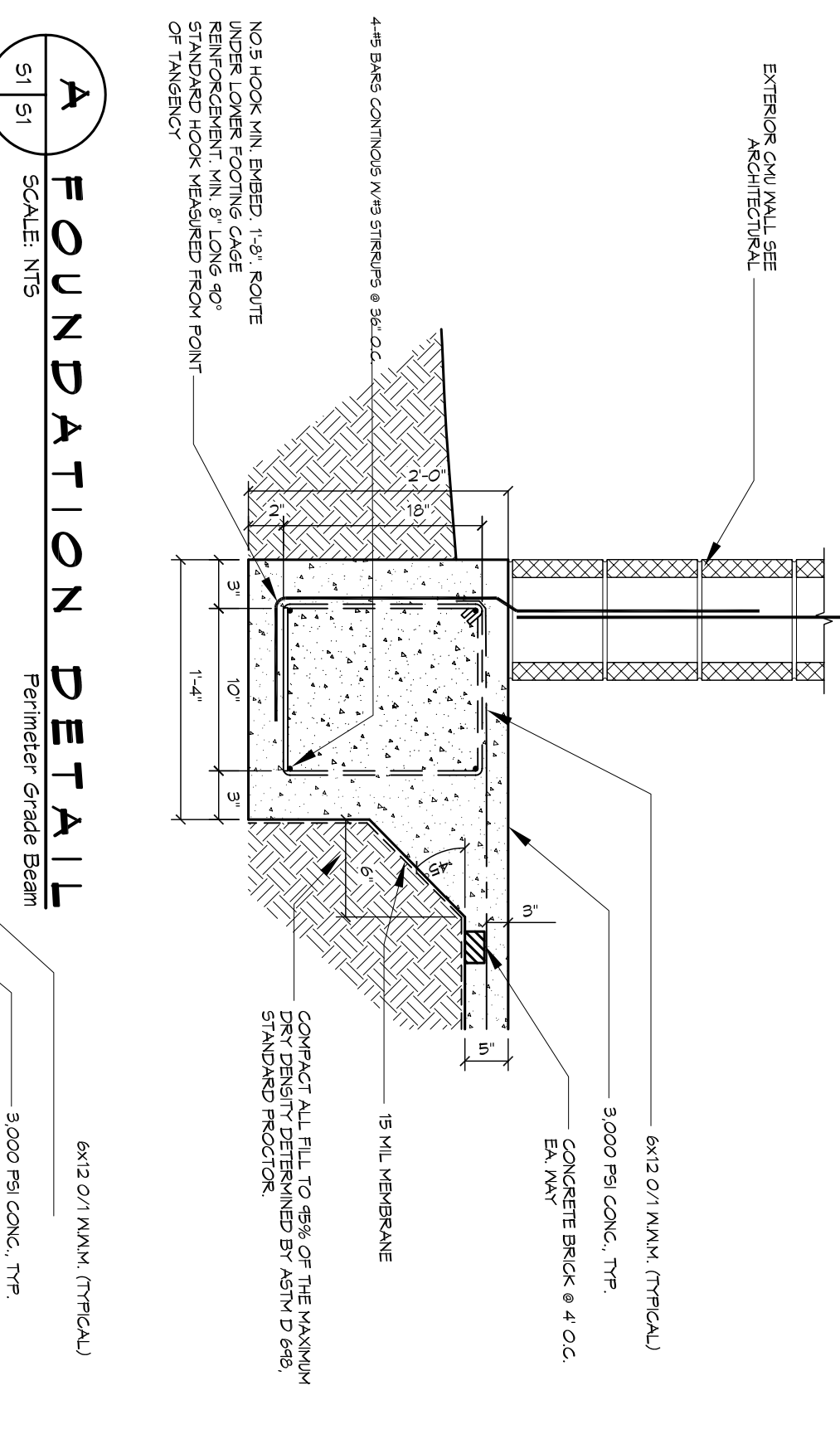
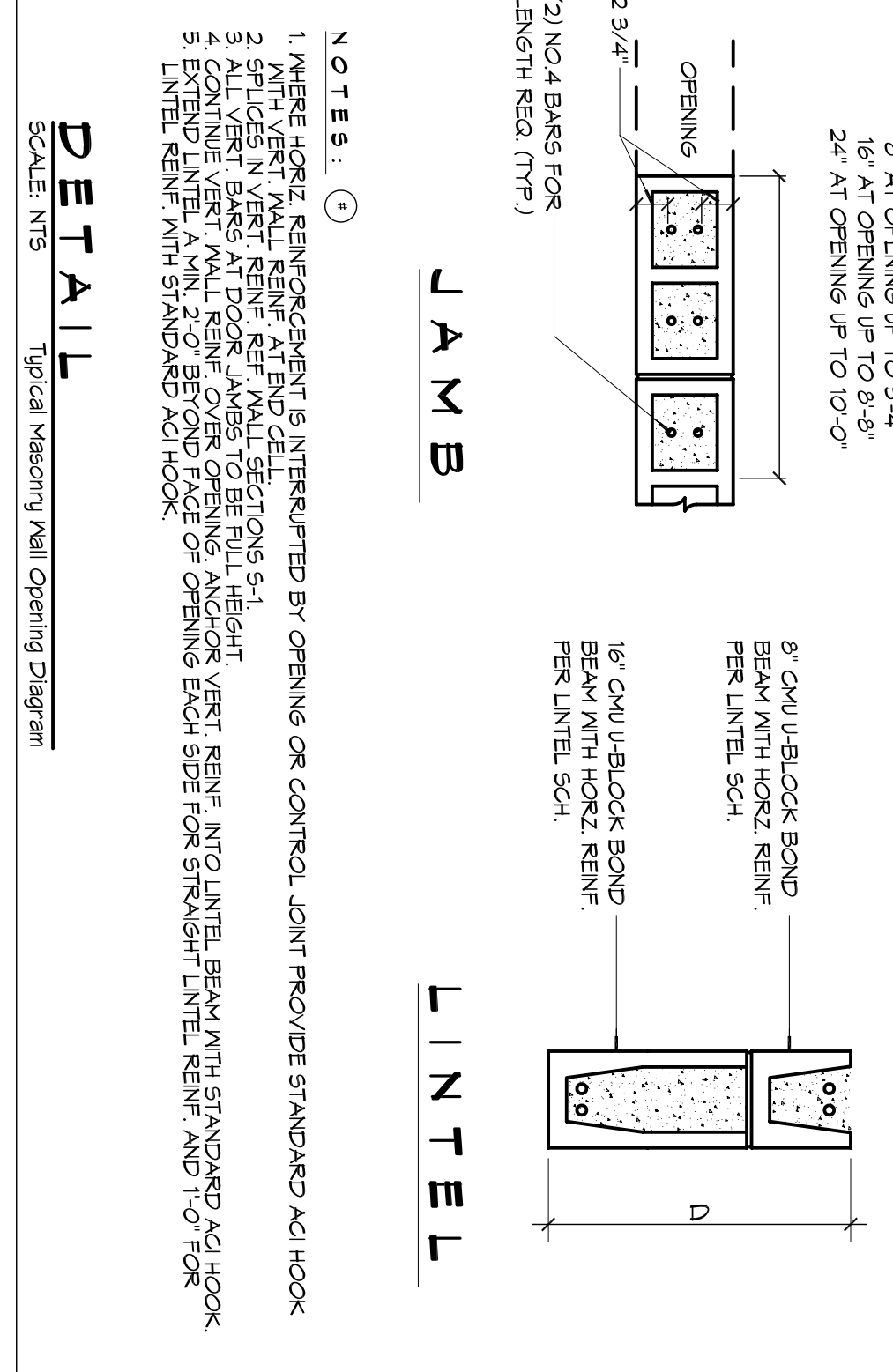
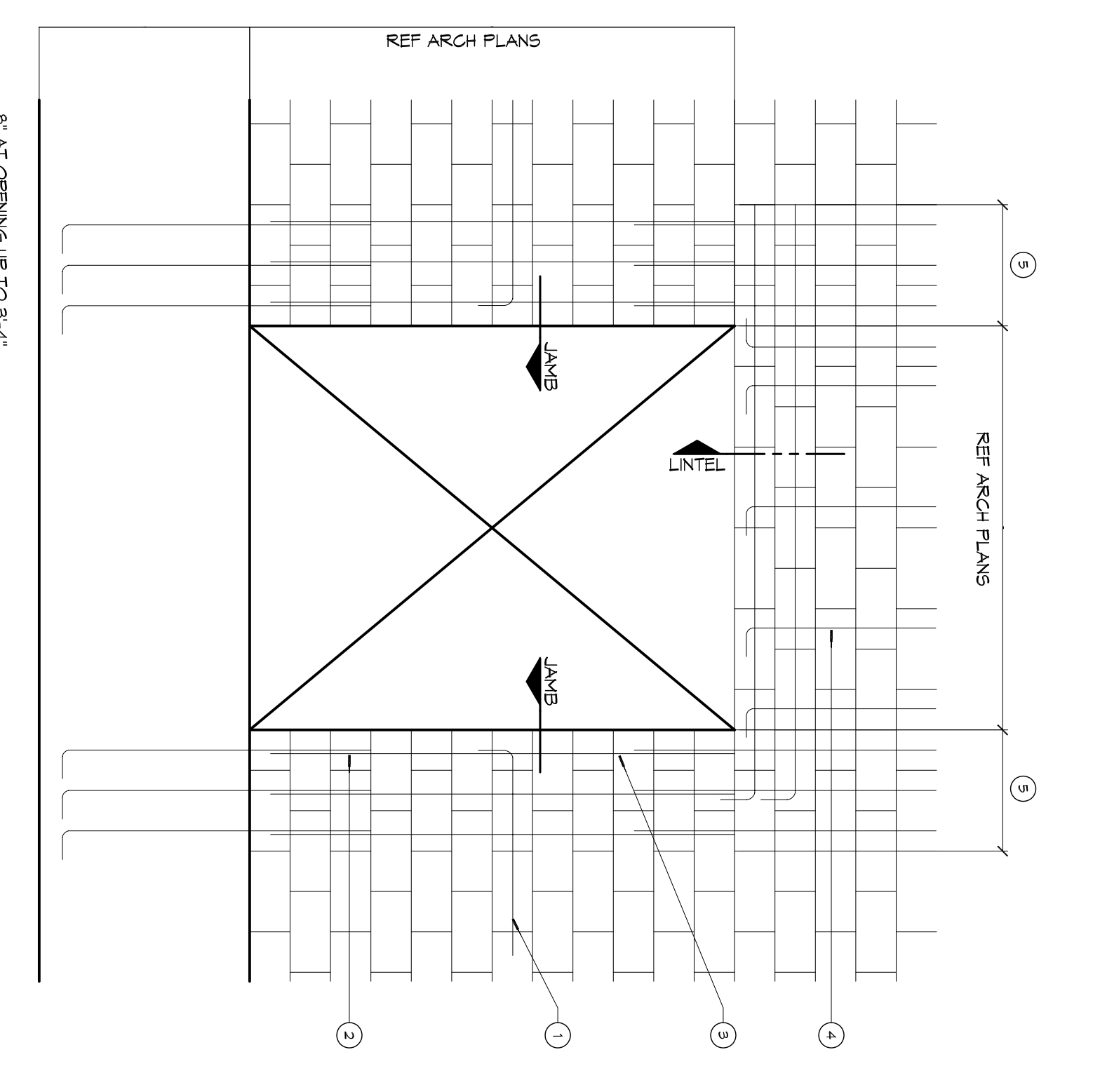
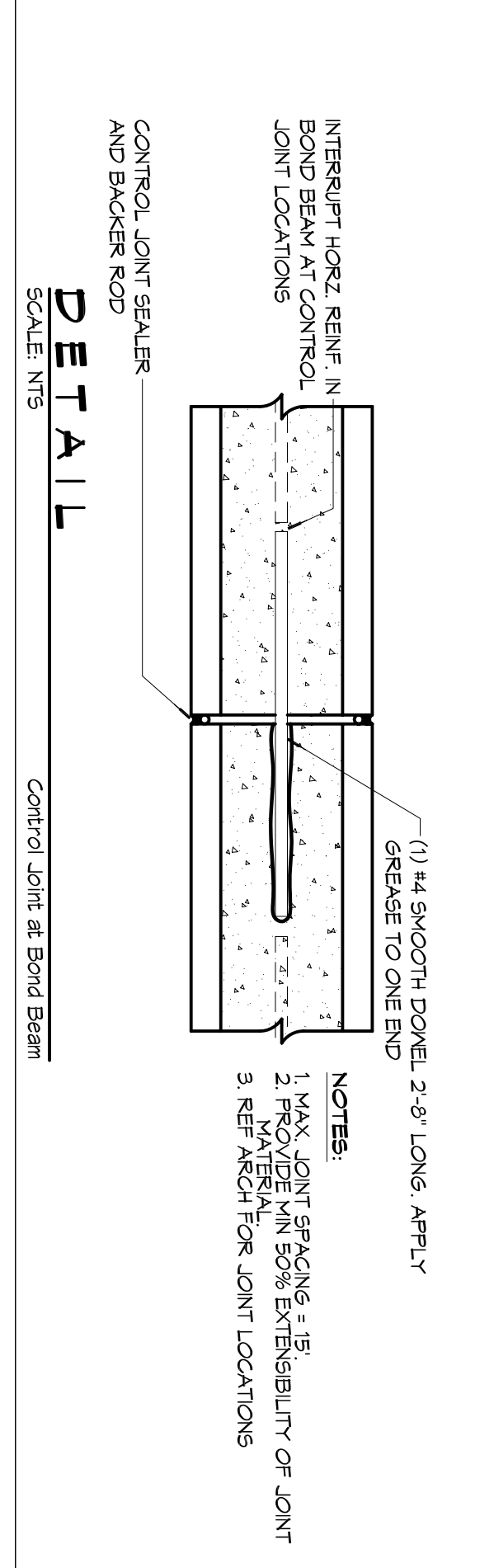
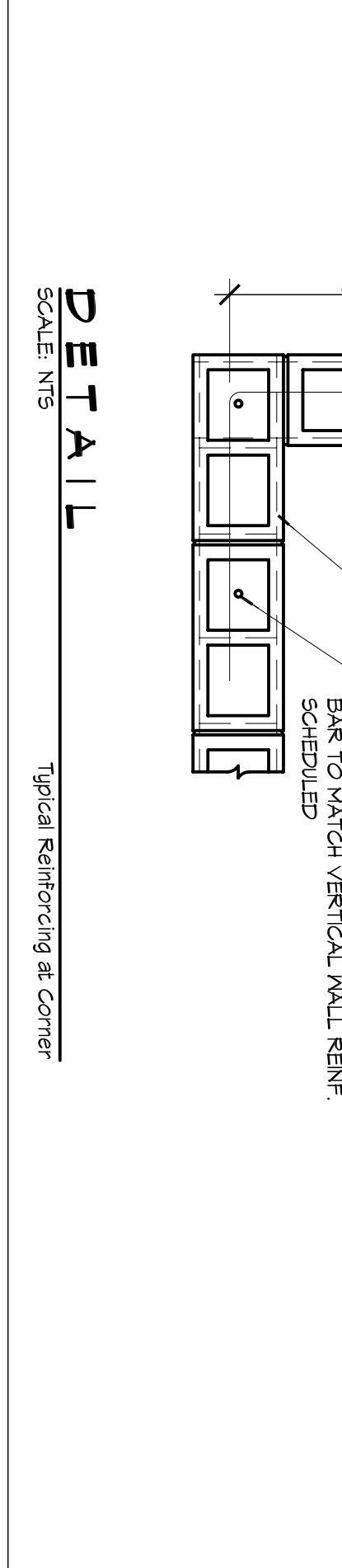
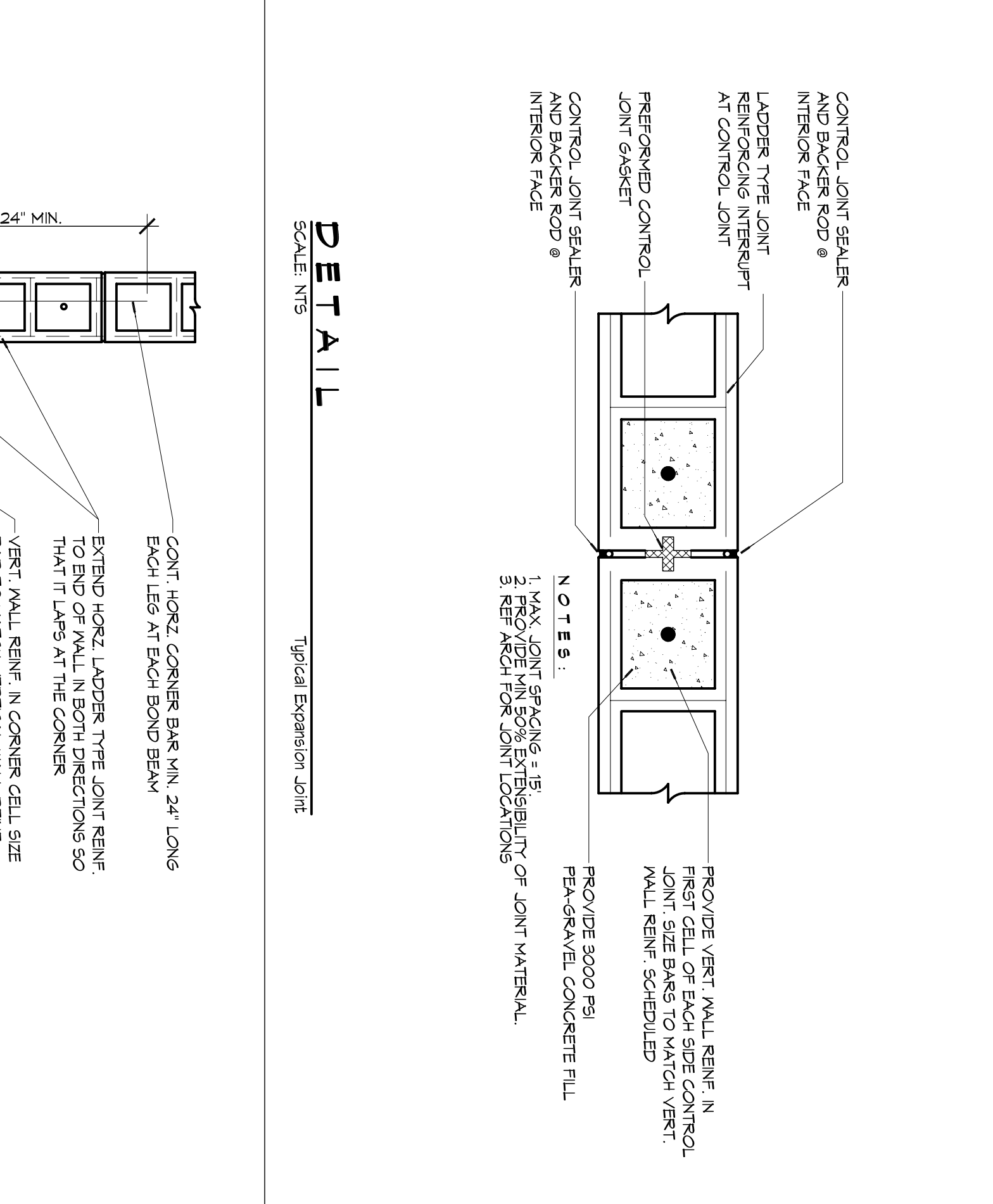
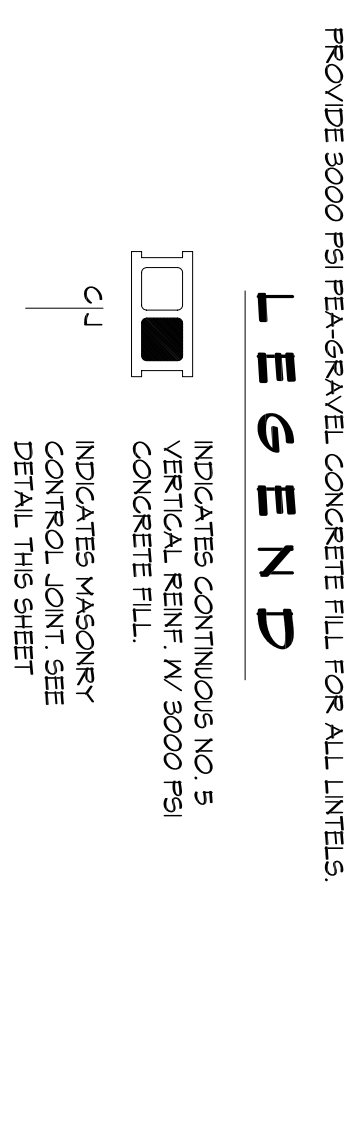

FOUNDATION NOTES

1. THE CONCRETE MIX SHALL HAVE A MINIMUM COMPRESSIVE STRENGTH OF 4,000 PSI AT 28 DAYS. CONCRETE MIX SHALL BE IN ACCORDANCE WITH ACI-318.
2. ALL CONVENTIONAL REINFORCING STEEL SHALL MEET ASTM-A615 (GRADE 60).
3. ONE LAYER OF POLYETHYLENE VAPOUR BARRIER SHALL BE PLACED UNDER CONCRETE FOUNDATION. VAPOUR BARRIER TO BE 15 MIL. BY TENSOR OR EQUIVALENT. PROVIDE APPROPRIATE ACCESSORIES FOR A COMPLETE SYSTEM.
4. ALL REINFORCING STEEL AND MESH SHALL BE SECURELY SUPPORTED TO PREVENT BOTH VERTICAL AND HORIZONTAL MOVEMENT DURING CONCRETE PLACEMENT.
5. THE CONTRACTOR SHALL VERIFY ALL DIMENSIONS, BRICK LEDGES, DIMENSIONS AND CONFIGURATIONS. CONTRACTOR MUST BE RESPONSIBLE FOR SAME.
6. GRADE BEAM STEEL SHALL VARY BY -5% - +20%.
7. GRADE BEAM STEEL SHALL BE SELECTED GRANULAR MATERIAL COMPACTED TO 95% STANDARD PROCTOR DENSITY IN A MAXIMUM OF 6" LIFTS.
8. ALL RUNOFF WATER MUST BE CARRIED AWAY FROM THE SLAB TO PREVENT SATURATION OF THE SLAB BASE.
9. ALL TREES WITHIN CLOSE PROXIMITY SHALL BE REMOVED TO PREVENT THE ROOTS FROM EXTENDING UNDER THE SLAB.
10. PROVIDE AND MAINTAIN IMMEDIATE SITE DRAINAGE BEFORE, DURING, AND AFTER CONSTRUCTION. PROVIDE GRADING, SWELLS, AND SLUMP PIPING AS MAY BE REQUIRED TO IMMEDIATELY DRAIN ALL RAINWATER FROM THE CONSTRUCTION AREA. FOOTING EXCAVATIONS SHOULD BE OBSERVED AND CONCRETE PLACED AS SOON AS POSSIBLE TO AVOID EXPOSURE OF THE FOOTING BOTTOMS TO WETTING AND DRYING. CONCRETE PLACEMENT IF IT IS REQUIRED THAT A FOOTING EXCAVATION BE LEFT OPEN FOR MORE THAN ONE DAY, THEY SHOULD BE PROTECTED TO REDUCE EVAPORATION OR ENTRY OF MOISTURE.
11. TREAT SOIL BELOW SLAB FOR TERMITES.

SITE PREP NOTES

1. REMOVE EXISTING SURFACE TO A DEPTH OF 2 FT. AND REPLACE WITH STRUCTURAL FILL. PROOF-ROLL WITH A RUBBER Tired VEHICLE WEIGHING 20 TONS.
2. PROVIDE AND MAINTAIN IMMEDIATE SITE DRAINAGE BEFORE, DURING AND AFTER CONSTRUCTION. PROVIDE GRADING, SWELLS AND SLUMP PIPING AS MAY BE REQUIRED TO IMMEDIATELY DRAIN ALL RAINWATER FROM THE CONSTRUCTION AREA. FOOTING EXCAVATIONS SHOULD BE OBSERVED AND CONCRETE PLACED AS SOON AS POSSIBLE TO AVOID EXPOSURE OF THE FOOTING BOTTOMS TO WETTING AND DRYING. CONCRETE PLACEMENT IF IT IS REQUIRED THAT A FOOTING EXCAVATION BE LEFT OPEN FOR MORE THAN ONE DAY, THEY SHOULD BE PROTECTED TO REDUCE EVAPORATION OR ENTRY OF MOISTURE.
3. TREAT SOIL BELOW SLAB FOR TERMITES.

DAMMON ENGINEERING, INC.

Architects & Engineers

Chief Architect: Kevin J. Kinchen, NCARB
 Chief Engineer: Brian Mistic, PE
 554 Old Spanish Trail
 Slidell, LA 70458

www.dammonengineering.com
 info@dammonengineering.com
 PH: 985.649.5832
 F: 985.641.5930

REVISIONS	DATE
# DESCRIPTION	

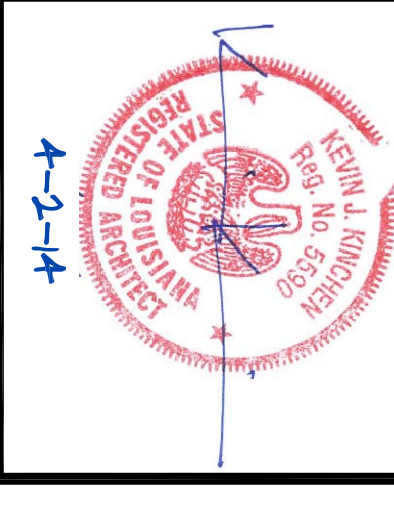

CITY OF SLIDELL
 TOWN OF TOWNSHIP
 FOUNDATION PLAN AND DETAILS

2602 2nd STREET
 SLIDELL, LOUISIANA, 70458

JOB NO: 2170 DATE: 4/2/2014
 DRAWN BY: DPD CHECKED BY: KJ

SHEET NO: 3 OF 8