

**IRRIGATION SCHEDULE**

SYMBOL	MANUFACTURER/MODEL/DESCRIPTION	QTY	ESI	GPM	RADIUS
	Rain Bird 1806 15 Strip Series Turf Spray 6.0" Pop-Up Sprinkler with Co-Molded Wiper Seal, Side and Bottom Inlet, 1/2" NPT Female Threaded Inlet.	6	30		
	Rain Bird 1806 5 Series MPR Turf Spray 6.0" Pop-Up Sprinkler with Co-Molded Wiper Seal, Side and Bottom Inlet, 1/2" NPT Female Threaded Inlet.	26	30		
	Rain Bird 1806 8 Series MPR Turf Spray 6.0" Pop-Up Sprinkler with Co-Molded Wiper Seal, Side and Bottom Inlet, 1/2" NPT Female Threaded Inlet.	8	30		
	Rain Bird 1806 10 Series MPR Turf Spray 6.0" Pop-Up Sprinkler with Co-Molded Wiper Seal, Side and Bottom Inlet, 1/2" NPT Female Threaded Inlet.	13	30		
	Rain Bird 1806 12 Series MPR Turf Spray 6.0" Pop-Up Sprinkler with Co-Molded Wiper Seal, Side and Bottom Inlet, 1/2" NPT Female Threaded Inlet.	8	30		
	Rain Bird 1806 15 Series MPR Turf Spray 6.0" Pop-Up Sprinkler with Co-Molded Wiper Seal, Side and Bottom Inlet, 1/2" NPT Female Threaded Inlet.	8	30		
	Rain Bird 1806 ADJ Turf Spray 6.0" Pop-Up Sprinkler with Co-Molded Wiper Seal, Side and Bottom Inlet, 1/2" NPT Female Threaded Inlet.	11	30		
	Rain Bird 1806 ADJ Turf Spray 6.0" Pop-Up Sprinkler with Co-Molded Wiper Seal, Side and Bottom Inlet, 1/2" NPT Female Threaded Inlet.	2	30		
	Rain Bird 1806 5 Series MPR Shrub Spray 5.0" Pop-Up Sprinkler with Co-Molded Wiper Seal, Side and Bottom Inlet, 1/2" NPT Female Threaded Inlet.	9	30		
	Rain Bird 1806 8 Series MPR Shrub Spray 5.0" Pop-Up Sprinkler with Co-Molded Wiper Seal, Side and Bottom Inlet, 1/2" NPT Female Threaded Inlet.	12	30		
	Rain Bird 1806 10 Series MPR Shrub Spray 5.0" Pop-Up Sprinkler with Co-Molded Wiper Seal, Side and Bottom Inlet, 1/2" NPT Female Threaded Inlet.	4	30		
	Hunter PGP-ADJ Turf Rotor, 4.0" Pop-Up, Adjustable and Full Circle, Standard Angle Red Nozzle, Lower Precipitation Rate.	18	40	0.60	29'

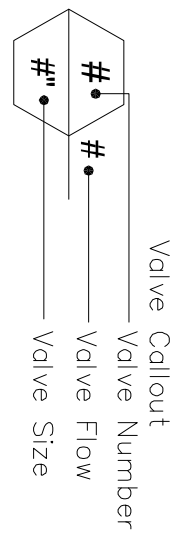

**IRRIGATION PLAN**  
SCALE: 1"=20'-0"

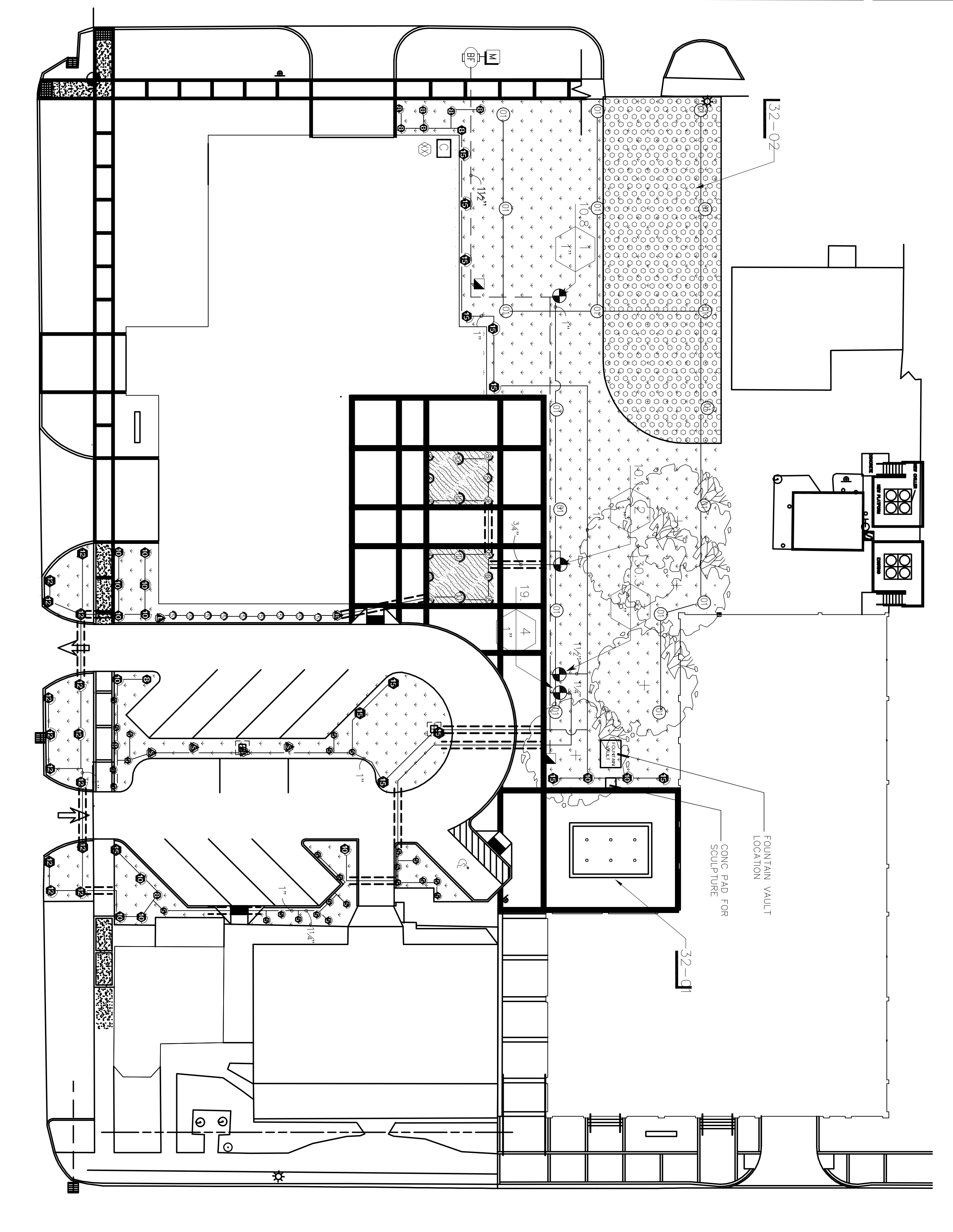

**VALVE SCHEDULE**

NUMBER	MODEL	SIZE	TYPE	WIRE	ESI	ESI @ POC	GPM	PRECIP
1	Rain Bird PGA Angle	1"	Turf Rotor	107.0	46.58	49.62	10.80	0.17 in/h
2	Rain Bird PGA Angle	1"	Shrub Spray	185.4	36.95	40.16	10.10	1.09 in/h
3	Rain Bird PGA Angle	1"	Turf Spray	217.2	40.94	50.81	30.26	0.96 in/h
4	Rain Bird PGA Angle	1"	Turf Spray	222.8	41.91	47.70	19.72	1.12 in/h

**REFERENCE NOTES SCHEDULE**

- 32-01** 32 EXTERIOR IMPROVEMENTS QTY DETAIL
- 32-02** Foundation shall be design build by contractor and dimensioned as shown with 26" high seatwall surround. Seatwall / surround shall have concrete cap. Fountain shall feature six (6) bubbler type. Final design shall be submitted to landscape architect for approval. nozzles to create a min. 3h jet. See detail
- 32-03** Grasspaved by manufacturer. See detail

**CRITICAL ANALYSIS**

Generated: 2013-04-08 15:25  
 P.O.C. NUMBER: 01  
 Water Source Information: Mike Noto - 985-290-7388  
 FLOW AVAILABLE  
 Water Meter Size: 1-1/2"  
 Flow Available: 75,000 gpm  
 PRESSURE AVAILABLE  
 Static Pressure at POC: 65.00' psi  
 Elevation Change: 2.00' ft  
 Service Line Size: 20,000 ft  
 Pressure Available: 62.00' psi  
 DESIGN ANALYSIS  
 Maximum Station Flow: 30.26 gpm  
 Flow Available at POC: 75,000 gpm  
 Residual Flow Available: 44.74 gpm  
 Critical Station:  
 Station Number: 3  
 Loss for Friction: 30.00 psi  
 Loss Elev. high head to valve: 0.00 psi  
 Pipe Loss Critical Head: 4.90 psi  
 Loss Fitting Factor: 0.49 psi  
 Loss through Valve: 5.55 psi  
 Pressure Req. at Critical Station: 40.94 psi  
 Loss for Fittings: 0.49 psi  
 Loss for Main Line: 4.93 psi  
 Loss for POC to Valve Elevation: 2.6 psi  
 Loss for Water Meter: 1.84 psi  
 Critical Station Pressure at POC: 50.81 psi  
 Pressure Available: 62.00 psi  
 Residual Pressure Available: 11.19 psi

**Eric R. McQuiston L.L.C.**  
Landscape Architecture

**DAMMON ENGINEERING, INC.**  
Architects & Engineers

CHIEF ENGINEER, EMMETT DAMMON, P.E.  
 CHIEF ARCHITECT, KEVIN KINCHEN  
 554 OLD SPANISH TRAIL  
 SLIDELL, LA 70456  
 dammonengineering.com  
 dammoneng@bellsouth.net  
 PHONE: 985-649-5832  
 FAX: 985-641-5950

**CITY HALL PARKING LOT & COURTYARD**

BOULEVARD STREET  
 SLIDELL, LA  
 JOB No: 2172 DATE: 05-30-13  
 DRAWN BY: ERM CHECKED BY:

REVISIONS

#	DESCRIPTION	DATE

LANDSCAPE IRRIGATION PLAN

SHEET No: 9 OF 11  
**L1.2**