

**LEGEND**

- BUILDING
- EXISTING RIGHT OF WAY
- SERVITUDE
- CATCH BASIN
- CULVERT
- DROP INLET, DRAIN LINE
- DROP INLET, DRAIN LINE
- COMMUNICATIONS MANHOLE, LINE
- DRAIN MANHOLE, DRAIN LINE
- ELECTRICAL MANHOLE, ELEC. LINE
- GAS MANHOLE, GAS LINE
- SEWER MANHOLE, SEWER LINE
- TELEPHONE MANHOLE, TELE LINE
- TRAFFIC MANHOLE, TRAFFIC LINE
- WATER MANHOLE, WATER LINE
- UTILITY POLE / OVERHEAD LINES  
ELECTRIC, TELEPHONE, CABLE TV
- FIBER OPTIC RISER / LINE
- FENCE
- TELCO RISER / PEDISTAL
- UTILITY CLEANOUT
- UTILITY METER
- UTILITY PEDESTAL
- UTILITY VALVE
- UTILITY VALVE VAULT
- FIRE HYDRANT
- LIGHT STANDARD
- TRAFFIC SIGNAL POLE
- TRAFFIC LIGHT POWER VAULT
- CANOPY SUPPORT
- BOLLARD
- SIGN
- TREE
- RESIDENTIAL MAILBOX
- PP DEADMAN

**GENERAL NOTES**

THE LOCATIONS OF UNDERGROUND AND OTHER NONVISIBLE UTILITIES SHOWN HEREON HAVE BEEN DETERMINED FROM DATA EITHER FURNISHED BY THE AGENCIES CONTROLLING SUCH DATA AND/OR EXTRACTED FROM RECORDS MADE AVAILABLE TO US BY THE AGENCIES CONTROLLING SUCH RECORDS. WHERE FOUND, THE SURFACE FEATURES OF LOCATIONS ARE SHOWN. THE ACTUAL NONVISIBLE LOCATIONS MAY VARY FROM THOSE SHOWN HEREON. EACH AGENCY SHOULD BE CONTACTED RELATIVE TO THE PRECISE LOCATION OF ITS UNDERGROUND INSTALLATION PRIOR TO ANY RELIANCE UPON THE ACCURACY OF SUCH LOCATIONS SHOWN HEREON, INCLUDING PRIOR TO EXCAVATION AND DIGGING.

**BASIS OF ELEVATION**

ELEVATIONS SHOWN ON THIS SURVEY ARE BASED ON THE NORTH AMERICAN VERTICAL DATUM OF 1988 (NAVD88) UTILIZING GEOID 12A. THEY ARE DERIVED FROM GPS OBSERVATIONS REFERENCED TO THE LOUISIANA STATE UNIVERSITY CONTINUOUSLY OPERATING REFERENCE STATIONS NETWORK IN ACCORDANCE WITH LOUISIANA R.S. 50:173.1 COVERING VERTICAL CONTROL STANDARDS.

**SERVITUDES**

THE SERVITUDES AND RESTRICTIONS SHOWN ON THIS SURVEY ARE LIMITED TO THOSE SET FORTH IN THE DESCRIPTION FURNISHED US AND THERE IS NO REPRESENTATION THAT ALL APPLICABLE SERVITUDES AND RESTRICTIONS ARE SHOWN HEREON. THE SURVEYOR HAS MADE NO TITLE SEARCH OR PUBLIC RECORD SEARCH IN COMPILING THE DATA FOR THIS SURVEY.

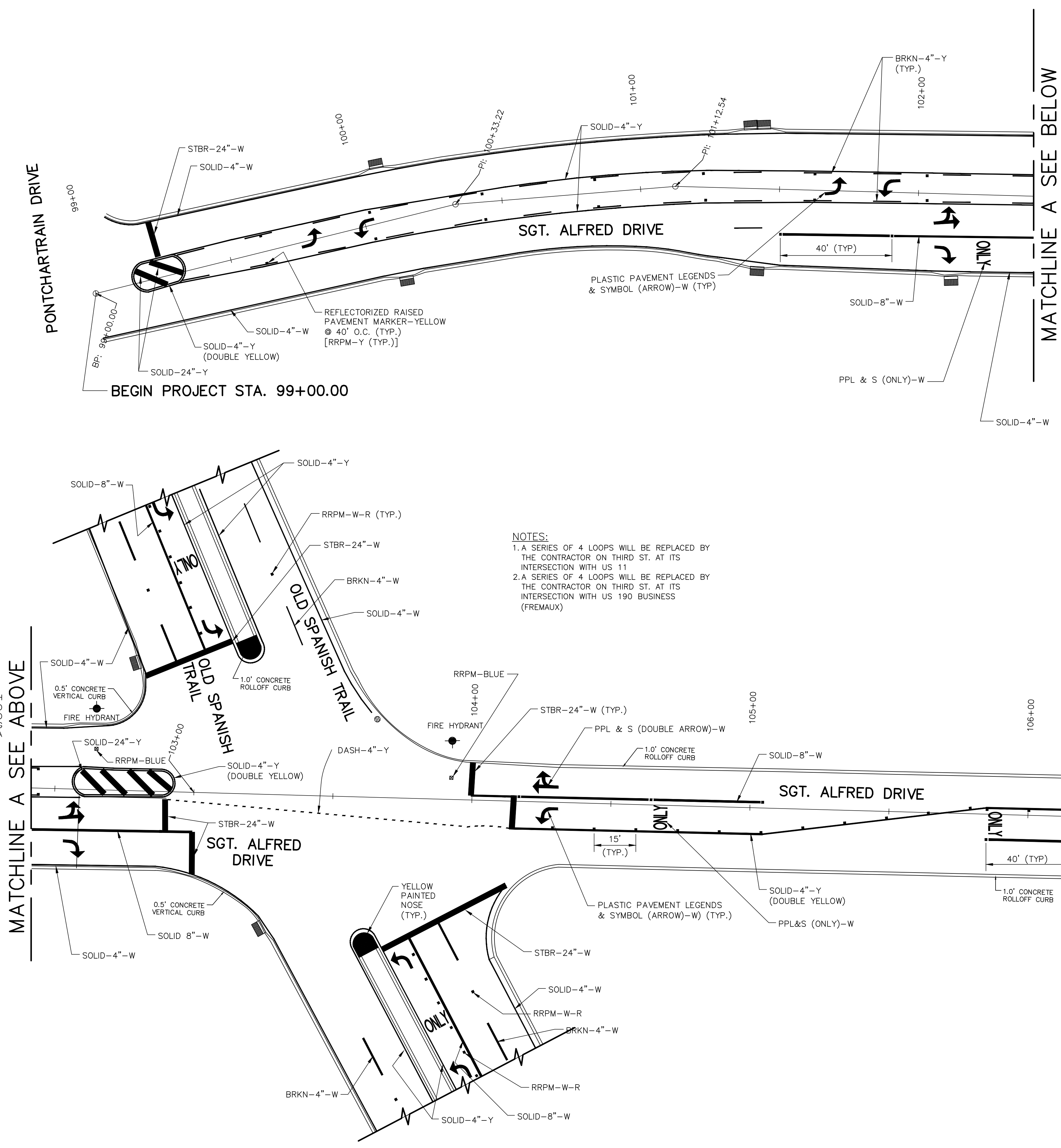

**NOTES:**

1. A SERIES OF 4 LOOPS WILL BE REPLACED BY THE CONTRACTOR ON THIRD ST. AT ITS INTERSECTION WITH US 11
2. A SERIES OF 4 LOOPS WILL BE REPLACED BY THE CONTRACTOR ON THIRD ST. AT ITS INTERSECTION WITH US 190 BUSINESS (FREMAUX)

**LEGEND:**

- EX. WATER METER
- EX. WATER VALVE
- EX. TELEPHONE MANHOLE
- EX. OVERHEAD TRAFFIC SIGNAL
- EX. TRAFFIC SIGN
- NEW TRAFFIC SIGN
- TRAFFIC DIRECTION, FOR INFORMATION ONLY
- SOLID-4"-W . . . THERMOPLASTIC PAVEMENT STRIPING SOLID-4"-WHITE
- SOLID-4"-Y . . . THERMOPLASTIC PAVEMENT STRIPING SOLID-4"-YELLOW
- SOLID-8"-W . . . THERMOPLASTIC PAVEMENT STRIPING SOLID-8"-WHITE
- BRKN-4"-W . . . THERMOPLASTIC PAVEMENT STRIPING BROKEN-4"-WHITE
- BRKN-4"-Y . . . THERMOPLASTIC PAVEMENT STRIPING BROKEN-4"-YELLOW
- DASH-4"-Y . . . THERMOPLASTIC PAVEMENT STRIPING DASH-4"-YELLOW
- CRWK-8"-W . . . THERMOPLASTIC PAVEMENT CROSS WALK SOLID-8"-WHITE
- STBR-24"-W . . . THERMOPLASTIC PAVEMENT STOP BAR SOLID-24"-WHITE
- PPL&S (ARROW)-W . . . THERMOPLASTIC PAVEMENT LEGENDS & SYMBOLS-ARROW-WHITE
- PPL&S (ONLY)-W . . . THERMOPLASTIC PAVEMENT LEGENDS & SYMBOLS-ONLY-WHITE
- PPL&S (SCHOOL)-Y . . . THERMOPLASTIC PAVEMENT LEGENDS & SYMBOLS-SCHOOL-YELLOW
- RRPM-W-R . . . REFLECTORIZED RAISED PAVEMENT MARKER-WHITE-RED
- RRPM-Y . . . REFLECTORIZED RAISED PAVEMENT MARKER-YELLOW
- NRRPM-Y . . . NONREFLECTORIZED RAISED PAVEMENT MARKER-YELLOW

MATCHLINE B SEE SHEET TWO

MATCHLINE A SEE ABOVE

MATCHLINE A SEE BELOW

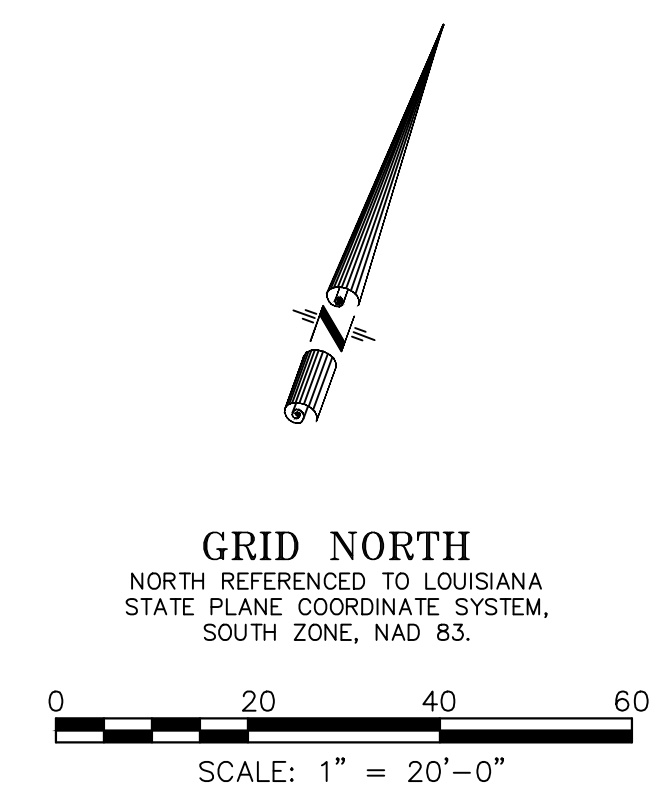

**CITY OF SLIDELL ENGINEERING DEPARTMENT**

NO.	DATE	DESCRIPTION	REVISIONS	BY	RAC
1	9.7.16	GENERAL STRIPING	REVISIONS		

**Infinity Engineering Consultants, LLC**  
 CIVIL STRUCTURAL ELECTRICAL MARINE  
 504-300-0548  
 NEW ORLEANS, LA  
 EC PROJECT NO. 14-004  
 DRAWN BY: PHAN THI NGUYEN  
 DESIGN/CHECK BY: TUNG THANH N'VIETSON  
 APPROVED BY: TUNG THANH N'VIETSON

**SGT. ALFRED DRIVE ROADWAY IMPROVEMENTS**  
 CITY OF SLIDELL, LA.  
**STRIPING PLANS (SHEET 1 OF 7)**

City Project No. 600-141  
 Date MAY 2016  
 Scale AS NOTED  
 Sheet 11 OF 22