

LEGEND

- - - - - PROPERTY LINE
- ○ ○ ○ ○ FENCE LINE
- - - - - WIRING
- AA ☼ - 2 @ 90° LUMINAIRE
250W 277V HP SODIUM
- ◀ JJ - LANDSCAPE UPLIGHT

NOTE:

ALL UTILITIES SHALL BE INSTALLED UNDERGROUND.

SITE LIGHTING

EXTERIOR LIGHTING SHALL BE SHADED OR INWARDLY DIRECTED IN SUCH A MANNER SO THAT NO DIRECT LIGHTING OR GLARE IS CAST BEYOND THE PROPERTY LINE. THE INTENSITY OF SUCH LIGHTING SHALL NOT EXCEED ONE FOOT CANDLE AS MEASURED AT THE ABUTTING PROPERTY LINE.

LUMINAIRE TYPE SUMMARY

QUANTITY

TYPE BRAND NAME CATALOG NUMBER

DESCRIPTION

- AA (P2) 1 (53) ON A 30' POLE WITH A 2 FOOT PEDESTACK
- AA (P3) 1 (54) ON A 30' POLE WITH A 2 FOOT PEDESTACK
- BB 1 (55) ON A 30' POLE
- BB1 1 (56) ON A 30' POLE
- JJ 1 (57) GROUND MOUNTED
- X416 1 (58) POST MOUNTED

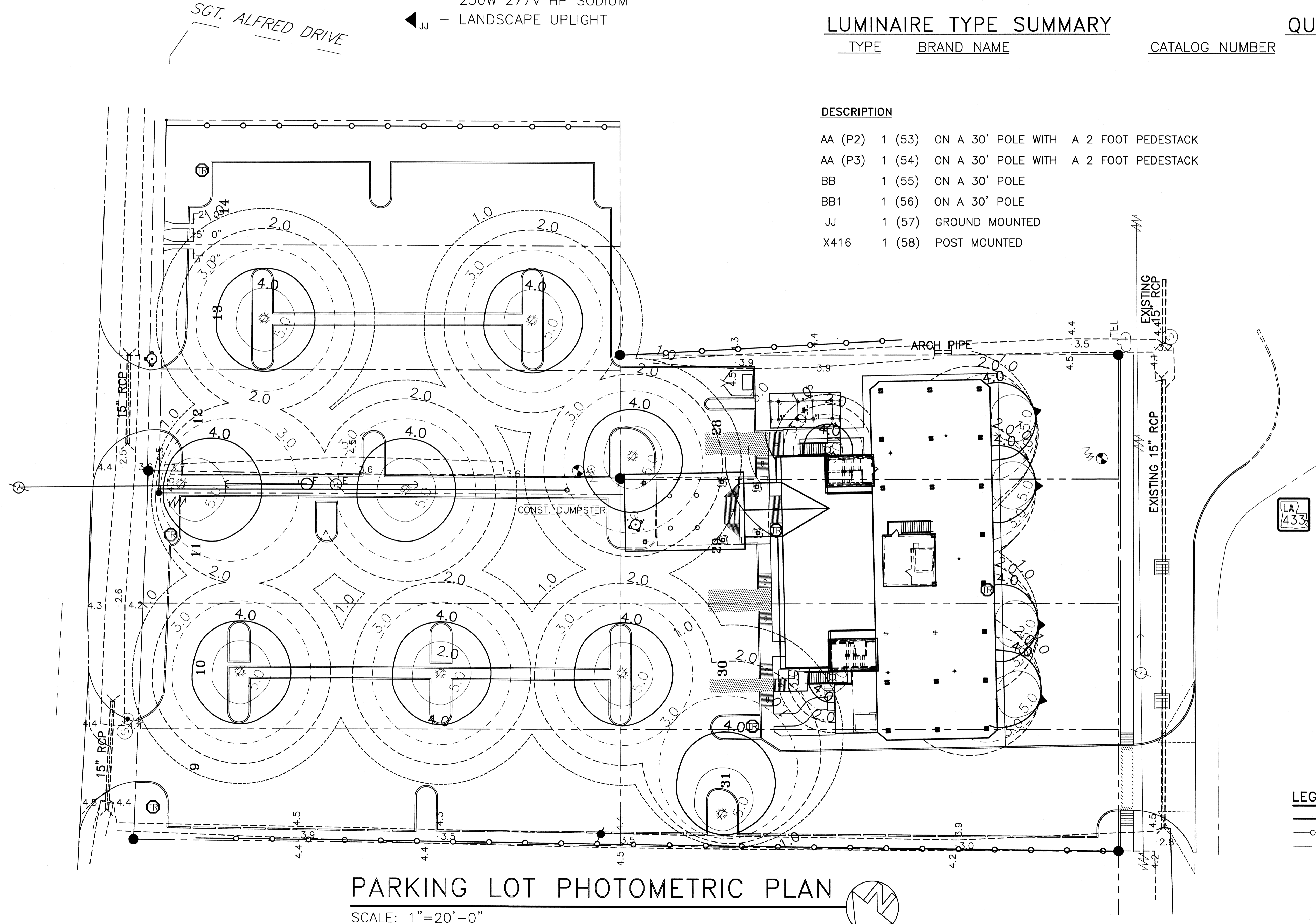

LEGEND

- - - - - PROPERTY LINE
- ○ ○ ○ ○ FENCE LINE
- - - - - WIRING
- ☼ - 2 @ 90° LUMINAIRE
250W 277V HP SODIUM
- ◀ - LANDSCAPE UPLIGHT

RENOVATE OFFICE BUILDING

PARKING LOT PHOTOMETRIC PLAN

ST. TAMMANY PARISH OFFICE BUILDING
520 OLD SPANISH TRAIL
SLIDELL, LOUISIANA

DAMMON ENGINEERING, INC.
1095 FLORIDA AVENUE 985-649-5832 SLIDELL, LA. 70458
DAMMONENGINEERING.COM

SCALE: 1"=20'

FILE:

JOB NO. 1729

DATE: 1-8-07

SHEET

E15

OF

REVISED: 03-07-07cb

CONTRACT SET- 10/10/07