

AREAS OF FILL
 AREAS OF CUT

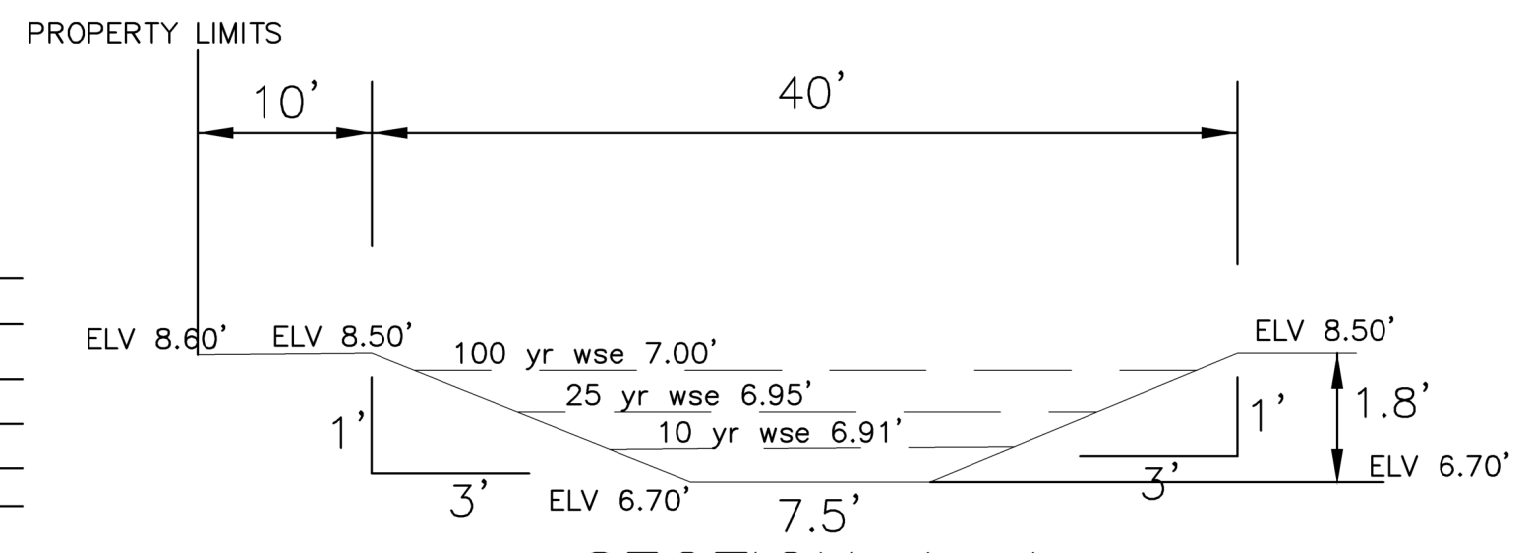
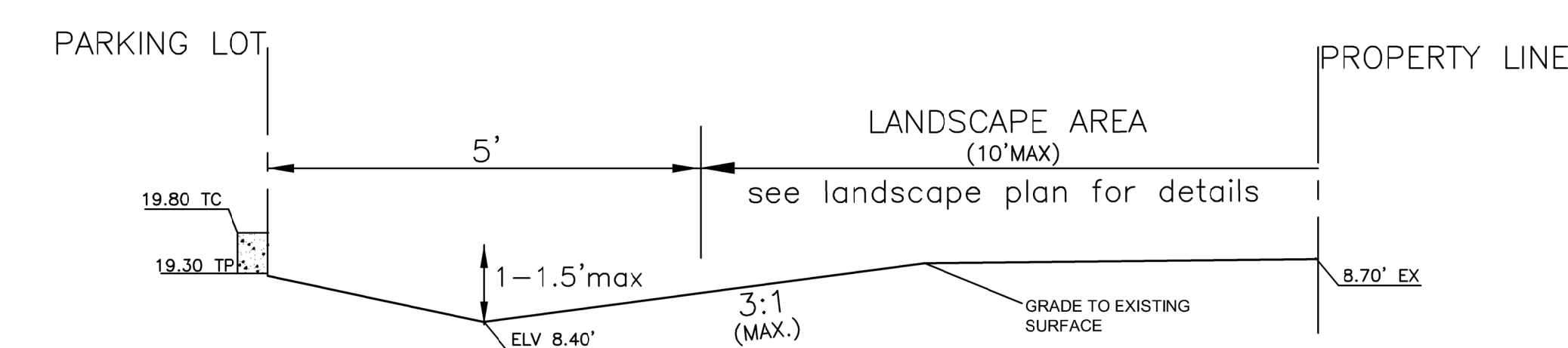

SECTION B-B
NOT TO SCALE
INSTALL BERMS/HIGH POINTS TO DRAIN MAJORITY FLOW TOWARDS PARKING LOT LIMITS

SECTION A-A
NOT TO SCALE
NOTE: 9847+/- AREA S.F. OF CUT
1.55ft x 9847 sf = 565 CY

CUT/Fill MITIGATION VOLUME BFE = 13

Name	2d Area	DEPTH	Cut	Fill	Net
GARAGE	2000 Sq. Ft.	0.00 Cu. Yd.	133 Cu. Yd.	133 Cu. Yd.<Fill>	
Quarters	2561 Sq. Ft.	0.00 Cu. Yd.	95 Cu. Yd.	95 Cu. Yd.<Fill>	
Parking lot & landscape	10000 Sq. Ft.	0.00 Cu. Yd.	370 Cu. Yd.	278 Cu. Yd.<Fill>	
Pond	8807 Sq. Ft.	427 Cu. Yd.	0.00 Cu. Yd.	565 Cu. Yd.<Cut>	
Total					57 Cu. Yd.<CUT>

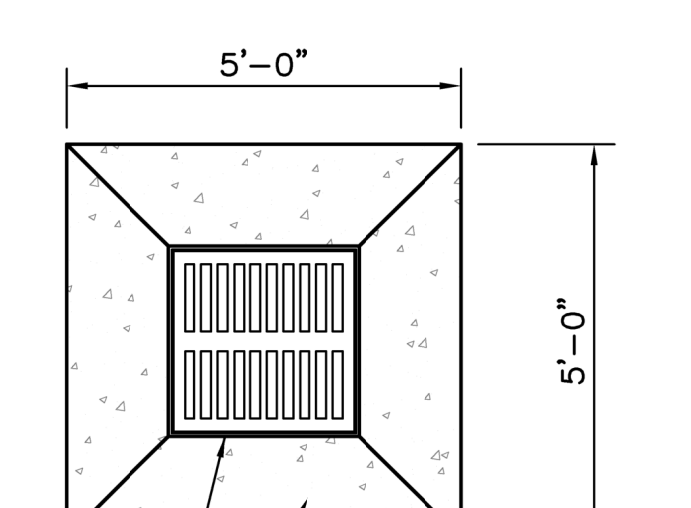
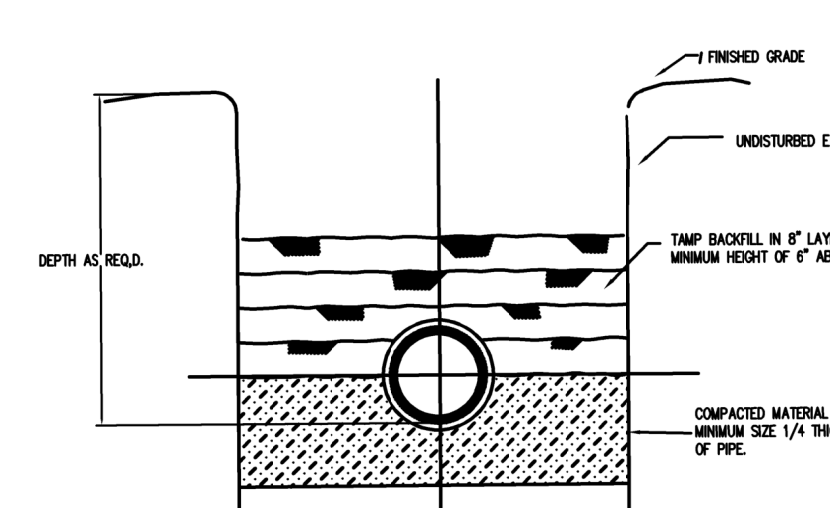
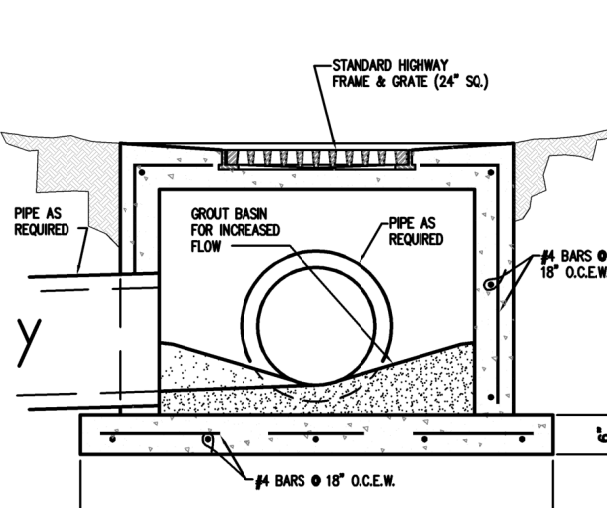

NOTE: 1. THE BEDDING DEPTH BENEATH THE CATCH BASIN SHALL BE 6" Limestone COMPACTED TO SOE MOD. ST. PROCTOR.
 2. THE CATCH BASIN SHALL BE BACKFILLED WITH AN APPROVED MATERIAL OR, IF APPROVED BY THE PROJECT ENGINEER, EXCAVATED MATERIAL MAY BE USED.
 NOTE: 1. THE BEDDING DEPTH BENEATH THE PIPE SHALL BE 6" Limestone COMPACTED TO SOE MOD. ST. PROCTOR.
 2. THE PIPE SHALL BE WRAPPED IN GEOTEXTILE FABRIC AT EACH JOINT.
 NOTE: GRATES TO BE FIELD PAINTED BLACK.

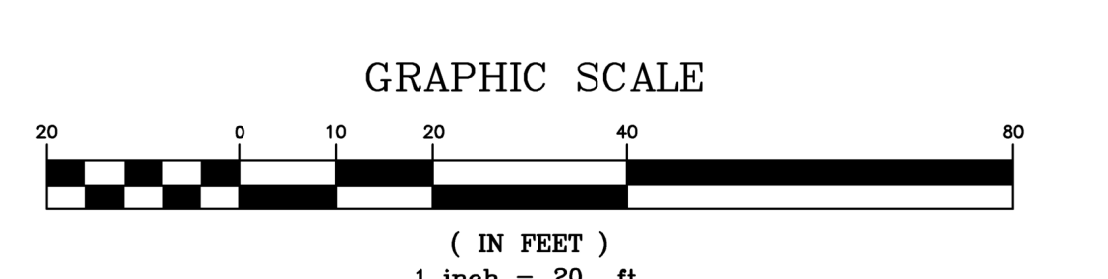

GRADING AND DRAINAGE NOTES :

- CONTRACTOR SHALL VERIFY TOP ELEVATIONS OF ALL DRAINAGE STRUCTURES IN FIELD AND SET FLOW LINE INVERT ELEVATIONS TO REFLECT DESIGN INDICATED IN CONSTRUCTION PLANS.
- CUT OR FILL SLOPES SHOULD NOT BE STEEPER THAN 3(H):1(V).
- ALL 3:1 SLOPES MUST BE STABILIZED WITH MATTING, MULCH AND OR PLANT MATERIAL TO ENSURE THAT RUNOFF AND SILT DOES NOT LEAVE PROJECT SITE.
- ALL EXCAVATED UNPAVED AREAS SHALL BE RESTORED BY SODDING OR HYDROSEEDING.
- ADJUST PAVEMENT AND/OR CURB ELEVATIONS AS NECESSARY TO ASSURE AS SMOOTH FIT AND CONTINUOUS GRADE WITH EXISTING.
- CONTRACTOR IS RESPONSIBLE FOR VERIFYING ALL UTILITIES AND NOTIFYING THE APPROPRIATE UTILITY COMPANY PRIOR TO BEGINNING CONSTRUCTION.
- CONTRACTOR SHALL VERIFY HORIZONTAL AND VERTICAL LOCATION OF ALL EXISTING STORM SEWER STRUCTURES, PIPES, AND ALL UTILITIES PRIOR TO CONSTRUCTION.
- CONTRACTOR IS RESPONSIBLE FOR REPAIRS OF DAMAGE TO ANY EXISTING IMPROVEMENTS DURING CONSTRUCTION, SUCH AS BUT NOT LIMITED TO DRAINAGE, UTILITIES, PAVEMENT, STRIPING, CURBS, ETC. REPAIRS SHALL BE EQUAL TO OR BETTER THAN EXISTING CONDITIONS.
- PROPOSED SPOT GRADES ARE SHOWN ARE TO TOP OF PAVEMENT UNLESS OTHERWISE NOTED.
- ALL UN-SURFACED AREAS DISTURBED BY GRADING OPERATIONS SHALL RECEIVE 4 INCHES OF TOPSOIL. CONTRACTOR SHALL APPLY STABILIZATION FABRIC TO ALL SLOPES 3H:1V OR STEEPER. CONTRACTOR SHALL GRASS DISTURBED AREAS IN ACCORDANCE WITH STANDARD SPECIFICATIONS UNTIL A HEAVY STAND OF GRASS IS OBTAINED.
- CONSTRUCTION SHALL COMPLY WITH ALL GOVERNING CODES AND BE CONSTRUCTED TO SAME.
- THE CONTRACTOR SHALL MAINTAIN DUST CONTROL ON SITE AT ALL TIMES BY WATERING SITE AS OFTEN AS NEEDED.
- CONTRACTOR SHALL FIELD VERIFY ELEVATIONS OF ADJACENT PROPERTIES TO SITE. IF EXISTING GRADES DO NOT MATCH THOSE SHOWN ON THIS PLAN, CONTRACTOR SHALL NOTIFY OWNERS PROJECT MANAGER.
- CONTRACTOR SHALL BE RESPONSIBLE FOR ANY TRAFFIC CONTROL NECESSARY FOR DRIVE DEMOLITION/CONSTRUCTION.
- ALL HANDICAP ACCESSIBLE RAMPS, SIDEWALKS, ROUTES, ETC. MUST BE CONSTRUCTED IN ACCORDANCE WITH FEDERAL, STATE, CITY STANDARDS. THE EVENT THESE REQUIREMENTS CANNOT BE MET J.V. BURKES & ASSOCIATES SHALL BE NOTIFIED PRIOR TO CONSTRUCTION FOR AN ALTERNATE SOLUTION.
- THE CONTRACTOR SHALL BALL AND FLUSH ALL SEWER AND STORM DRAIN LINES IN THE PRESENCE OF THE ENGINEER AND OWNER.
- THE CONTRACTOR SHALL AT ALL TIMES, PROVIDE AND MAINTAIN EMERGENCY ACCESS TO THE PROJECT SITE, IN ACCORDANCE WITH THE REQUIREMENTS OF THE FIRE PROTECTION AGENCY HAVING JURISDICTION OVER THE PROJECT SITE.
- THE CONTRACTOR SHALL ADJUST ALL UTILITY BOXES, MANHOLE COVERS, DRAIN INLETS, VALVE COVERS, ETC TO MATCH FINISH GRADE IN THE CONSTRUCTION AREA UNLESS OTHERWISE APPROVED BY THE ENGINEER.
- THE CONTRACTOR SHALL EXCAVATE FOR AND EXPOSE EXISTING UNDERGROUND UTILITIES WHERE CONNECTIONS ARE TO MADE PRIOR TO ANY CONSTRUCTION. SHOULD ANY ADJUSTMENTS IN LINE OR GRADE BE NECESSARY, THE CONTRACTOR SHALL BRING IT TO THE ATTENTION OF THE ENGINEER.
- THE CONTRACTOR SHALL COORDINATE UNDERGROUND UTILITY CONSTRUCTION IN SUCH A MANNER AS TO PREVENT ANY CONFLICT WHERE UTILITY LINES CROSS.
- ALL DRAINAGE PIPES SHALL HAVE A MIN SLOPE OF 0.15% UNLESS OTHERWISE NOTED.
- PRIOR TO FINAL DRAINAGE INSPECTION, ALL NEW POND & SWALE SLOPES SHALL BE HYDROSEEDED OR SODDED.
- PIPE SHALL BE R.C.P. C-76 CLASS III (UNLESS OTHERWISE NOTED).

LEGEND

	SEWER MANHOLE , SEWER LINE
	WATER MANHOLE , WATER LINE
	GAS MANHOLE , GAS LINE
	TELE. MANHOLE , TELE. LINE
	DRAIN MANHOLE , DRAIN LINE
	DRAIN INLET , DRAIN LINE
	POWER POLE / OVERHEAD LINES
	ELEC. TOWER / OVERHEAD LINES
	CATCH BASIN
	LIGHT STANDARD
	TRAFFIC LIGHT
	TELE. , ELEC. , CATV PEDESTAL
	GAS , WATER , ELECTRIC METER
	GAS , WATER VALVE
	SEWER , DRAIN CLEANOUT
	FIRE HYDRANT
	GUY WIRE ANCHOR
	SIGN
	PYLON
	MAILBOX
	TREE
	SHRUB
	FENCE

DRAINAGE LEGEND

	27.86' SW	PROPOSED TOP OF SIDEWALK ELEVATION
	27.86' TP	PROPOSED TOP OF FINISH PAVEMENT ELEVATION
	27.86' SW	PROPOSED TOP OF PAVEMENT & SIDEWALK ELEVATION
	27.86' TC	PROPOSED TOP OF CURB ELEVATION
	27.86' FL	PROPOSED FLOW LINE ELEVATION
	27.86' FG	PROPOSED FINISH GROUND ELEVATION (UNPAVED)
	X 27.86	EXISTING ELEVATION
		DRAIN INLET - 24" X 24" GRATE TOP OF CASTING ELEVATION INVERT ELEVATION
		PROPOSED STORM DRAINAGE PIPE
		FLOW ARROW
		PROPOSED GRADED HIGH POINT OR LOW POINT

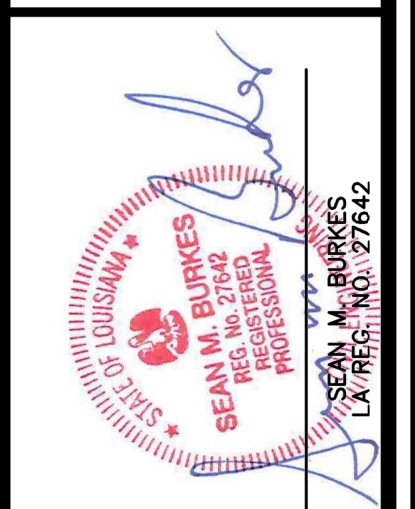

J.V. Burkes & Associates, Inc.
 SURVEYING ENGINEERING ENVIRONMENTAL
 1809 Shortcut Highway
 Slidell, Louisiana 70458
 E-mail: jvbassoc@jvburkes.com
 Phone: 985-649-0075 Fax: 985-649-0154

DRAINAGE PLAN
 A 1.000 ACRE PORTION OF LOTS 29 & 30,
 WITTEBORG FARMS IN SECTION 13, T-9-S, R-14-E,
 GREENSBURG LAND DISTRICT
 ST. TAMMANY PARISH, LOUISIANA
 DECLARATION IS MADE TO ORIGINAL PURCHASER OF THE SURVEY. IT IS NOT TRANSFERABLE TO ADDITIONAL INSTITUTIONS OR SUBSEQUENT OWNERS. SURVEY TO BE MADE ONLY IF PRINT HAS ORIGINAL SEAL OF SURVEYOR.

SCALE: 1" = 20'
 DATE: 9/2/2022
 DRAWN BY: WSR
 CHECKED BY: SMB
 DWG. NO.: 20210632
 SHEET 1 OF 1