



**DAMMON ENGINEERING INC**

Date: 3.31.09 Project: Stennis ROF  
Reviewed: \_\_\_\_\_  
Reviewed as Noted: X  
Revise and Resubmit: \_\_\_\_\_  
Rejected: \_\_\_\_\_  
Other: \_\_\_\_\_

Corrections or comments made on the shop drawings during this review do not relieve the contractor from compliance with requirements of the drawings and specifications. This check is only for review of the general conformance with the design concept of the project and general compliance with the information given in the contract documents. This contractor is responsible for confirming and correlating all quantities and dimensions; selecting fabrication processes and techniques of construction, coordinating his or her work with that of all other trades and performing all in a safe and satisfactory manner.

Submittal Item: Pipe Bollards & Embeds  
Comments

- Robert Walker
- Verify quantities & lengths.
  - See mark-ups.
  - Co-ord. w/O.H. door contractor.
  - Review revised bollard detail.

<b><u>BROADMOOR, L.L.C.</u></b>	
I hereby agree that the (equipment) (material) (article) shown and marked in this submittal is that proposed to be incorporated with contract number <u>N69450-05-D-0096</u> , is in compliance with the contract documents, can be installed in the allocated spaces, and is submitted for Government approval.	
QC Manager	Date
<u>Robert Walker</u>	<u>3.31.09</u>
QC Officer	Date
<u>Robert Walker</u>	<u>3/31/09</u>

FROM :

FAX NO. :

Feb. 26 2009 04:00PM P 2

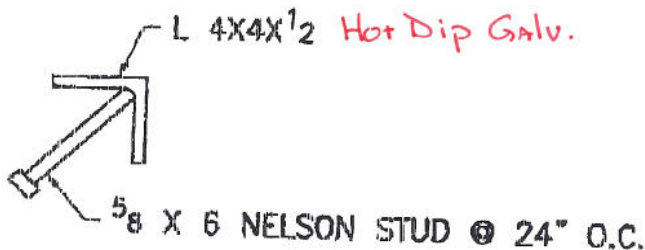

GALVANIZE

6 L'S 26'-0 LONG ✓

### 6 ANGLE EMBEDS

BOAT STORAGE BLDG.

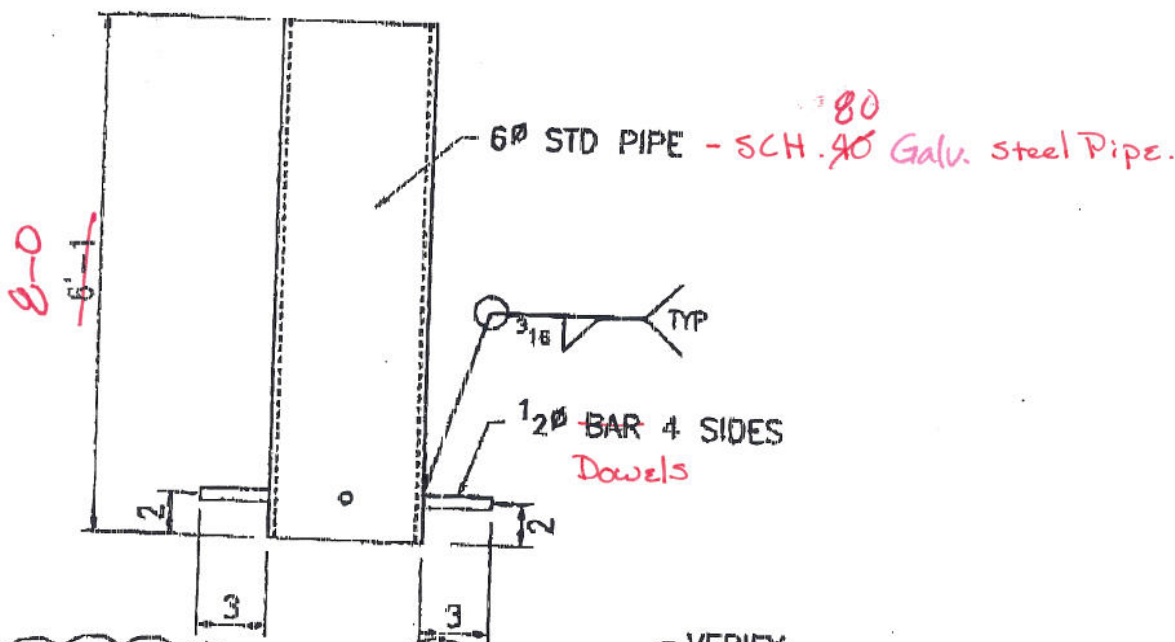

12 - Exterior  
~~24 - Interior~~ 6" STD PIPE PAINTED  
**36** ~~12~~ BOLLARDS  
 BOAT STORAGE BLDG.

NOTE:

Interior bollards  
 are being reviewed  
 weather or not they  
 stay will verify with  
 owner & Relay info to you - Not Req'd.

VERIFY

Project Name: Stennis Riverine  
 Contract: N69450-05-D-0096  
 Ben Proj.: 3013-70  
 Submittal: 055000-01  
 Reviewed  
 Reviewed by: J. Collins  
 DATE: 3/26/09

COMBAT CRAFT OPERATIONS FACILITY  
 NASA JOHN C. STENNIS SPACE CTR. MISS.

BOAT STORAGE BLDG.

2/26/09

SHEET 2

6" DIAMETER - SCHEDULE 80 GALV.  
STEEL PIPE. FILL POST WITH  
CONCRETE AND EMBEDDED IN A 3000 PSI  
PORTLAND CEMENT CONCRETE FOUNDATION

1 1/2" TALL GROUT WASH DOME

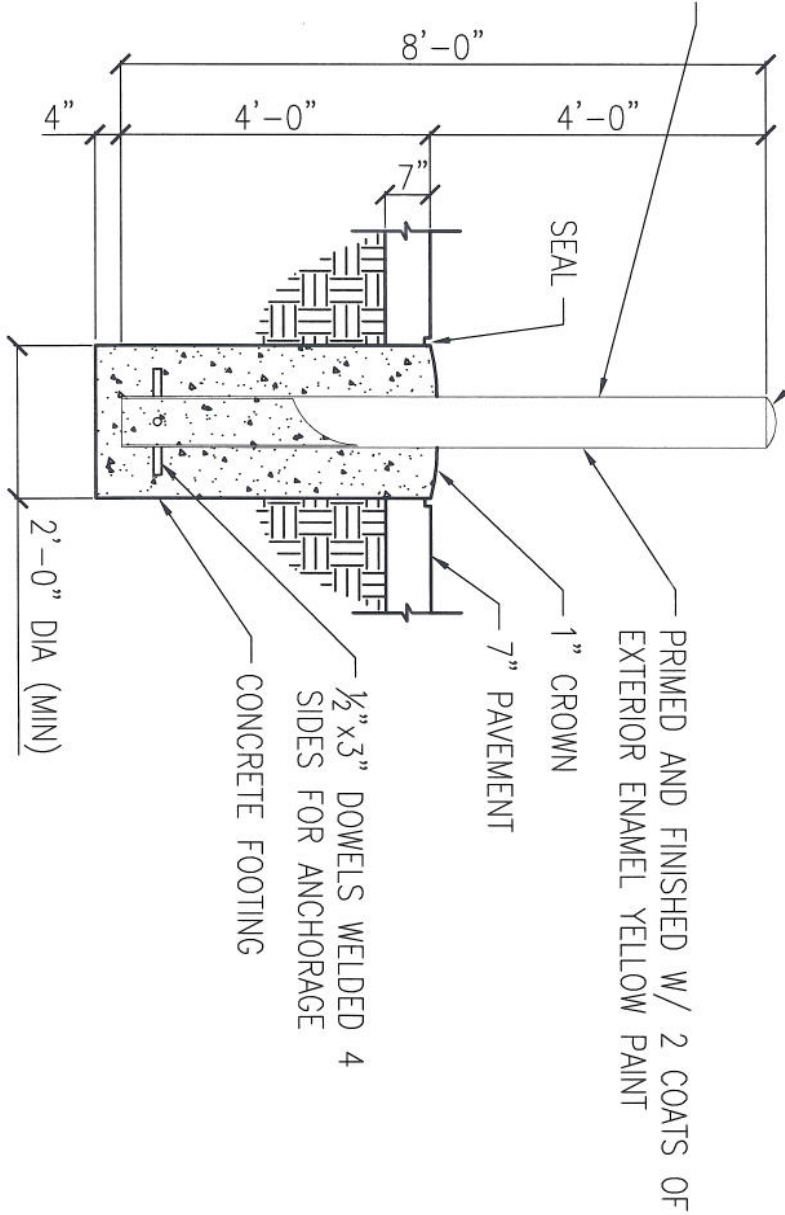

**BOLLARD DETAIL**

N.T.S.

C3.1