



Corporate office:  
122 Leesley Lane  
Argyle, Texas 76226  
[www.bondedlp.com](http://www.bondedlp.com)

**Toll Free: 800-950-7933**

**Fax: 940-455-2225**

## **Stennis Space Center SOF Riverine & Combatant Craft Operations Facility Lightning Protection**

**Bay St. Louis, MS**  
87839-08-

Bonded Lightning Protection is UL Listed for Lightning Protection Installation (UL# E83936). All components are manufactured by UL Listed manufacturers including Advanced Lightning Technology (UL# E153482), East Coast Lightning Equipment (UL# E93753) and Thompson Lightning Protection (UL# E14909).



**Class I Conductors** (LP-COND-C1-01)

Item #	Description	Unit	Weight
<b>129</b>	<b>29 Strand 17 Ga Braided Copper Lightning Conductor - UL Labeled (Spooled to Special Lengths)</b>	<b>FT</b>	<b>0.19</b>
129-500	29 Strand 17 Ga Braided Copper Lightning Conductor - UL Labeled on 500' Spools (SOLD in 500' ROLL SPOOL CAN NOT BE BROKEN)	FT	0.20
132	32 Strand 17 Ga Copper Lightning Conductor - UL Labeled (Spooled to Special Lengths)	FT	0.22
132-500	32 Strand 17 Ga Copper Lightning Conductor - UL Labeled on 500' Spools (Spool Size Can Not Be Broken)	FT	0.22
174	24 Strand 14 Ga Copper Braided Lightning Conductor - UL Labeled on 500' Spools	FT	3.20
129T	29 Strand 17 Ga Tinned Copper Braided Lightning Conductor - UL Labeled on 500' Spools	FT	0.19
132T	32 Strand 17 Ga Tinned Copper Lightning Conductor - UL Labeled on 500' Spools	FT	2.17
<b>A124</b>	<b>24 Strand 14 Ga Aluminum Braided Lightning Conductor UL Labeled (Spooled to Special Lengths)</b>	<b>FT</b>	<b>0.10</b>
A124-500	24 Strand 14 Ga Braided Aluminum Lightning Conductor - UL Labeled on 500' Spools (SOLD in 500' ROLL SPOOL CAN NOT BE BROKEN)	FT	0.00
A128	28 Strand 14 Ga Aluminum Rope Lay Lightning Conductor - UL Labeled on 500' Spools	FT	1.15
168	28 Strand 16 Ga Copper Rope Lay Lightning Conductor - UL Labeled on 500' Spools	FT	2.30



**Air Terminals - Aluminum Blunt Tip** (LP-AT-02-02)

Item #	Description	Unit	Weight
<b>A410B</b>	<b>1/2" x 10" Blunt Tip Solid Aluminum Air Terminal - UL Label</b>	<b>EA</b>	<b>0.20</b>
<b>A412B</b>	<b>1/2" x 12" Blunt Tip Solid Aluminum Air Terminal - UL Label</b>	<b>EA</b>	<b>0.22</b>
A415B	1/2" x 15" Blunt Tip Solid Aluminum Air Terminal - UL Label	EA	0.31
A418B	1/2" x 18" Blunt Tip Solid Aluminum Air Terminal - UL Label	EA	0.34
A424B	1/2" x 24" Blunt Tip Solid Aluminum Air Terminal - UL Label	EA	0.46
A436B	1/2" x 36" Blunt Tip Solid Aluminum Air Terminal - UL Label	EA	0.69
A448B	1/2" x 48" Blunt Tip Solid Aluminum Air Terminal - UL Label	EA	0.92
A460B	1/2" x 60" Blunt Tip Solid Aluminum Air Terminal - UL Label	EA	1.15
A472B	1/2" x 72" Blunt Tip Solid Aluminum Air Terminal - UL Label	EA	1.38
A510B	5/8" x 10" Blunt Tip Solid Aluminum Air Terminal - UL Label	EA	0.31
A512B	5/8" x 12" Blunt Tip Solid Aluminum Air Terminal - UL Label	EA	0.46
A518B	5/8" x 18" Blunt Tip Solid Aluminum Air Terminal - UL Label	EA	0.55
A524B	5/8" x 24" Blunt Tip Solid Aluminum Air Terminal - UL Label	EA	0.74
A536B	5/8" x 36" Blunt Tip Solid Aluminum Air Terminal - UL Label	EA	1.10
A548B	5/8" x 48" Blunt Tip Solid Aluminum Air Terminal - UL Label	EA	1.47
A560B	5/8" x 60" Blunt Tip Solid Aluminum Air Terminal - UL Label	EA	1.94
A584B	5/8" x 84" Blunt Tip Solid Aluminum Air Terminal - UL Label	EA	6.57



**Base - Adhesive Mount** (LP-C2BASE-10)

A cast base designed for mounting air terminals with adhesive on flat roofs and other surfaces that cannot be penetrated with fasteners. The base includes bolt type conductor connector.

Item #	Description	Unit	Weight
839-38	Bronze Fm Adhesive Base 3/8" Fits Conductor Sizes .292 to .528	EA	1.00
839-12	Bronze Fm Adhesive Base 1/2" Fits Conductor Sizes .292 to .528	EA	1.00
839-12T	Tinned Bronze Fm Adhesive Base 1/2" Fits Conductor Sizes .292 to .528	EA	0.97
839-58	Bronze Fm Adhesive Base 5/8" Fits Conductor Sizes .292 to .528	EA	1.00
<b>A839-12</b>	<b>Aluminum Fm Adhesive Base 1/2" Fits Conductor Sizes .292 to .562</b>	<b>EA</b>	<b>0.38</b>
A839-58	Aluminum Fm Adhesive Base 5/8" Fits Conductor Sizes .292 to .562	EA	0.38

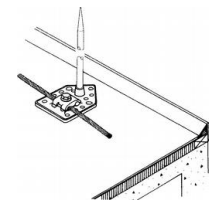
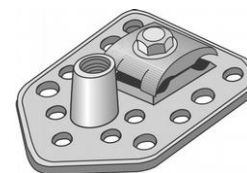

Typical application

### Thru Roof Point Base with Horizontal Connector (LP-TWTR-05)

The conductor connector is designed to mount on the roof framing for additional support. The assembly includes an under roof nut and sealing washer.

Item #	Description	Unit	Weight
2380-38	Bronze 12" Thru Roof Point Base for 3/8" Air Terminal with 1/2" Brass Threaded Rod - Fits Conductor Sizes .375 to .500	EA	1.34
2380-12	Bronze 12" Thru Roof Point Base for 1/2" Air Terminal with 1/2" Brass Threaded Rod - Fits Conductor Sizes .375 to .500	EA	1.34
<b>2380BM-12</b>	<b>Bimetal 12" Thru Roof Point Base for 1/2" Aluminum Air Terminal with 1/2" Stainless Threaded Rod to Copper Conductors - Fits Conductor Sizes .375 to .500</b>	<b>EA</b>	<b>0.00</b>
2380BM-58	Bimetal 12" Thru Roof Point Base for 5/8" Aluminum Air Terminal with 1/2" Stainless Threaded Rod to Copper Conductors - Fits Conductor Sizes .375 to .500	EA	0.00
A2380-12	Aluminum 12" Thru Roof Point Base for 1/2" Air Terminal with 1/2" Stainless Steel Threaded Rod - Fits Conductor Sizes .375 to .500	EA	0.92
A2380-58	Aluminum 12" Thru Roof Point Base for 5/8" Air Terminal with 1/2" Stainless Steel Threaded Rod - Fits Conductor Sizes .375 to .500	EA	0.92

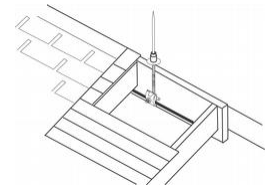

Typical application

### Loop - 1/4" Holes (LP-LOOP-03)

Item #	Description	Unit	Weight
<b>2425</b>	<b>Copper Conductor Loop - Loop Width 5/8" - Hole Size 1/4" - Maximum Conductor Size .437"</b>	<b>EA</b>	<b>0.01</b>
2425T	Tinned Copper Conductor Loop - Loop Width 5/8" - Hole Size 1/4" - Maximum Conductor Size .437"	EA	0.01
2430	Copper Conductor Loop 1/4" Hole	EA	0.02
2430T	Tinned Copper Conductor Loop 1/4" Hole	EA	0.04

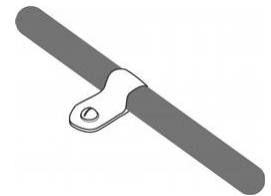
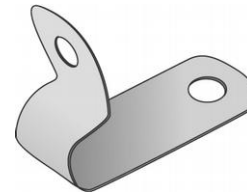

Typical application

### Conductor Support - Adhesive (LP-SPT-04)

A stamped conductor support for mounting with adhesive on flat roofs and other surfaces that cannot be penetrated with fasteners.

Item #	Description	Unit	Weight
2510	Copper Adhesive Conductor Support - Overall Size 2-1/4" x 3-1/2" - Maximum Conductor Size .528	EA	0.09
<b>A2510</b>	<b>Aluminum Adhesive Conductor Support - Overall Size 2-1/4" x 3-1/2" - Maximum Conductor Size .562</b>	<b>EA</b>	<b>0.04</b>

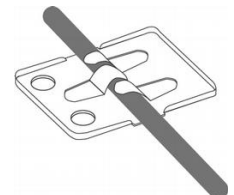
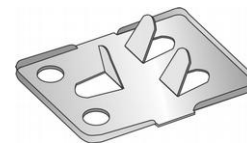

Typical application

### Swivel Air Terminal Adapter Male (LP-AT-ACC-10)

A swivel adapter designed to allow plumb air terminal mounting on sloped surfaces. Available in aluminum or brass for 3/8", 1/2" and 5/8" air terminals mounting to 3/8", 1/2" or 5/8" bases.

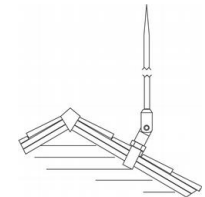
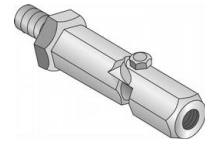

Typical application

Item #	Description	Unit	Weight
1950-12-38	Premier Brass Male Swivel Point Adapter 1/2" Base - 3/8" Air Terminal	EA	0.40
1950-12-12	Premier Brass Male Swivel Point Adapter 1/2" Base - 1/2" Air Terminal	EA	0.40
1950-12-58	Premier Brass Male Swivel Point Adapter 1/2" Base - 5/8" Air Terminal	EA	0.40
1950-38-38	Premier Brass Male Swivel Point Adapter 3/8" Base - 3/8" Air Terminal	EA	0.40
1950-38-12	Premier Brass Male Swivel Point Adapter 3/8" Base - 1/2" Air Terminal	EA	0.40
1950-38-58	Premier Brass Male Swivel Point Adapter 3/8" Base - 5/8" Air Terminal	EA	0.40
1950-58-38	Premier Brass Male Swivel Point Adapter 5/8" Base - 3/8" Air Terminal	EA	0.40
1950-58-12	Premier Brass Male Swivel Point Adapter 5/8" Base - 1/2" Air Terminal	EA	0.40
1950-58-58	Premier Brass Male Swivel Point Adapter 5/8" Base - 5/8" Air Terminal	EA	0.40
<b>A1950-12-12</b>	<b>Premier Aluminum Male Swivel Point Adapter 1/2" Base - 1/2" Air Terminal</b>	<b>EA</b>	<b>0.24</b>
A1950-12-58	Premier Aluminum Male Swivel Point Adapter 1/2" Base - 5/8" Air Terminal	EA	0.24
A1950-58-12	Premier Alum Male Swivel Point Adapter 5/8" Base - 1/2" Air Terminal	EA	0.24
A1950-58-58	Premier Aluminum Male Swivel Point Adapter 5/8" Base - 5/8" Air Terminal	EA	0.24

### Thru Roof Assembly (LP-TWTR-04)

An assembly designed to make a sealed roof penetration while maintaining low resistance grounding. Stainless steel hardware and sealing washers are included.

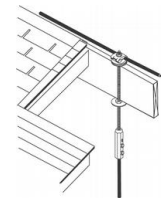

Typical application

Item #	Description	Unit	Weight
2350	Bronze Copper to Copper 18" Thru Roof Assembly with no PVC and 1/2" Brass Threaded Rod - Fits Conductor Sizes .257 to .500	EA	1.50
A2350	Aluminum to Aluminum 18" Thru Roof Assembly with no PVC and 1/2" Stainless Steel Threaded Rod - Fits Conductor Sizes .257 to .562	EA	1.20
<b>2351</b>	<b>Bronze / Aluminum 18" Thru Roof Assembly with no PVC and 1/2" Stainless Steel Threaded Rod - Fits Conductor Sizes .257 to .500</b>	<b>EA</b>	<b>1.30</b>

### Thru Wall Assembly (LP-TWTR-01)

An assembly designed for a thru wall penetration that can be easily sealed while maintaining low resistance grounding. Stainless steel hardware and sealing washers are included.

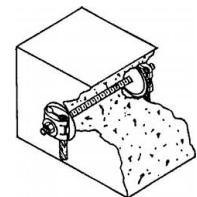

Typical application

Item #	Description	Unit	Weight
2300	Bronze Copper to Copper 18" Thru Wall Assembly with 1/2" Brass Threaded Rod - Fits Conductor Sizes .292 to .528	EA	1.92
A2300	Aluminum to Aluminum 18" Thru Wall Assembly with 1/2" Stainless Steel Threaded Rod - Fits Conductor Sizes .292 to .562	EA	1.42
<b>2301</b>	<b>Bronze / Aluminum Bimetal 18" Thru Wall Assembly with 1/2" Stainless Steel Threaded Rod - Fits Conductor Sizes .292 to .562</b>	<b>EA</b>	<b>1.72</b>

### Ground Rod Clamp - Brass Standard Duty (GC-GRCLMP-09)

A standard duty ground rod clamp. Provides enough contact between rod and conductor to be used for lightning protection. Two stainless steel bolts included.



Item #	Description	Unit	Weight
<b>3014U</b>	<b>Brass Standard Duty Ground Rod Clamp - Fits Rod Sizes: 1/2", 5/8" and 3/4" to Maximum Conductor Size .528</b>	<b>EA</b>	<b>0.32</b>

### Ground Rods - Copper Clad Sectional (GC-GROD-01a)

1-1/2" thread at both ends of rod.

Item #	Description	Unit	Weight
<b>2921</b>	<b>5/8" x 10' Copper Clad Sectional Ground Rod</b>	<b>EA</b>	<b>8.70</b>
2953	3/4" x 8' Copper Clad Sectional Ground Rod	EA	9.98
2961	3/4" x 10' Copper Clad Sectional Ground Rod	EA	12.80
2981	1" x 10' Copper Clad Sectional Ground Rod	EA	23.00



### Ground Rod Couplers (GC-GROD-06)

Ground rod couplers are used to connect threaded or sectional ground rods.

Item #	Description	Unit	Weight
3040-12	Brass Coupler 1/2" Ground Rod for Full Size Rods	EA	0.20
<b>3040-58</b>	<b>Brass Coupler 5/8" Ground Rod</b>	<b>EA</b>	<b>0.30</b>
3040-34	Brass Coupler 3/4" Ground Rod	EA	0.40
3040-1	Brass Coupler 1" Ground Rod	EA	1.00
3050-12	304 Stainless Steel Coupler 1/2" Ground Rod	EA	0.20
3050-58	304 Stainless Steel Coupler 5/8" Ground Rod	EA	0.30
3050-34	304 Stainless Steel Coupler 3/4" Ground Rod	EA	0.40
3050-1	Stainless Steel Coupler 1" Ground Rod	EA	0.80



### Connector - One Bolt Parallel with Countersunk Bolt (LP-C2CON-02)

(LP-C2CON-02)

A cast parallel connector for attaching conductor to conductor, or conductor to rod. The clamp provides for 1-1/2" of contact. The bolt head is recessed into the connector to provide a smooth bottom surface.

Item #	Description	Unit	Weight
902	Bronze One Bolt Parallel Clamp with Countersunk Bolt - Fits Conductor Sizes .162 to .528	EA	0.41
902T	Tinned Bronze One Bolt Parallel Clamp with Countersunk Bolt - Fits Conductor Sizes .162 to .528	EA	0.47
<b>A902</b>	<b>Aluminum One Bolt Parallel Clamp with Countersunk Bolt - Fits Conductor Sizes .167 to .562</b>	<b>EA</b>	<b>0.15</b>

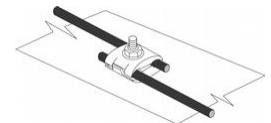
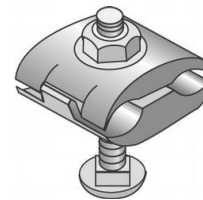

Typical application

### Splicer - Hex Standard Straight (LP-C2CON-06)

A straight splicer suitable for Class I and Class II lightning and grounding conductor.

Item #	Description	Unit	Weight
917	Brass Standard Straight Connector - Accepts 129/#2 Solid Thru 268/#4/0 Cable	EA	0.35
917-1	H D Brass Standard Straight Connector - Accepts 129/#2 Solid Thru 288/#250MCM Cable	EA	0.53
<b>A917</b>	<b>Aluminum Std Straight Connector - Accepts A124 Thru A237 Cable</b>	<b>EA</b>	<b>0.18</b>



Typical application

## Connector - Stainless Steel Parallel Secondary Bimetal

(LP-C2CON-14)

A stainless steel bimetal connector for joining copper and aluminum secondary bonding cables, which provides 2" of contact on each conductor.

Item #	Description	Unit	Weight
929-1	Secondary Stainless Steel Bimetal Parallel Connector - Fits Conductor Sizes .292 to .562	EA	0.18
929-5	Bimetal Parallel Splicer - Aluminum Top with Bronze Bottom	EA	0.30
929-5LH-12	Bimetal Parallel Splicer Less Hardware - Aluminum Top, Stainless Shim and Bronze Bottom All Drilled Out 17/32"	EA	0.27

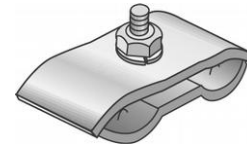

Illustrates the 929-1

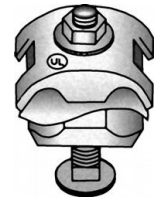

Illustrates the 929-5

## Connector - Secondary (LP-C2CON-23)

A cast connector suitable for connecting two conductors, two rods or a conductor to a rod.

Item #	Description	Unit	Weight
940	Bronze Secondary Connector - Fits Conductor Sizes .162 to .528 ( Cut 905 In Half To Get 940, Cut On Line)	EA	0.22
940T	Tinned Bronze Secondary Connector - Fits Conductor Sizes .162 to .528	EA	0.22
A940	Aluminum Secondary Connector - Fits Conductor Sizes .162 to .562	EA	0.11

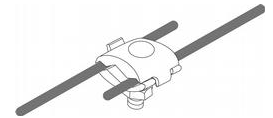
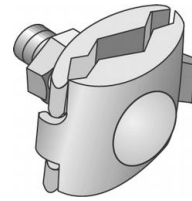

Typical application

## Bonding Plate (LP-C2BP-03)

A cast bonding connector with three square inches of surface contact.

Item #	Description	Unit	Weight
1005	Three Square Inch Bronze Bonding Plate - Fits Conductor Sizes .292 to .528	EA	0.44
A1005	Three Square Inch Aluminum Bonding Plate - Fits Conductor Sizes .292 to .562	EA	0.16
1005BM	Three Square Inch Bi-Metal Bonding Plate for Bonding Aluminum Surface to Copper Conductor - Fits Conductor Sizes .292 to .528	EA	0.31

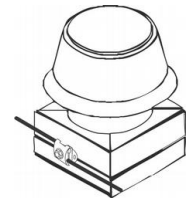

Typical application

## Bolt Hole Bonding Plate (LP-C2BP-11)

A cast bonding connector with a hole for bolts up to 1" diameter. The bonding conductor has eight square inches of contact surface.

Item #	Description	Unit	Weight
1040	Bronze Bolt Hole Bonding Plate - Fits Conductor Sizes .375 to .500	EA	0.63
A1040	Aluminum Bolt Hole Bonding Plate - Fits Conductor Sizes .375 to .500	EA	0.22

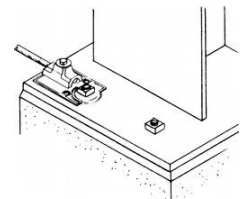
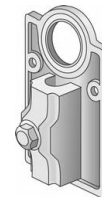

Typical application

**Strap - Ground** (LP-C2BS-01)

A ground strap used to bond pipes and round objects. The strap is 1" wide by 1/16" thick and is available in multiple lengths. The conductor is secured with a heavy duty cast bolt type conductor connector.

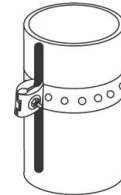

Vertical application

Item #	Description	Unit	Weight
1201	Copper Bonding Strap Fits 2" Thru 6-1/2" OD - Overall Length 22-1/4" - Connector Fits Grounding Conductor Sizes #2 Stranded - 4/0 Stranded	EA	0.36
1202	Copper Bonding Strap Fits 3/4" Thru 2-1/2" OD - Overall Length 10-13/16" - Connector Fits Grounding Conductor Sizes #2 Stranded - 4/0 Stranded	EA	0.29
1209	Copper Bonding Strap Fits 6" Thru 10-1/2" OD - Overall Length 35-7/16" - Connector Fits Grounding Conductor Sizes #2 Stranded - 4/0 Stranded	EA	0.42
1201T	Tinned Copper Bonding Strap Fits 2" Thru 6-1/2" OD - Overall Length 22-1/4" - Connector Fits Grounding Conductor Sizes #2 Stranded - 4/0 Stranded	EA	0.36
1202T	Tinned Copper Bonding Strap Fits 3/4" Thru 2-1/2" OD - Overall Length 10-13/16" - Connector Fits Grounding Conductor Sizes #2 Stranded - 4/0 Stranded	EA	0.29
1209T	Tinned Copper Bonding Strap Fits 6" Thru 10-1/2" OD - Overall Length 35-7/16" - Connector Fits Grounding Conductor Sizes #2 Stranded - 4/0 Stranded	EA	0.42
<b>A1201</b>	<b>Aluminum Bonding Strap Fits 2" Thru 6-1/2" OD - Overall Length 22-1/4" - Connector Fits Lightning Conductor Sizes A124 thru A237</b>	<b>EA</b>	<b>0.27</b>
A1202	Aluminum Bonding Strap Fits 3/4" Thru 2-1/2" OD - Overall Length 10-13/16" - Connector Fits Lightning Conductor Sizes A124 thru A237	EA	0.20
A1209	Aluminum Bonding Strap Fits 6" Thru 10-1/2" OD - Overall Length 35-7/16" - Connector Fits Lightning Conductor Sizes A124 thru A237	EA	0.33

**Strap - Heavy Duty Pipe** (LP-C2BS-02)

The 2" wide, heavy duty strap qualifies as a water pipe bond as outlined in UL96 and UL96A.

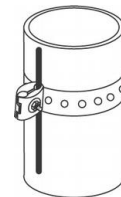

Vertical application

Item #	Description	Unit	Weight
1240	Copper Heavy Duty Pipe Strap Fits 2" Thru 4-1/2" OD - Overall Length 20-11/16" - Connector Fits Grounding Conductor Sizes #2 Stranded - 4/0 Stranded	EA	1.40
1246	Copper Heavy Duty Pipe Strap Fits 4" Thru 6-1/2" OD - Overall Length 27-1/4" - Connector Fits Grounding Conductor Sizes #2 Stranded - 4/0 Stranded	EA	1.65
1248	Copper Heavy Duty Pipe Strap Fits 6" Thru 8-1/2" OD - Overall Length 33-7/8" - Connector Fits Grounding Conductor Sizes #2 Stranded - 4/0 Stranded	EA	1.92
1250	Copper Heavy Duty Pipe Strap Fits 8" Thru 10-1/2" OD - Overall Length 40-7/16" - Connector Fits Grounding Conductor Sizes #2 Stranded - 4/0 Stranded	EA	2.18
1260	Copper Heavy Duty Pipe Strap Fits 10" Thru 12-1/2" OD - Overall Length 47" - Connector Fits Grounding Conductor Sizes #2 Stranded - 4/0 Stranded	EA	2.45
A1240	Aluminum Heavy Duty Pipe Strap Fits 2" Thru 4-1/2" OD - Overall Length 20-11/16" - Connector Fits Lightning Conductor Sizes A124 thru A237	EA	0.61
<b>A1246</b>	<b>Aluminum Heavy Duty Pipe Strap Fits 4" Thru 6-1/2" OD - Overall Length 27-1/4" - Connector Fits Lightning Conductor Sizes A124 thru A237</b>	<b>EA</b>	<b>0.72</b>
A1248	Aluminum Heavy Duty Pipe Strap Fits 6" Thru 8-1/2" OD - Overall Length 33-7/8" - Connector Fits Lightning Conductor Sizes A124 thru A237	EA	0.85
A1250	Aluminum Heavy Duty Pipe Strap Fits 8" Thru 10-1/2" OD - Overall Length 40-7/16" - Connector Fits Lightning Conductor Sizes A124 thru A237	EA	0.97
A1260	Aluminum Heavy Duty Pipe Strap Fits 10" Thru 12-1/2" OD - Overall Length 47" - Connector Fits Lightning Conductor Sizes A124 thru A237	EA	1.08

**U-Bolt Ground Clamp** (GC-UBOLT-02)

A U-bolt cast ground clamp with stainless steel U-bolt and hardware. The conductor connector can accept one or two conductors.

Item #	Description	Unit	Weight
1372	Bronze U-Bolt Twin Connector Fits 1-1/4" to 2" Maximum Diameter with 2 Wires .292 to .528 Maximum Diameter	EA	0.80
1372T	Tinned Bronze U-Bolt Twin Connector Fits 1 1/4" to 2" Maximum Diameter with 2 Wires .292 to .528 Maximum Diameter	EA	0.50
1373	Bronze U-Bolt Twin Connector Fits 2" to 3" Maximum Diameter with 2 Wires .292 to .528 Maximum Diameter	EA	0.80
1373T	Tinned Bronze U-Bolt Twin Connector Fits 2" to 3" Maximum Diameter with 2 Wires .292 to .528 Maximum Diameter	EA	1.04
1374	Bronze U-Bolt Twin Connector Fits 3" to 4-1/2" Maximum Diameter with 2 Wires .292 to .528 Maximum Diameter	EA	1.70
1374T	Tinned Bronze U-Bolt Twin Connector Fits 3" to 4-1/2" Maximum Diameter with 2 Wires .292 to .528 Maximum Diameter	EA	1.54
1376	Bronze U-Bolt Twin Connector Fits 4" to 6-3/4" Maximum Diameter with 2 Wires .292 to .528 Maximum Diameter	EA	2.30
1376T	Tinned Bronze U-Bolt Twin Connector Fits 4" to 6-3/4" Maximum Diameter with 2 Wires .292 to .528 Maximum Diameter	EA	2.30
<b>A1372</b>	<b>Aluminum U-Bolt Twin Connector Fits 1-1/4" to 2" Maximum Diameter Round Objects with 1 or 2 Wires .292 to .562 Maximum Diameter</b>	<b>EA</b>	<b>0.30</b>
A1373	Aluminum U-Bolt Twin Connector Fits 2" to 3" Maximum Diameter Round Objects with 1 or 2 Wires .292 to .562 Maximum Diameter	EA	0.40
A1374	Aluminum U-Bolt Twin Connector Fits 3" to 4-1/2" Maximum Diameter Round Objects with 1 or 2 Wires .292 to .562 Maximum Diameter	EA	0.70

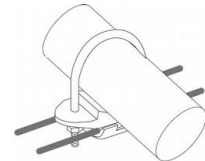
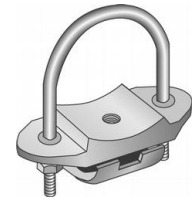

Typical application