

**NOTE:**  
 CONTRACTOR TO  
 COORDINATE EXACT  
 PLACEMENT OF  
 POWER/CABLE LOCATIONS  
 BASED ON TV MODEL &  
 BRACKET; TYPICAL FOR  
 ALL LOCATIONS.  
 COORDINATE WITH  
 INTERIOR DESIGNER.

**NOTE:** CONTRACTOR TO PROVIDE HARDWARE  
 CONNECTION TO POWERED FURNITURE PANELS;  
 CONNECTION TO POWERED FURNITURE PANELS;  
 FSTV-1, DATA CABLING TO RUN IN PANEL RACEWAY

**FIRST FLOOR FURNITURE PLAN**

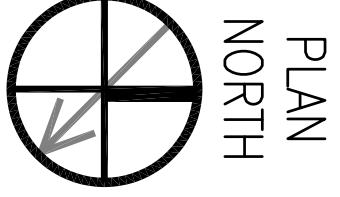
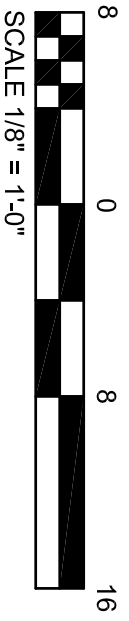

**INTERIOR ELEVATION**

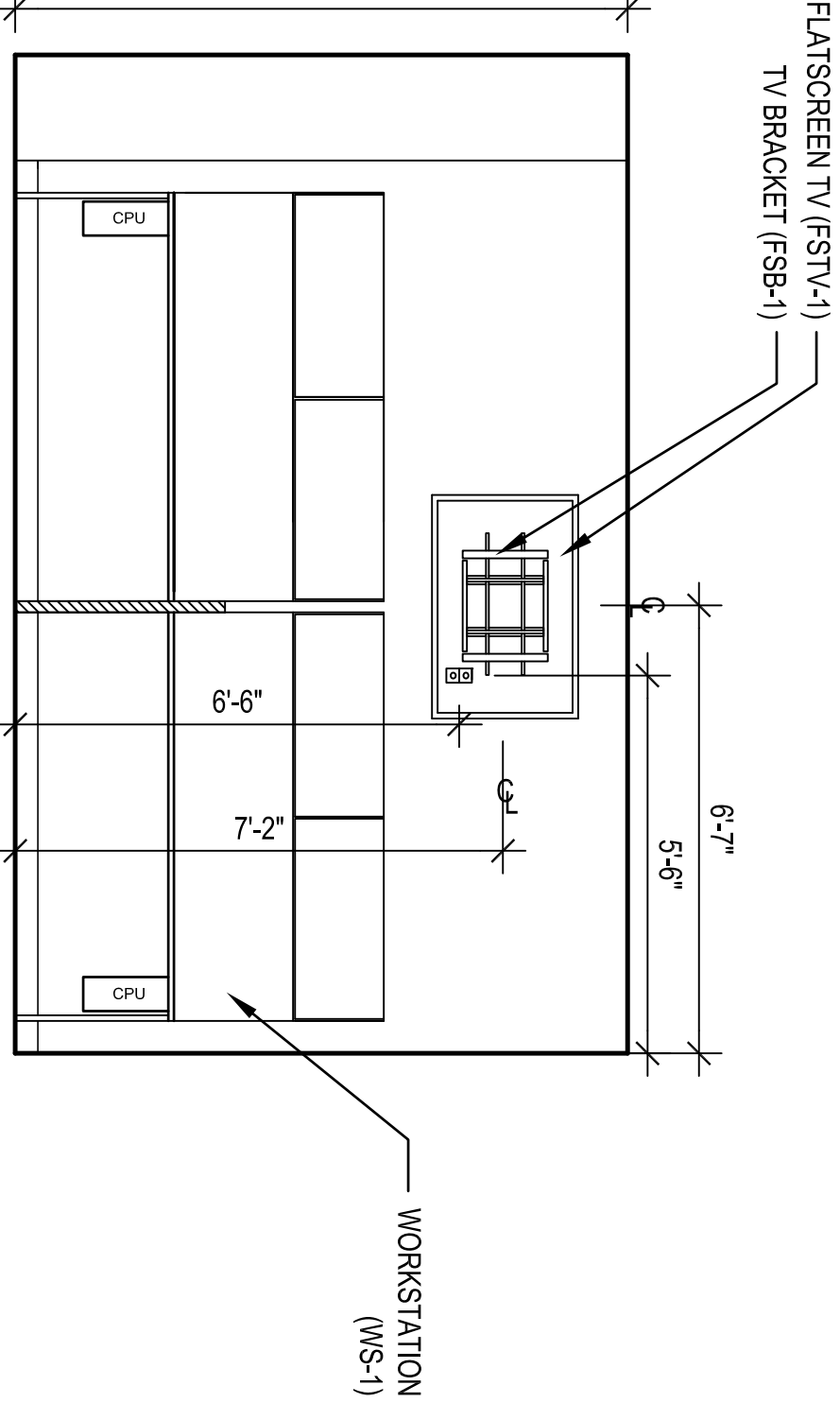
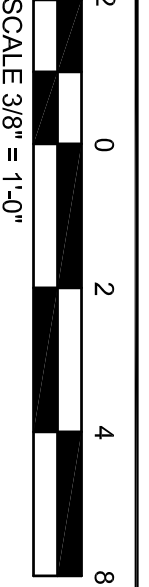

CID FINAL  
 SUBMITTAL ISSUE



DEPARTMENT OF THE NAVY NAVAL FACILITIES ENGINEERING COMMAND NAVAL FACILITIES ENGINEERING COMMAND SOUTHEAST 1PT SOUTH ATLANTIC JOHN C. STENNIS SPACE CENTER MISSISSIPPI	NAVAL FACILITIES ENGINEERING COMMAND NAVAL FACILITIES ENGINEERING COMMAND SOUTHEAST NAVAL AIR STATION JACKSONVILLE MISSISSIPPI
<b>SOF RIVERINE AND COMBATANT                  CRAFT OPERATIONS FACILITY</b>	
<b>1ST FLR FURNITURE PLAN</b>	
SCALE: _____ SHEET NO. 62 OF 132 DATE: AUG. 11, 2009 PROJECT NO. CID-1	DRAWING NUMBER: 15026709 CONTRACTOR: NS2467-05-D-0096 DATE: AUG. 11, 2009

  
**BROADMOOR DESIGN**  
 BROADMOOR, L.L.C.  
 2740 NORTH ARNOULT ROAD, METAIRIE, LA 70002 (504) 885-5401  
 www.broadmoorllc.com

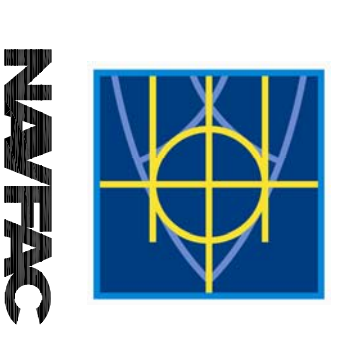

SYM	DESCRIPTION	DATE	APPR

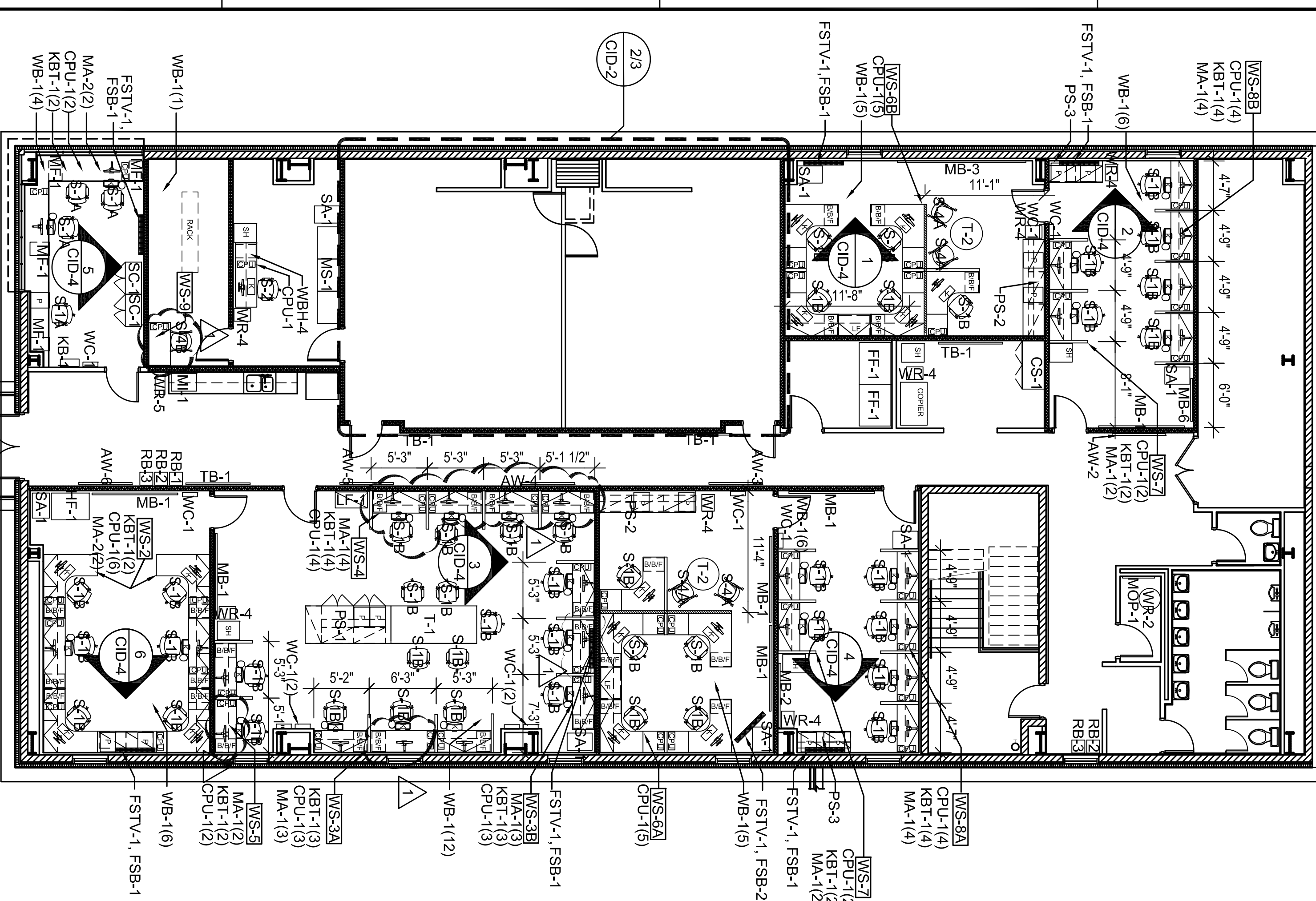

**SECOND FLOOR FURNITURE PLAN**

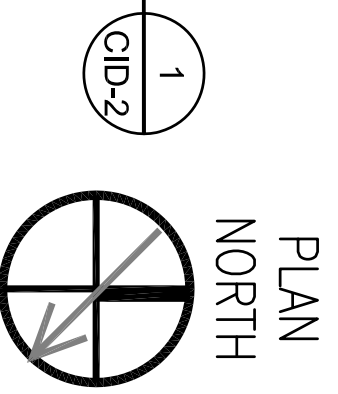
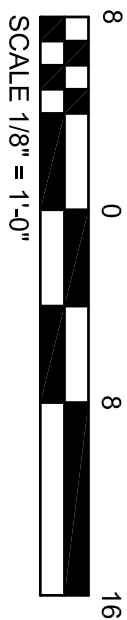

NOTE: CONTRACTOR TO AVOID LOCATING POWER / DATA OUTLETS BEHIND BIF/ (BOX / BOX / FILE PEDESTAL) LOCATIONS.

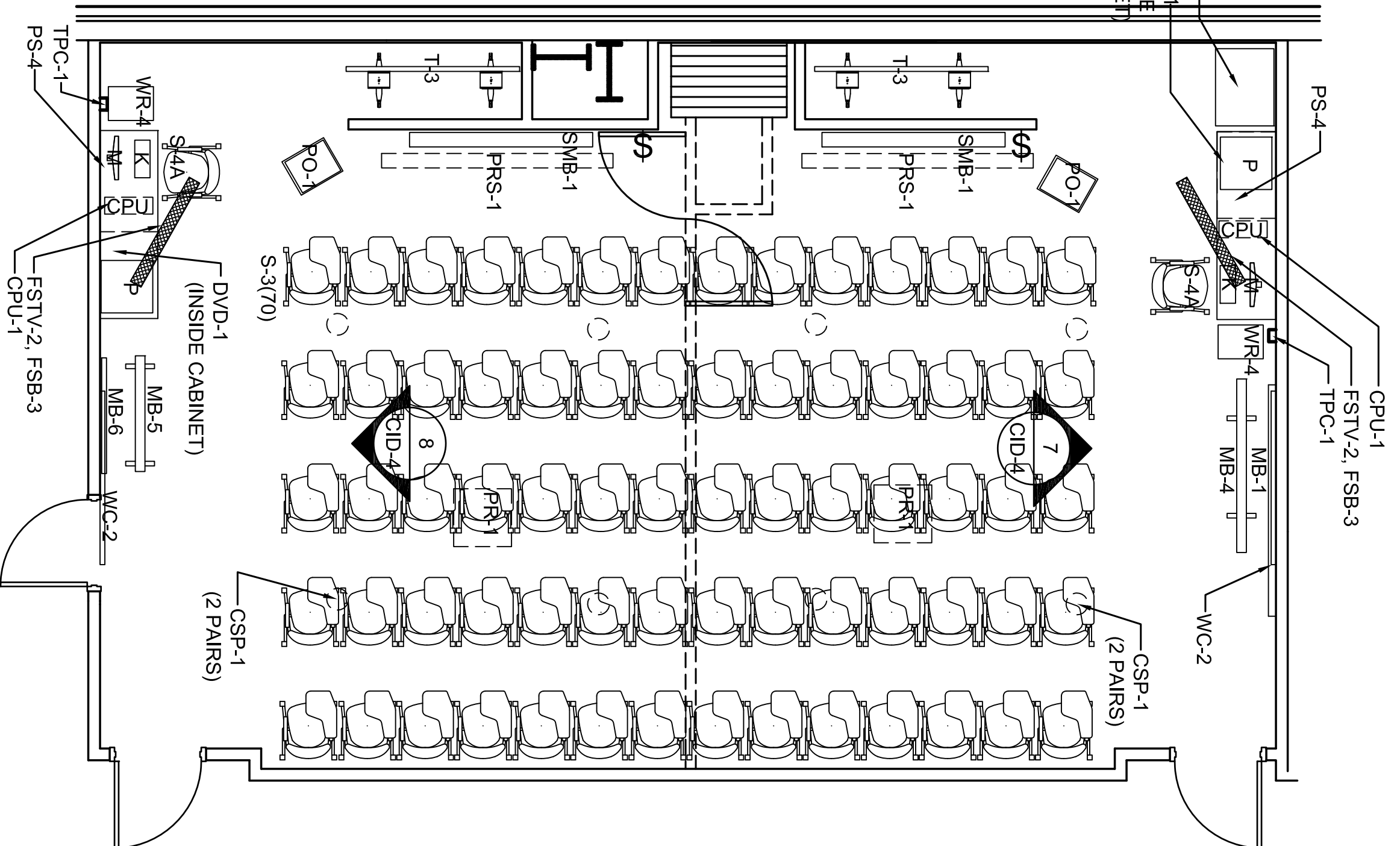

**DETAIL PLAN**

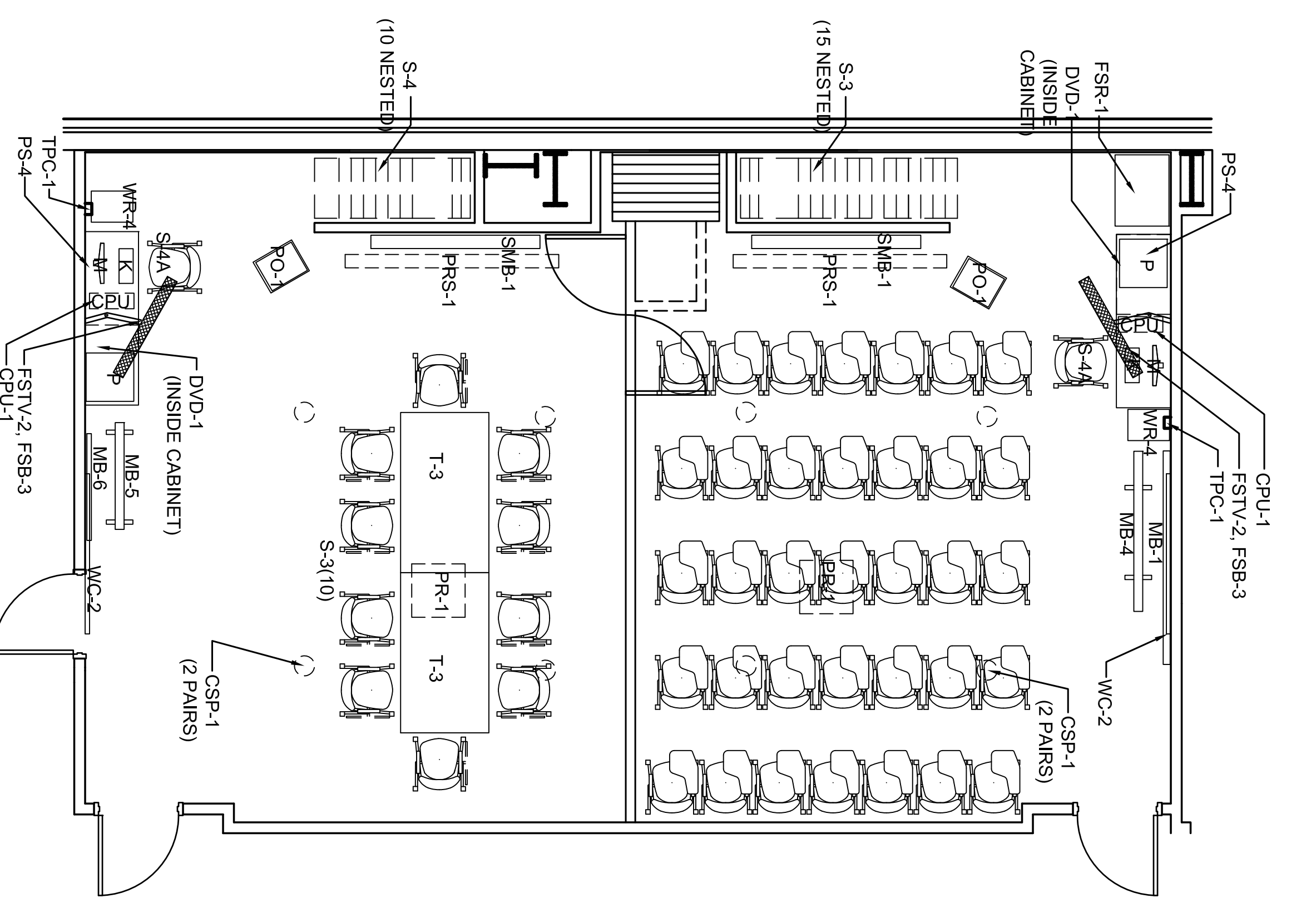
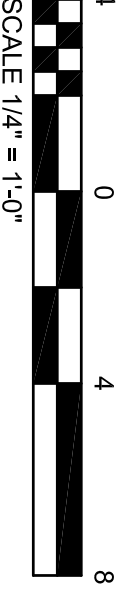

**DETAIL PLAN**

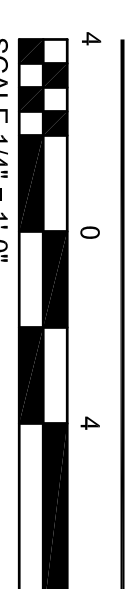

CID FINAL  
SUBMITTAL ISSUE

**AUG. 11, 2009**  
**CID - 2**

DEPARTMENT OF THE NAVY NAVAL FACILITIES ENGINEERING COMMAND IPT SOUTH ATLANTIC JOHN C. STENNIS SPACE CENTER MISSISSIPPI	NAVAL FACILITIES ENGINEERING COMMAND NAVAL FACILITIES ENGINEERING COMMAND SOUTHEAST NAVAL AIR STATION JACKSONVILLE MISSISSIPPI
<b>SOF RIVERINE AND COMBATANT CRAFT OPERATIONS FACILITY</b>	
<b>2ND FLR FURNITURE PLAN / DTL PLANS</b>	
SCALE: 1/8" = 1'-0"	SCALE: 1/4" = 1'-0"
WORKING DRAWING NO. 15026710	CONTRACT NUMBER: N62467-05-D-0086
WORK ORDER NO. 510227	DATE: 08/13/09
DESIGNED BY: P-210	CHECKED BY: P-210
DRAWN BY: P-210	DATE: 08/13/09
CORE ID: MA-1412	SHEET: 03 OF 132

**BROADMOOR DESIGN**  
BROADMOOR, L.L.C.  
2740 NORTH ARNOULT ROAD METAIRIE, LA 70002 (504) 885-5401  
www.broadmoorllc.com

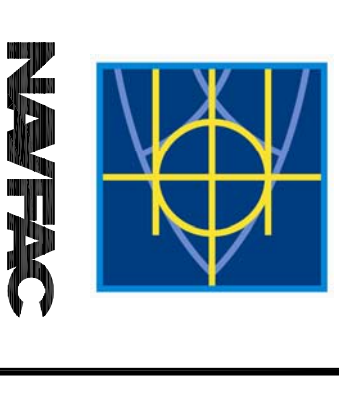

SYM	DESCRIPTION	DATE	APPR
	RELOCATION OF PEDESTALS IN 208 & WS-9	9-16-09	DBT



