

REVDATE: FILE NAME: C:\Schlafly\ENGR 08010 SDF Rivertine Drawings Elec 5-As-buils E2.1.dwg LAYOUT NAME: E2.3 PLOTTED: Friday, May 28, 2010 - 2:51pm

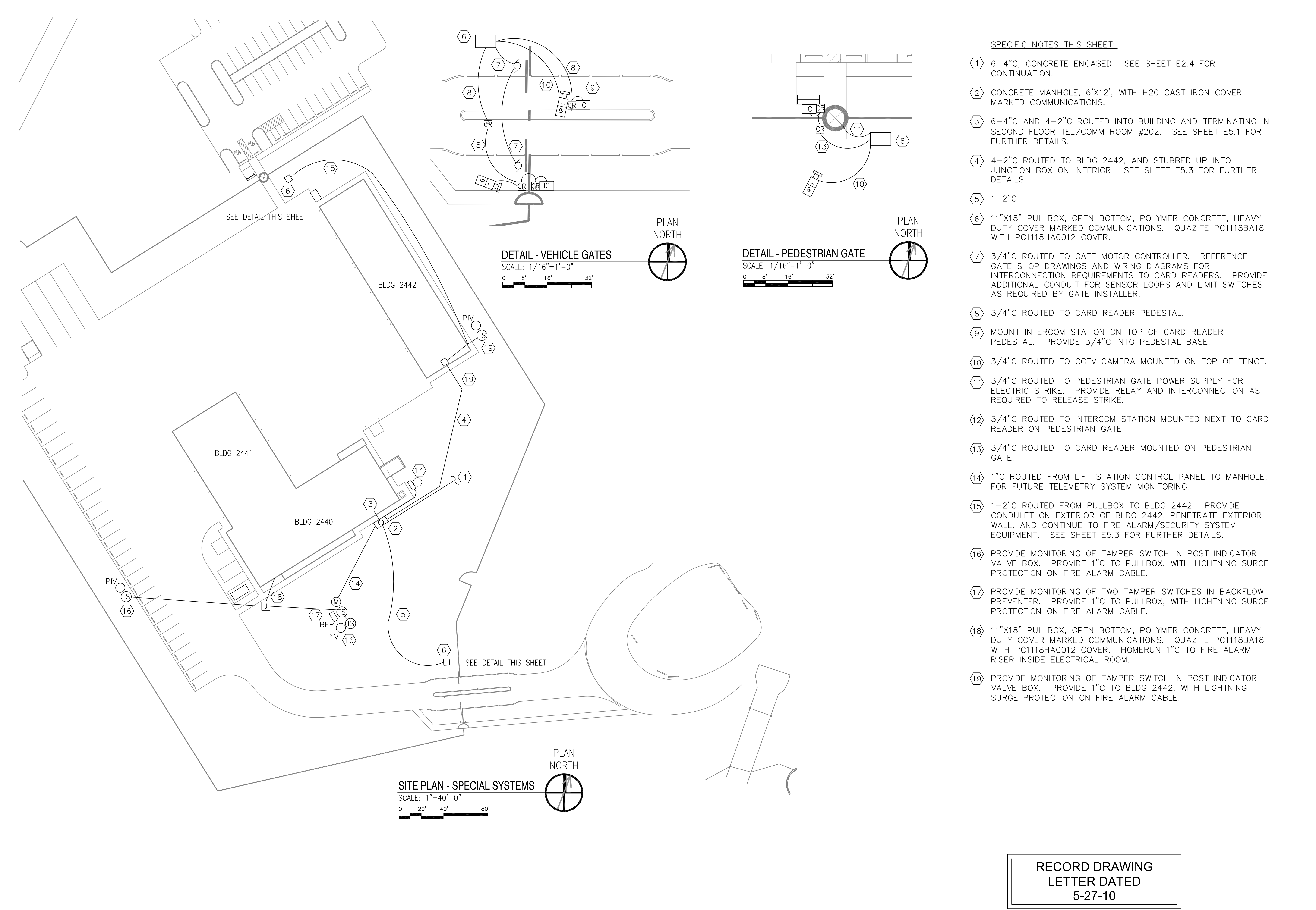

- SPECIFIC NOTES THIS SHEET:
- ① 6-4" C, CONCRETE ENCASED. SEE SHEET E2.4 FOR CONTINUATION.
 - ② CONCRETE MANHOLE, 6'X12', WITH H2O CAST IRON COVER MARKED COMMUNICATIONS.
 - ③ 6-4" C AND 4-2" C ROUTED INTO BUILDING AND TERMINATING IN SECOND FLOOR TEL/COMM ROOM #202. SEE SHEET E5.1 FOR FURTHER DETAILS.
 - ④ 4-2" C ROUTED TO BLDG 2442, AND STUBBED UP INTO JUNCTION BOX ON INTERIOR. SEE SHEET E5.3 FOR FURTHER DETAILS.
 - ⑤ 1-2" C.
 - ⑥ 11"X18" PULLBOX, OPEN BOTTOM, POLYMER CONCRETE, HEAVY DUTY COVER MARKED COMMUNICATIONS. QUAZITE PC1118BA18 WITH PC1118HA0012 COVER.
 - ⑦ 3/4" C ROUTED TO GATE MOTOR CONTROLLER. REFERENCE GATE SHOP DRAWINGS AND WIRING DIAGRAMS FOR INTERCONNECTION REQUIREMENTS TO CARD READERS. PROVIDE ADDITIONAL CONDUIT FOR SENSOR LOOPS AND LIMIT SWITCHES AS REQUIRED BY GATE INSTALLER.
 - ⑧ 3/4" C ROUTED TO CARD READER PEDESTAL.
 - ⑨ MOUNT INTERCOM STATION ON TOP OF CARD READER PEDESTAL. PROVIDE 3/4" C INTO PEDESTAL BASE.
 - ⑩ 3/4" C ROUTED TO CCTV CAMERA MOUNTED ON TOP OF FENCE.
 - ⑪ 3/4" C ROUTED TO PEDESTRIAN GATE POWER SUPPLY FOR ELECTRIC STRIKE. PROVIDE RELAY AND INTERCONNECTION AS REQUIRED TO RELEASE STRIKE.
 - ⑫ 3/4" C ROUTED TO INTERCOM STATION MOUNTED NEXT TO CARD READER ON PEDESTRIAN GATE.
 - ⑬ 3/4" C ROUTED TO CARD READER MOUNTED ON PEDESTRIAN GATE.
 - ⑭ 1" C ROUTED FROM LIFT STATION CONTROL PANEL TO MANHOLE, FOR FUTURE TELEMETRY SYSTEM MONITORING.
 - ⑮ 1-2" C ROUTED FROM PULLBOX TO BLDG 2442. PROVIDE CONDULET ON EXTERIOR OF BLDG 2442, PENETRATE EXTERIOR WALL, AND CONTINUE TO FIRE ALARM/SECURITY SYSTEM EQUIPMENT. SEE SHEET E5.3 FOR FURTHER DETAILS.
 - ⑯ PROVIDE MONITORING OF TAMPER SWITCH IN POST INDICATOR VALVE BOX. PROVIDE 1" C TO PULLBOX, WITH LIGHTNING SURGE PROTECTION ON FIRE ALARM CABLE.
 - ⑰ PROVIDE MONITORING OF TWO TAMPER SWITCHES IN BACKFLOW PREVENTER. PROVIDE 1" C TO PULLBOX, WITH LIGHTNING SURGE PROTECTION ON FIRE ALARM CABLE.
 - ⑱ 11"X18" PULLBOX, OPEN BOTTOM, POLYMER CONCRETE, HEAVY DUTY COVER MARKED COMMUNICATIONS. QUAZITE PC1118BA18 WITH PC1118HA0012 COVER. HOMERUN 1" C TO FIRE ALARM RISER INSIDE ELECTRICAL ROOM.
 - ⑲ PROVIDE MONITORING OF TAMPER SWITCH IN POST INDICATOR VALVE BOX. PROVIDE 1" C TO BLDG 2442, WITH LIGHTNING SURGE PROTECTION ON FIRE ALARM CABLE.

RECORD DRAWING
LETTER DATED
5-27-10

REVISIONS	NO.	DATE	DESCRIPTION	APPR.
11-5-09	1	11-5-09	REVISED PER URS COMMENTS	
12-4-09	2	12-4-09	SITE FIRE PROTECTION COORDINATION	
5-27-10	3	5-27-10	AS-BUILT REVISIONS	

SCHLAFLY ENGINEERING LLC
 121 SOUTH GENOIS STREET
 NEW ORLEANS LA 70119
 PHONE 504-415-3347
 FAX 504-482-7943
 M. KIMBALL SCHLAFLY, P.E.
 LA REG 27699

DES: K. SCHLAFLY	DRW: K. SCHLAFLY
REVIEWED BY: R. WILTSE	
PM/DM: T. ARTRIP	
CHIEF ENG/ARCH: P. DAMMON	

DEPARTMENT OF THE NAVY NAVAL FACILITIES ENGINEERING COMMAND SOUTHEAST 1ST SOUTH ATLANTIC	MISSISSIPPI JOHN C. STENNIS SPACE CENTER SOF RIVERINE AND COMBATANT CRAFT OPERATIONS FACILITY
NAVAL FACILITIES ENGINEERING COMMAND SOUTHEAST 1ST SOUTH ATLANTIC	MISSISSIPPI JOHN C. STENNIS SPACE CENTER SOF RIVERINE AND COMBATANT CRAFT OPERATIONS FACILITY

CODE ID. NO. N4412	SIZE D
SCALE: AS SHOWN	
MAXIMO NO. #####	
STA. PROJ. NO. P-210	
WORK ORDER NO. 510247	
CONSTR. CONTR. NO. N62467-05-D-0096	
NAVFAC DRAWING NO. 15026755	
SHEET 108 OF 132	

E2.3

DRAWING REVISION: 01 JAN 2009