

REV/DATE: FILE NAME: \\Server\jobs\Government\Stennis ROF\... FINAL REVISIONS 2009\C6.1.dwg LAYOUT NAME: Layout1 PLOTTED: Tuesday, December 01, 2009 - 11:26am

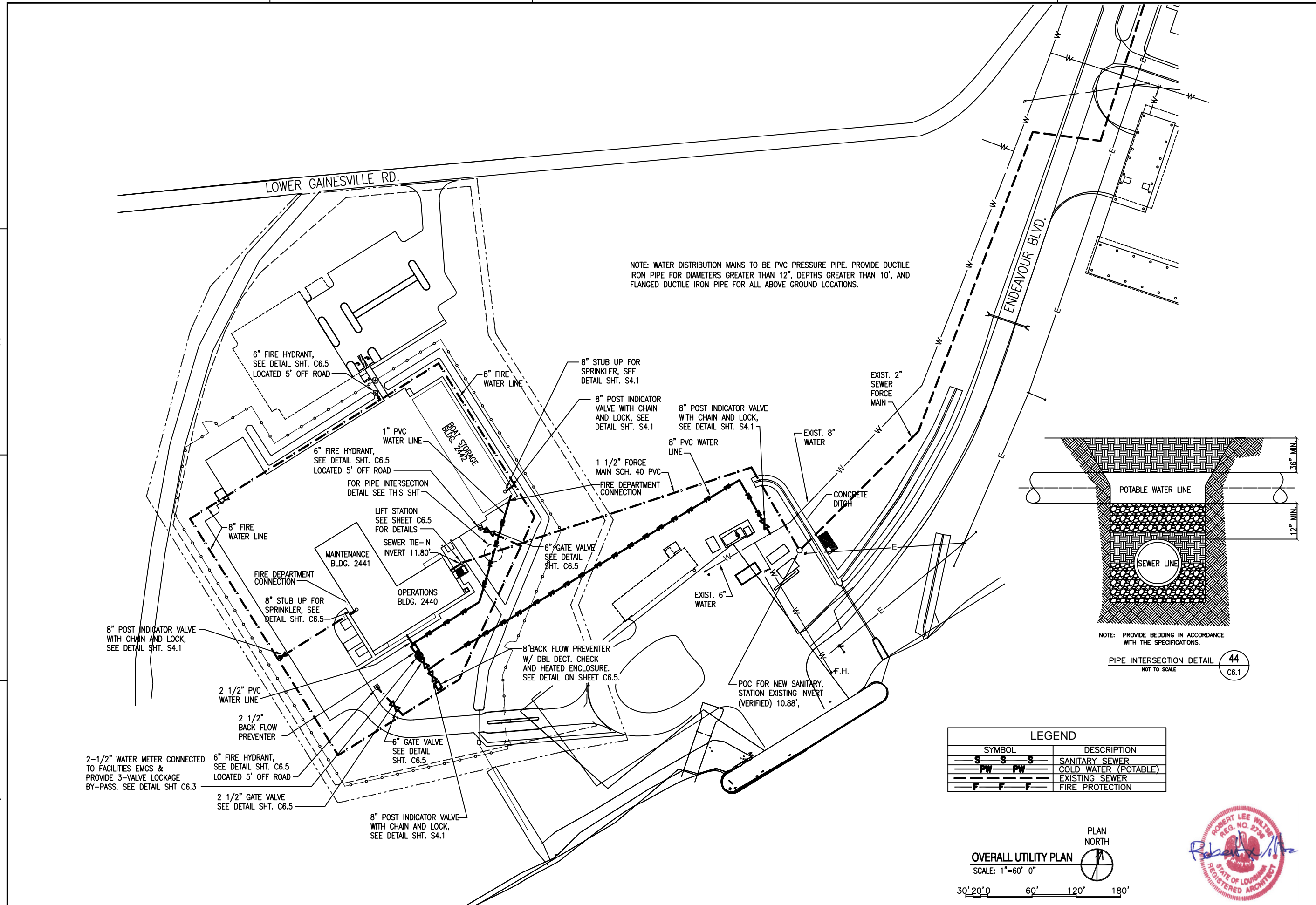

LEGEND	
SYMBOL	DESCRIPTION
	SANITARY SEWER
	COLD WATER (POTABLE)
	EXISTING SEWER
	FIRE PROTECTION

OVERALL UTILITY PLAN  
SCALE: 1"=60'-0"

PLAN NORTH

30' 20' 0" 60' 120' 180'

DATE	APPR	REV	DESCRIPTION
11-30-09	RW		REVISED FIRE PROTECTION WATER LINE PLACEMENT
11-4-09	RW		REVISED AS PER LRS COMMENTS 9 OCTOBER 2009

NAVFAC

**DAMMON**  
ENGINEERING, INC.  
CHIEF ENGINEER: ROBERT DAMMON, P.E.  
CHIEF ARCHITECT: ROBERT WILTSE  
1095 FLORIDA AVENUE  
SUDELL, LA. 70463  
(855) 640-5832  
SEPTEMBER 4, 2009

EMMETT G. DAMMON  
REGISTERED PROFESSIONAL ENGINEER  
STATE OF MISSISSIPPI  
0952

DES: C. DAMMON | DRW: C. DAMMON  
REVIEWED BY: R. WILTSE  
P/W/CHA: T. ARTHUR  
CHIEF ENG/ARCH: P. DAMMON

NAVAL FACILITIES ENGINEERING COMMAND  
NAVAL FACILITIES ENGINEERING COMMAND SOUTHEAST  
NAVAL AIR STATION JACKSONVILLE  
MISSISSIPPI  
JOHN C. STENNIS SPACE CENTER  
SOF RIVERINE AND COMBATANT  
CRAFT OPERATIONS FACILITY - PRE-FINAL  
OVERALL UTILITY PLAN

CODE ID. NO. H4412 | SIZE: D  
SCALE: AS SHOWN  
MAGNO NO. ###  
STA. PROJ. NO. P-210  
WORK ORDER NO. 510247  
CONSTR. CONTR. NO. N62467-05-D-0096  
NAVFAC DRAWING NO. 15026672  
SHEET 25 OF 132  
C6.1

ROBERT LEE WILTSE  
REG. NO. 2738  
REGISTERED ARCHITECT  
STATE OF LOUISIANA