

1 2 3 4 5

A B C D

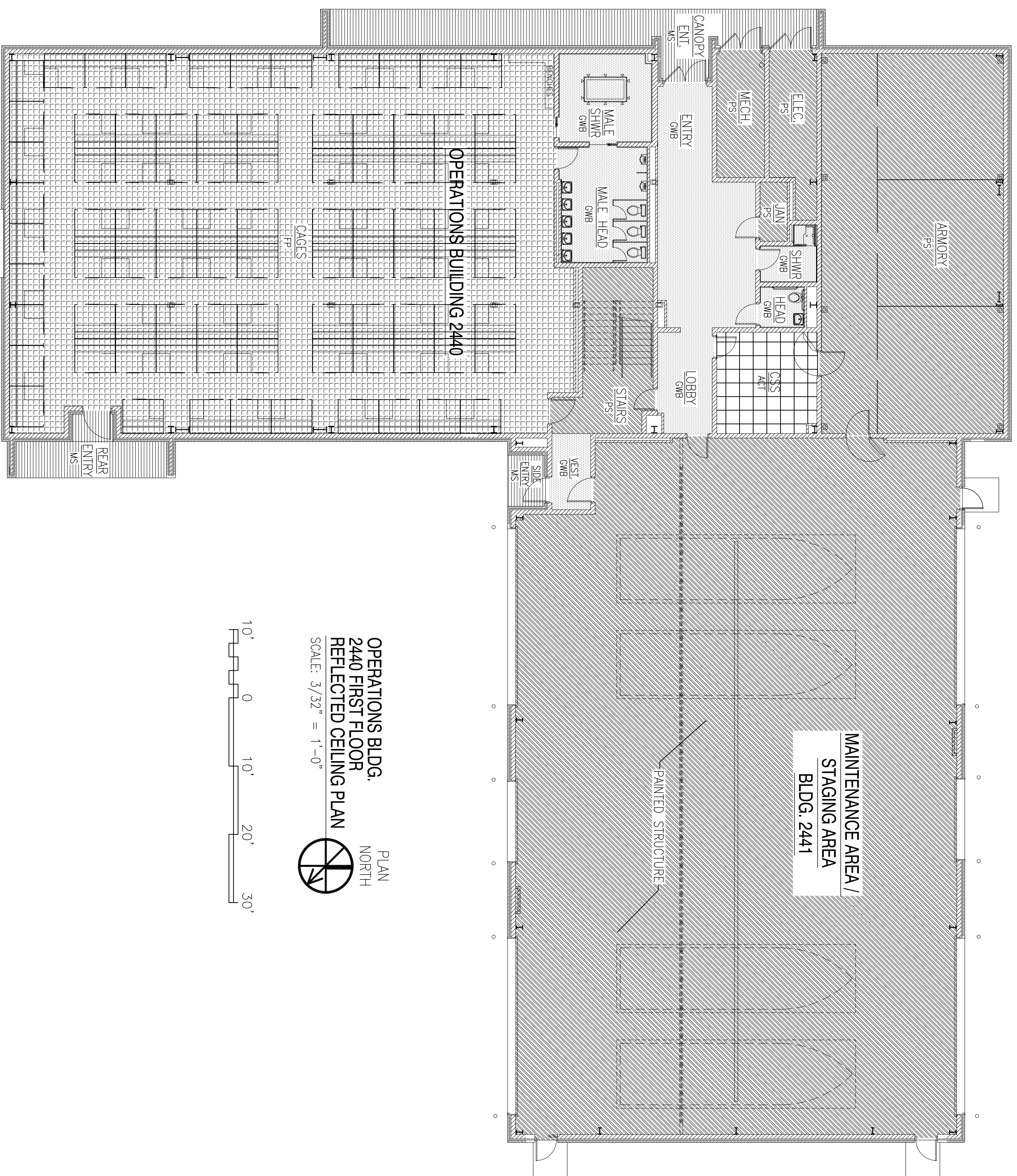

OPERATIONS BLDG.
2440 FIRST FLOOR
REFLECTED CEILING PLAN
SCALE: 3/32" = 1'-0"

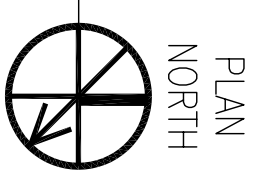

FINISH LEGEND:

ACT	ACOUSTICAL CEILING TILE
CONC	SEALED CONCRETE
CPT-1	CARPET TILE TYPE 1
CPT-2	CARPET TILE TYPE 2
EP	EPOXY PAINT
GWB	GYP SUM WALL BOARD
IRWT	IMPACT RESISTANT WALL TREATMENT
MPI	MASTER PAINTERS INSTITUTE (MPI) SYSTEM EXT 5, 1D-03
MS	METAL SOFFIT
P	PAINT
PS	PAINTED STRUCTURE
PT	PORCELAIN TILE
QVT	QUARTZ VINYL TILE
RB	RUBBER BASE
RT	RUBBER STAR TREADS
FP	FIREPROOFING



<p>DEPARTMENT OF THE NAVY NAVAL FACILITIES ENGINEERING COMMAND SOUTHEAST NAVAL AIR STATION JACKSONVILLE MISSISSIPPI</p> <p>JOHN C. STENNIS SPACE CENTER SOF OPERINE AND COMBATANT CRAFT OPERATIONS FACILITY - PRE-FINAL OPS./MAINT. BLDG. 2440/2441 1ST FLOOR REFLECTED CEILING PLAN</p>	<p>DES: R. WALLACE ENGINEERED BY: R. WALLACE DRAWN: J. HERRMAN CHECKED: T. ARBIB IN CHARGE: P. DAMMON</p>		<p>DAMMON ENGINEERING, INC. CHIEF ENGINEER 1000 W. UNIVERSITY BLVD. SUITE 100 MOBILE, LA 36688 (985) 649-4812</p>		<p>REVISD AS PER URS COMMENTS 9 OCTOBER 2009</p>	<p>11-6-09</p>	<p>RW</p>
<p>SYMBOL</p>	<p>DESCRIPTION</p>	<p>DATE</p>	<p>APPROVED</p>				