

1 2 3 4 5

1 2 3 4 5

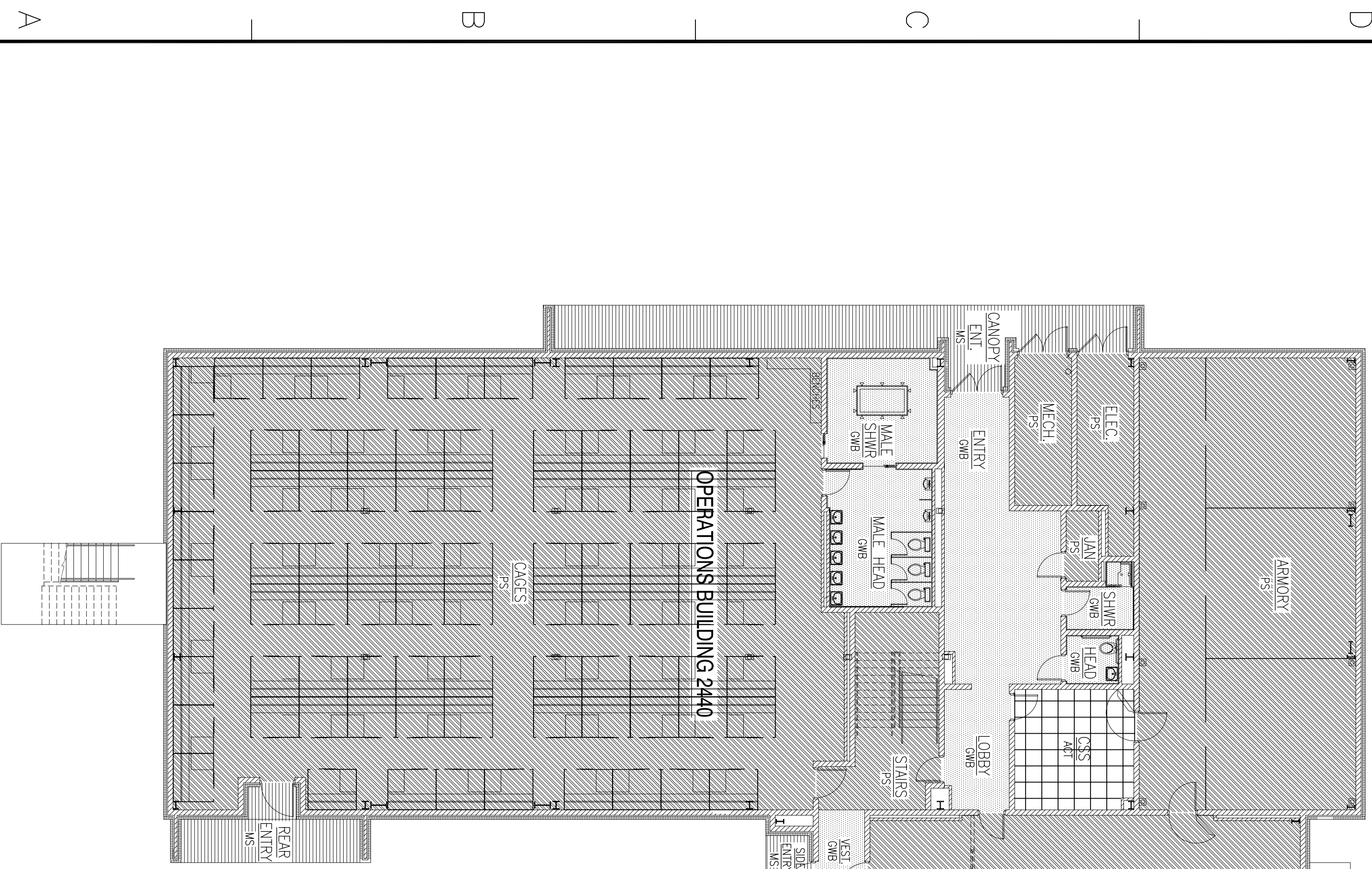

OPERATIONS BLDG.
2440 FIRST FLOOR
REFLECTED CEILING PLAN
SCALE: 3/32" = 1'-0"

PLAN
NORTH

10' 0 10' 20' 30'

FINISH LEGEND:

	ACT	ACOUSTICAL CEILING TILE
	CONC	SEALED CONCRETE
	CPTT-1	CARPET TILE TYPE 1
	CPTT-2	CARPET TILE TYPE 2
	EP	EPOXY PAINT
	GWB	GYPSUM WALL BOARD
	IRWT	IMPACT RESISTANT WALL TREATMENT
	MPI	MASTER PAINTERS INSTITUTE (MPI) SYSTEM EXT 5, 1D-03
	MS	METAL SOFFIT
	P	PAINT
	PS	PAINTED STRUCTURE
	PT	PORCELAIN TILE
	QVT	QUARTZ VINYL TILE
	RB	RUBBER BASE
	RT	RUBBER STAR TREADS



DEPARTMENT OF THE NAVY NAVAL FACILITIES ENGINEERING COMMAND SOUTHEAST NAVAL AIR STATION JACKSONVILLE JOHN C. STENNIS SPACE CENTER MISSISSIPPI SOF OPERINE AND COMBATANT CRAFT OPERATIONS FACILITY - PRE-FINAL OPS./MAINT. BLDG. 2440/2441 1ST FLOOR REFLECTED CEILING PLAN	DESIGNED BY: R. WILKIE DRAWN BY: J. HERNANDEZ CHECKED BY: T. ARBIB IN CHARGE: P. DAMMON		DAMMON ENGINEERING, INC. ENGINEER 3001 LA 7008 SUITE 100 BOULDER, LA 70026 (985) 649-5312		<table border="1"> <thead> <tr> <th>SYM</th> <th>DESCRIPTION</th> <th>DATE</th> <th>APPR</th> </tr> </thead> <tbody> <tr> <td> </td> <td> </td> <td> </td> <td> </td> </tr> <tr> <td> </td> <td> </td> <td> </td> <td> </td> </tr> <tr> <td> </td> <td> </td> <td> </td> <td> </td> </tr> </tbody> </table>	SYM	DESCRIPTION	DATE	APPR												
SYM	DESCRIPTION	DATE	APPR																		