



Basic 47 Laboratory Hood with built-in blower 2247300 is shown with Flat Solid Epoxy Work Surface 4882803 and Protector Acid Storage Cabinet 9901000.

Inset: Basic 70 Laboratory Hood 2246400 is shown with Flat Solid Epoxy Work Surface 4882804 and two Protector Standard Storage Cabinets 9900100.



Requires Ductwork



Basic™ Laboratory Hoods

Features & Benefits

Basic 47 and 70 Laboratory Hoods are designed specifically for modular laboratories, classrooms and light duty applications where safe ventilation is required.

Constructed of epoxy-coated steel, Basic Hoods are economical and have a smaller overall height and depth than traditional hoods so they fit in areas with low ceilings or narrow aisles. Choose from 4' and 6' widths.

Front panel may be removed for access to blower and electrical connections.

Versatile blower mounts on top of the hood liner or in a remote location. Hoods are also available without blower.

CE mark*. Contact Labconco for specific 230 volt, 50 Hz models that conform to CE (European Community) requirements for electrical safety and electromagnetic compatibility.

Two-piece baffle is adjustable.

Durable and attractive exterior is glacier white, dry powder epoxy-coated steel.

Vapor-proof incandescent lighting illuminates the interior. Explosion-proof models include an explosion-proof incandescent light fixture (bulb not included).

The right side fixture panel is factory-prepared for up to three color-coded service fixtures, one duplex electrical receptacle and an airflow monitor.

Top of the hood liner is factory-prepared to accommodate two customer-supplied apparatus rods.

Vertical-rising tempered safety glass sash protects the operator while providing excellent visibility.

ETL-listed. Hoods carry the ETL mark signifying that they are certified to UL 3101-1/61010-1 and CAN/CSA C22.2 No. 1010.1.

The curved air foil directs air flow into the hood to minimize turbulence and ensure fume containment. The foil lifts off for cleaning.

Unassembled models available. Components fit into a carton less than one half its assembled size. The compact container is more economical to ship and store than assembled hood cartons and transports readily to remote locations. Assembly is simple and fast. **Unassembled models are not pre-wired.**

Performance tested to ASHRAE 110-1995.

The right interior wall is factory-prepared to accommodate an accessory cupsink and turret (sold separately).

Durable epoxy-coated 16 gauge steel liner resists chemical degradation.

Pre-wired electrical components. Incandescent lighting and switches are factory-wired to the hood's junction box. **Explosion-proof models are furnished without switches and wiring as these must conform to varying local codes.**

Compact dimensions accommodate tight installations. The 48" height, 53" with built-in blower, makes it ideal for laboratories with lower ceiling heights. Overall depth of 25" makes it adaptable to shallow cabinetry.



* Contact Labconco for specific models.

Exclusive Feature



Basic™ Laboratory Hoods



Requires
Ductwork



Vapor-proof models feature:

- Pre-wired 100-watt vapor-proof incandescent light, light and blower switches.

Explosion-proof models feature:

- Explosion-proof incandescent light fixture. (Requires installation. Bulb not included.)
- **Furnished without switches and wiring as these must conform to varying local codes.**

Models with blower module feature:

- Belt-driven blower with adjustable sheave.
- Epoxy-coated steel base and housing.
- Corrosion-resistant coated aluminum impeller.

Unassembled models feature:

- Basic 47 Hood carton dimensions: 51" w x 39" d x 14.5" h.
- Basic 70 Hood carton dimensions: 74" w x 39" d x 14.5" h.
- Blower carton dimensions (if applicable): 20" w x 28" d x 16" h.

All models require (not included):

- **Blower.** See page 65 and back pocket.**
- **Ductwork.** See back pocket.
- **Work Surface.** See page 104.
- **Base Cabinet or Stand.** See pages 106-116.

Optional accessories for on-site installation include:

- **Service Fixture Kits.** See page 69.
- **Electrical Duplex Kits.** See page 69.
- **Guardian Airflow Monitor Kits.** See page 69.
- **Cupsink and Turret Kit.** See page 69.
- **Sash Stop Kit.** See page 69.
- **Right Side Finish Panel Kit.** See page 69.

Contact Labconco at **800-821-5525** or **816-333-8811** for blower sizing assistance.

*Contact Labconco for specific models.

** Many models include a blower module.

Heights of switches, electrical receptacle and service fixtures meet requirements of ADA.

All models feature:

- By-pass airflow design.
- Curved air foil that lifts off for cleaning.
- Glacier white, dry powder epoxy-coated, 16 gauge steel exterior and interior.
- Two-piece adjustable baffle.
- 3/16" thick tempered safety glass, vertical-rising sash with epoxy-coated aluminum sash handle.
- Removable front panel for access to electrical wiring.
- Factory-prepared right side fixture panel for up to three service fixtures, one duplex electrical receptacle and one airflow monitor (fixtures, receptacle and monitor not included).
- Factory-prepared right interior wall for one cupsink and turret (cupsink and turret not included).

- Factory-prepared top of hood liner for two apparatus rods (rods not included).
- Epoxy-coated steel 10.31" OD exhaust connection.

All models conform to the following regulations and standards:

- SEFA 1-2005
- NFPA 45-2004
- ASTM E84-01
- ASHRAE 110-95
- ANSI Z9.5-2003
- UL 3101-1/61010-1
- CAN/CSA C22.2 No. 1010.1
- CE Conformity Marking (220 volt models)*



Ordering Information & Dimensional Data

Basic™ 47 Laboratory Hoods

Basic 47 Hoods with Blower Module

Capable of overcoming a maximum external static pressure of .25" H₂O at 720 CFM (100 fpm).

Overall dimensions: 47.00" wide x 25.00" deep x 53.00" high (with blower module mounted on top of hood).

Nominal Width	Catalog Number	Electrical Requirements	Incandescent Lamp	Blower Motor	Equivalent Resistance*		Assembly Configuration	Shipping Weight lbs./kg
					10" dia.	12" dia.		
4 Feet	2247300	115 volts, 60 Hz	Vapor-Proof	1/3 hp	100'	250'	Fully Assembled	370/168
	2247301**	220 volts, 50 Hz	Vapor-Proof	1/2 hp	100'	250'	Fully Assembled	370/168
	2247500	115/230 volts, 60 Hz	EP†	1/3 hp, EP	100'	250'	Fully Assembled	375/170
	2247501**	220 volts, 50 Hz	EP†	1/3 hp, EP	100'	250'	Fully Assembled	375/170
	2246603	115 volts, 60 Hz	Vapor-Proof	1/3 hp	100'	250'	Unassembled	272/123 29/13††
	2246604**	220 volts, 50 Hz	Vapor-Proof	1/2 hp	100'	250'	Unassembled	272/123 29/13††
	2246605	115/230 volts, 60 Hz	EP†	1/3 hp, EP	100'	250'	Unassembled	272/123 41/19††
	2246606**	220 volts, 50 Hz	EP†	1/3 hp, EP	100'	250'	Unassembled	272/123 41/19††

Basic 47 Hoods for use with remote blower

Static pressure loss does not exceed .35" H₂O at 100 fpm (720 CFM). Overall dimensions: 47.00" wide x 25.00" deep x 48.00" high.

Nominal Width	Catalog Number	Electrical Requirements	Incandescent Lamp	Assembly Configuration	Shipping Weight lbs./kg
4 Feet	2247400	115 volts, 60 Hz	Vapor-Proof	Fully Assembled	275/125
	2247401**	220 volts, 50 Hz	Vapor-Proof	Fully Assembled	275/125
	2246600	115 volts, 60 Hz	Vapor-Proof	Unassembled	272/123
	2246601**	110/220 volts, 50 Hz	Vapor-Proof	Unassembled	272/123
	2246602	115/230 volts, 50/60 Hz	EP†	Unassembled	272/123

EP = explosion-proof * Maximum length of straight duct to achieve 100 fpm face velocity ** International electrical configuration † Bulb not included †† Shipping weight of separate blower carton

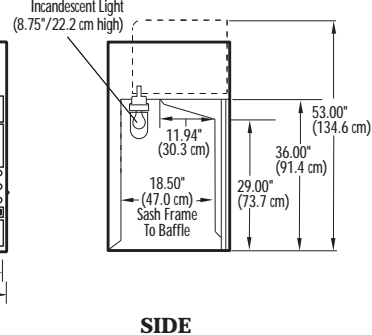
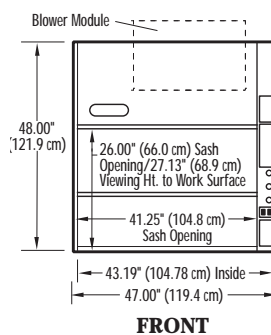
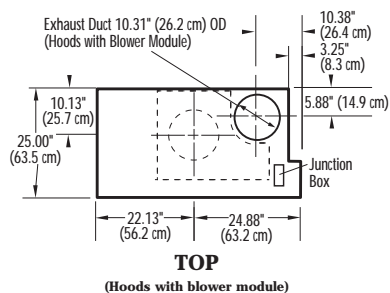
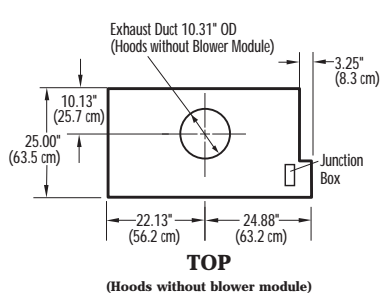

See page 69 for blower module detail.



Ordering Information & Dimensional Data

Basic™ 70 Laboratory Hoods

Basic 70 Hoods with Blower Module

Capable of overcoming a maximum external static pressure of .23" H₂O at 1120 CFM (100 fpm).

Overall dimensions: 70.00" wide x 25.00" deep x 53.00" high (with blower module mounted on top of hood).

Nominal Width	Catalog Number	Electrical Requirements	Incandescent Lamp	Blower Motor	Equivalent Resistance* 10" dia. 12" dia.		Assembly Configuration	Shipping Weight lbs./kg
6 Feet	2246300	115 volts, 60 Hz	Vapor-Proof	3/4 hp	45'	100'	Fully Assembled	450/204
	2246301**	220 volts, 50 Hz	Vapor-Proof	3/4 hp	45'	100'	Fully Assembled	450/204
	2246500	115/230 volts, 60 Hz	EP†	3/4 hp, EP	45'	100'	Fully Assembled	455/206
	2246501**	220 volts, 50 Hz	EP†	3/4 hp, EP	45'	100'	Fully Assembled	455/206
	2246703	115 volts, 60 Hz	Vapor-Proof	3/4 hp	45'	100'	Unassembled	426/193 29/13††
	2246704**	220 volts, 50 Hz	Vapor-Proof	3/4 hp	45'	100'	Unassembled	426/193 41/19††
	2246705	115/230 volts, 60 Hz	EP†	3/4 hp, EP	45'	100'	Unassembled	426/193 41/19††
	2246706**	220 volts, 50 Hz	EP†	3/4 hp, EP	45'	100'	Unassembled	426/193 41/19††

Basic 70 Hoods for use with remote blower

Static pressure loss does not exceed .57" H₂O at 100 fpm (1120 CFM). Overall dimensions: 70.00" wide x 25.00" deep x 48.00" high.

Nominal Width	Catalog Number	Electrical Requirements	Incandescent Lamp	Assembly Configuration	Shipping Weight lbs./kg
6 Feet	2246400	115 volts, 60 Hz	Vapor-Proof	Fully Assembled	430/195
	2246401**	220 volts, 50 Hz	Vapor-Proof	Fully Assembled	430/195
	2246700	115 volts, 60 Hz	Vapor-Proof	Unassembled	426/193
	2246701**	110/220 volts, 50 Hz	Vapor-Proof	Unassembled	426/193
	2246702	115/230 volts, 50/60 Hz	EP†	Unassembled	426/193

EP = explosion-proof * Maximum length of straight duct to achieve 100 fpm face velocity ** International electrical configuration † Bulb not included †† Shipping weight of separate blower carton

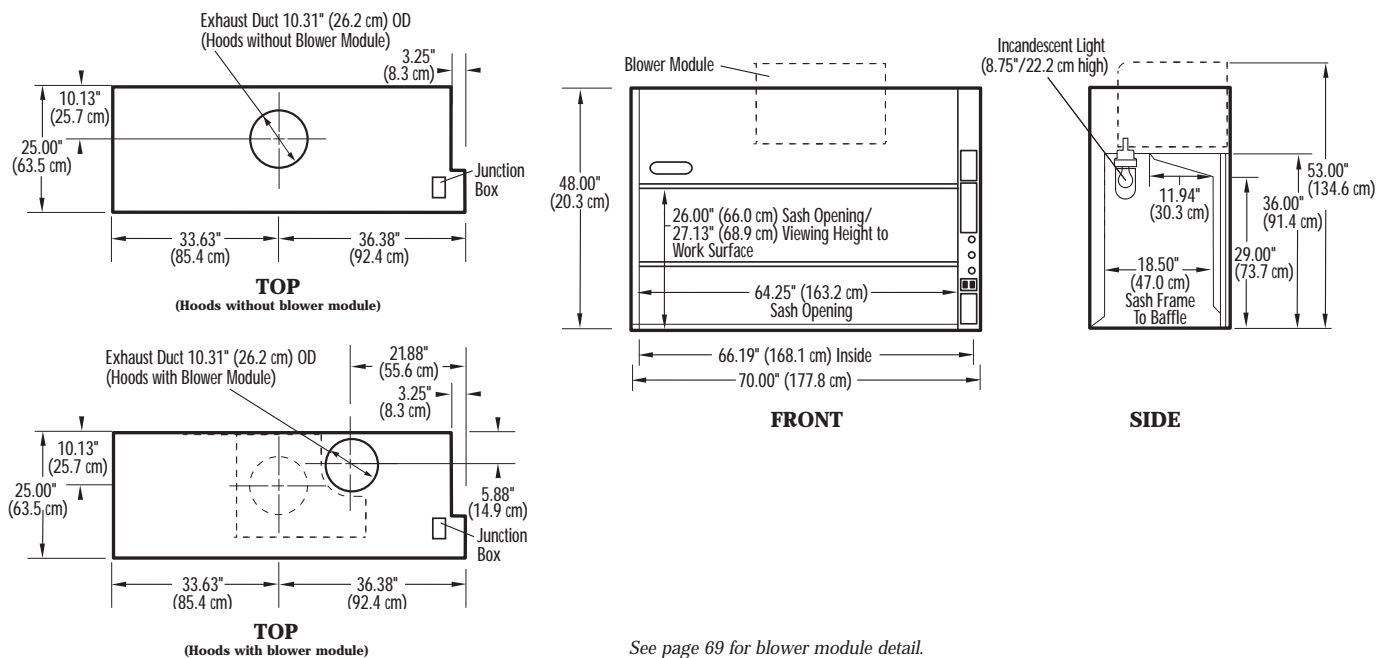

See page 69 for blower module detail.



Accessories

Basic™ Laboratory Hoods



Guardian™ Jr. Airflow Monitor Kits

Audible/visual alarm alerts user to low face velocity. For installation in a factory-prepared cutout on upper portion of right side fixture panel. Shipping weight 6 lbs. (2.7 kg)



Guardian™ Digital Airflow Monitor Kits

An LCD displays average face velocity. Audible/visual alarm alerts user to low or high face velocity. For installation in a factory-prepared cutout on upper portion of right side fixture panel. Shipping weight 6 lbs. (2.7 kg)

Catalog #	Description
9743208	Guardian Jr. Airflow Monitor for 115 volt, 60 Hz operation
9743210**	Guardian Jr. Airflow Monitor for 230 volt, 50 Hz operation

Catalog #	Description
9743207	Guardian Digital Airflow Monitor for 115 volt, 60 Hz operation
9743209**	Guardian Digital Airflow Monitor for 230 volt, 50 Hz operation

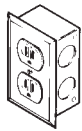

Duplex Electrical Receptacle Kits

Each kit includes duplex electrical receptacle, junction box and receptacle cover plate. For mounting on the lower right side fixture panel. **Electrical wiring is not included.**

Catalog #	Kit	Shipping Wt.
4844400	115 volts, 20 amps AC	4 lbs. (1.8 kg)
4844401	115 volts, 20 amps AC, GFCI	4 lbs. (1.8 kg)



4965901 Sash Stop Kit

The Sash Stop restricts how far the sash may be opened. This small plastic device may be easily installed on the left side of Basic Hoods to restrict sash opening height. Shipping weight 0.5 lb. (0.2 kg)

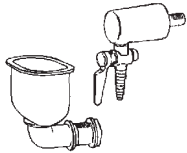

4852500 Cupsink and Turret Kit

Polypropylene cupsink, 3" x 6", and chrome turret mount on right side wall. **Plumbing pipe is not included.** Shipping weight 0.5 lb. (0.2 kg)

4878600 Right Side Finish Panel Kit

Includes a glacier white epoxy-coated steel panel to provide a finished appearance to the right side of the hood. The panel hides the exposed plumbing when service fixtures are installed. Not for use with 4852500 Cupsink and Turret. Shipping weight 20 lbs. (9 kg)

** International electrical configuration

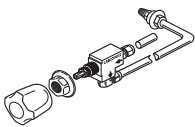

Standard Service Fixture Kits

Each kit includes one remotely-controlled service fixture with 0.25" diameter valve and tubing, color-coded fixture knob and color-coded hose connector. For mounting on the right side fixture panel. Shipping weight 4 lbs. (1.8 kg)

Catalog #	Kit	Tubing	Valve	Knob/Connector Color	Maximum Flow Rate	Maximum Working Pressure*
2832600	Cold Water (CW)	Copper	Brass	Green	3.5 GPM (13.2 LPM)	40 psi
2832601	Hot Water (HW)	Copper	Brass	Red	3.5 GPM (13.2 LPM)	40 psi
2832602	Deionized/ Distilled Water (DI)	Stainless Steel	Nickel-Plated/ Stainless Steel	White	3.5 GPM (13.2 LPM)	40 psi
2832603	Vacuum (VAC)	Copper	Brass	Yellow	8.6 CFM	14.7 psi
2832604	Air (AIR)	Copper	Brass	Orange	23.7 CFM	40 psi
2832605	Gas (GAS)	Brass	Brass	Blue	29.0 CFM (441 BTU/sec)	40 psi
2832606	Nitrogen (NIT)	Copper	Brass	Brown	24.1 CFM	40 psi
2832607	Argon (ARG)	Copper	Brass	Gray	20.2 CFM	40 psi
2832608	Steam (STM)	Copper	Brass	Black	0.5 LBM/min	40 psi

GPM = gallons per minute LPM = liters per minute CFM = cubic feet per minute BTU/sec = British thermal unit per second LBM/min = pounds mass per minute
* Maximum allowable pressure is 200 psi with a working pressure of 40 psi.

Blower Module Detail

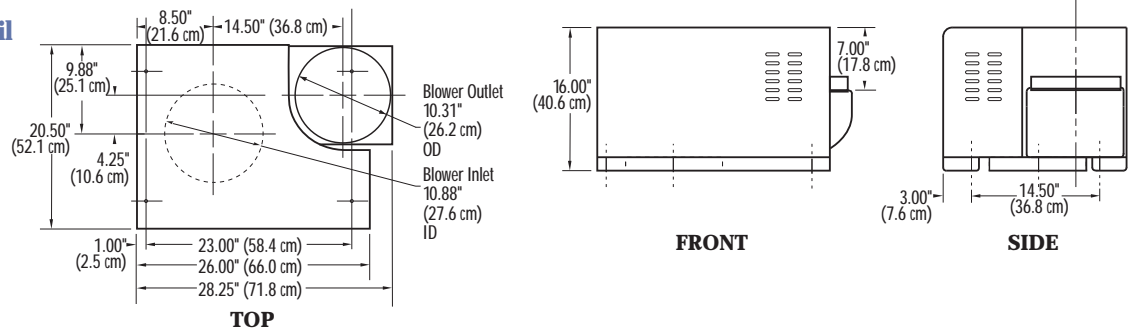



Fiberglass 30 Laboratory Hoods



Fiberglass 30 Laboratory Hood 3030002 is shown with Flat Solid Epoxy Work Surface 4882806 and Protector Standard Storage Cabinet 9900200. Remote blower, ductwork, work surface and base cabinet must be ordered separately.

Compact Fiberglass 30 Laboratory Hoods are designed for research, educational and clinical applications requiring small working space and efficient fume removal. Like the Protector Premier line, these hoods feature a corrosion-resistant, one-piece molded fiberglass liner.

All models feature:

- By-pass airflow design.
- Durable glacier white, dry powder epoxy-coated steel exterior.
- One-piece molded fiberglass interior and pre-set baffle with flame spread index less than 25 per ASTM E-84.
- 3/16" thick tempered safety glass vertical-rising sash with epoxy-coated aluminum handle.
- Pivoting air foil.
- Right side fixture panel factory-prepared to accept up to three service fixtures, one electrical duplex and one airflow monitor (kits are sold separately).
- 6.69" ID fiberglass exhaust connection.

All models conform to the following regulations and standards:

- SEFA 1-2005
- NFPA 45-2004
- ASTM E84-01
- ASHRAE 110-95
- ANSI Z9.5-2003
- UL 3101-1/61010-1
- CAN/CSA C22.2 No. 1010.1
- UL 1805
- CE Conformity Marking (230 volt models)*

Models 3030000 and 3030001 feature:

- Built-in corrosion-resistant, direct drive exhaust blower capable of overcoming a maximum external static pressure of 0.12" H₂O at 310 CFM (100 fpm).
- Pre-wired 100 watt, vapor-proof incandescent lighting, light and blower switches.

Models 3030002 and 3030003:

- Designed for use with remote blower (not included).

- Static pressure loss does not exceed 0.14" H₂O at 100 fpm (310 CFM).
- Pre-wired 100 watt, vapor-proof incandescent lamp, light and blower switches.

Models 3030004 and 3030005 feature:

- Built-in corrosion-resistant, explosion-proof, direct drive exhaust blower capable of overcoming a maximum external static pressure of 0.12" H₂O at 310 CFM (100 fpm).
- **Furnished without light, switches or wiring. Wiring must conform to local codes.** (Explosion-proof Light Fixture Kit is available. See page 71.)

All models require (not included):

- **Ductwork.** See back pocket.
- **Work Surface.** See page 104.
- **Base Cabinet or Stand.** See pages 106-116.

Optional accessories for on-site installation include:

- **Service Fixture Kits.** See page 71.
- **Electrical Duplex Kits.** See page 71.
- **Guardian Airflow Monitor Kits.** See page 71.
- **Explosion-Proof Light Fixture Kit.** See page 71.

Contact Labconco at **800-821-5525** or **816-333-8811** for blower sizing assistance.

*Contact Labconco for specific models.

Ordering Information

Catalog Number	Built-in Blower	Equivalent Resistance**		Electrical Requirements	Vapor-Proof Lamp	Dimensions (w x d x h)	Shipping Weight lbs./kg
		6" dia.	8" dia.				
3030000	1/10 HP, Std.	20'	80'	115 volts, 60 Hz	100 watt	30.00" x 30.16" x 48.00"	230/104
3030001 †	1/3 HP, Std.	20'	80'	230 volts, 50 Hz	100 watt	30.00" x 30.16" x 52.00"	230/104
3030002	None	—	—	115 volts, 60 Hz	100 watt	30.00" x 30.16" x 48.00"	210/95
3030003 †	None	—	—	230 volts, 50 Hz	100 watt	30.00" x 30.16" x 48.00"	210/95
3030004	1/4 HP, EP	20'	80'	115 volts, 60 Hz	None	30.00" x 30.16" x 54.00"	240/109
3030005 †	1/3 HP, EP	20'	80'	230 volts, 50 Hz	None	30.00" x 30.16" x 54.00"	240/109

EP = Explosion-proof ** Maximum length of straight duct to achieve 100 fpm face velocity † International electrical configuration



Accessories & Dimensional Data

Fiberglass 30 Laboratory Hoods

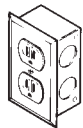

Duplex Electrical Receptacle Kits

Each kit includes duplex electrical receptacle, wiring, junction box and receptacle cover plate. For mounting on the lower right side fixture panel.

Catalog #	Kit	Shipping Wt.
2834800	115 volts, 20 amps AC	4 lbs. (1.8 kg)
2834801	115 volts, 20 amps AC, GFCI	4 lbs. (1.8 kg)

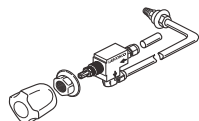

Standard Service Fixture Kits

Each kit includes one remotely-controlled service fixture with 0.25" diameter valve and tubing, color-coded fixture knob and color-coded hose connector. For mounting on the right side fixture panel. Shipping weight 4 lbs. (1.8 kg.)

Catalog #	Kit	Tubing	Valve	Knob/Connector Color
2832600	Cold Water (CW)	Copper	Brass	Green
2832601	Hot Water (HW)	Copper	Brass	Red
2832602	Deionized/ Distilled Water (DI)	Stainless Steel	Nickel-Plated/ Stainless Steel	White
2832603	Vacuum (VAC)	Copper	Brass	Yellow
2832604	Air (AIR)	Copper	Brass	Orange
2832605	Gas (GAS)	Brass	Brass	Blue
2832606	Nitrogen (NIT)	Copper	Brass	Brown
2832607	Argon (ARG)	Copper	Brass	Gray
2832608	Steam (STM)	Copper	Brass	Black

See maximum flow rates and working pressures on page 69.



Guardian™ Digital Airflow Monitor Kits

An LCD displays average face velocity. Audible/visual alarm alerts user to low or high face velocity. For installation in a factory-prepared cutout on upper portion of right side fixture panel. Shipping weight 6 lbs. (2.7 kg)

Catalog #	Description
9743201	Guardian Digital Airflow Monitor for 115 volt, 60 Hz operation
9743205*	Guardian Digital Airflow Monitor for 230 volt, 50 Hz operation



Guardian™ 500 Airflow Monitor Field Installation Kits

Audible/visual alarm alerts user to low face velocity. For installation in a factory-prepared cutout on upper portion of right side fixture panel. Shipping weight 6 lbs. (2.7 kg)

Catalog #	Description
9743213	Guardian Jr. Airflow Monitor for 115 volt, 60 Hz operation
9743214*	Guardian Jr. Airflow Monitor for 230 volt, 50 Hz operation

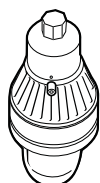

4892900 Explosion-Proof Light Fixture Kit

For mounting on Fiberglass 30 Hood 3030004 or 3030005. Includes explosion-proof incandescent light fixture, mounting hardware and instructions. 13" h x 7" diameter. **Bulb and electrical wiring are not included.** Shipping weight 11 lbs. (5 kg)

* International electrical configuration

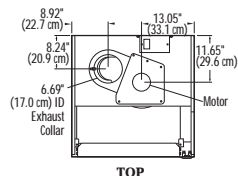

TOP

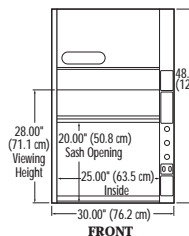

FRONT

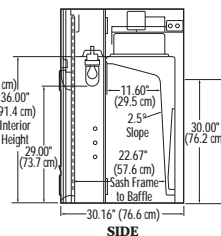

SIDE

3030000
(with Built-in Blower)

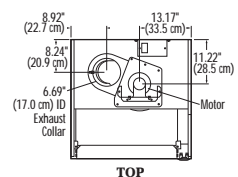

TOP

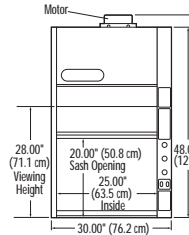

FRONT

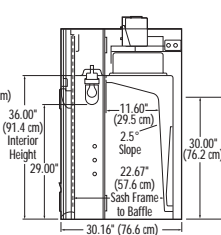

SIDE

3030001
(with Built-in Blower)

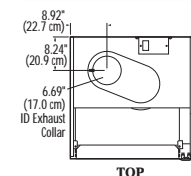

TOP

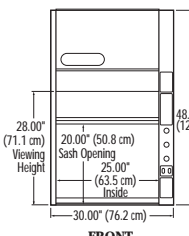

FRONT

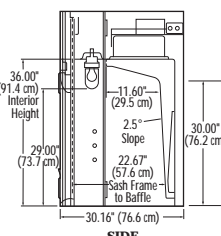

SIDE

3030002 and 3030003
(for use with Remote Blower)

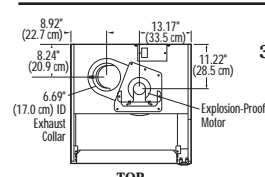

TOP

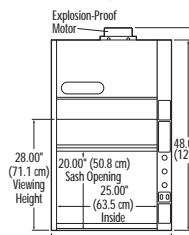

FRONT

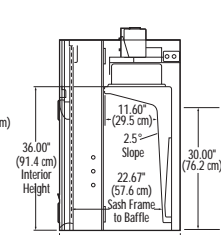

SIDE

3030004 and 3030005
(with Built-in
Explosion-Proof Blower)