

**DAMMON
ENGINEERING, INC.**

CHIEF ENGINEER
EMMETT
DAMMON, P.E.

CHIEF ARCHITECT
ROBERT
WILTSE

1095 FLORIDA AVENUE
SLIDELL, LA. 70458
OFFICE: 985-649-5832
FAX: 985-641-5950

WEBSITE:
WWW.DAMMONENGINEERING.COM

EMAIL:
DAMMONENG@BELLSOUTH.NET

ARCHITECTURE

ENGINEERING

STUDIES

PLANNING

INVESTIGATION

EXPERT WITNESS

SOUTHEAST
LOUISIANA
VETERAN'S
HEALTH CARE
SYSTEM

SUITE D
REFLECTED
CEILING
PLAN

REV:

SCALE: AS NOTED

JOB#: 2012

DATE: 03-17-09

SHEET 5

A-3

OF 11

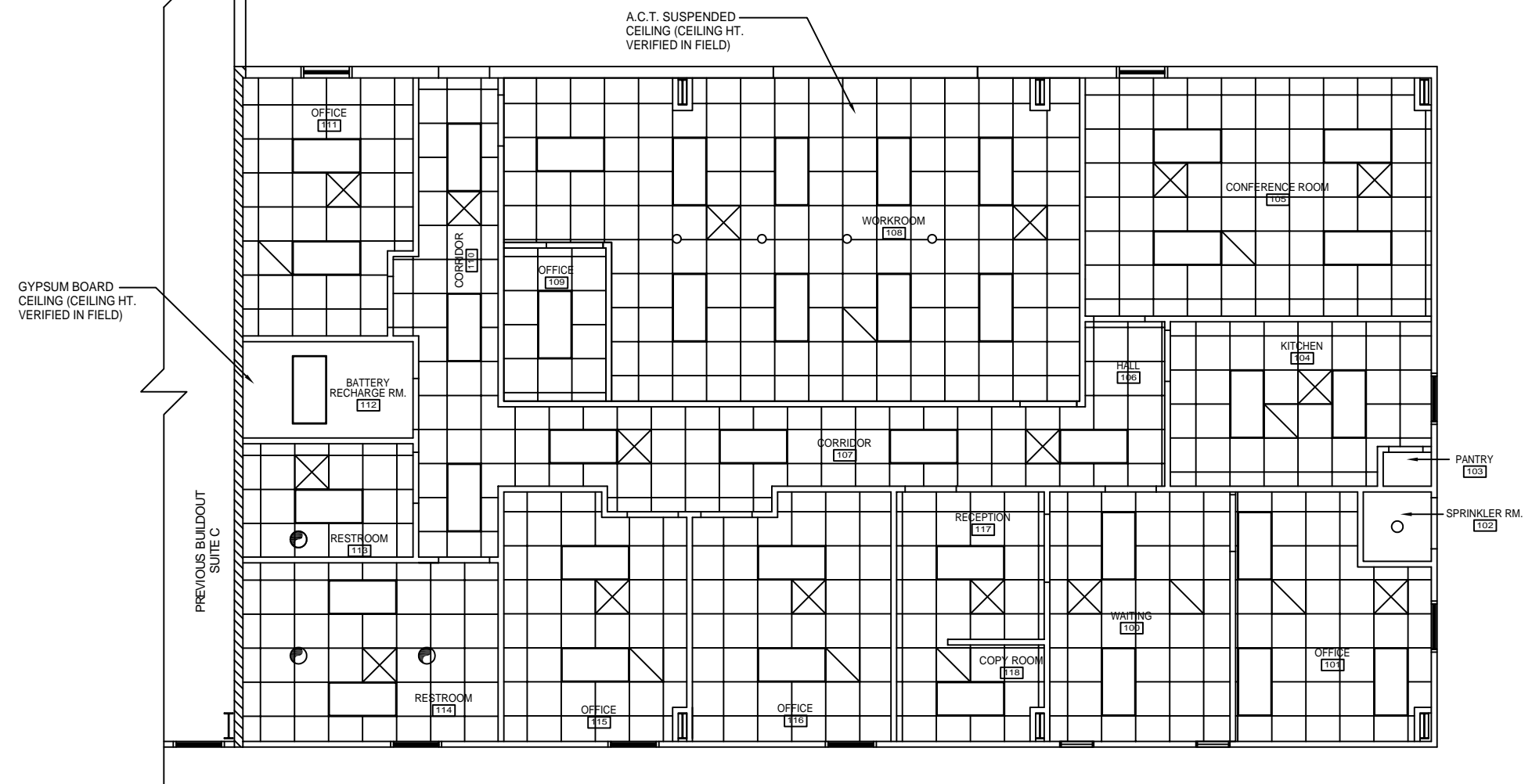

- LEGEND**
- ☒ - SUPPLY AIR
 - ☐ - RETURN AIR
 - ⊗ - EXHAUST FAN
 - ▭ - 2x4' FLUORESCENT LIGHT
 - ⊞ - 2x2' A.C.T. SUSPENDED CEILING
9'-0" TYPICAL CEILING HEIGHT

A.C.T. SUSPENDED
CEILING (CEILING HT.
VERIFIED IN FIELD)

GYPSUM BOARD
CEILING (CEILING HT.
VERIFIED IN FIELD)

PREVIOUS BUILDOUT
SUITE C

REFLECTED CEILING PLAN - SUITE D
SCALE: 1/4"=1'

