

DAMMON
ENGINEERING, INC.

CHIEF ENGINEER
EMMETT
DAMMON, P.E.

CHIEF ARCHITECT
ROBERT
WILTSE

1095 FLORIDA AVENUE
SLIDELL, LA. 70458
OFFICE: 985-649-5832
FAX: 985-641-5950

WEBSITE:
WWW.DAMMONENGINEERING.COM

EMAIL:
DAMMONENG@BELLSOUTH.NET

ARCHITECTURE
ENGINEERING
STUDIES
PLANNING
INVESTIGATION
EXPERT WITNESS

PATTERSON
DENTAL
OFFICE
RENOVATION

EXISTING
REFLECTED
CEILING
PLAN

REV:

SCALE: AS NOTED

JOB#: 2076

DATE: 08-25-10

SHEET

X-2



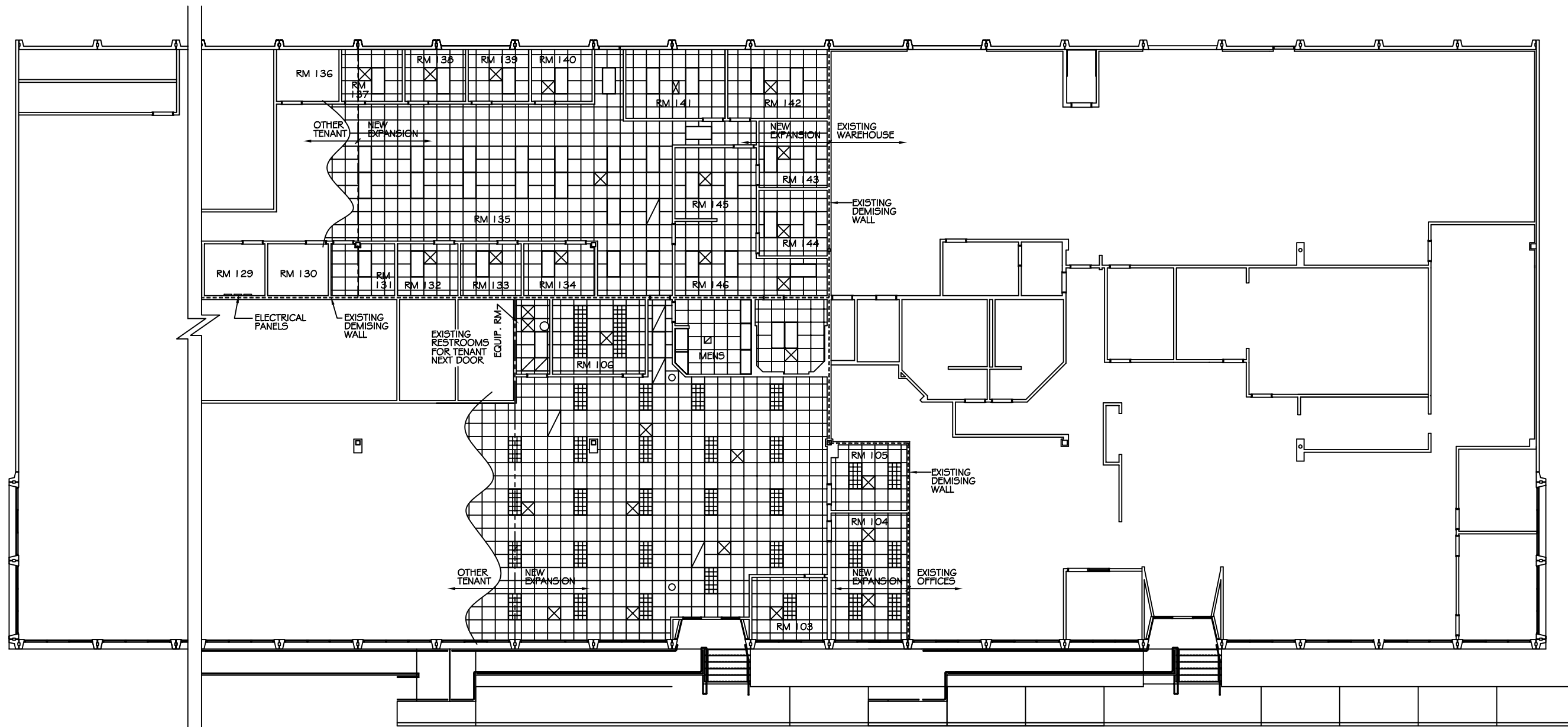



OF

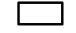

EXISTING REFLECTED CEILING PLAN

SCALE: 1/8" = 1'-0"

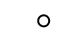
LEGEND

-  - 2x4' FLUORESCENT LIGHT FIXTURE
-  - 2x4' PARABOLIC LIGHT FIXTURE
-  - HVAC SUPPLY AIR GRILLE
-  - HVAC RETURN AIR GRILLE
-  - INTERCOM SPEAKER
-  - EXISTING CEILING GRID

PRELIMINARY (NOT FOR CONSTRUCTION)