









## VACUUM NOTES

THE VACUUM PIPING LAYOUT HAS A LARGE EFFECT ON THE EFFICIENCY AND RELIABILITY OF THE DENTAL VACUUM SYSTEM. REFER TO MANUFACTURER'S PRE-INSTALLATION GUIDE PROVIDED BY HENRY SCHEIN EQUIPMENT SPECIALIST FOR SPECIFIC SIZING OF STUB-UP, TRUNK, AND BRANCH LINES.

IT IS HIGHLY RECOMMENDED THAT VACUUM LINES RUN UNDERNEATH DENTAL EQUIPMENT BY MEANS OF TRENCHING/ CORING (CONCRETE SLAB) OR IN SUB FLOOR (BASEMENT/ CRAWL SPACE). ALL LINES ARE TO BE DESIGNED WITH PVC PIPING UNLESS DICTATED BY LOCAL CODES TO USE COPPER OR CAST IRON.

TO ENSURE OPTIMUM VACUUM PERFORMANCE, INSTALL MAIN LINE DIRECTLY BELOW THE DENTAL CHAIR, CABINET OR WALL JUNCTION BOX TO REDUCE OR ELIMINATE BRANCH LINE RUNS WHEREVER POSSIBLE.

**1. STUB-UP**  
TERMINATE VACUUM TRUNK LINE IN MECHANICAL ROOM W/ VERTICAL STUB-UP 3" A.F.F. PLUMBING CONTRACTOR TO PROVIDE FPT ADAPTOR ON END OF STUB-UP. SIZE OF ADAPTOR TO BE DETERMINED BY TRUNK AND PUMP INTAKE PIPE SIZES. IN THE CASE OF DUAL TRUNK LINE SYSTEM, PROVIDE ENOUGH SPACE BETWEEN STUB-UPS TO INSTALL TEES ON BOTH LINES.

**2. TRUNK LINE(S)**  
VACUUM TRUNK LINE(S) TO BE SUPPORTED EVERY 6'-0" TO PREVENT SAG AND SLOPED A MINIMUM OF 1/4" PER 10'-0" TOWARD THE VACUUM PUMP.

**3. BRANCH LINE(S)**  
BRANCH LINES ARE TO BE 'SWEEPING' 90 DEGREE TURNS TO AVOID VACUUM LOSS. A "Y" TEE FITTING SHOULD BE USED WHEN AVAILABLE TO BRANCH TWO LINES TOGETHER.

**SPECIAL NOTE:**  
IF VACUUM LINES ENCR OACH ON EITHER A WALL OR COLUMN FOOTING, USE 45 DEGREE ELBOWS TO PIPE AROUND FOOTING SO PIPE REACHES PROPER LOCATION.

## BRANCH LINE CONFIGURATIONS

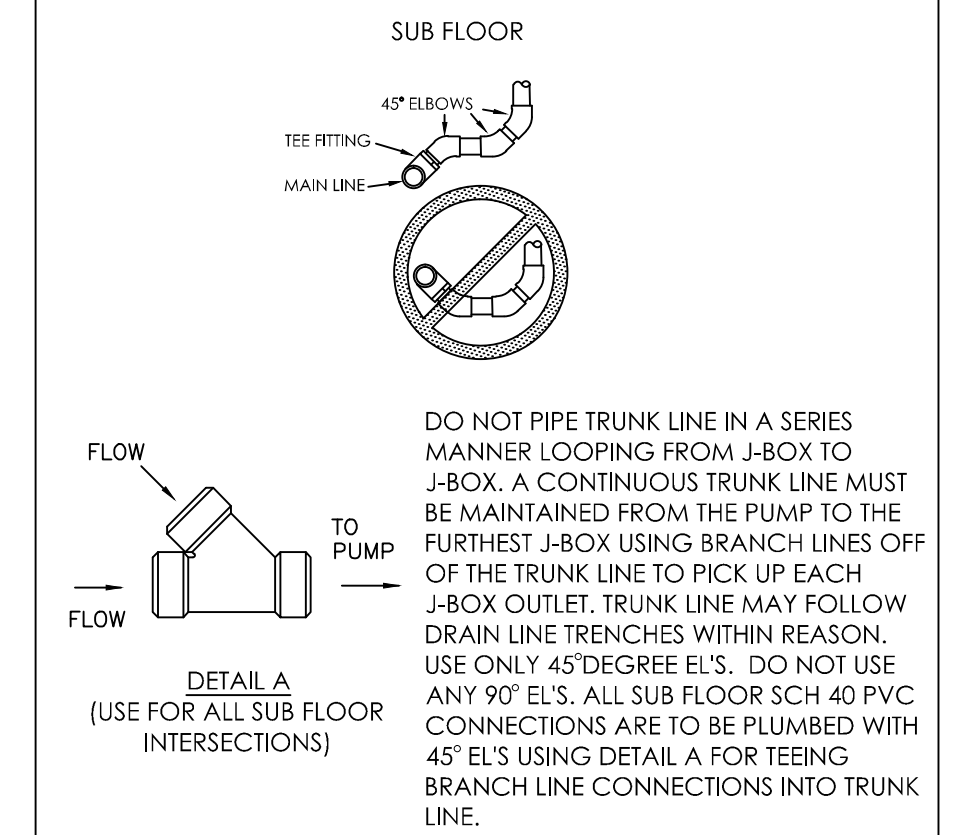

## PLUMBING NOTES

1. THIS SPECIFICATION SHEET IS INTENDED AS A GUIDE FOR TRADESMEN. THE FLOOR PLANS ENCLOSED HEREIN ARE SUGGESTIONS FOR THE PLACEMENT OF DENTAL EQUIPMENT. THEY ARE NOT INTENDED FOR CONSTRUCTION.
2. EXACT EQUIPMENT LOCATIONS MUST BE JOB SITE VERIFIED BY THE HENRY SCHEIN DENTAL EQUIPMENT SPECIALIST.
3. FOLLOW MANUFACTURER'S DRAWINGS FOR EXACT REQUIREMENTS FOR ANY EQUIPMENT SUPPLIED BY HENRY SCHEIN DENTAL. CONSULT WITH HENRY SCHEIN DENTAL REP FOR ADDITIONAL INFORMATION.
4. ANY REFERENCE TO "AIR", "COMPRESSED AIR" OR "AIR COMPRESSOR" REFER TO THE UNIT AND ALL COMPONENTS WHICH ARE CONSIDERED A LEVEL 3 "GAS-DRIVEN DEVICE" SUPPLY SYSTEM. REFER TO NFPA 99, 2005, 5.3.3.5 FOR REGULATIONS & REQUIREMENTS. THIS SHOULD NOT BE CONFUSED WITH "AIR" AS IT IS DEFINED IN LEVEL 1 OR LEVEL 2 MEDICAL FACILITIES.
5. WATER PRESSURE MUST NOT EXCEED 50 PSI AT ALL DENTAL UNITS.
6. BACK-FLOW PREVENTION IS REQUIRED ON ALL LINES AS PER LOCAL CODE.

SEE SHEET SPE.1 FOR ILLUSTRATIONS & DETAILS

## PLUMBING SPECIFICATIONS

QUANTITY	SPEC. NUMBER	DESCRIPTION	UTILITIES							CONS. DETAIL	
			COLD WATER	HOT WATER	DRAIN	AIR	NATURAL GAS	VACUUM	OXYGEN		VENT
12	3	UTILITY CENTER - CONTRACTOR TO PROVIDE REQ'D UTILITIES. BACK FLOW PREVENTION REQUIRED AS PER LOCAL CODE.	•								3
3	13	COMPRESSED AIR LINE AND VALVE - CONTRACTOR TO PROVIDE REQ'D UTILITIES. TERMINATE WITH A 3/8" COMPRESSION STOP.				•					13
1	158	HANDPIECE MAINTENANCE SYSTEM - CONTRACTOR TO PROVIDE REQ'D UTILITIES. 1/2" AIR LINE WITH VALVE STOP (58-145 PSI) ABOVE COUNTERTOP. SYSTEM SUPPLIED AND INSTALLED BY HENRY SCHEIN DENTAL.				•					158
1	16	MODEL TRIMMER - CONTRACTOR TO PROVIDE REQ'D UTILITIES. MODEL TRIMMER SUPPLIED AND INSTALLED BY HENRY SCHEIN DENTAL. BACK FLOW PREVENTION REQUIRED PER CODE.				•					16
1	17	PLASTER TRAP - SUPPLIED BY HENRY SCHEIN DENTAL. INSTALLED BY CONTRACTOR ON SINK DRAIN LINE.				•					17
1	25	DENTAL AIR COMPRESSOR - FOR GAS-DRIVEN DEVICES IN A LEVEL 3 FACILITY. CONTRACTOR TO PROVIDE REQ'D UTILITIES AND FRESH-AIR INTAKE VENT. 1/2" I.D. COPPER TYPE K OR L SUPPLY LINES TO LOCATIONS THAT REQUIRE AIR. BUCK BOOST TRANSFORMER SUPPLIED AND INSTALLED BY CONTRACTOR (IF REQ'D). FINAL CONNECTIONS BY CONTRACTOR. REFER TO NFPA 99, 2005, 5.3.3.5 FOR REGULATIONS & REQUIREMENTS.									25
1	26B	VACUUM PUMP (WET) - CONTRACTOR TO PROVIDE REQ'D UTILITIES. SCH 40 PVC MAIN TRUNK LINES (WHERE PERMITTED BY CODE). TRUNK, REDUCTION AND BRANCH LINE SIZES PER MFR RECOMMENDATIONS. EXHAUST PUMP TO OUTSIDE. BACK FLOW PREVENTION REQ'D PER LOCAL CODE. CONTRACTOR TO PROVIDE AIR/WATER SEPARATOR IF NOT INCLUDED WITH PUMP. BUCK BOOST TRANSFORMER SUPPLIED AND INSTALLED BY CONTRACTOR (IF REQ'D). FINAL CONNECTIONS BY CONTRACTOR.	•	•							26B
1	28	VACUUM INLET - CONTRACTOR TO PROVIDE A 1/2" PVC BRANCH WITH TERMINATION FITTING FROM MAIN TRUNK LINE. VERIFY HEIGHT AND LOCATION WITH HENRY SCHEIN DENTAL EQUIPMENT SPECIALIST.								•	28
1	30A	WATER SOLENOID W/FILTER - CONTRACTOR TO PROVIDE REQ'D UTILITIES. SOLENOID SUPPLIED BY HENRY SCHEIN DENTAL. INSTALLED BY CONTRACTOR ON COLD WATER SUPPLY LINE TO THE OFFICE.	•								30A

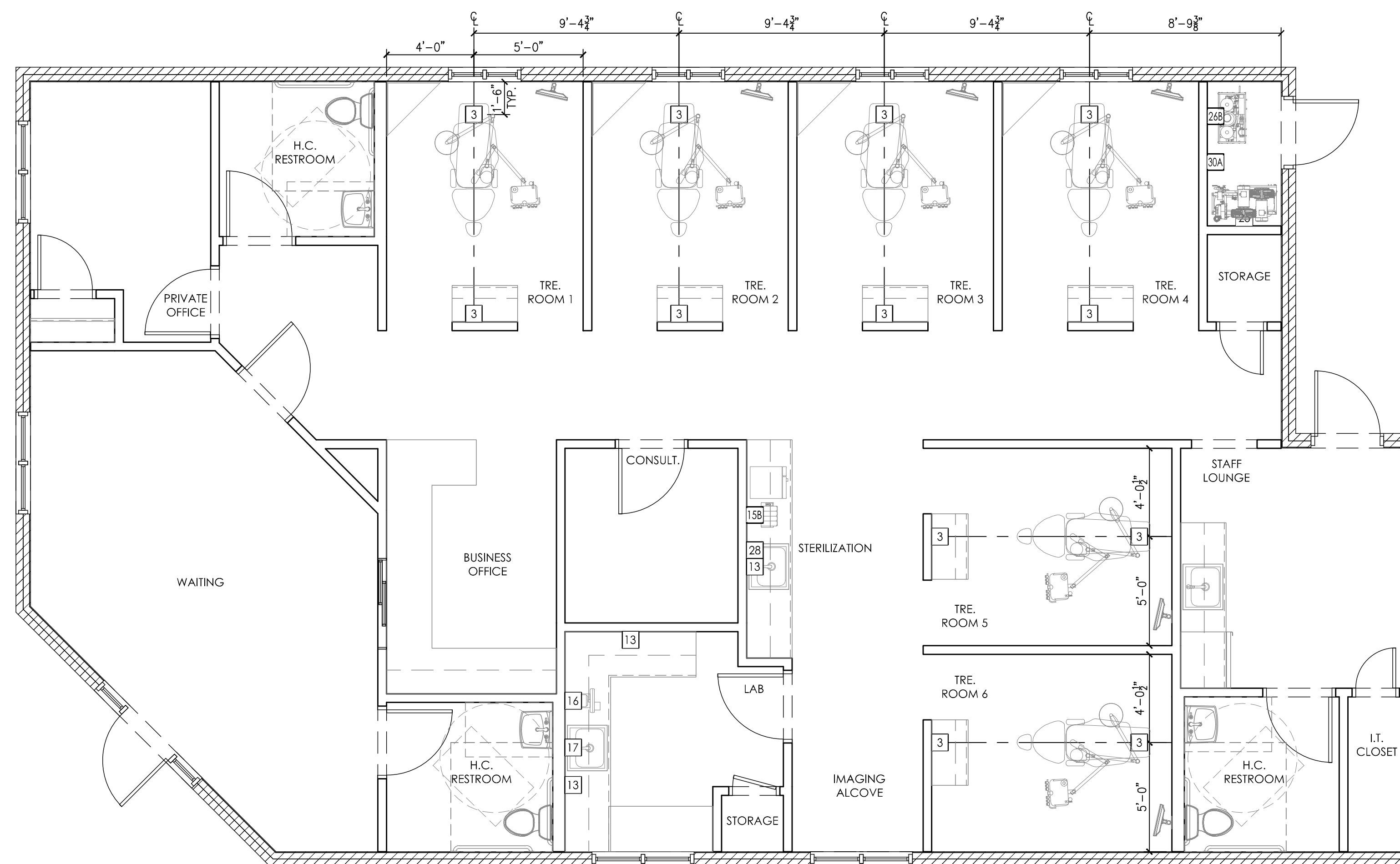

THIS PLAN IS FOR THE SOLE PURPOSE OF SPECIFICATION AND INSTALLATION OF THE DENTAL EQUIPMENT SUPPLIED BY HENRY SCHEIN DENTAL. THE SPACE PLANNING AND CONCEPTUAL DESIGN HAS BEEN PROVIDED BY OTHERS AND THE IDEAS HEREIN ARE NOT NECESSARILY RECOMMENDED BY THE HENRY SCHEIN DENTAL NATIONAL DESIGN GROUP.

## PROPOSED DENTAL PLUMBING SPECIFICATIONS

1/4"=1'-0"

**HENRY SCHEIN®**  
DENTAL  
10920 WEST LINCOLN AVENUE  
WEST ALLIS, WI 53227

PROJECT: **DR. BRITNEY BEARD**

LOCATION: SUIDELL, LA

HENRY SCHEIN REP:  
JAMES KINNEY  
CENTER:  
NEW ORLEANS, LA  
PHONE #:  
(225) 772-0548

**IMPORTANT NOTE:**  
THIS DOCUMENT HAS BEEN PREPARED AS AN INSTRUMENT OF PROFESSIONAL SERVICE, AND IS NOT AN ARCHITECTURAL PLAN. THE IDEAS/ DESIGNS INCLUDED HEREIN ARE THE SOLE PROPERTY OF HENRY SCHEIN DENTAL AND ARE PROTECTED UNDER COPYRIGHT. THEY MAY NOT BE USED OR REPRODUCED WITHOUT EXPRESSED WRITTEN CONSENT OF HENRY SCHEIN AND FULL PAYMENT OF ANY ASSOCIATED DESIGN FEES.  
**ALL DIMENSIONS ARE SUBJECT TO JOB-SITE VERIFICATION.**

DRAWING NAME:  
BEARD-1-F  
PROJECT START DATE:  
08/31/2015  
FINALS START DATE:  
08/31/2015  
DRAWN BY: OTHER  
FINALS BY: AKL  
CHECKED BY: DJW

REVISIONS:  
---  
---  
---  
---  
---  
---  
INT.SQ.FT. = PER ARCH

SCALE: 1/4"=1'-0"  
SHT. SIZE: D

PLUMBING PLAN

SP.1

## ELECTRICAL NOTES

1. THIS SPECIFICATION SHEET IS INTENDED AS A GUIDE FOR TRADESMEN. THE FLOOR PLANS ENCLOSED HEREIN ARE SUGGESTIONS FOR THE PLACEMENT OF DENTAL EQUIPMENT. THEY ARE NOT INTENDED FOR CONSTRUCTION.
2. EXACT EQUIPMENT LOCATIONS MUST BE JOB SITE VERIFIED BY THE HENRY SCHEIN DENTAL EQUIPMENT SPECIALIST.
3. FOLLOW MANUFACTURER'S DRAWINGS FOR EXACT REQUIREMENTS FOR ANY EQUIPMENT SUPPLIED BY HENRY SCHEIN DENTAL. CONSULT WITH HENRY SCHEIN DENTAL REP FOR ADDITIONAL INFORMATION.
4. GFCI PROTECTION OR REDUNDANT GROUND IN DENTAL CHAIR RECEPTACLES, DENTAL UTILITY CABINETS AND ANY OTHER AREAS REQUIRED BY LOCAL CODE IS THE RESPONSIBILITY OF THE ELECTRICAL CONTRACTOR.
5. ADDITIONAL CONVENIENCE OUTLETS REQUIRED ON JOBSITE ARE THE RESPONSIBILITY OF ELECTRICAL CONTRACTORS. FOLLOW LOCAL CODE RESTRICTIONS.
6. ALL COMPUTER NETWORKING AND WORKSTATIONS MUST BE SPECIFIED BY CUSTOMER'S COMPUTER SUPPLIER. IF HENRY SCHEIN WILL BE SUPPLYING THE COMPUTER NETWORKING SYSTEM, SEE SHEET SE.2 FOR THE OFFICE AUTOMATION PLAN.

SEE SHEET SPE.1 FOR ILLUSTRATIONS & DETAILS

**HENRY SCHEIN®**  
DENTAL  
10920 WEST LINCOLN AVENUE  
WEST ALLIS, WI 53227

PROJECT:  
**DR. BRITNEY BEARD**

LOCATION:  
SLIDELL, LA

HENRY SCHEIN REP:  
JAMES KINNEY  
CENTER:  
NEW ORLEANS, LA  
PHONE #:  
(225) 772-0548

**-IMPORTANT NOTE-**  
THIS DOCUMENT HAS BEEN PREPARED AS AN INSTRUMENT OF PROFESSIONAL SERVICE, AND IS NOT AN ARCHITECTURAL PLAN. THE IDEAS/ DESIGNS INCLUDED HEREIN ARE THE SOLE PROPERTY OF HENRY SCHEIN DENTAL AND ARE PROTECTED UNDER COPYRIGHT. THEY MAY NOT BE USED OR REPRODUCED WITHOUT EXPRESSED WRITTEN CONSENT OF HENRY SCHEIN AND FULL PAYMENT OF ANY ASSOCIATED DESIGN FEES.  
**ALL DIMENSIONS ARE SUBJECT TO JOB-SITE VERIFICATION.**

DRAWING NAME:  
BEARD-1-F  
PROJECT START DATE:  
08/31/2015  
FINALS START DATE:  
08/31/2015  
DRAWN BY: OTHER  
FINALS BY: AKL  
CHECKED BY: DJW

REVISIONS:  
---  
---  
---  
---  
---  
---  
INT.SQ.FT. = PER ARCH

SCALE: SHT. SIZE:  
1/4"=1'-0" D  
**ELECTRICAL**  
PLAN

**SE.1**

## ELECTRICAL SPECIFICATIONS

QUANTITY	SPEC. NUMBER	DESCRIPTION	UTILITIES					
			ELECTRICAL (SEE DETAILS FOR REQUIREMENTS)	VOLTAGE & AMPS	DEDICATED CIRCUIT LOW VOLTAGE CONTROL	REMOTE SWITCH	MECHANICAL DETAIL	CONSTRUCTION DETAIL
12	3	UTILITY CENTER - CONTRACTOR TO PROVIDE REQ'D UTILITIES. BACK FLOW PREVENTION REQUIRED AS PER LOCAL CODE.		• 115V, 20A				3
6	4A	2" CONDUIT - PIPE CHASE WITH PULL-STRING SUPPLIED AND INSTALLED BY CONTRACTOR.						6A
1	14	DENTAL CEILING LIGHT - CONTRACTOR TO PROVIDE REQ'D UTILITIES AND MOUNTING SUPPORT. LIGHT SUPPLIED AND INSTALLED BY HENRY SCHEIN DENTAL.		• 115V, 15A				14A
1	14A	STERILIZER (SINGLE CASSETTE) - CONTRACTOR TO PROVIDE REQ'D UTILITIES. STERILIZER SUPPLIED AND INSTALLED BY HENRY SCHEIN DENTAL. VERIFY IF SWITCHED OUTLET IS REQ'D.		• 115V, 20A	•			14A
1	14A	STERILIZER (AUTO-CLAVE) - CONTRACTOR TO PROVIDE REQ'D UTILITIES. STERILIZER SUPPLIED AND INSTALLED BY HENRY SCHEIN DENTAL. VERIFY IF SWITCHED OUTLET IS REQ'D.		• 115V, 20A	•			14A
1	15B	HANDPIECE MAINTENANCE SYSTEM - CONTRACTOR TO PROVIDE REQ'D UTILITIES. 1/2" AIR LINE WITH VALVE STOP (58-145 PSI) ABOVE COUNTERTOP. SYSTEM SUPPLIED AND INSTALLED BY HENRY SCHEIN DENTAL.		• 115V, 15A				15B
1	16	MODEL TRIMMER - CONTRACTOR TO PROVIDE REQ'D UTILITIES. MODEL TRIMMER SUPPLIED AND INSTALLED BY HENRY SCHEIN DENTAL. BACK FLOW PREVENTION REQUIRED PER CODE.		• 115V, 15A				16
1	25	DENTAL AIR COMPRESSOR - FOR GAS-DRIVEN DEVICES IN A LEVEL 3 FACILITY. CONTRACTOR TO PROVIDE REQ'D UTILITIES AND FRESH AIR INTAKE VENT. 1/2" I.D. COPPER TYPE K OR L SUPPLY LINES TO LOCATIONS THAT REQUIRE AIR. BUCK BOOST TRANSFORMER SUPPLIED AND INSTALLED BY CONTRACTOR (IF REQ'D). FINAL CONNECTIONS BY CONTRACTOR. REFER TO NFPA 99, 2005, 5.3.3.5 FOR REGULATIONS & REQUIREMENTS.		• 230V, 30A	• • •			25
1	26B	VACUUM PUMP (WET) - CONTRACTOR TO PROVIDE REQ'D UTILITIES. SCH 40 PVC MAIN TRUNK LINES (WHERE PERMITTED BY CODE). TRUNK, REDUCTION AND BRANCH LINE SIZES PER MFR RECOMMENDATIONS. EXHAUST PUMP TO OUTSIDE. BACK FLOW PREVENTION REQ'D PER LOCAL CODE. CONTRACTOR TO PROVIDE AIR/WATER SEPARATOR IF NOT INCLUDED WITH PUMP. BUCK BOOST TRANSFORMER SUPPLIED AND INSTALLED BY CONTRACTOR (IF REQ'D). FINAL CONNECTIONS BY CONTRACTOR.		• (2) 230V, 20A	• • •			26B
1	30A	WATER SOLENOID W/FILTER - CONTRACTOR TO PROVIDE REQ'D UTILITIES. SOLENOID SUPPLIED BY HENRY SCHEIN DENTAL. INSTALLED BY CONTRACTOR ON COLD WATER SUPPLY LINE TO THE OFFICE.		• 115V, 15A	• •			30A
1	32A	REMOTE PANEL (AIR, WATER, & 2 VAC) - SUPPLIED BY HENRY SCHEIN DENTAL, INSTALLED BY CONTRACTOR 60" A.F.F. CONTRACTOR TO SUPPLY AND INSTALL 24V CONTROL WIRING PER MFR SPECS.			•			32A
6	39A	WALL MOUNTED MONITOR - CONTRACTOR TO PROVIDE REQ'D UTILITIES AND MOUNTING SUPPORT. EXACT LOCATION PER OWNER AND HENRY SCHEIN EQUIPMENT SPECIALIST.		• SEE MFG. SPECS				39A

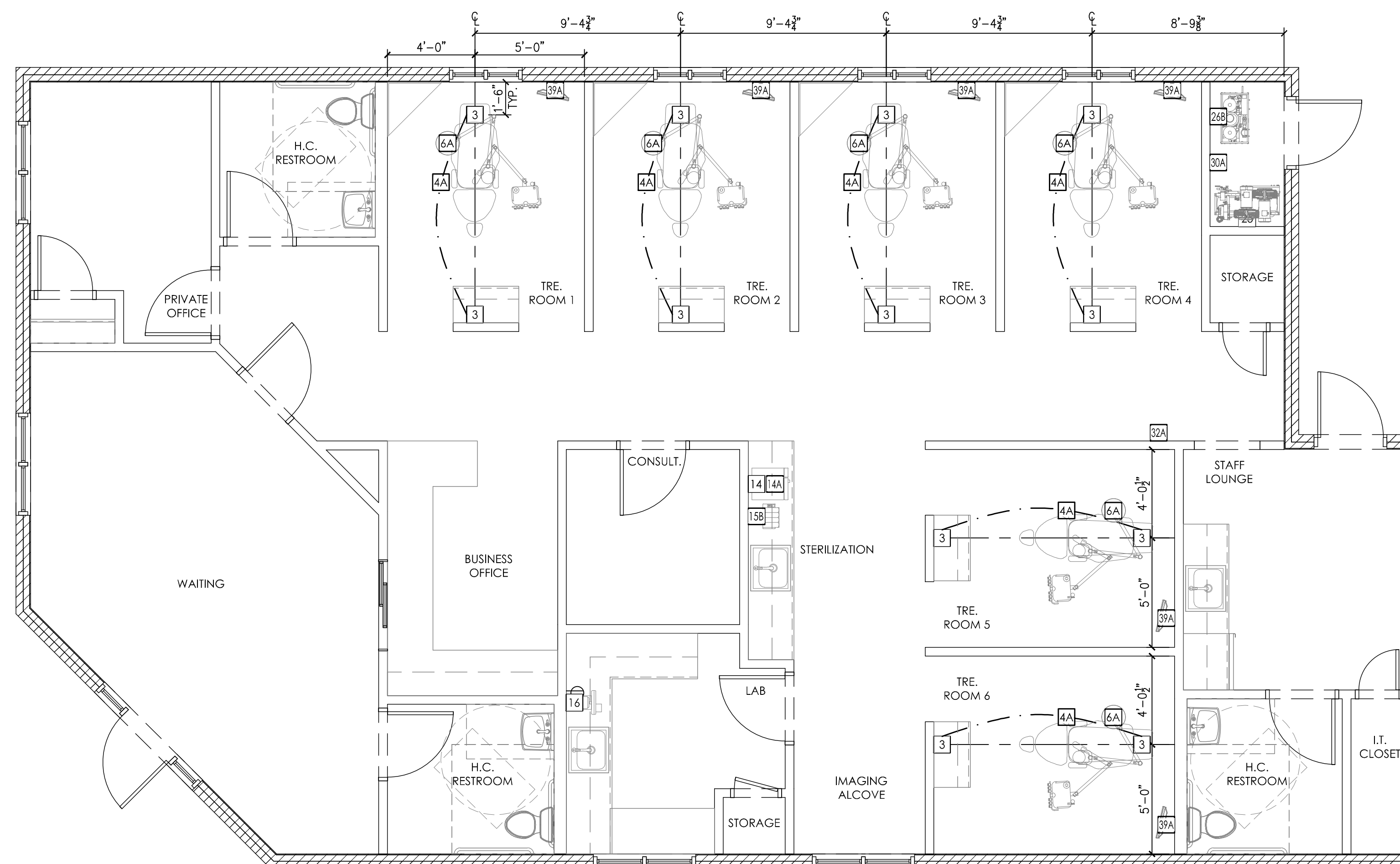

THIS PLAN IS FOR THE SOLE PURPOSE OF SPECIFICATION AND INSTALLATION OF THE DENTAL EQUIPMENT SUPPLIED BY HENRY SCHEIN DENTAL. THE SPACE PLANNING AND CONCEPTUAL DESIGN HAS BEEN PROVIDED BY OTHERS AND THE IDEAS HEREIN ARE NOT NECESSARILY RECOMMENDED BY THE HENRY SCHEIN DENTAL NATIONAL DESIGN GROUP.

## PROPOSED DENTAL ELECTRICAL SPECIFICATIONS

1/4"=1'-0"

