

Date: JUNE 30, 2002
 Drawn By: MC
 Checked By: SI
 Revision:

Project Number: 00015
 This drawing shall remain the property of the drafter and shall not be used for any other project without the written consent of the drafter. The drafter shall not be responsible for any errors or omissions on this drawing.

ROZAS • WARD / a.i.a. architects
 1010 COMMON STREET, SUITE 2750, NEW ORLEANS, LOUISIANA 70112 • (504) 584-4370
 Medical Office Building
 Slidell, Louisiana

As Bm/HS
 4-1-03

JOHN'S ELECTRIC SERVICE, INC.
 2737 BARBOUR STREET
 NEW ORLEANS, LOUISIANA 70119
 (504) 551-4400

E.4R
 Drawing
 4x8 IN.

AHU/CU	CONDUIT & WIRE SIZE	DISCONNECT SWITCH	SOURCE
AHU-1	3#6AG-1" C	60/3 FDS FUSED @ 60	LA-20.22.24
CU-1	3#6AG-1" C	60/3 FUSED @ 40	LA-19.21.23
AHU-2	3#10AG-1" C	60/3 FDS FUSED @ 60	LB-20.22.24
CU-2	3#6AG-1" C	60/3 FUSED @ 40	LB-19.21.23
AHU-3	3#6AG-1" C	60/3 FDS FUSED @ 60	LC-20.22.24
CU-3	3#6AG-1" C	60/3 FUSED @ 40	LC-21.23.25
AHU-4	3#4AG-1 1/4" C	100/3 FDS FUSED @ 80	LD-27.29.31
CU-4	3#6AG-1" C	60/3 FDS FUSED @ 60	LD-28.30.32
AHU-5	3#4AG-1 1/4" C	100/3 FDS FUSED @ 80	LE-27.29.31
CU-5	3#6AG-1" C	60/3 FDS FUSED @ 60	LE-28.30.32

HVAC EQUIPMENT WIRING SCHEDULE

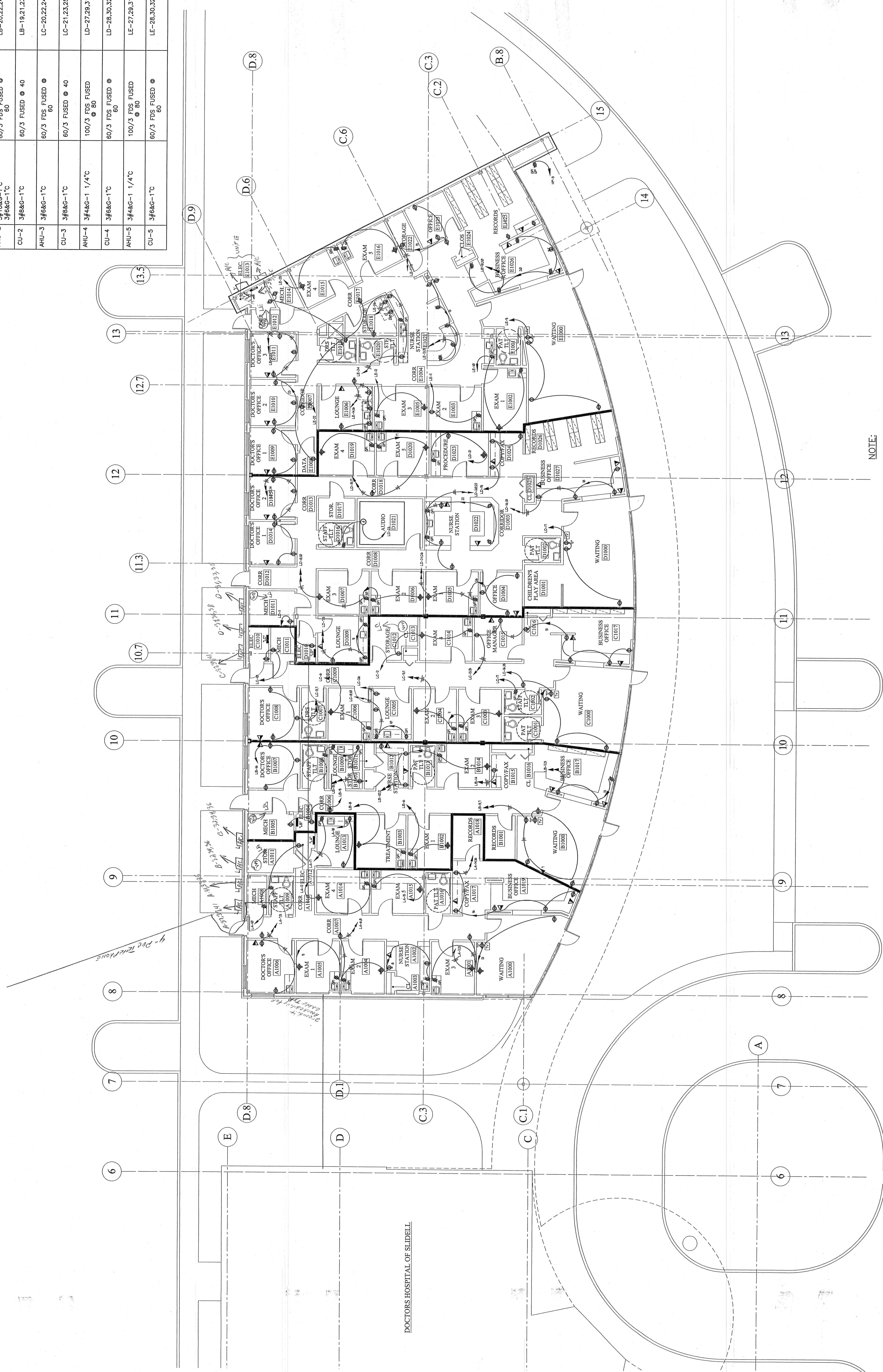

DOCTORS HOSPITAL OF SLIDELL

1 E.4R
 N
 FIRST FLOOR PLAN - POWER
 SCALE: 1/8" = 1'-0"