

PLUMBING EQUIPMENT, METHODS AND MATERIALS PRODUCTS

1. GENERAL:
ALL PRODUCTS USED SHALL COMPLY WITH THE APPLICABLE SECTIONS OF THE LOUISIANA STATE PLUMBING CODE, 2019 EDITION.
CONTRACTOR SHALL SUPPLY ONLY THOSE PRODUCTS APPROVED IN WRITING PRIOR TO PROCUREMENT.

2. WATER DISTRIBUTION PIPING
ALL POTABLE WATER PIPING SHALL BE COPPER TYPE "L" WITH SOLDERED JOINTS FOR 4" OR SMALLER. PROVIDE VALVE STEM EXTENSIONS OF 2" LENGTH FOR ALL VALVES IN INSULATED PIPING.
DELECTRO UNIONS SHALL BE INSTALLED WHEREVER ANY DISSIMILAR METALS ARE USED.
CONTRACTOR SHALL SUPPLY OPTIONAL PROTECTOR FOR PEK OR CPVC FOR WATER DISTRIBUTION PIPING.

3. SANITARY SOLID WASTE AND VENT SYSTEMS
ALL SANITARY DRAIN, WASTE AND VENT PIPING SHALL BE CAST IRON SERVICE WEIGHT. PROVIDE NO-HUB COUPLERS FOR ABOVE GROUND INSTALLATION AND BELL AND SPOUT JOINTS FOR UNDERGROUND INSTALLATION. PROVIDE 2% GRADE (1/4" PER FT) SLOPE FOR ALL GRAVITY WASTE AND VENT.
CONTRACTOR SHALL SUPPLY OPTIONAL PROTECTOR FOR TYPE "DWV" PVC FOR DRAIN, WASTE AND VENT PIPING.

4. SLEEVES AND ESCUTCHEONS
PROVIDE GALVANIZED SHEET METAL SLEEVES FOR ALL PIPE PENETRATIONS AT FLOORS, CEILINGS, AND PARTITIONS. PROVIDE PIPE SLEEVES TWO PIPE SIZES LARGER THAN PIPE AND/OR INSULATION. GALK AND INSTALL ESCUTCHEONS AS SPECIFIED.
PROVIDE INDEL PLATED BRASS ESCUTCHEONS WITH SPRING LOCK S OR SET SCREWS AT CEILING AND WAREHOUSE. DO NOT USE CHROME PLATED FERROUS METAL ESCUTCHEONS.

5. VALVES
VALVES SHALL BE SOLID BRONZE THROUGH 2" AND BRONZE FITTED FOR LARGER SIZES. PROVIDE FULL-PORT BALL VALVES WITH SOLDER CONNECTIONS.
VALVES SHALL BE RATED AT 125 PSI SWP/200 PSI WOG HBQ3. STOCKHOLD, CRANE OR APPROVED EQUIVALENT.

6. ACCESS DOORS
PROVIDE ACCESS TO ALL PARTS REQUIRING SERVICE SUCH AS VALVES, REGULATORS, TRAPS, ETC. WITH ACCESS DOORS OF THE SIZE REQUIRED TO PROPERLY SERVICE THE ITEM, BUT GENERALLY NOT SMALLER THAN 12" X 12". WHERE ACCESS DOORS CANNOT BE PROVIDED FOR STRUCTURAL OR ARCHITECTURAL REASONS, NOTIFY THE ARCHITECT.
ACCESS DOORS IN PAINTED AREAS SHALL BE PRIME COATED WITH FINISH PAINTING AS SPECIFIED IN OTHER DIVISIONS.

7. CLEANOUTS AND COVERS
PROVIDE CLEANOUTS AT THE BASE OF EACH STACK AND AS SHOWN ON THE DRAWINGS. SPACING SHALL NOT BE GREATER THAN 60 FEET APART. PROVIDE A CLEANOUT AT EACH CUMULATIVE CHANGE OF DIRECTION OF THE WASTE LINE OF 135 DEGREES, AND AS REQUIRED TO PROPERLY ROO THE SYSTEM.

8. ROOF FLASHING FOR VENT STACKS
FLASHING SHALL BE LEAD OR NOT LESS THAN FOUR POUNDS PER SQUARE FOOT AND SHALL BE TALL ENOUGH TO TURN INTO THE TOP OF THE VENT PIPE, WHICH SHALL BE 12" ABOVE THE ROOF AND EXTEND OUT FROM THE STACKS AT LEAST 12" ON EACH SIDE.

9. PIPE HANGERS AND SUPPORTS
HANGERS FOR HORIZONTAL PIPES IN BUILDING SHALL BE ADJUSTABLE AND SUPPORTED BY TREATED ROOF EQUIVALENT TO PEE AND BAYON JEER OR #40L. HANGERS ON BARE COPPER LINES SHALL BE COPPER PLATED. INSULATED LINES SHALL BE PROVIDED WITH A 20 GAUGE MANNAN SADDLE 12" LONG FOR PIPES 2" AND SMALLER AND 18" LONG FOR LARGER PIPES.
SUPPORT ALL PIPING BELOW THE BUILDING WITH 3/8" STAINLESS STEEL RODS 4'-FOOT ON CENTER AND AT EACH SIDE OF EACH FITTING. FOR EXISTING CONCRETE SLABS USE TREATED STAINLESS STEEL RODS AND 3/8" CONCRETE DRILL AND SET ANCHORS. TWIST THE RODS AROUND THE PIPING WITH THREE COMPLETE TURNS AROUND THE VERTICAL ROD. PROVIDE 1'-FOOT LONG, 3/8" DIA PVC SADDLES FOR ALL COPPER AND PVC PIPING. THE SADDLES SHALL BE THE SAME DIAMETER AS THE PIPE.

10. UNIONS
UNIONS 2" AND SMALLER SHALL BE GROUND JOINT TYPE.

11. FIXTURES AND EQUIPMENT GENERAL
FURNISH ALL PLUMBING FIXTURES, DRAINS AND EQUIPMENT AS SHOWN ON THE DRAWINGS. IF THE ARCHITECTURAL DRAWINGS DIFFER FROM THE PLUMBING DRAWINGS, THE ARCHITECT SHALL BE NOTIFIED PRIOR TO PURCHASE. FURNISH FIXTURES AND OTHER EQUIPMENT COMPLETE WITH ALL REQUIRED AND NECESSARY TRIM, FITTINGS, AND OTHER DEVICES FOR A COMPLETE FINISHED PRODUCT.
FIXTURES AND EQUIPMENT SHALL HAVE THE MANUFACTURER'S NAME OR TRADEMARK IMPRINTED ON OR ATTACHED BY METALLIC NAME PLATE. ALL FIXTURES AND ALL TRIM SHALL BE BY THE SAME MANUFACTURER UNLESS NOTED OTHERWISE. TRIM MAY BE OF DIFFERENT MANUFACTURER THAN FIXTURES, BUT EQUIVALENT TO THAT SPECIFIED.
ALL EXPOSED TRIM SHALL BE CHROME-PLATED. TOPS OF ALL FLOOR DRAINS SHALL BE CHROME OR NICHEL BRONZE UNLESS OTHERWISE NOTED.

12. PLUMBING FIXTURES
GENERAL: THE CONTRACTOR SHALL FURNISH AND INSTALL ALL PLUMBING FIXTURES WITH ALL ASSOCIATED VALVES, TRIM CONNECTIONS, ETC. SHOWN ON THE CONTRACT DRAWINGS. ALL FIXTURES MUST BE DELIVERED TO THE BUILDING PROPERLY GRADED. ESCUTCHEONS SHALL BE CHROME-PLATED BRASS OR STAINLESS STEEL. TRAPS SHALL BE 1 1/2" GAUGE AND SHALL HAVE A COUNTERSINK CLEANOUT FLUO.

13. EXISTING
ALL WORK SHALL BE DONE IN ACCORDANCE WITH ALL GOVERNING CODES AND ACCORDING TO BEST PRACTICES AND ALL PRODUCTS SHALL BE INSTALLED AS DIRECTED BY THE MANUFACTURER THROUGH THEIR WRITTEN INSTRUCTIONS.

14. DISINFECTANT
DISINFECT NEW WATER PIPING (AND EXISTING WATER PIPING AFFECTED BY THE CONTRACTOR'S OPERATIONS) IN ACCORDANCE WITH ANNUAL CODE. FILL PIPING SYSTEMS WITH SOLUTION CONTAINING A MINIMUM OF 50 PARTS PER MILLION OF AVAILABLE CHLORINE AND ALLOW SOLUTION TO STAND FOR A MINIMUM OF 24 HOURS. FLUSH SOLUTION FROM SYSTEMS WITH CLEAN WATER UNTIL MAXIMUM RESIDUAL CHLORINE CONTENT IS NOT GREATER THAN 0.2 PARTS PER MILLION.

15. EXCAVATION AND BACKFILLING
PERFORM ALL EXCAVATION AND BACKFILLING AS REQUIRED. TRENCHES SHALL BE MADE DEEP ENOUGH FOR PROPER INSTALLATION OF THE PIPE. GRADE THE DITCH BOTTOM FOR PROPER SLOPE AND PROVIDE BELL HOLES TO ALLOW THE FULL BEARING OF THE BARREL. COMPLY WITH ALL HEALTH AND SAFETY REGULATIONS. FLUSH SOLUTION FROM SYSTEMS WITH CLEAN WATER UNTIL MAXIMUM RESIDUAL CHLORINE CONTENT IS NOT GREATER THAN 0.2 PARTS PER MILLION.
EXCAVATE 6" BELOW THE PIPE AND FILL WITH COMPACTED OR WETTED SAND TO PIPE GRADE. NO EXCAVATION SHALL BE UNDER OR NEAR FOOTINGS.

16. CONTRACTOR'S RESPONSIBILITIES
THE CONTRACTOR'S RESPONSIBILITIES INCLUDE, BUT ARE NOT LIMITED TO, THE FOLLOWING:
SETTING FLOOR AND WALL SLEEVES IN PROPER LOCATIONS.
NOTIFYING OTHER TRADES OF LOCATION AND SIZE OF CHANGES, STACKS, CLEANOUTS, ETC., THAT WILL RELATE TO THEIR WORK.
PROVIDING ACCESS TO ALL ITEMS REQUIRING ROUTINE SERVICE.

17. WATER DISTRIBUTION PIPING
EXTEND FROM THE WATER MAIN TO EVERY FITTING OR OUTLET REQUIRING HOT OR COLD WATER. PROVIDE A STOP VALVE AND A DRAIN FOR THE PIPING SYSTEM.
PIPE SIZES SHOWN ON THE DRAWINGS ARE NOMINAL DIAMETER.
EVERY FITTING CONNECTION SHALL BE PROVIDED WITH A STOP VALVE AND AN 1/4" VERTICAL AIR CHAMBER AT THE FITTING CONNECTION. (WATER CLOSETS DO NOT REQUIRE AIR CHAMBERS.)

18. BUILDING SANITARY DRAIN, WASTE AND VENTS
THE SANITARY DRAIN, WASTE AND VENT SYSTEM SHALL BE AS SHOWN ON THE DRAWINGS, AND SHALL INCORPORATE ANY FIELD CHANGES AS REQUIRED TO MEET JOB CONDITIONS. ANY MAJOR CHANGES FROM WHAT IS SHOWN ON THE DRAWINGS SHALL BE SUBMITTED FOR APPROVAL BY THE ARCHITECT.
A FUTURE SHALL WASH THE BOTTOM OF ALL STACKS.
THERE SHALL BE NO HORIZONTAL OFFSET IN VENTS LESS THAN 6" ABOVE THE FLOOR FIN OF THE HIGHEST FIXTURE IN THE GROUP.

19. TESTING
CONTRACTOR SHALL NOTIFY THE ARCHITECT AT LEAST THREE WORKING DAYS BEFORE ANY TESTS ARE CONDUCTED. NO JOISTS OR FITTINGS SHALL BE COVERED UNTIL THEY HAVE BEEN TESTED AND APPROVED. REPEAT TESTS AS NECESSARY UNTIL PROVEN SATISFACTORY.
THE FOLLOWING TEST AS DESCRIBED IN THE LOUISIANA STATE PLUMBING CODE, 2000 EDITION, SECTION 411, SHALL BE CONDUCTED:
SANITARY PIPING SYSTEM
WATER TEST - FILL SYSTEM WITH WATER AND HOLD FOR 45 MINUTES WITHOUT DROP IN WATER LEVEL.
POTABLE WATER SYSTEM
150 PSI (WATER PRESSURE) AND HOLD FOR FOUR HOURS WITH NO ALLOWABLE PRESSURE DROP.
IF PRESSURE HOLDS ONLY, USE 100 PSI AIR PRESSURE AND HOLD FOR 8 HOURS WITHOUT DROP IN PRESSURE BEYOND THAT DICTATED FROM TEMPERATURE CHANGES.
INSTALL PRESSURE GAUGE FOR TEST PROCEDURE, AND LEAVE IN PLACE UNTIL WATER SUPPLY IS RESTORED.

20. SOLDERED PIPE FITTINGS
SOLDERED PIPE FITTINGS SHALL BE MADE USING "DYNALOW" OR SILVER SOLDERING ALLOY.
CLEAN PIPE AND FITTINGS BRIGHT WITH SAND PAPER OR BRASS BRUSH AND APPLY PASTE FLUX. FLUXED PIPE IS NOT ACCEPTABLE AND ASSURE JOINT. APPLY HEAT EQUALLY TO THE PIPE FITTINGS AND APPLY SOLDER TO FILL THE JOINT BY CAPILLARY ACTION. CLEAN JOINT OF EXCESS SOLDER BEFORE IT COOLS. FITTINGS DISCOLORED BY HEAT SHALL BE REMOVED AND THE JOINT REMADE.

21. CAST IRON PIPE FITTINGS
FITTINGS MAY BE NO-HUB, PUSH TYPE, OR LEAD AND OAKUM. INSTALL AS RECOMMENDED BY THE MANUFACTURER USING TOOLS AS RECOMMENDED. CARE SHALL BE TAKEN TO PREVENT SHIFTING OR RETURN OF PIPE.

22. SOLDER TYPE FITTINGS
BRAZE USING J.W. HANNO "DYNALOW" OR SILVER SOLDERING ALLOY.
CLEAN PIPE AND FITTINGS BRIGHT WITH SAND PAPER OR BRASS BRUSH AND APPLY PASTE FLUX. FLUXED PIPE IS NOT ACCEPTABLE AND ASSURE JOINT. APPLY HEAT EQUALLY TO THE PIPE FITTINGS AND APPLY SOLDER TO FILL THE JOINT BY CAPILLARY ACTION. CLEAN JOINT OF EXCESS SOLDER BEFORE IT COOLS. FITTINGS DISCOLORED BY HEAT SHALL BE REMOVED AND THE JOINT REMADE.

23. PIPE SLEEVES
NOTIFY CALLY ALL ANNUAL SPACES BETWEEN PIPES (FOR INSULATION) AND SLEEVES WITH SILICONE TYPE SEALANT.
SLEEVES PASSING THROUGH FLOORS SHALL EXTEND 2" ABOVE THE FLOOR LEVEL TO PREVENT WATER PENETRATION AROUND PIPE. THE SLEEVE SHALL BE SEALED TO THE FLOOR.

24. INSTALLATION OF PIPES
ALL TRENCH PIPING SHALL BE SEALED TO REMOVE ALL CUTTING LIPS FROM THE INSIDE EDGE AND SHALL BE TRENCH WITH CLEAN DIES TO THE PROPER DEPTH. CUTS SHALL BE CLEAN AND NOT BURLED OR ROUGH. APPLY LUBRICANT TO MAKE TRENCH EASY.
ALL CENTER PIPES SHALL BE REMOVED TO REMOVE ALL CUTTING LIPS FROM INSIDE EDGE.
PIPE SHALL BE LAD OR SUPPORTED IN A STRAIGHT AND TRUE MANNER WITH FITTING USED TO MAKE ALL CHANGES IN DIRECTION.
ALL PIPES SHALL BE CUT CLEAN AT PRECISE ANGLE. HAND CUTTING OF PVC PIPE IS NOT ACCEPTABLE.

25. PIPE HANGERS AND SUPPORTS
SUPPORT ALL SUSPENDED PIPE WITH PROPERLY ADJUSTABLE SWIVEL HANGERS WITH MAXIMUM SPACING AS FOLLOWS: TRAC
CAST IRON - ONE HANGER FOR EACH SECTION OF CAST IRON PIPE.
SOLDERED AND SOLDER PIPE - 8'-0" SPACING FOR PIPE 1 1/2" AND SMALLER, AND 10'-0" SPACING FOR 2" AND LARGER.
ALL TRENCH HANGERS SHALL BE USED AS FOLLOWS:
PIPE 2" & SMALLER - 3/8" PIPE 2 1/2" TO 4" - 1/2" PIPE ABOVE 4" - 5/8"

26. INSULATION
INSULATE ALL PIPING SYSTEMS AS FOLLOWS:
HOT WATER PIPING - INSULATE ALL HOT WATER PIPING WITH 1" FIBERGLASS INSULATION WITH ALL SERVICE JACKET.
COLD WATER PIPING - INSULATE ALL COLD WATER PIPING WITH 1" THICK CLOSED CELL FOAM INSULATION OR FIBERGLASS INSULATION WITH ALL SERVICE JACKET.

27. PROTECTION DURING CONSTRUCTION
INSTALL TEST FLUO, WOOD FLUOS OR CAPS IN ALL OPEN PIPES AT TIME OF INSTALLATION AND DO NOT REMOVE UNTIL PIPING IS CONNECTED.
PROTECT ALL FINISHED SURFACES OF FIXTURES AND BRASS FROM ANY DAMAGE. FIXTURES OR BRASS OF ANY TYPE THAT ARE DAMAGED, SCRATCHED OR DISCOLORED SHALL BE REMOVED AND REPLACED AT THE CONTRACTOR'S EXPENSE.

28. PROTECTION DURING CONSTRUCTION
INSTALL TEST FLUO, WOOD FLUOS OR CAPS IN ALL OPEN PIPES AT TIME OF INSTALLATION AND DO NOT REMOVE UNTIL PIPING IS CONNECTED.
PROTECT ALL FINISHED SURFACES OF FIXTURES AND BRASS FROM ANY DAMAGE. FIXTURES OR BRASS OF ANY TYPE THAT ARE DAMAGED, SCRATCHED OR DISCOLORED SHALL BE REMOVED AND REPLACED AT THE CONTRACTOR'S EXPENSE.

29. PROTECTION DURING CONSTRUCTION
INSTALL TEST FLUO, WOOD FLUOS OR CAPS IN ALL OPEN PIPES AT TIME OF INSTALLATION AND DO NOT REMOVE UNTIL PIPING IS CONNECTED.
PROTECT ALL FINISHED SURFACES OF FIXTURES AND BRASS FROM ANY DAMAGE. FIXTURES OR BRASS OF ANY TYPE THAT ARE DAMAGED, SCRATCHED OR DISCOLORED SHALL BE REMOVED AND REPLACED AT THE CONTRACTOR'S EXPENSE.

30. PROTECTION DURING CONSTRUCTION
INSTALL TEST FLUO, WOOD FLUOS OR CAPS IN ALL OPEN PIPES AT TIME OF INSTALLATION AND DO NOT REMOVE UNTIL PIPING IS CONNECTED.
PROTECT ALL FINISHED SURFACES OF FIXTURES AND BRASS FROM ANY DAMAGE. FIXTURES OR BRASS OF ANY TYPE THAT ARE DAMAGED, SCRATCHED OR DISCOLORED SHALL BE REMOVED AND REPLACED AT THE CONTRACTOR'S EXPENSE.

31. PROTECTION DURING CONSTRUCTION
INSTALL TEST FLUO, WOOD FLUOS OR CAPS IN ALL OPEN PIPES AT TIME OF INSTALLATION AND DO NOT REMOVE UNTIL PIPING IS CONNECTED.
PROTECT ALL FINISHED SURFACES OF FIXTURES AND BRASS FROM ANY DAMAGE. FIXTURES OR BRASS OF ANY TYPE THAT ARE DAMAGED, SCRATCHED OR DISCOLORED SHALL BE REMOVED AND REPLACED AT THE CONTRACTOR'S EXPENSE.

32. PROTECTION DURING CONSTRUCTION
INSTALL TEST FLUO, WOOD FLUOS OR CAPS IN ALL OPEN PIPES AT TIME OF INSTALLATION AND DO NOT REMOVE UNTIL PIPING IS CONNECTED.
PROTECT ALL FINISHED SURFACES OF FIXTURES AND BRASS FROM ANY DAMAGE. FIXTURES OR BRASS OF ANY TYPE THAT ARE DAMAGED, SCRATCHED OR DISCOLORED SHALL BE REMOVED AND REPLACED AT THE CONTRACTOR'S EXPENSE.

33. PROTECTION DURING CONSTRUCTION
INSTALL TEST FLUO, WOOD FLUOS OR CAPS IN ALL OPEN PIPES AT TIME OF INSTALLATION AND DO NOT REMOVE UNTIL PIPING IS CONNECTED.
PROTECT ALL FINISHED SURFACES OF FIXTURES AND BRASS FROM ANY DAMAGE. FIXTURES OR BRASS OF ANY TYPE THAT ARE DAMAGED, SCRATCHED OR DISCOLORED SHALL BE REMOVED AND REPLACED AT THE CONTRACTOR'S EXPENSE.

34. PROTECTION DURING CONSTRUCTION
INSTALL TEST FLUO, WOOD FLUOS OR CAPS IN ALL OPEN PIPES AT TIME OF INSTALLATION AND DO NOT REMOVE UNTIL PIPING IS CONNECTED.
PROTECT ALL FINISHED SURFACES OF FIXTURES AND BRASS FROM ANY DAMAGE. FIXTURES OR BRASS OF ANY TYPE THAT ARE DAMAGED, SCRATCHED OR DISCOLORED SHALL BE REMOVED AND REPLACED AT THE CONTRACTOR'S EXPENSE.

35. PROTECTION DURING CONSTRUCTION
INSTALL TEST FLUO, WOOD FLUOS OR CAPS IN ALL OPEN PIPES AT TIME OF INSTALLATION AND DO NOT REMOVE UNTIL PIPING IS CONNECTED.
PROTECT ALL FINISHED SURFACES OF FIXTURES AND BRASS FROM ANY DAMAGE. FIXTURES OR BRASS OF ANY TYPE THAT ARE DAMAGED, SCRATCHED OR DISCOLORED SHALL BE REMOVED AND REPLACED AT THE CONTRACTOR'S EXPENSE.

36. PROTECTION DURING CONSTRUCTION
INSTALL TEST FLUO, WOOD FLUOS OR CAPS IN ALL OPEN PIPES AT TIME OF INSTALLATION AND DO NOT REMOVE UNTIL PIPING IS CONNECTED.
PROTECT ALL FINISHED SURFACES OF FIXTURES AND BRASS FROM ANY DAMAGE. FIXTURES OR BRASS OF ANY TYPE THAT ARE DAMAGED, SCRATCHED OR DISCOLORED SHALL BE REMOVED AND REPLACED AT THE CONTRACTOR'S EXPENSE.

37. PROTECTION DURING CONSTRUCTION
INSTALL TEST FLUO, WOOD FLUOS OR CAPS IN ALL OPEN PIPES AT TIME OF INSTALLATION AND DO NOT REMOVE UNTIL PIPING IS CONNECTED.
PROTECT ALL FINISHED SURFACES OF FIXTURES AND BRASS FROM ANY DAMAGE. FIXTURES OR BRASS OF ANY TYPE THAT ARE DAMAGED, SCRATCHED OR DISCOLORED SHALL BE REMOVED AND REPLACED AT THE CONTRACTOR'S EXPENSE.

38. PROTECTION DURING CONSTRUCTION
INSTALL TEST FLUO, WOOD FLUOS OR CAPS IN ALL OPEN PIPES AT TIME OF INSTALLATION AND DO NOT REMOVE UNTIL PIPING IS CONNECTED.
PROTECT ALL FINISHED SURFACES OF FIXTURES AND BRASS FROM ANY DAMAGE. FIXTURES OR BRASS OF ANY TYPE THAT ARE DAMAGED, SCRATCHED OR DISCOLORED SHALL BE REMOVED AND REPLACED AT THE CONTRACTOR'S EXPENSE.

39. PROTECTION DURING CONSTRUCTION
INSTALL TEST FLUO, WOOD FLUOS OR CAPS IN ALL OPEN PIPES AT TIME OF INSTALLATION AND DO NOT REMOVE UNTIL PIPING IS CONNECTED.
PROTECT ALL FINISHED SURFACES OF FIXTURES AND BRASS FROM ANY DAMAGE. FIXTURES OR BRASS OF ANY TYPE THAT ARE DAMAGED, SCRATCHED OR DISCOLORED SHALL BE REMOVED AND REPLACED AT THE CONTRACTOR'S EXPENSE.

40. PROTECTION DURING CONSTRUCTION
INSTALL TEST FLUO, WOOD FLUOS OR CAPS IN ALL OPEN PIPES AT TIME OF INSTALLATION AND DO NOT REMOVE UNTIL PIPING IS CONNECTED.
PROTECT ALL FINISHED SURFACES OF FIXTURES AND BRASS FROM ANY DAMAGE. FIXTURES OR BRASS OF ANY TYPE THAT ARE DAMAGED, SCRATCHED OR DISCOLORED SHALL BE REMOVED AND REPLACED AT THE CONTRACTOR'S EXPENSE.

41. PROTECTION DURING CONSTRUCTION
INSTALL TEST FLUO, WOOD FLUOS OR CAPS IN ALL OPEN PIPES AT TIME OF INSTALLATION AND DO NOT REMOVE UNTIL PIPING IS CONNECTED.
PROTECT ALL FINISHED SURFACES OF FIXTURES AND BRASS FROM ANY DAMAGE. FIXTURES OR BRASS OF ANY TYPE THAT ARE DAMAGED, SCRATCHED OR DISCOLORED SHALL BE REMOVED AND REPLACED AT THE CONTRACTOR'S EXPENSE.

42. PROTECTION DURING CONSTRUCTION
INSTALL TEST FLUO, WOOD FLUOS OR CAPS IN ALL OPEN PIPES AT TIME OF INSTALLATION AND DO NOT REMOVE UNTIL PIPING IS CONNECTED.
PROTECT ALL FINISHED SURFACES OF FIXTURES AND BRASS FROM ANY DAMAGE. FIXTURES OR BRASS OF ANY TYPE THAT ARE DAMAGED, SCRATCHED OR DISCOLORED SHALL BE REMOVED AND REPLACED AT THE CONTRACTOR'S EXPENSE.

43. PROTECTION DURING CONSTRUCTION
INSTALL TEST FLUO, WOOD FLUOS OR CAPS IN ALL OPEN PIPES AT TIME OF INSTALLATION AND DO NOT REMOVE UNTIL PIPING IS CONNECTED.
PROTECT ALL FINISHED SURFACES OF FIXTURES AND BRASS FROM ANY DAMAGE. FIXTURES OR BRASS OF ANY TYPE THAT ARE DAMAGED, SCRATCHED OR DISCOLORED SHALL BE REMOVED AND REPLACED AT THE CONTRACTOR'S EXPENSE.

44. PROTECTION DURING CONSTRUCTION
INSTALL TEST FLUO, WOOD FLUOS OR CAPS IN ALL OPEN PIPES AT TIME OF INSTALLATION AND DO NOT REMOVE UNTIL PIPING IS CONNECTED.
PROTECT ALL FINISHED SURFACES OF FIXTURES AND BRASS FROM ANY DAMAGE. FIXTURES OR BRASS OF ANY TYPE THAT ARE DAMAGED, SCRATCHED OR DISCOLORED SHALL BE REMOVED AND REPLACED AT THE CONTRACTOR'S EXPENSE.

45. PROTECTION DURING CONSTRUCTION
INSTALL TEST FLUO, WOOD FLUOS OR CAPS IN ALL OPEN PIPES AT TIME OF INSTALLATION AND DO NOT REMOVE UNTIL PIPING IS CONNECTED.
PROTECT ALL FINISHED SURFACES OF FIXTURES AND BRASS FROM ANY DAMAGE. FIXTURES OR BRASS OF ANY TYPE THAT ARE DAMAGED, SCRATCHED OR DISCOLORED SHALL BE REMOVED AND REPLACED AT THE CONTRACTOR'S EXPENSE.

46. PROTECTION DURING CONSTRUCTION
INSTALL TEST FLUO, WOOD FLUOS OR CAPS IN ALL OPEN PIPES AT TIME OF INSTALLATION AND DO NOT REMOVE UNTIL PIPING IS CONNECTED.
PROTECT ALL FINISHED SURFACES OF FIXTURES AND BRASS FROM ANY DAMAGE. FIXTURES OR BRASS OF ANY TYPE THAT ARE DAMAGED, SCRATCHED OR DISCOLORED SHALL BE REMOVED AND REPLACED AT THE CONTRACTOR'S EXPENSE.

47. PROTECTION DURING CONSTRUCTION
INSTALL TEST FLUO, WOOD FLUOS OR CAPS IN ALL OPEN PIPES AT TIME OF INSTALLATION AND DO NOT REMOVE UNTIL PIPING IS CONNECTED.
PROTECT ALL FINISHED SURFACES OF FIXTURES AND BRASS FROM ANY DAMAGE. FIXTURES OR BRASS OF ANY TYPE THAT ARE DAMAGED, SCRATCHED OR DISCOLORED SHALL BE REMOVED AND REPLACED AT THE CONTRACTOR'S EXPENSE.

48. PROTECTION DURING CONSTRUCTION
INSTALL TEST FLUO, WOOD FLUOS OR CAPS IN ALL OPEN PIPES AT TIME OF INSTALLATION AND DO NOT REMOVE UNTIL PIPING IS CONNECTED.
PROTECT ALL FINISHED SURFACES OF FIXTURES AND BRASS FROM ANY DAMAGE. FIXTURES OR BRASS OF ANY TYPE THAT ARE DAMAGED, SCRATCHED OR DISCOLORED SHALL BE REMOVED AND REPLACED AT THE CONTRACTOR'S EXPENSE.

49. PROTECTION DURING CONSTRUCTION
INSTALL TEST FLUO, WOOD FLUOS OR CAPS IN ALL OPEN PIPES AT TIME OF INSTALLATION AND DO NOT REMOVE UNTIL PIPING IS CONNECTED.
PROTECT ALL FINISHED SURFACES OF FIXTURES AND BRASS FROM ANY DAMAGE. FIXTURES OR BRASS OF ANY TYPE THAT ARE DAMAGED, SCRATCHED OR DISCOLORED SHALL BE REMOVED AND REPLACED AT THE CONTRACTOR'S EXPENSE.

50. PROTECTION DURING CONSTRUCTION
INSTALL TEST FLUO, WOOD FLUOS OR CAPS IN ALL OPEN PIPES AT TIME OF INSTALLATION AND DO NOT REMOVE UNTIL PIPING IS CONNECTED.
PROTECT ALL FINISHED SURFACES OF FIXTURES AND BRASS FROM ANY DAMAGE. FIXTURES OR BRASS OF ANY TYPE THAT ARE DAMAGED, SCRATCHED OR DISCOLORED SHALL BE REMOVED AND REPLACED AT THE CONTRACTOR'S EXPENSE.

51. PROTECTION DURING CONSTRUCTION
INSTALL TEST FLUO, WOOD FLUOS OR CAPS IN ALL OPEN PIPES AT TIME OF INSTALLATION AND DO NOT REMOVE UNTIL PIPING IS CONNECTED.
PROTECT ALL FINISHED SURFACES OF FIXTURES AND BRASS FROM ANY DAMAGE. FIXTURES OR BRASS OF ANY TYPE THAT ARE DAMAGED, SCRATCHED OR DISCOLORED SHALL BE REMOVED AND REPLACED AT THE CONTRACTOR'S EXPENSE.

52. PROTECTION DURING CONSTRUCTION
INSTALL TEST FLUO, WOOD FLUOS OR CAPS IN ALL OPEN PIPES AT TIME OF INSTALLATION AND DO NOT REMOVE UNTIL PIPING IS CONNECTED.
PROTECT ALL FINISHED SURFACES OF FIXTURES AND BRASS FROM ANY DAMAGE. FIXTURES OR BRASS OF ANY TYPE THAT ARE DAMAGED, SCRATCHED OR DISCOLORED SHALL BE REMOVED AND REPLACED AT THE CONTRACTOR'S EXPENSE.

53. PROTECTION DURING CONSTRUCTION
INSTALL TEST FLUO, WOOD FLUOS OR CAPS IN ALL OPEN PIPES AT TIME OF INSTALLATION AND DO NOT REMOVE UNTIL PIPING IS CONNECTED.
PROTECT ALL FINISHED SURFACES OF FIXTURES AND BRASS FROM ANY DAMAGE. FIXTURES OR BRASS OF ANY TYPE THAT ARE DAMAGED, SCRATCHED OR DISCOLORED SHALL BE REMOVED AND REPLACED AT THE CONTRACTOR'S EXPENSE.

54. PROTECTION DURING CONSTRUCTION
INSTALL TEST FLUO, WOOD FLUOS OR CAPS IN ALL OPEN PIPES AT TIME OF INSTALLATION AND DO NOT REMOVE UNTIL PIPING IS CONNECTED.
PROTECT ALL FINISHED SURFACES OF FIXTURES AND BRASS FROM ANY DAMAGE. FIXTURES OR BRASS OF ANY TYPE THAT ARE DAMAGED, SCRATCHED OR DISCOLORED SHALL BE REMOVED AND REPLACED AT THE CONTRACTOR'S EXPENSE.

55. PROTECTION DURING CONSTRUCTION
INSTALL TEST FLUO, WOOD FLUOS OR CAPS IN ALL OPEN PIPES AT TIME OF INSTALLATION AND DO NOT REMOVE UNTIL PIPING IS CONNECTED.
PROTECT ALL FINISHED SURFACES OF FIXTURES AND BRASS FROM ANY DAMAGE. FIXTURES OR BRASS OF ANY TYPE THAT ARE DAMAGED, SCRATCHED OR DISCOLORED SHALL BE REMOVED AND REPLACED AT THE CONTRACTOR'S EXPENSE.

56. PROTECTION DURING CONSTRUCTION
INSTALL TEST FLUO, WOOD FLUOS OR CAPS IN ALL OPEN PIPES AT TIME OF INSTALLATION AND DO NOT REMOVE UNTIL PIPING IS CONNECTED.
PROTECT ALL FINISHED SURFACES OF FIXTURES AND BRASS FROM ANY DAMAGE. FIXTURES OR BRASS OF ANY TYPE THAT ARE DAMAGED, SCRATCHED OR DISCOLORED SHALL BE REMOVED AND REPLACED AT THE CONTRACTOR'S EXPENSE.

57. PROTECTION DURING CONSTRUCTION
INSTALL TEST FLUO, WOOD FLUOS OR CAPS IN ALL OPEN PIPES AT TIME OF INSTALLATION AND DO NOT REMOVE UNTIL PIPING IS CONNECTED.
PROTECT ALL FINISHED SURFACES OF FIXTURES AND BRASS FROM ANY DAMAGE. FIXTURES OR BRASS OF ANY TYPE THAT ARE DAMAGED, SCRATCHED OR DISCOLORED SHALL BE REMOVED AND REPLACED AT THE CONTRACTOR'S EXPENSE.

58. PROTECTION DURING CONSTRUCTION
INSTALL TEST FLUO, WOOD FLUOS OR CAPS IN ALL OPEN PIPES AT TIME OF INSTALLATION AND DO NOT REMOVE UNTIL PIPING IS CONNECTED.
PROTECT ALL FINISHED SURFACES OF FIXTURES AND BRASS FROM ANY DAMAGE. FIXTURES OR BRASS OF ANY TYPE THAT ARE DAMAGED, SCRATCHED OR DISCOLORED SHALL BE REMOVED AND REPLACED AT THE CONTRACTOR'S EXPENSE.

59. PROTECTION DURING CONSTRUCTION
INSTALL TEST FLUO, WOOD FLUOS OR CAPS IN ALL OPEN PIPES AT TIME OF INSTALLATION AND DO NOT REMOVE UNTIL PIPING IS CONNECTED.
PROTECT ALL FINISHED SURFACES OF FIXTURES AND BRASS FROM ANY DAMAGE. FIXTURES OR BRASS OF ANY TYPE THAT ARE DAMAGED, SCRATCHED OR DISCOLORED SHALL BE REMOVED AND REPLACED AT THE CONTRACTOR'S EXPENSE.

60. PROTECTION DURING CONSTRUCTION
INSTALL TEST FLUO, WOOD FLUOS OR CAPS IN ALL OPEN PIPES AT TIME OF INSTALLATION AND DO NOT REMOVE UNTIL PIPING IS CONNECTED.
PROTECT ALL FINISHED SURFACES OF FIXTURES AND BRASS FROM ANY DAMAGE. FIXTURES OR BRASS OF ANY TYPE THAT ARE DAMAGED, SCRATCHED OR DISCOLORED SHALL BE REMOVED AND REPLACED AT THE CONTRACTOR'S EXPENSE.

61. PROTECTION DURING CONSTRUCTION
INSTALL TEST FLUO, WOOD FLUOS OR CAPS IN ALL OPEN PIPES AT TIME OF INSTALLATION AND DO NOT REMOVE UNTIL PIPING IS CONNECTED.
PROTECT ALL FINISHED SURFACES OF FIXTURES AND BRASS FROM ANY DAMAGE. FIXTURES OR BRASS OF ANY TYPE THAT ARE DAMAGED, SCRATCHED OR DISCOLORED SHALL BE REMOVED AND REPLACED AT THE CONTRACTOR'S EXPENSE.

62. PROTECTION DURING CONSTRUCTION
INSTALL TEST FLUO, WOOD FLUOS OR CAPS IN ALL OPEN PIPES AT TIME OF INSTALLATION AND DO NOT REMOVE UNTIL PIPING IS CONNECTED.
PROTECT ALL FINISHED SURFACES OF FIXTURES AND BRASS FROM ANY DAMAGE. FIXTURES OR BRASS OF ANY TYPE THAT ARE DAMAGED, SCRATCHED OR DISCOLORED SHALL BE REMOVED AND REPLACED AT THE CONTRACTOR'S EXPENSE.

63. PROTECTION DURING CONSTRUCTION
INSTALL TEST FLUO, WOOD FLUOS OR CAPS IN ALL OPEN PIPES AT TIME OF INSTALLATION AND DO NOT REMOVE UNTIL PIPING IS CONNECTED.
PROTECT ALL FINISHED SURFACES OF FIXTURES AND BRASS FROM ANY DAMAGE. FIXTURES OR BRASS OF ANY TYPE THAT ARE DAMAGED, SCRATCHED OR DISCOLORED SHALL BE REMOVED AND REPLACED AT THE CONTRACTOR'S EXPENSE.

64. PROTECTION DURING CONSTRUCTION
INSTALL TEST FLUO, WOOD FLUOS OR CAPS IN ALL OPEN PIPES AT TIME OF INSTALLATION AND DO NOT REMOVE UNTIL PIPING IS CONNECTED.
PROTECT ALL FINISHED SURFACES OF FIXTURES AND BRASS FROM ANY DAMAGE. FIXTURES OR BRASS OF ANY TYPE THAT ARE DAMAGED, SCRATCHED OR DISCOLORED SHALL BE REMOVED AND REPLACED AT THE CONTRACTOR'S EXPENSE.

65. PROTECTION DURING CONSTRUCTION
INSTALL TEST FLUO, WOOD FLUOS OR CAPS IN ALL OPEN PIPES AT TIME OF INSTALLATION AND DO NOT REMOVE UNTIL PIPING IS CONNECTED.
PROTECT ALL FINISHED SURFACES OF FIXTURES AND BRASS FROM ANY DAMAGE. FIXTURES OR BRASS OF ANY TYPE THAT ARE DAMAGED, SCRATCHED OR DISCOLORED SHALL BE REMOVED AND REPLACED AT THE CONTRACTOR'S EXPENSE.

66. PROTECTION DURING CONSTRUCTION
INSTALL TEST FLUO, WOOD FLUOS OR CAPS IN ALL OPEN PIPES AT TIME OF INSTALLATION AND DO NOT REMOVE UNTIL PIPING IS CONNECTED.
PROTECT ALL FINISHED SURFACES OF FIXTURES AND BRASS FROM ANY DAMAGE. FIXTURES OR BRASS OF ANY TYPE THAT ARE DAMAGED, SCRATCHED OR DISCOLORED SHALL BE REMOVED AND REPLACED AT THE CONTRACTOR'S EXPENSE.

67. PROTECTION DURING CONSTRUCTION
INSTALL TEST FLUO, WOOD FLUOS OR CAPS IN ALL OPEN PIPES AT TIME OF INSTALLATION AND DO NOT REMOVE UNTIL PIPING IS CONNECTED.
PROTECT ALL FINISHED SURFACES OF FIXTURES AND BRASS FROM ANY DAMAGE. FIXTURES OR BRASS OF ANY TYPE THAT ARE DAMAGED, SCRATCHED OR DISCOLORED SHALL BE REMOVED AND REPLACED AT THE CONTRACTOR'S EXPENSE.

68. PROTECTION DURING CONSTRUCTION
INSTALL TEST FLUO, WOOD FLUOS OR CAPS IN ALL OPEN PIPES AT TIME OF INSTALLATION AND DO NOT REMOVE UNTIL PIPING IS CONNECTED.
PROTECT ALL FINISHED SURFACES OF FIXTURES AND BRASS FROM ANY DAMAGE. FIXTURES OR BRASS OF ANY TYPE THAT ARE DAMAGED, SCRATCHED OR DISCOLORED SHALL BE REMOVED AND REPLACED AT THE CONTRACTOR'S EXPENSE.

69. PROTECTION DURING CONSTRUCTION
INSTALL TEST FLUO, WOOD FLUOS OR CAPS IN ALL OPEN PIPES AT TIME OF INSTALLATION AND DO NOT REMOVE UNTIL PIPING IS CONNECTED.
PROTECT ALL FINISHED SURFACES OF FIXTURES AND BRASS FROM ANY DAMAGE. FIXTURES OR BRASS OF ANY TYPE THAT ARE DAMAGED, SCRATCHED OR DISCOLORED SHALL BE REMOVED AND REPLACED AT THE CONTRACTOR'S EXPENSE.

70. PROTECTION DURING CONSTRUCTION
INSTALL TEST FLUO, WOOD FLUOS OR CAPS IN ALL OPEN PIPES AT TIME OF INSTALLATION AND DO NOT REMOVE UNTIL PIPING IS CONNECTED.
PROTECT ALL FINISHED SURFACES OF FIXTURES AND BRASS FROM ANY DAMAGE. FIXTURES OR BRASS OF ANY TYPE THAT ARE DAMAGED, SCRATCHED OR DISCOLORED SHALL BE REMOVED AND REPLACED AT THE CONTRACTOR'S EXPENSE.

71. PROTECTION DURING CONSTRUCTION
INSTALL TEST FLUO, WOOD FLUOS OR CAPS IN ALL OPEN PIPES AT TIME OF INSTALLATION AND DO NOT REMOVE UNTIL PIPING IS CONNECTED.
PROTECT ALL FINISHED SURFACES OF FIXTURES AND BRASS FROM ANY DAMAGE. FIXTURES OR BRASS OF ANY TYPE THAT ARE DAMAGED, SCRATCHED OR DISCOLORED SHALL BE REMOVED AND REPLACED AT THE CONTRACTOR'S EXPENSE.

72. PROTECTION DURING CONSTRUCTION
INSTALL TEST FLUO, WOOD FLUOS OR CAPS IN ALL OPEN PIPES AT TIME OF INSTALLATION AND DO NOT REMOVE UNTIL PIPING IS CONNECTED.
PROTECT ALL FINISHED SURFACES OF FIXTURES AND BRASS FROM ANY DAMAGE. FIXTURES OR BRASS OF ANY TYPE THAT ARE DAMAGED, SCRATCHED OR DISCOLORED SHALL BE REMOVED AND REPLACED AT THE CONTRACTOR'S EXPENSE.

73. PROTECTION DURING CONSTRUCTION
INSTALL TEST FLUO, WOOD FLUOS OR CAPS IN ALL OPEN PIPES AT TIME OF INSTALLATION AND DO NOT REMOVE UNTIL PIPING IS CONNECTED.
PROTECT ALL FINISHED SURFACES OF FIXTURES AND BRASS FROM ANY DAMAGE. FIXTURES OR BRASS OF ANY TYPE THAT ARE DAMAGED, SCRATCHED OR DISCOLORED SHALL BE REMOVED AND REPLACED AT THE CONTRACTOR'S EXPENSE.

74. PROTECTION DURING CONSTRUCTION
INSTALL TEST FLUO, WOOD FLUOS OR CAPS IN ALL OPEN PIPES AT TIME OF INSTALLATION AND DO NOT REMOVE UNTIL PIPING IS CONNECTED.
PROTECT ALL FINISHED SURFACES OF FIXTURES AND BRASS FROM ANY DAMAGE. FIXTURES OR BRASS OF ANY TYPE THAT ARE DAMAGED, SCRATCHED OR DISCOLORED SHALL BE REMOVED AND REPLACED AT THE CONTRACTOR'S EXPENSE.

75. PROTECTION DURING CONSTRUCTION
INSTALL TEST FLUO, WOOD FLUOS OR CAPS IN ALL OPEN PIPES AT TIME OF INSTALLATION AND DO NOT REMOVE UNTIL PIPING IS CONNECTED.
PROTECT ALL FINISHED SURFACES OF FIXTURES AND BRASS FROM ANY DAMAGE. FIXTURES OR BRASS OF ANY TYPE THAT ARE DAMAGED, SCRATCHED OR DISCOLORED SHALL BE REMOVED AND REPLACED AT THE CONTRACTOR'S EXPENSE.

76. PROTECTION DURING CONSTRUCTION
INSTALL TEST FLUO, WOOD FLUOS OR CAPS IN ALL OPEN PIPES AT TIME OF INSTALLATION AND DO NOT REMOVE UNTIL PIPING IS CONNECTED.
PROTECT ALL FINISHED SURFACES OF FIXTURES AND BRASS FROM ANY DAMAGE. FIXTURES OR BRASS OF ANY TYPE THAT ARE DAMAGED, SCRATCHED OR DISCOLORED SHALL BE REMOVED AND REPLACED AT THE CONTRACTOR'S EXPENSE.

77. PROTECTION DURING CONSTRUCTION
INSTALL TEST FLUO, WOOD FLUOS OR CAPS IN ALL OPEN PIPES AT TIME OF INSTALLATION AND DO NOT REMOVE UNTIL PIPING IS CONNECTED.
PROTECT ALL FINISHED SURFACES OF FIXTURES AND BRASS FROM ANY DAMAGE. FIXTURES OR BRASS OF ANY TYPE THAT ARE DAMAGED, SCRATCHED OR DISCOLORED SHALL BE REMOVED AND REPLACED AT THE CONTRACTOR'S EXPENSE.

78. PROTECTION DURING CONSTRUCTION
INSTALL TEST FLUO, WOOD FLUOS OR CAPS IN ALL OPEN PIPES AT TIME OF INSTALLATION AND DO NOT REMOVE UNTIL PIPING IS CONNECTED.
PROTECT ALL FINISHED SURFACES OF FIXTURES AND BRASS FROM ANY DAMAGE. FIXTURES OR BRASS OF ANY TYPE THAT ARE DAMAGED, SCRATCHED OR DISCOLORED SHALL BE REMOVED AND REPLACED AT THE CONTRACTOR'S EXPENSE.

79. PROTECTION DURING CONSTRUCTION
INSTALL TEST FLUO, WOOD FLUOS OR CAPS IN ALL OPEN PIPES AT TIME OF INSTALLATION AND DO NOT REMOVE UNTIL PIPING IS CONNECTED.
PROTECT ALL FINISHED SURFACES OF FIXTURES AND BRASS FROM ANY DAMAGE. FIXTURES OR BRASS OF ANY TYPE THAT ARE DAMAGED, SCRATCHED OR DISCOLORED SHALL BE REMOVED AND REPLACED AT THE CONTRACTOR'S EXPENSE.

80. PROTECTION DURING CONSTRUCTION
INSTALL TEST FLUO, WOOD FLUOS OR CAPS IN ALL OPEN PIPES AT TIME OF INSTALLATION AND DO NOT REMOVE UNTIL PIPING IS CONNECTED.
PROTECT ALL FINISHED SURFACES OF FIXTURES AND BRASS FROM ANY DAMAGE. FIXTURES OR BRASS OF ANY TYPE THAT ARE DAMAGED, SCRATCHED OR DISCOLORED SHALL BE REMOVED AND REPLACED AT THE CONTRACTOR'S EXPENSE.

81. PROTECTION DURING CONSTRUCTION
INSTALL TEST FLUO, WOOD FLUOS OR CAPS IN ALL OPEN PIPES AT TIME OF INSTALLATION AND DO NOT REMOVE UNTIL PIPING IS CONNECTED.
PROTECT ALL FINISHED SURFACES OF FIXTURES AND BRASS FROM ANY DAMAGE. FIXTURES OR BRASS OF ANY TYPE THAT ARE DAMAGED, SCRATCHED OR DISCOLORED SHALL BE REMOVED AND REPLACED AT THE CONTRACTOR'S EXPENSE.

82. PROTECTION DURING CONSTRUCTION
INSTALL TEST FLUO, WOOD FLUOS OR CAPS IN ALL OPEN PIPES AT TIME OF INSTALLATION AND DO NOT REMOVE UNTIL PIPING IS CONNECTED.
PROTECT ALL FINISHED SURFACES OF FIXTURES AND BRASS FROM ANY DAMAGE. FIXTURES OR BRASS OF ANY TYPE THAT ARE DAMAGED, SCRATCHED OR DISCOLORED SHALL BE REMOVED AND REPLACED AT THE CONTRACTOR'S EXPENSE.

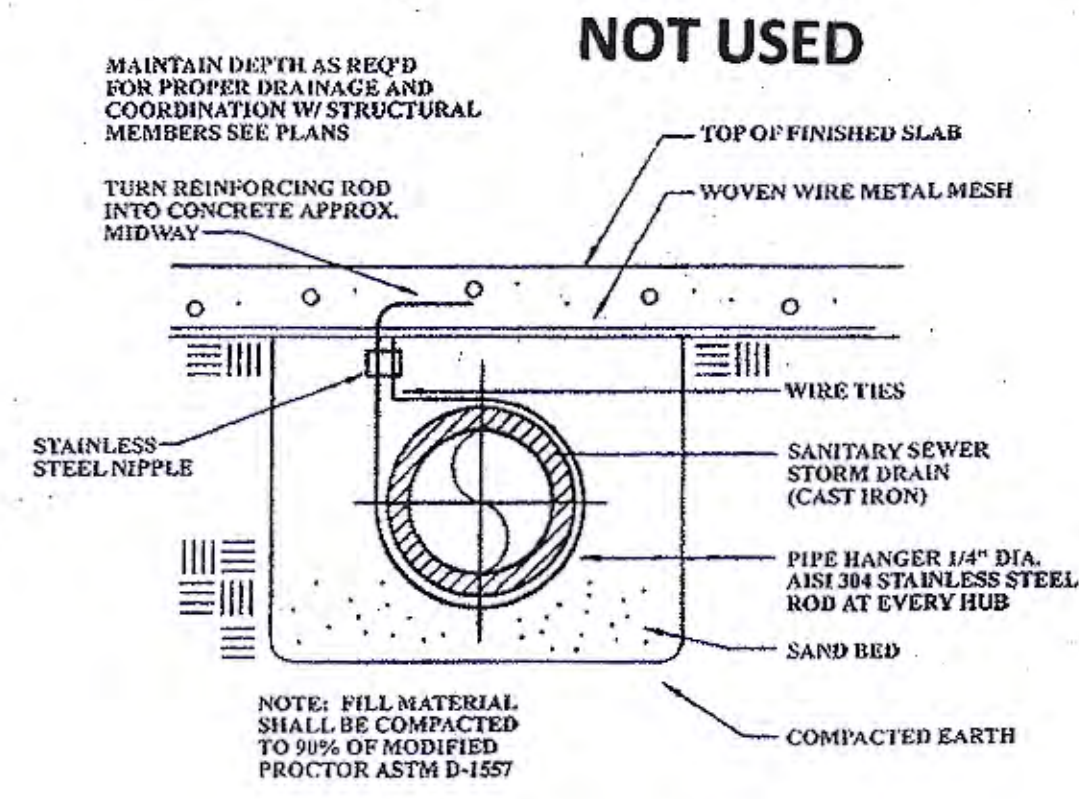

SEWER LINE SUPPORT DETAIL

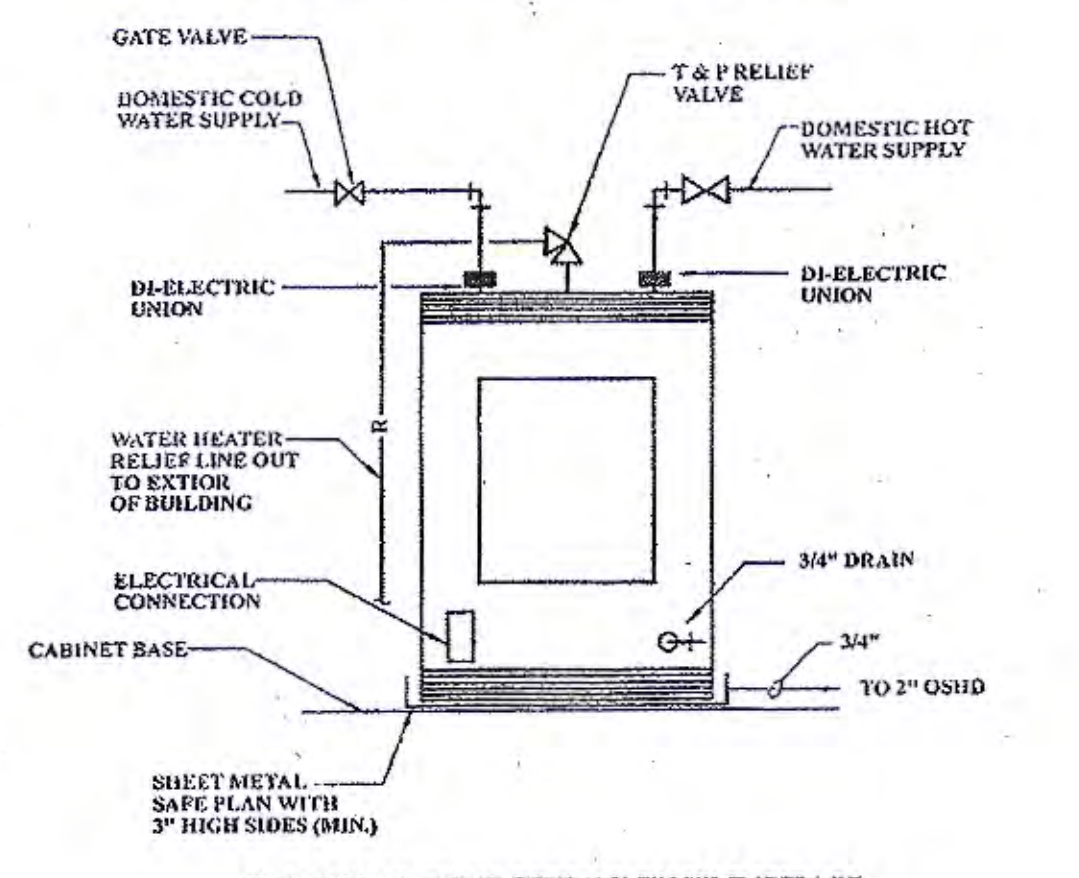

TYPICAL ELECTRIC W/H DETAIL

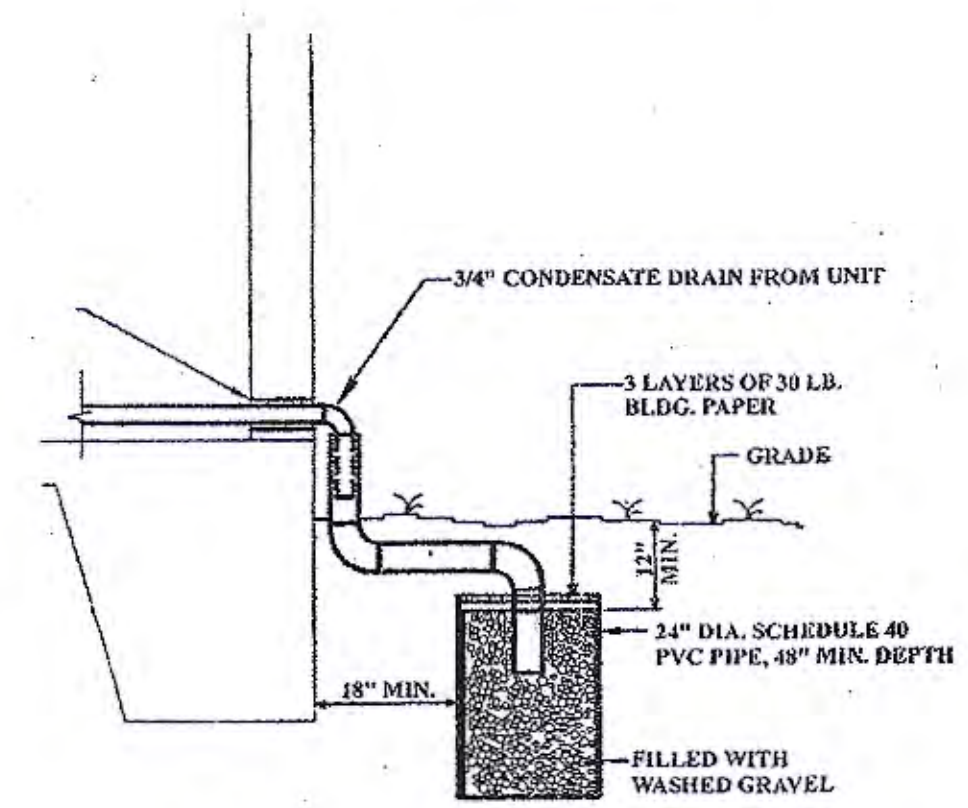

CONDENSATE SHELL DRAIN DETAIL

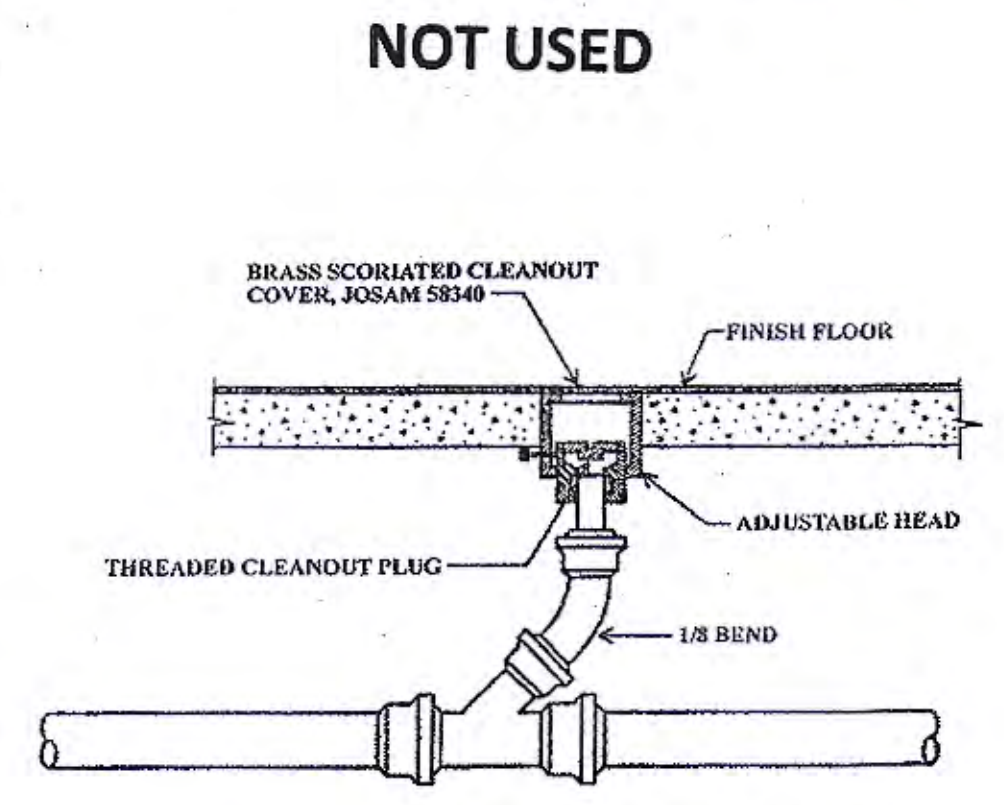

FINISH FLOOR CLEANOUT DETAIL

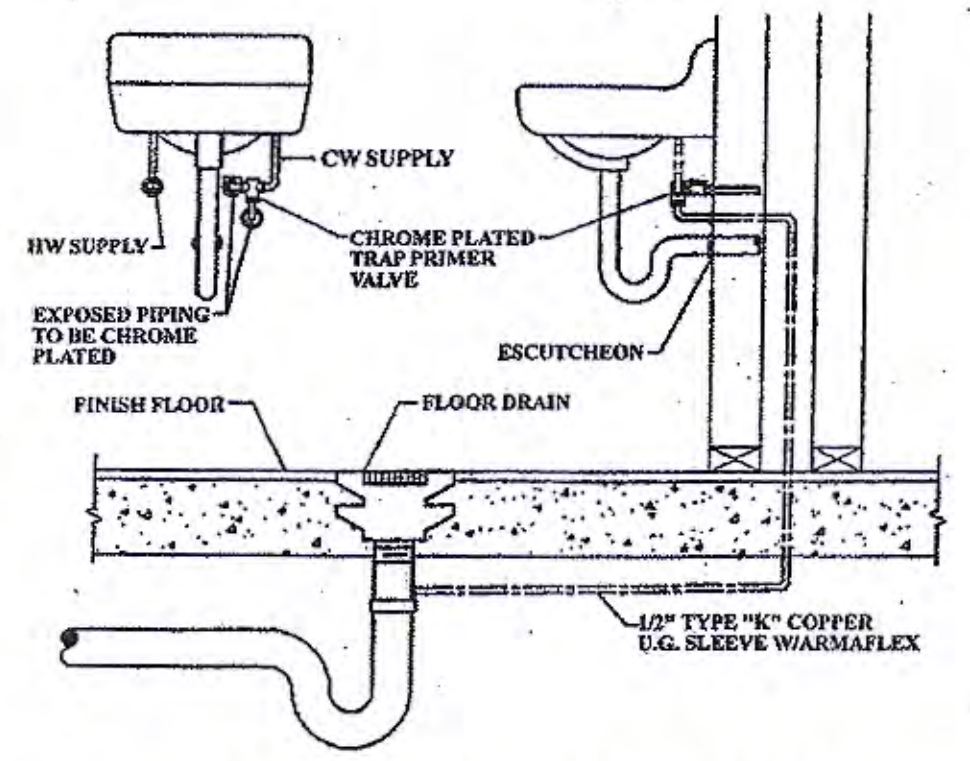

TRAP PRIMER INSTALLATION DETAIL

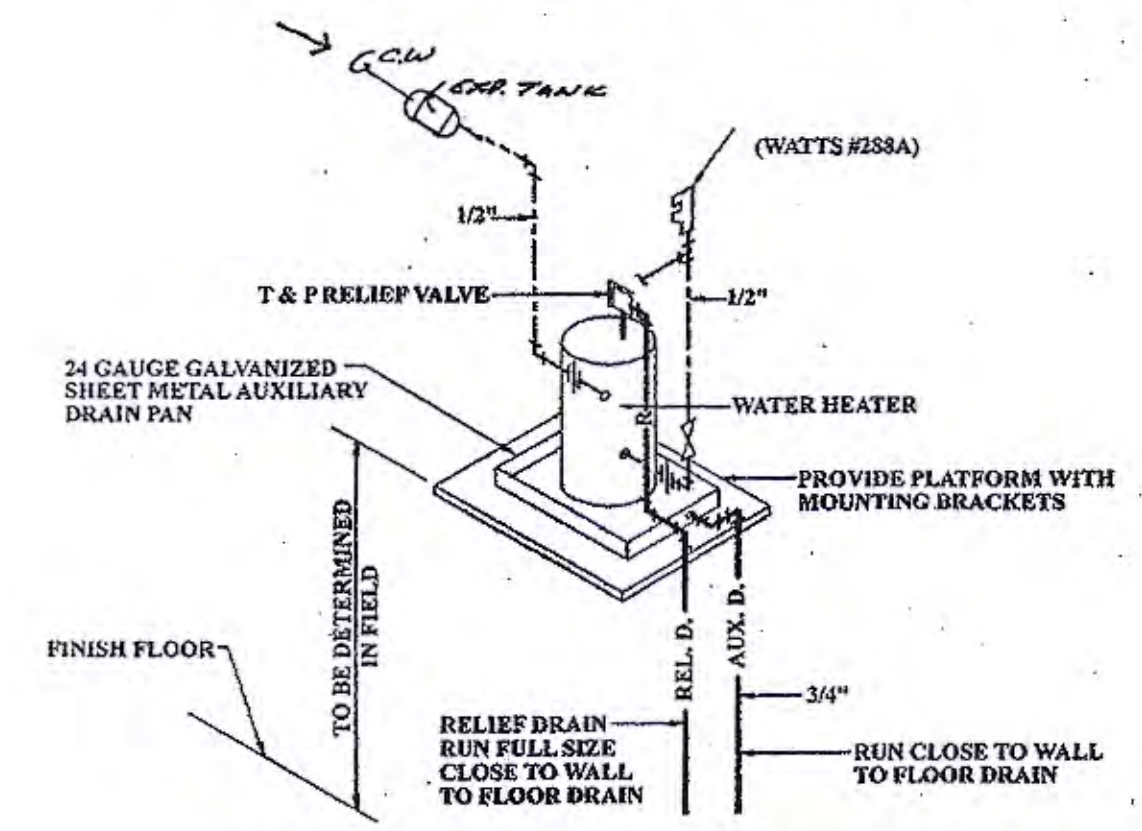

SHELF MOUNTED WATER HEATER DETAIL

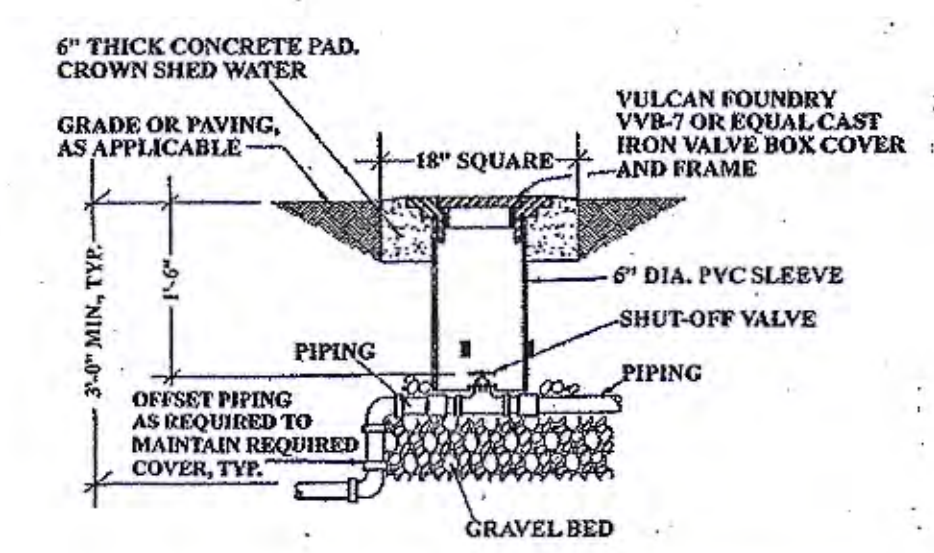

DOMESTIC CW VALVE BOX DETAIL

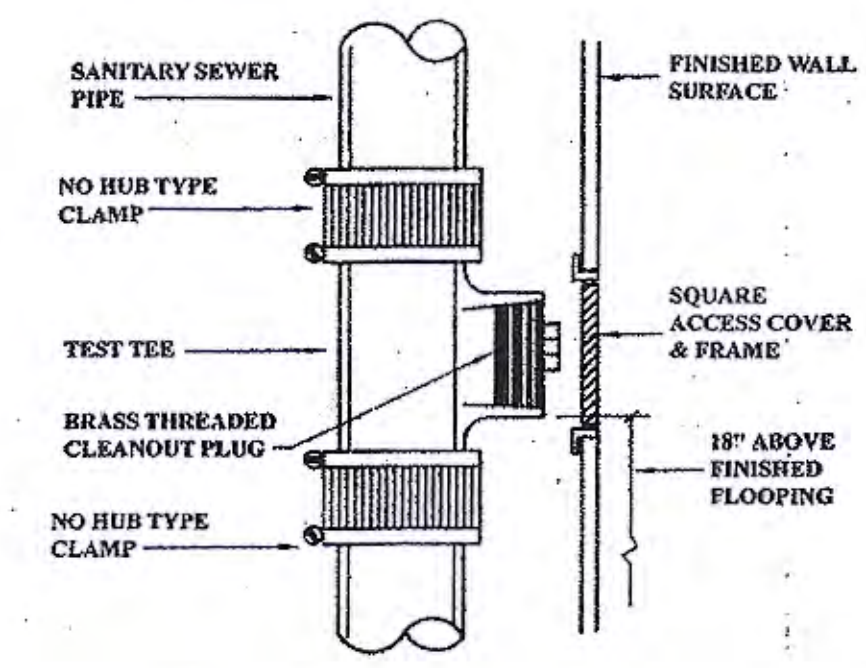

WALL CLEANOUT DETAIL

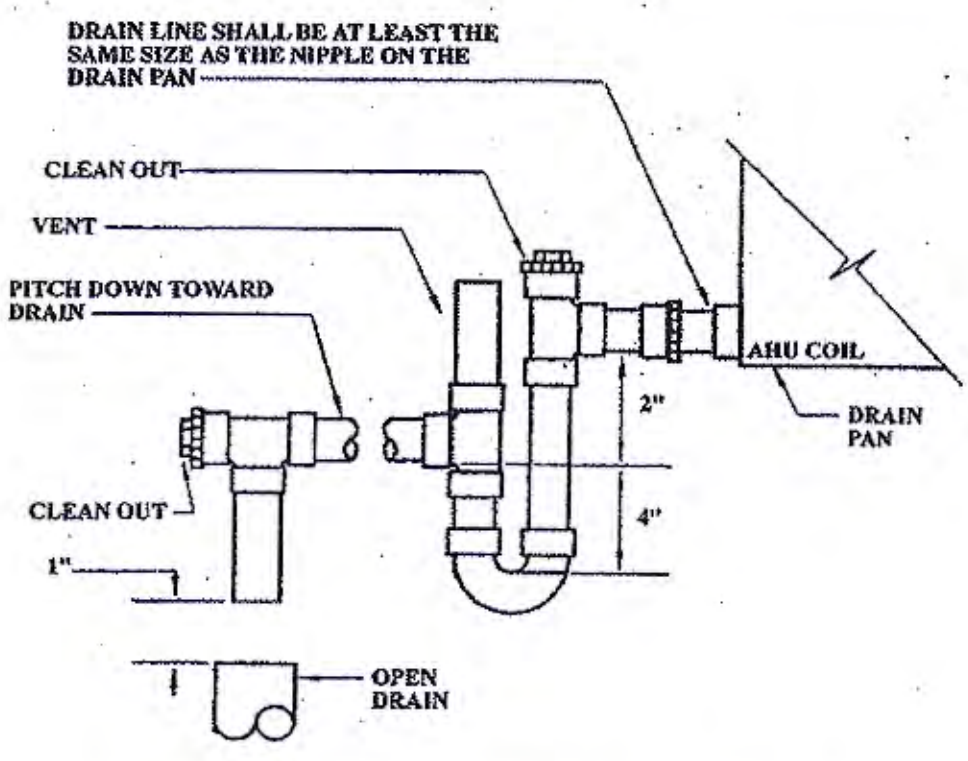

AIR HANDLING UNIT DRAIN TRAP

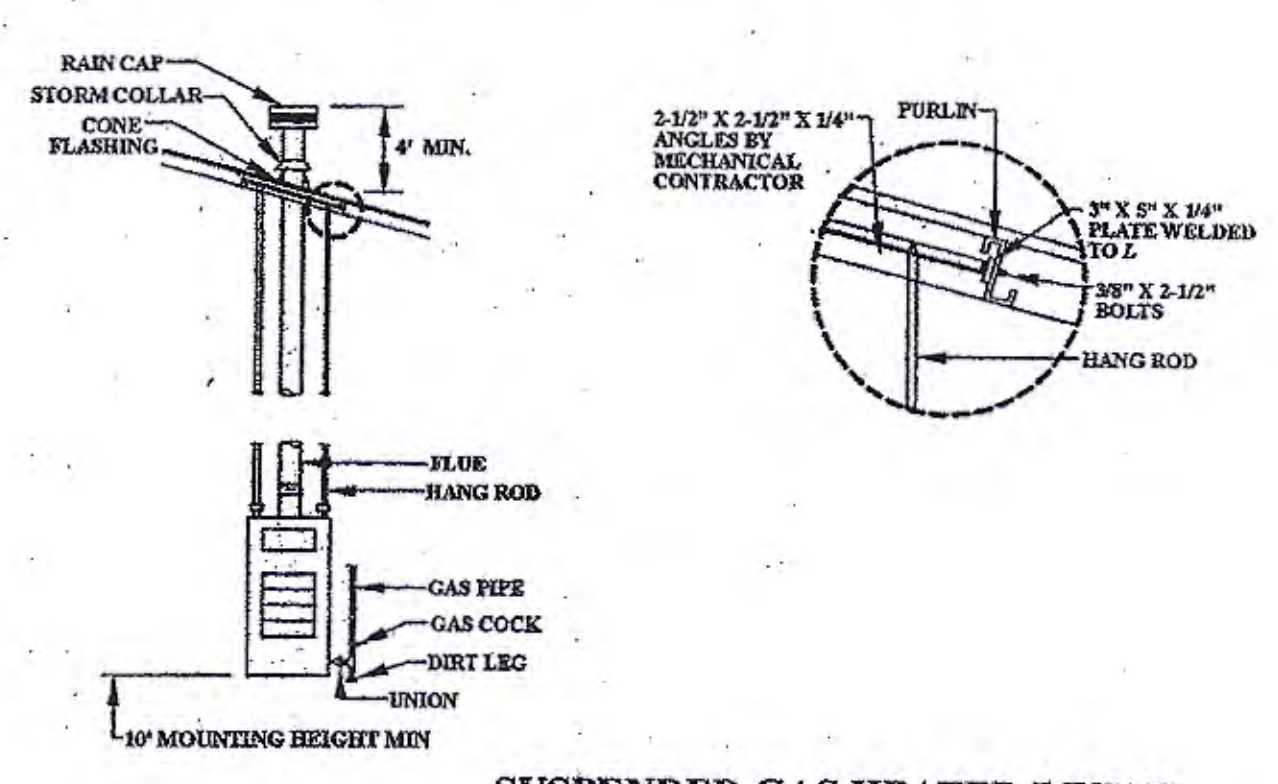

SUSPENDED GAS HEATER DETAIL
NOT USED

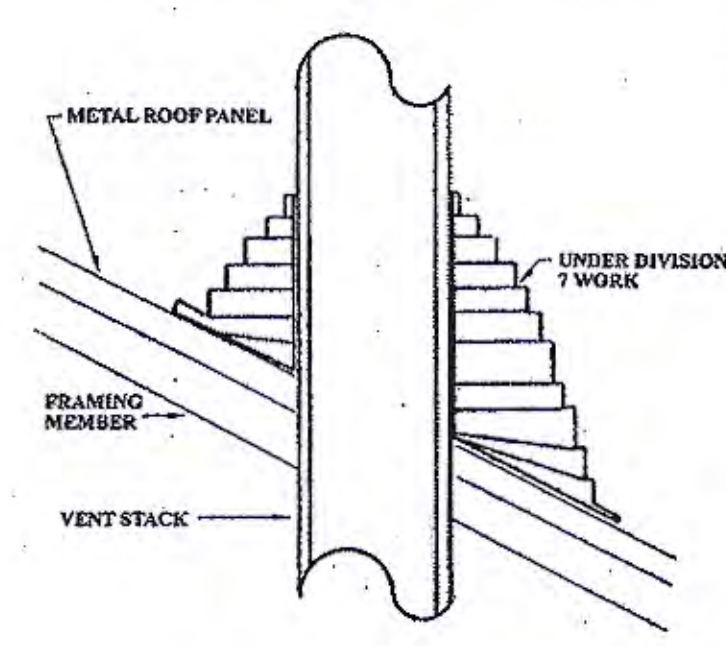

VENT FLASHING DETAIL

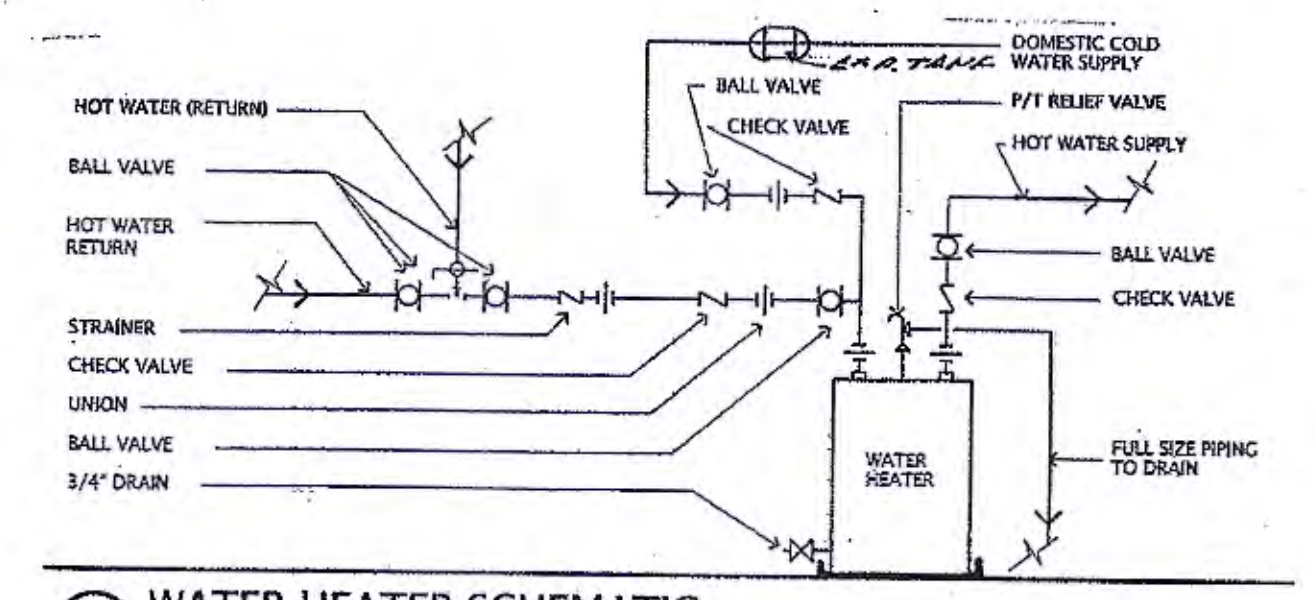

WATER HEATER SCHEMATIC

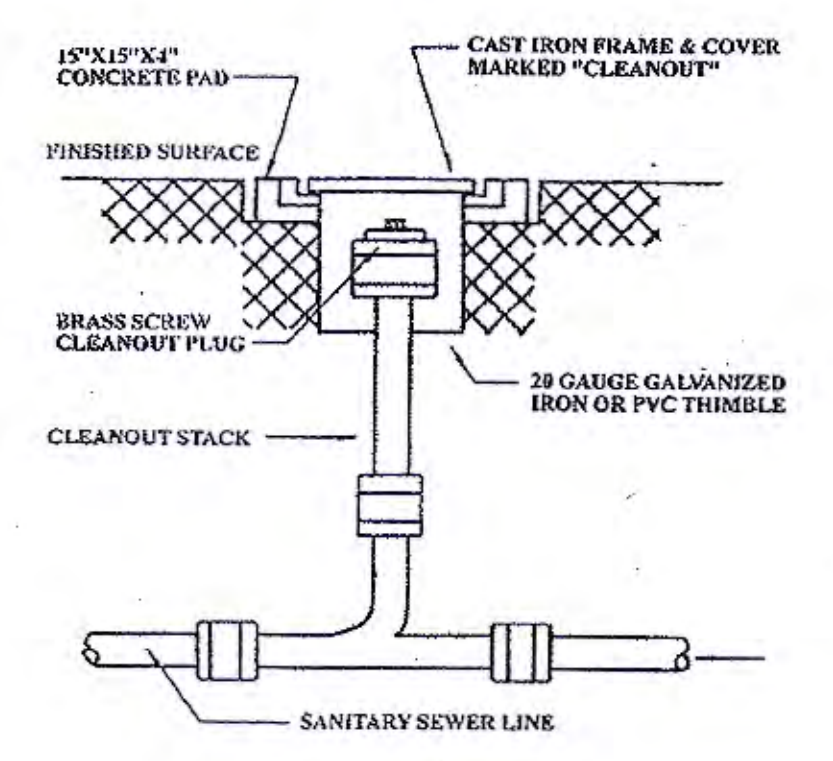

OUTSIDE C.O. DETAIL

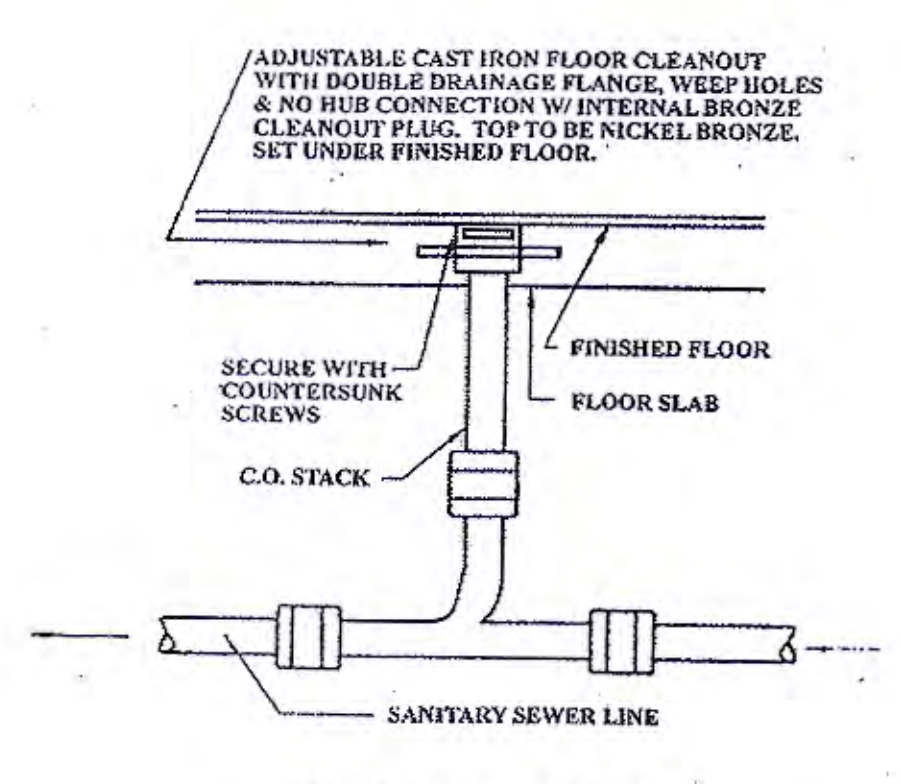

INSIDE C.O. DETAIL

FIXTURE CONNECTION SCHEDULE								
MARK	DESCRIPTION	TRAP SIZE	WASTE	VENT	COLD WATER	HOT WATER	MAX. FLOW GPM	REMARKS
	WATER CLOSET	INTEGRAL	4"	2"	1"	-	-	WALL HUNG-FLUSH VALVE
	WATER CLOSET		4"	2"	1"	-	-	HANDICAP
	LAVATORY *	1 1/4" x 1 1/2"	2"	1 1/2"	1/2"	1/2"	-	WALL HUNG-HANDICAP
	LAVATORY *	1 1/4" x 1 1/2"	2"	1 1/2"	1/2"	1/2"	-	WALL HUNG
	SINK *	1 1/4" x 1 1/2"	2"	1 1/2"	1/2"	1/2"	-	STAINLESS STEEL
	SERVICE SINK *	3"	3"	1 1/2"	1/2"	1/2"	-	FLOOR MOUNTED
	E.W.C.	1 1/4" x 1 1/2"	2"	1 1/2"	1/2"	-	-	HANDICAP
	URINAL	INTEGRAL	2"	1 1/2"	3/4"	-	-	WALL HUNG-HANDICAP
	WATER CLOSET	INTEGRAL	4"	2"	3/8"	-	-	TANK-TYPE, ELONG.
WH	WATER HYDRANT	-	-	-	3/4"	-	-	FREEZEPROOF W/VACUUM BREAKER
FD	FLOOR DRAIN	-	-	-	1/2"	-	-	SEE FLOOR PLAN FOR SIZES
WHA	WATER HAMMER ARRESTOR	-	-	-	1"	-	-	SEE FLOOR PLAN FOR SIZES

* INSTALL TRUEBRO INC. "HANDI LAV-GUARD" ON PIPING BENEATH LAVATORIES AND SINKS.

REVIEWED FOR STATE FIRE MARSHAL AS PER REVIEW LETTER BY: WILLIAM D. JONES, ARCHITECT, CBO
William D. Jones

REVISIONS	BY

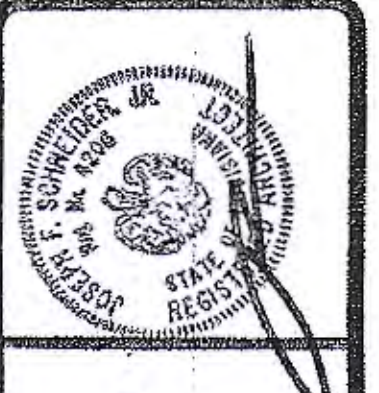

TYPICAL PLUMBING DETAILS

JOSEPH F. SCHNEIDER, JR., AIA
architect
105 Evangeline Drive Slidell, Louisiana 70460 (985) 847-0714

DRAWN
SCHNEIDER
CHECKED
SCHNEIDER
DATE
SCALE
1/4" = 1'-0"
JOB NO.
SHEET

ME-2
OF SHEETS

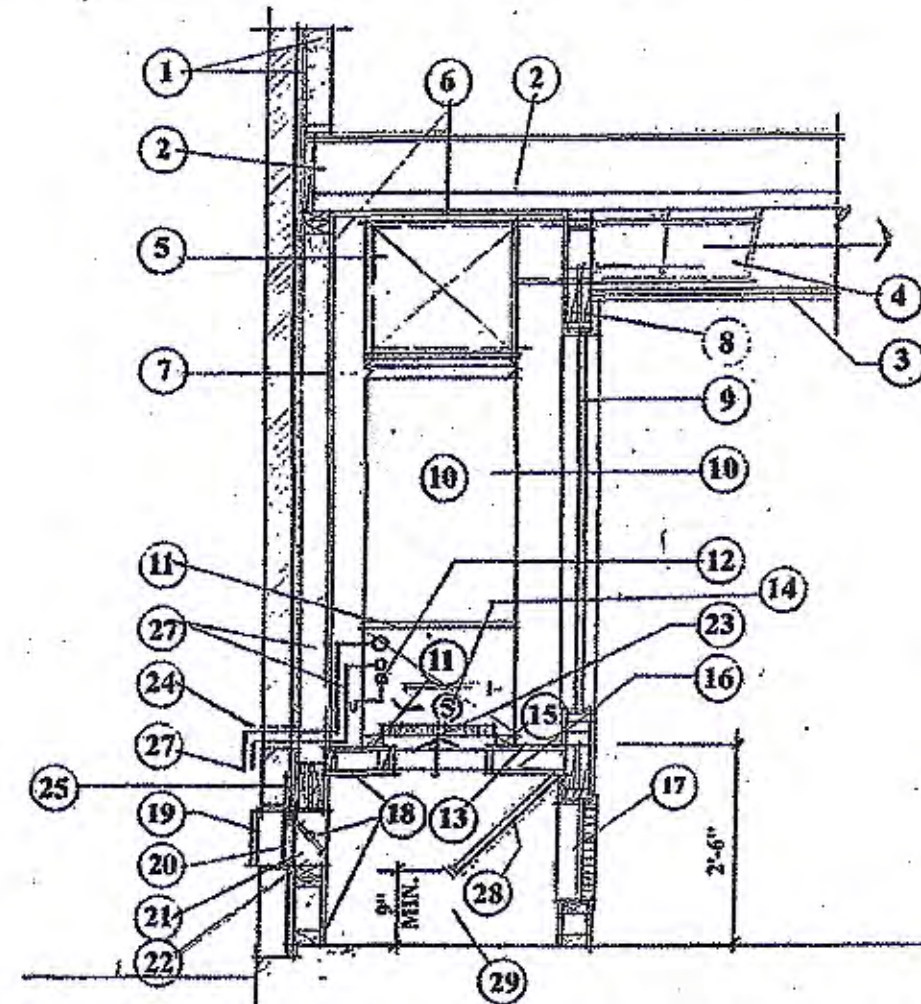

NOT USED
TYPICAL HVAC VERTICAL UNIT ON EXTERIOR WALL DETAIL

- HVAC DETAIL NOTES:**
- EXISTING EXTERIOR WALL.
 - EXISTING FLOOR SYSTEM.
 - FINISHED CEILING REFER TO ARCHITECTURAL DRAWINGS FOR HEIGHTS.
 - INSULATED SUPPLY DUCT.
 - INSULATED SUPPLY DUCT MAIN DUCT.
 - 5/8" FIRE RATED GYPSUM BOARD ALL WALLS AND CEILINGS OF HVAC CLOSET.
 - FLEXIBLE CONNECTION.
 - FRAMED DOOR OPENING OF HVAC CLOSET.
 - HVAC CLOSET DOOR.
 - VERTICAL AIR HANDLER.
 - COIL LINE FULL-CASED MULTI-POSITION TYPE.
 - 1/2" CONDENSATION DRAIN LINE WITH 1/2" TRAP. CONNECT TO EITHER HOUSE.
 - 28 GA. GALV. SHEET METAL OVER PLYWOOD PLATFORM.
 - SMOKE DETECTOR OR FRESH AIR AS SPECIFIED.
 - 2"x4" BLOCKING UNDER UNIT TO ALLOW TRAPPING FOR CONDENSATE DRAIN.
 - 2"x4" PLATFORM FRAMING WITH 1/2" PLYWOOD TOP.
 - RETURN AIR WALL GRILL REFER TO DRAWINGS FOR SIZE.
 - LINE RETURN AIR FLESH WITH 1" ACOUSTIC DUCT LINER.
 - 8"x16" OUTSIDE AIR (OSA) ALUMINUM WALL GRILL WITH INSECT SCREEN EQUAL TO RUSKIN MODEL RLF-211 OR EQUAL.
 - 2" AUTOMATIC FIRE DAMPER (AFD).
 - MANUAL DAMPER.
 - SHEET METAL SLEEVE.
 - FLTSR.
 - METAL WALL SLEEVE WITH SEALANT.
 - ANGLE 3/4"x1 1/2" OVER LOUVER OPENING WITH THRU-WALL FLASHING.
 - SEAL ALL WALL PENETRATIONS BY DUCTWORK.
 - REFRIGERANT LINESIZE PER MANUFACTURER'S SPECIATION. INSULATE ALL LINES.
 - NOISE BAFLE- 1/2" PLYWOOD WITH 1" DUCT LINER BOTH SIDES.
 - RETURN AIR FLESH.

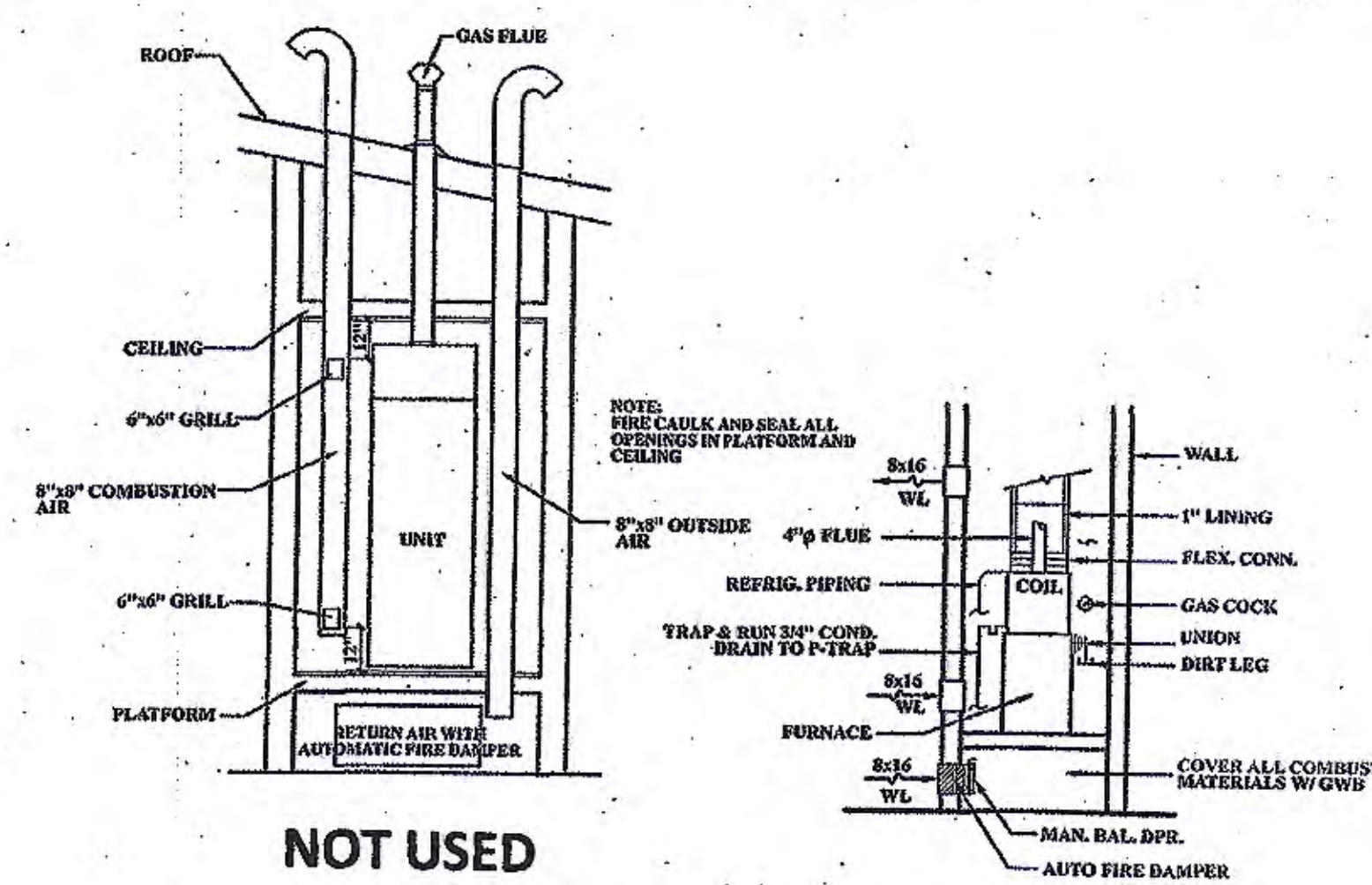

NOT USED
TYPICAL GAS FIRE CLOSET UNIT DETAIL

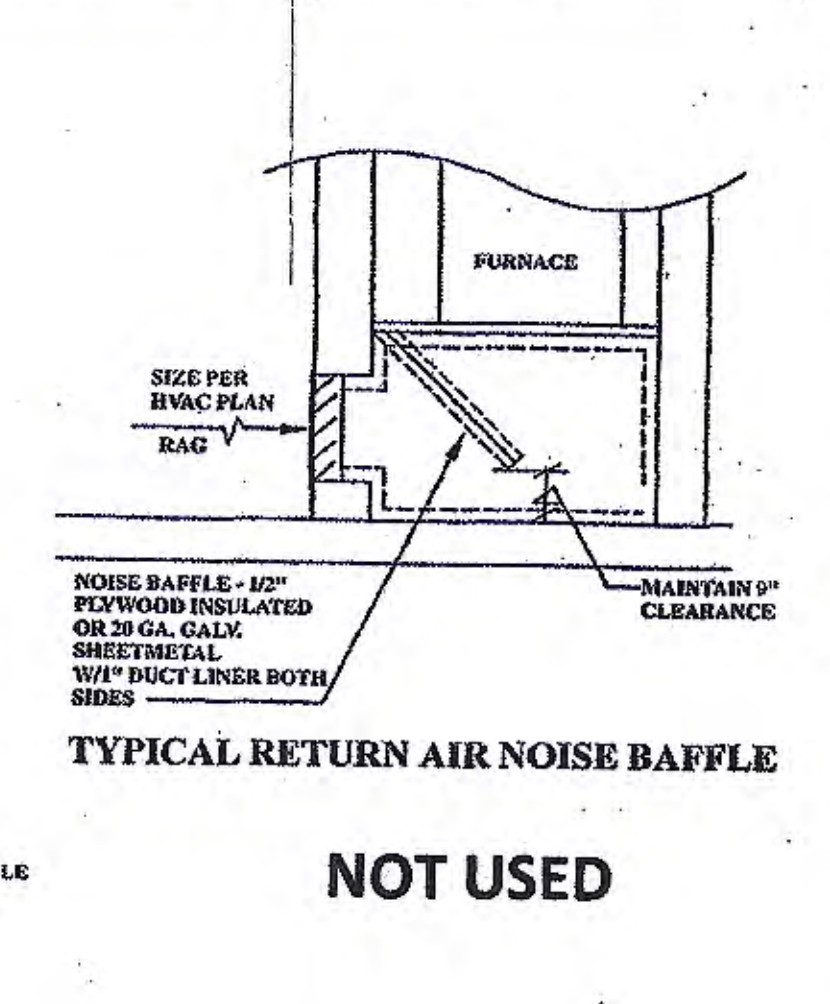

NOT USED
TYPICAL RETURN AIR NOISE BAFLE

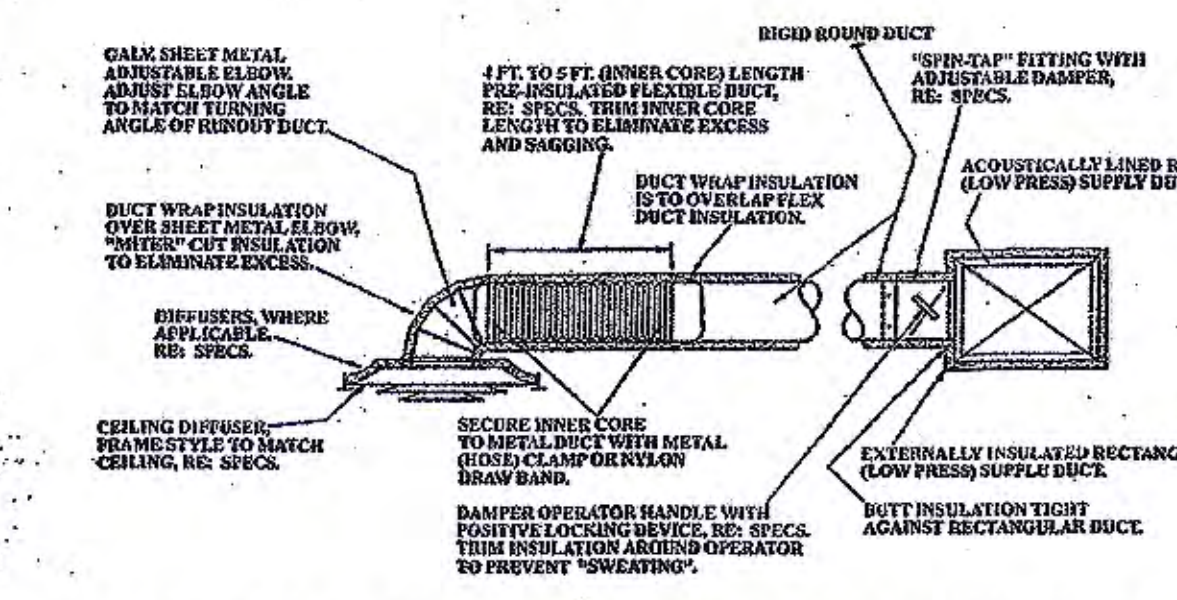

ROUND DUCT BRANCH RUNOUT CONNECTION DETAIL

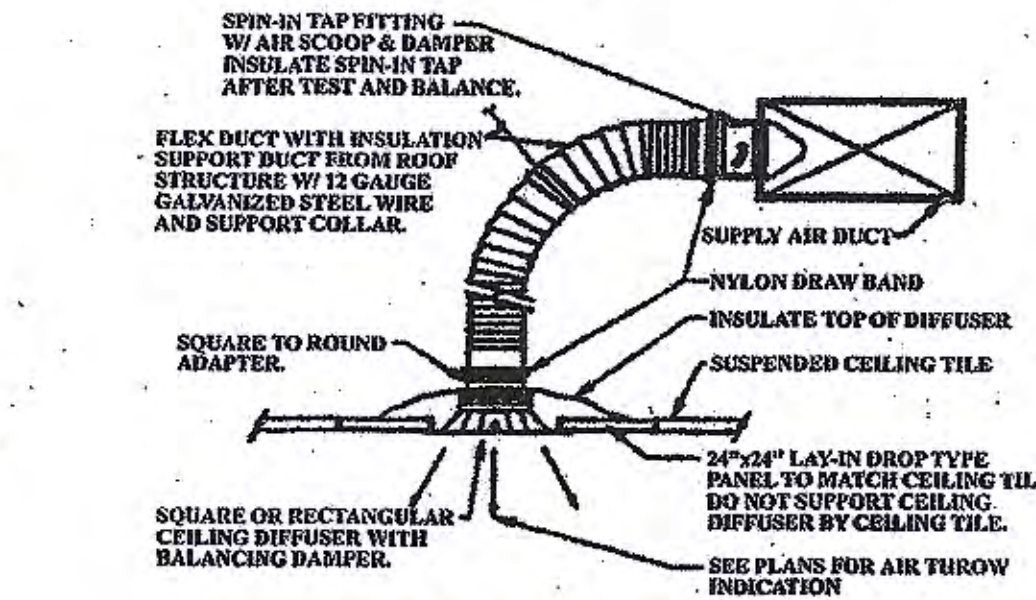

TYPICAL LAY-IN CEILING DIFFUSER DETAIL

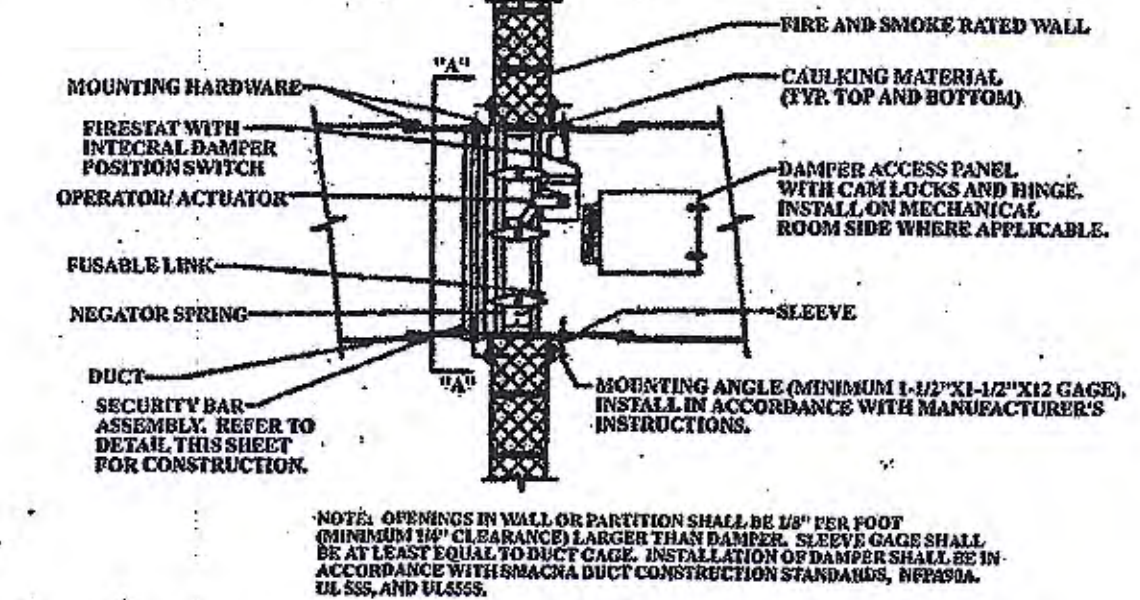

COMBINATION FIRE/SMOKE DAMPER DETAIL

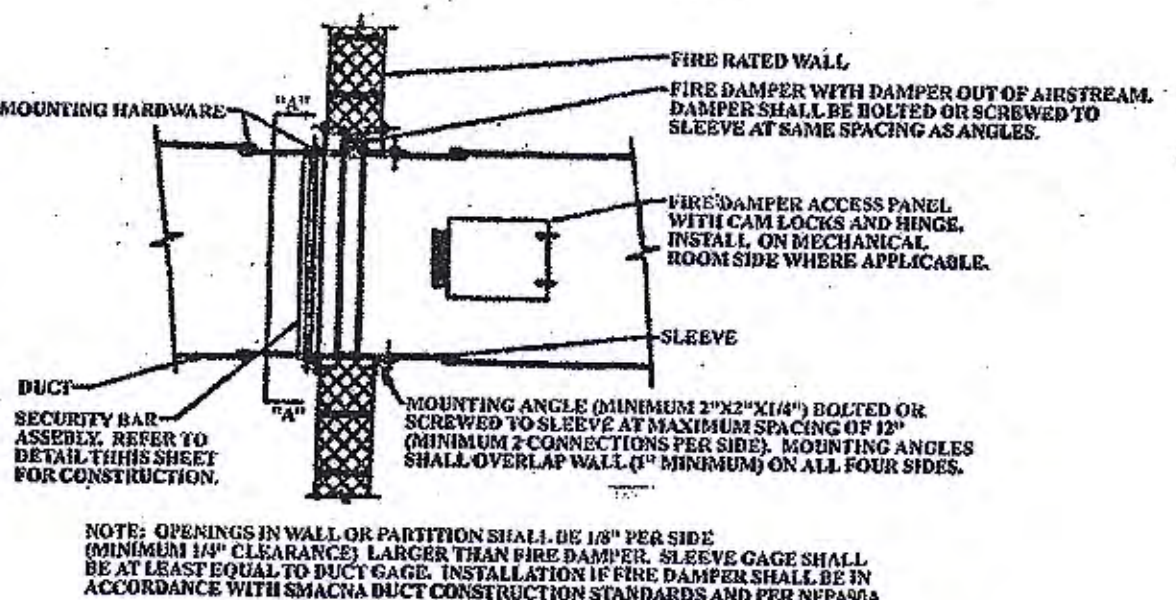

TYPICAL VERTICAL FIRE DAMPER DETAIL

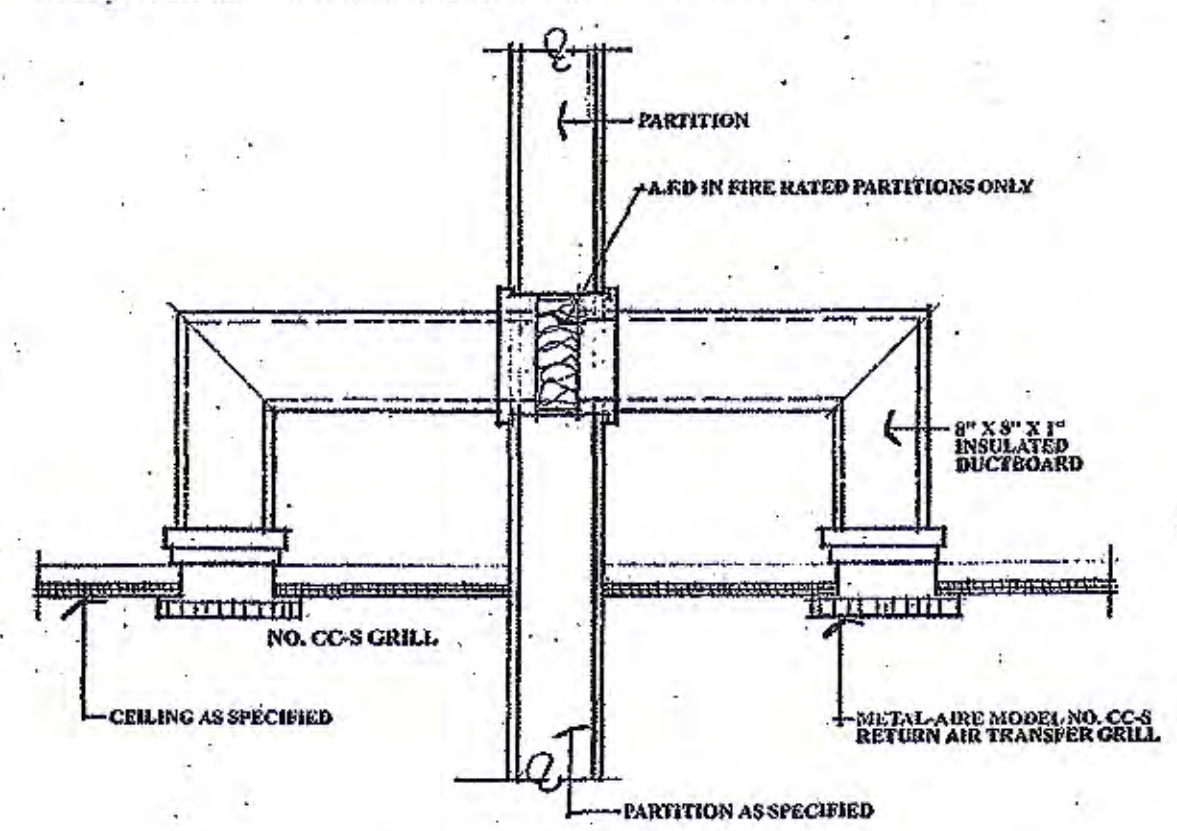

CEILING RETURN-AIR TRANSFER DETAIL

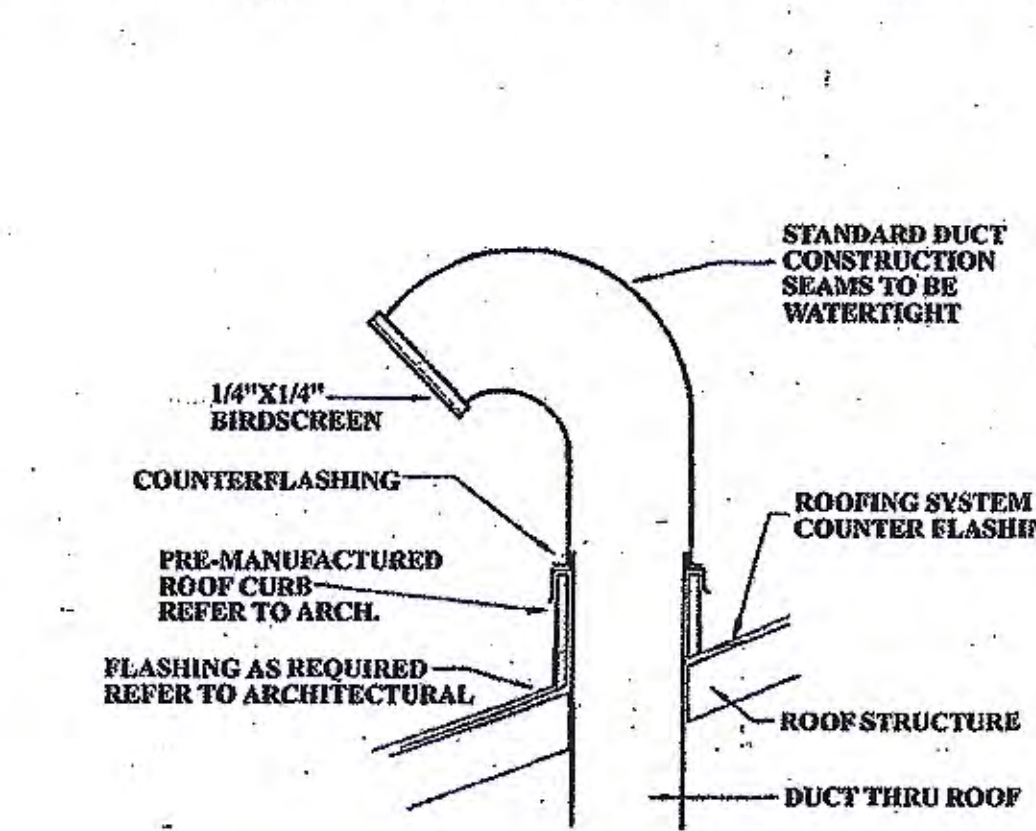

GOOSENECK DETAIL - SLOPED ROOF

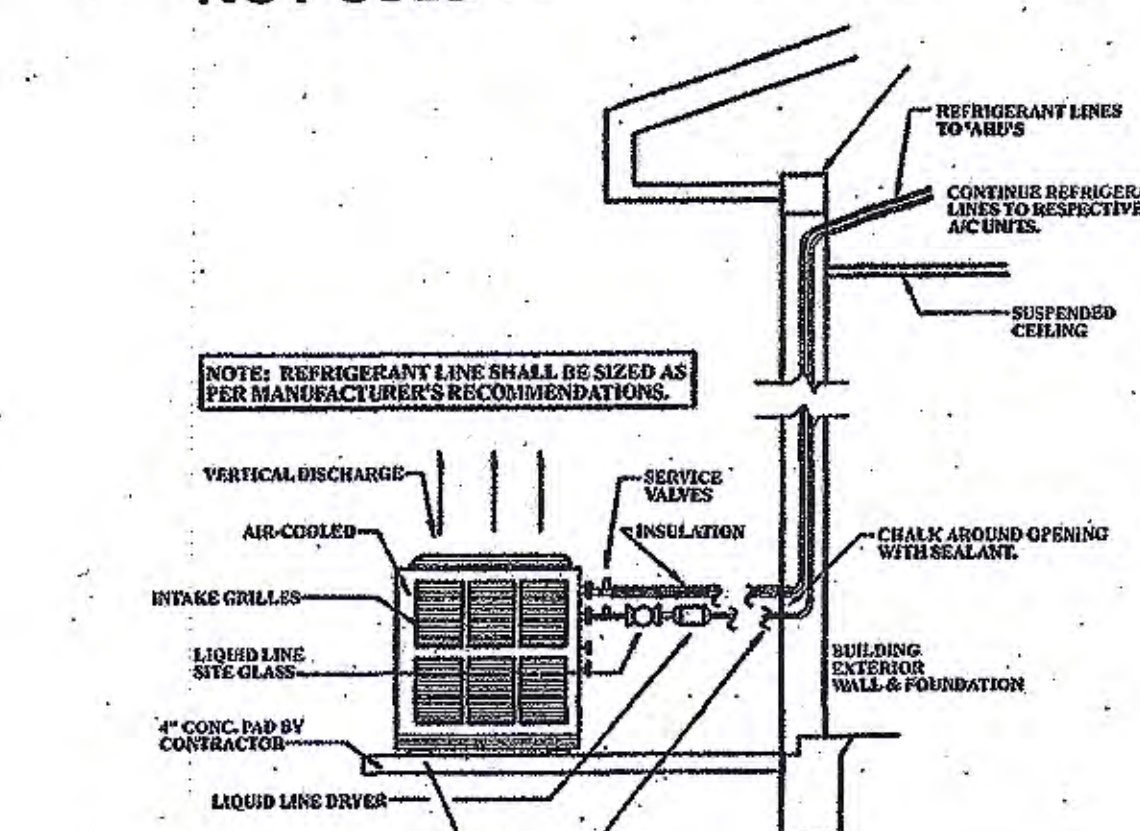

CONDENSING UNIT DETAIL

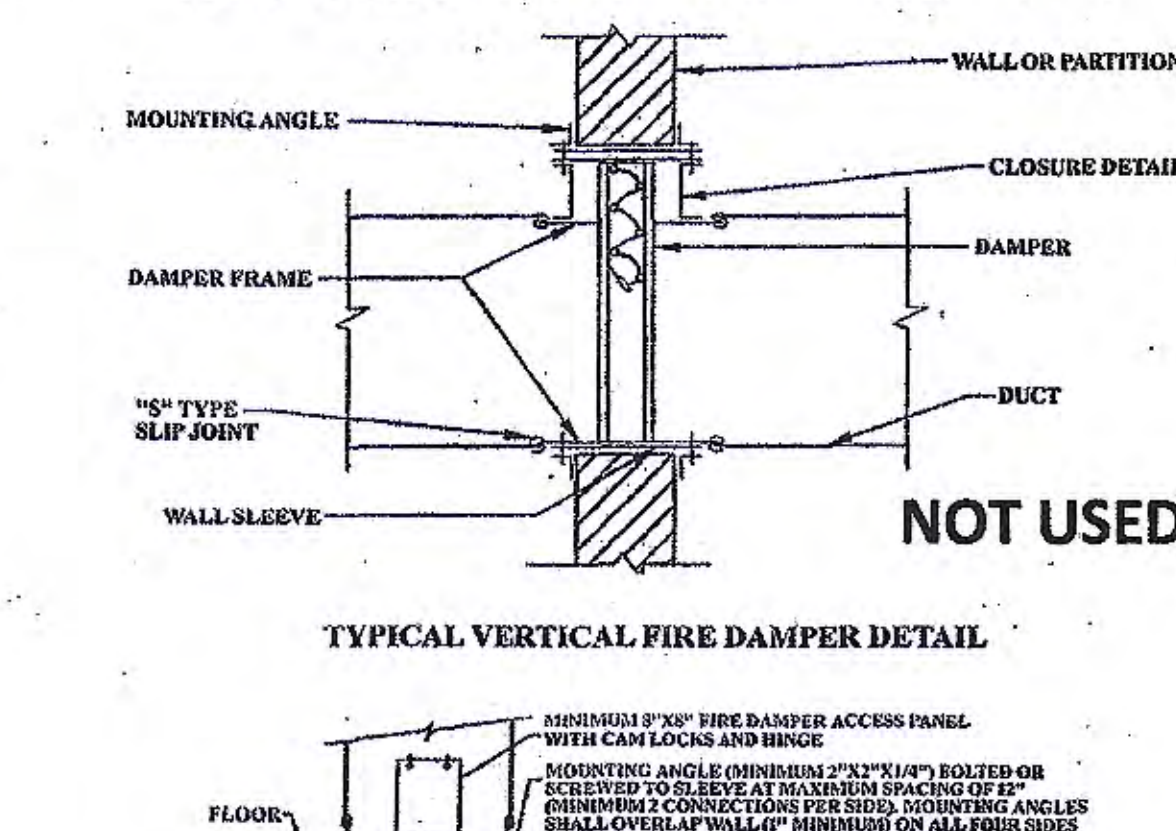

TYPICAL VERTICAL FIRE DAMPER DETAIL

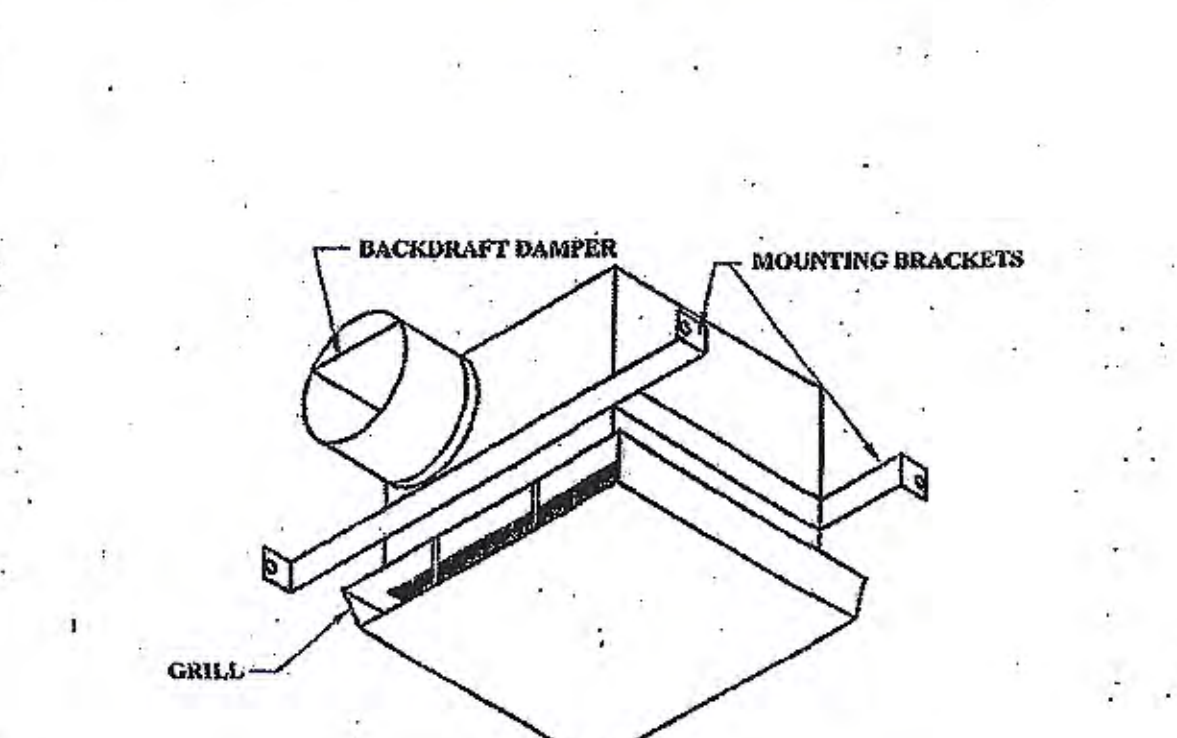

CEILING MOUNTED EXHAUST FAN

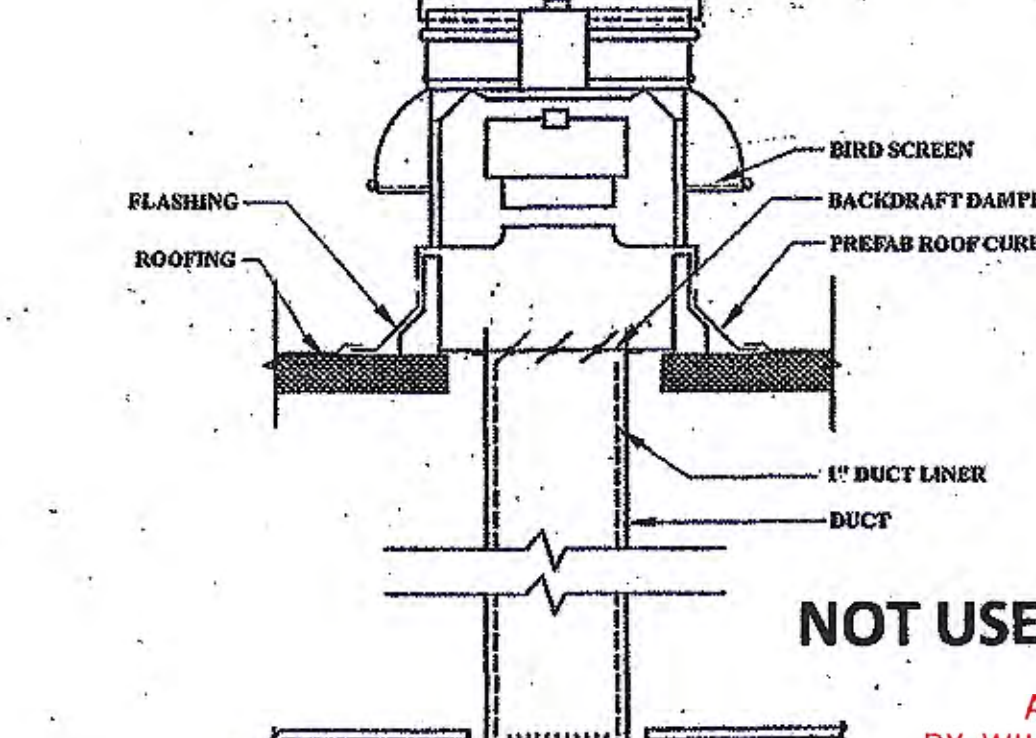

ROOF MOUNTED EXHAUST FAN DETAIL

NOT USED REVIEWED FOR STATE FIRE MARSHAL AS PER REVIEW LETTER BY WILLIAM D. JONES, ARCHITECT, CBO

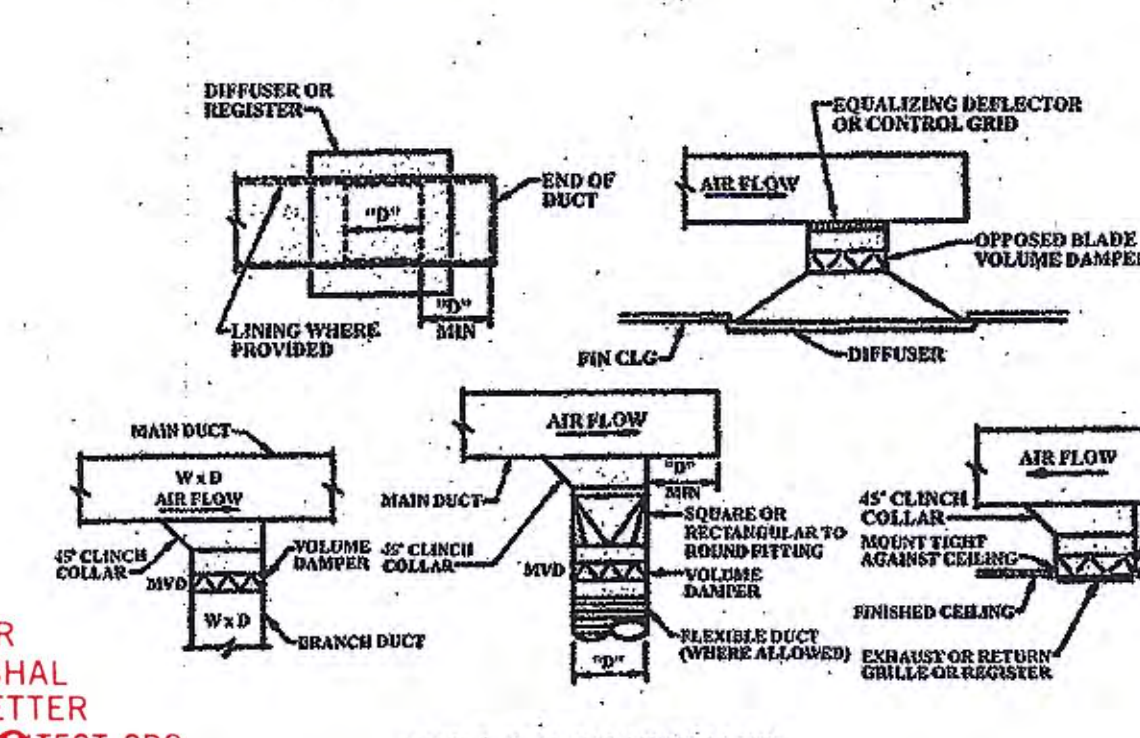

TYPICAL HARD DUCT TO AIR DEVICE CONNECTION DETAILS

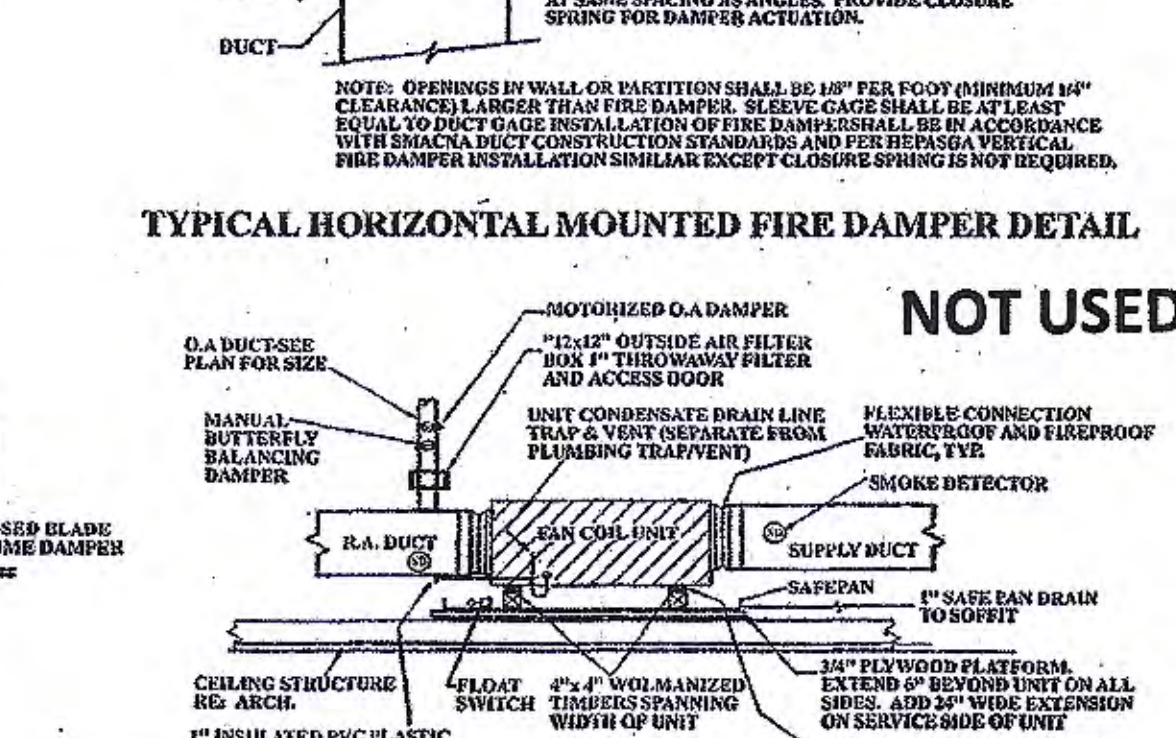

HORIZONTAL FAN COIL UNIT DETAIL

REVISIONS	BY

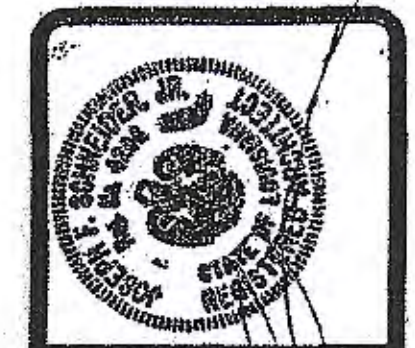

TYPICAL MECHANICAL DETAILS

JOSEPH F. SCHNEIDER, JR. AIA
architect
105 Evangeline Drive Slidell, Louisiana 70460 (985) 847-0714

DRAWN	5/21/06
CHECKED	5/21/06
DATE	11/18/06
SCALE	AS NOTED
JOB NO.	068
SHEET	

ME-3

PLUMBING FIXTURE SCHEDULE

- WC-1:**
HANDICAP WATER CLOSET- TWO PIECE LOW CONSUMPTION TYPE PRESSURE ASSISTANT TOILET- MIN. 17 1/2" HIGH, 15 GPF. COLOR WHITE. HANDLE LOCATED ON OPEN SIDE
- L-1:**
HANDICAP WALL MOUNTED 18" 20" ADA VITREOUS CHINA WITH CONCEALED WALL CARRIER, 4" CENTER SELF-CLOSING METERED LOW WATTAGE LEVER FAUCET OR PUSH OPERATIONS. PROVIDE WITH SUPPLY LIENS, ANGLE SUPPLIES WITH STOPS, "P" TRAP WITH "TRUBRO" ADA PIPE INSULATION KIT. MINIMUM WATER TEMPERATURE 110°F.
- MB-1:**
EQUAL TO MUSTEE LEG SUPPORTED 18" X 24" LANDRY TRAY NO. 12C COMBO UNIT POLYPURE RESIN.
- FD-1:**
2" DIAMETER FLOOR DRAIN W/ 1/2"Ø TRAP PRIMER. PROVED WITH DRAIN AND STRAINER WITH BRASS ROUND COVER CAP.
- EDF-1 (ELECTRIC DRINKING FOUNTAIN):**
1 WALL MOUNTED ELECTRIC DRINKING FOUNTAIN EQUAL TO HALSEY-TAYLOR DUAL BI-LEVEL BARRIER FREE ELECTRIC REFRIGERATED STAINLESS STEEL UNIT NO. "HACF-DBL-L/R" ADA. PROVIDE WITH MINIMUM 3/8" DIA. WATER LINE AND 1 1/2" DIA. DRAIN. MOUNT PER ADA REQUIREMENTS.
- WH - 1 WATER HEATER:**
52 GALLON ELECTRIC WATER HEATER WITH TWO 4,500 WATT NON-SIMULTANEOUS ELECTRIC ELEMENTS, INSULATED AND JACKETED GLASS LINED STEEL WITH EXPANSION TANK AND CIRCULATING PUMP.
- S-1 SINK: STERILIZATION ROOM:**
SINGLE BOWL STAINLESS STEEL HEAVY DUTY SINK RIMMED WITH HOT AND COLD WATER. PROVIDE WITH LEVER HANDLES AND ANGLE VALVES.
- S-2 SINK: LAB:**
SINGLE BOWL STAINLESS STEEL HEAVY DUTY RIMMED STAINLESS STEEL SINK WITH HOT AND COLD WATER. PROVIDE WITH LEVER HANDLES AND ANGLE VALVES. UNIT PROVIDED WITH PLASTER TRAP. REFER TO DENTAL EQUIPMENT DRAWINGS.
- S-3 SINK: CORRIDOR:**
ROUND SINGLE BOWL RIMMED STAINLESS STEEL CORRIDOR SINK WITH HOT AND COLD WATER. PROVIDE WITH LEVER HANDLES AND ANGLE VALVES.

MISCELLANEOUS PLUMBING ITEMS:

- A. VB - 1, VACUUM BREAKER: INSTALL VACUUMS BREAKER ON COLD WATER INLET TO WATER HEATER UNIT SHALL BE EQUAL TO WATTS 36 A.
- B. WHA, WATER HAMMER ARRESTORS: STAINLESS STEEL, BELLOWS / COMPRESSION CHAMBER TYPE, PRE - CHARGED AND PERMANENTLY SEALED AT THE FACTORY. EQUAL TO SMITHS HYDROTOL # 5005.
- C. INTERIOR FINISHED FLOOR CLEANOUT: SERIES 58660 BY JOSAM OR EQUAL. LACQUERED CAST IRON, TWO PIECE BODY WITH DOUBLE DRAINAGE FLANGE, WEEP HOLES, REVERSIBLE CLAMPING COLLAR AND ADJUSTABLE NICKEL, BRONZE STRAINER, ROUND WITH SCORIATED COVER IN SERVICE AREA AND ROUND WITH DEPRESSED COVER TO ACCEPT FLOOR FINISH IN FINISHED FLOOR AREAS.
- D. CLEANOUTS AND TEST TEES: FLOOR CLEANOUTS SHALL BE JOSAM SERIES 58340, ZURN Z1425 - 3 OR APPROVED EQUAL. WALL CLEANOUTS SHALL BE JOSAM SERIES 58710, ZURN Z1440 - 1 OR APPROVED EQUAL. EXTERIOR CLEANOUTS SHALL BE JOSAM SERIES 58310, ZURN Z1420 - 27 OR APPROVED EQUAL, SET IN 15" X 15" X 6" CONCRETE PAD.
- E. VALVE BOXES: EACH GATE VALVE SHALL BE PROVIDED WITH AN ADJUSTABLE, TWO PIECE, CAST IRON VALVE BOX OF A SIZE SUITABLE FOR THE VALVE. THE HEAD SHALL BE ROUND AND THE LID SHALL HAVE THE WORD "WATER" CAST ON IT. THE LEAST DIAMETER OF THE SHAFT OF THE BOX SHALL BE 5". EACH BOX SHALL BE GIVEN A HEAVY COAT OF BITUMINOUS PAINT AND SET IN AN 18" X 18" X 6" CONCRETE PAD.
- F. BP - 1, BACKFLOW PREVENTER: REDUCED PRESSURE EQUAL TO WATTS WITH AIR GAP AND STRAINER. PIPE DRAIN TO FLOOR DRAIN. EQUAL PRODUCTS BY FEBCO, HERSEY, ZURN.
- G. SHOCK ABSORBERS: SHOCK ABSORBERS SHALL BE INSTALLED ON ALL HOT AND COLD WATER SUPPLIES NEAR THE FAUCET. SHOCK ABSORBERS SHALL BE EQUAL TO PRECISION PLUMBING PRODUCTS, INC. WITH SIZES AS RECOMMENDED BY THE MANUFACTURER.

NOTES:

1. ALL MECHANICAL WORK SHALL COMPLY WITH THE 2015 EDITION OF THE INTERNATIONAL MECHANICAL CODE AND ALL REFERENCED STANDARDS.
2. ALL PLUMBING WORK SHALL COMPLY WITH THE 2015 EDITION OF THE INTERNATIONAL PLUMBING CODE.
3. ALL SEWER, DRAIN, AND VENT LINES SHALL BE SCHEDULE 40 PVC.
4. ALL COPPER LINES ABOVE GROUND SHALL BE TYPE "L" HARD COPPER.
5. ALL COPPER LINE BELOW GRADE SHALL BE SOFT COPPER TYPE "K".
6. ALL ELECTRICAL WORK SHALL COMPLY WITH NEC 2014 EDITION.

TOILET PARTITION & ACCESSORIES
BASED ON BRADLEY OR APPROVED EQUAL

- PAPER TOWEL DISPENSER/ WASTE RECEPTACLE:**
BRADLEY MODEL NO. B-262. 1 EACH TOILET ROOM.
- TOILET TISSUE DISPENSER:**
BRADLEY NO. 523 NON-CONTROLLED DUAL ROLL. ONE (1) EACH TOILET STALL.
- SOAP DISPENSER:**
BRADLEY MODEL NO. B-112 - WALL MOUNTED SOAP DISPENSER. ONE (1) EACH LAVATORY.
- GRAB BARS:**
BRADLEY NO. 812 - 1 1/2"Ø WITH SAFETY GRIP FINISH. ONE (1) 42" LONG EACH HANDICAP TOILET STALL AND ONE (1) 36" LONG EACH HANDICAP TOILET PER DRAWINGS. GRAB BARS SHALL BE CONCEALED MOUNTING TYPE BOTH BAR CONFIGURATION SHALL BE TYPE "001".

NOTE:

ALL HORIZONTAL DRAINAGE PIPING SHALL SLOPE ACCORDING TO IPC-2015 SECTION 704 TABLE 704.1:

2 1/2" OR LESS	MIN 1/4" PER FOOT
3" TO 6"	MIN 1/8" PER FOOT
8" OR LARGER	MIN 1/16" PER FOOT

BFP = BACK FLOW PREVENTOR

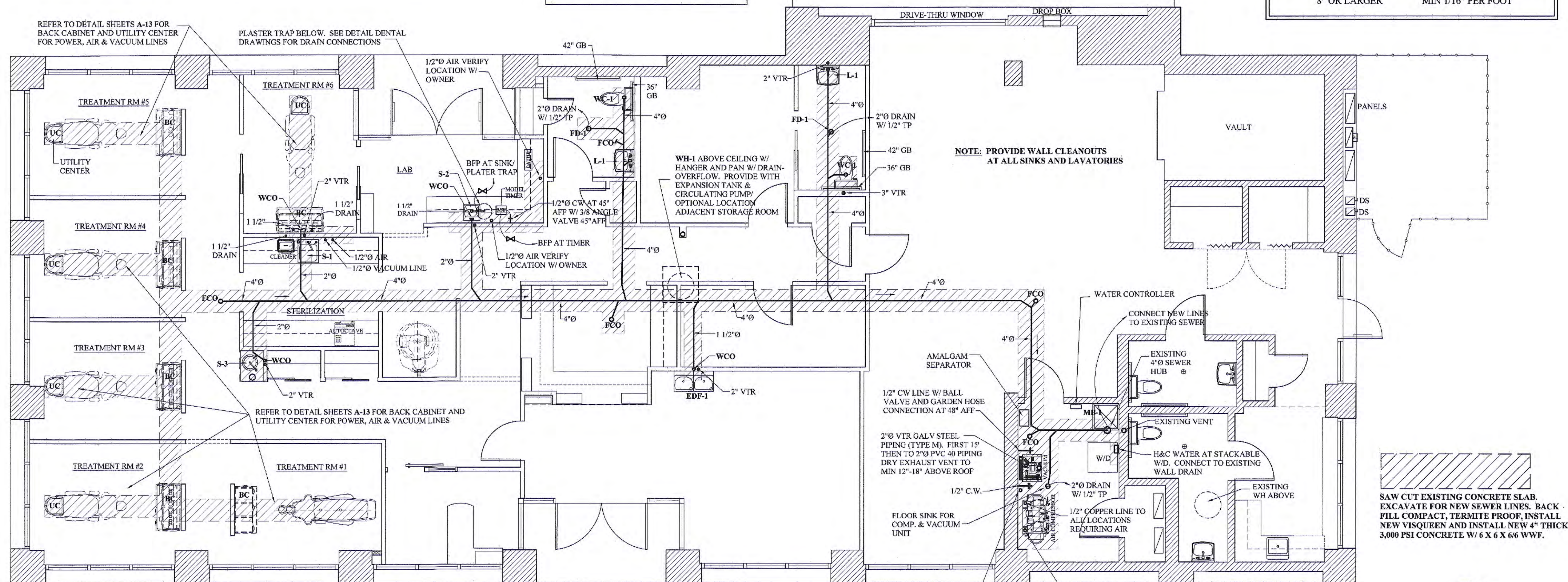

REFER TO DENTAL SHOP DRAWINGS Q0.1-Q4.2 FOR DETAILS OF ALL DENTAL EQUIPMENT (DATED 05/12/22)

NOTE: PROVIDE 2"Ø PVC HEADER TO ALL TREATMENT ROOMS PER DENTAL DRAWINGS. PROVIDE MIN 1/4" SLOPE PER 10'. REFER TO SHEET Q.4.2 OF DENTAL DRAWINGS FOR DETAILS OF VACUUM UNIT AND AIR COMPRESSOR.

OSA (FRESH) TO UNIT MANIFOLD. MAINTAIN MIN 10"Ø FROM ALL EXHAUST FANS, STACKS AND VENTS

REVIEWED FOR STATE FIRE MARSHAL AS PER REVIEW LETTER BY: WILLIAM D. JONES, ARCHITECT, CBO

William D. Jones

PLUMBING PLAN- NEW WORK

SCALE: 1/4" = 1'-0"

A-10

THESE DESIGN AND CONSTRUCTION DOCUMENTS AT THE SOLE PROPERTY OF JOSEPH F. SCHNEIDER, JR. AIA, ARCHITECT. NO USE OR REPRODUCTION OF THESE DOCUMENTS OR PARTIAL USE OR PARTIAL REPRODUCTION IS ALLOWED. NO USE OF THESE DRAWINGS WITHOUT THE WRITTEN EXPRESSED PERMISSION OF JOSEPH F. SCHNEIDER, JR. ARCHITECT IS ALLOWED.

REVISIONS	BY



INTERIOR RENOVATIONS
LEVEL-2 (LESS THEN 50%)
DR. PAMELA DAIGLE, DDS
2130 GAUSE BLVD WEST
SLIDELL, LOUISIANA 70460

JOSEPH F. SCHNEIDER JR., AIA
ARCHITECT
LA #4206 MS #3020 AL #8724 FL #AR95908 TX #24294
105 EVANGELINE DRIVE, SLIDELL, LOUISIANA 70460
(985) 847-0714
jfsarchitect@charter.net

DRAWN H. SCHNEIDER
CHECKED J. SCHNEIDER
DATE 06/07/2022
SCALE AS NOTED
JOB NO.
SHEET A-10
OF SHEETS

REVISIONS	BY

EXHAUST FAN: EF-1, EF-2, EF-3

CEILING MOUNTED EXHAUST FAN 100 CFM WITH 6" DIAMETER INSULATED DUCT TO EXTERIOR WALL. PROVIDE WITH WALL CAP, INSECT SCREEN, BACKDRAFT, DAMPER, AND WALL CAP. INSULATION MINIMUM R-6.

DUCT SMOKE DETECTOR ALARM:

IN ACCORDANCE WITH INTERNATIONAL MECHANICAL CODE (IMC) -2015-606.4.3 AND 2015 NFPA 90A, ACTIVATION OF A SMOKE DETECTOR SHALL ACTIVATE A VISUAL AND AUDIBLE SIGNAL IN AN APPROVED LOCATION. DUCT SMOKE DETECTORS TROUBLE CONDITIONS SHALL ACTIVATE A VISUAL AND AUDIBLE SIGNAL IN AN APPROVED LOCATION AND SHALL IDENTIFIED AS AIR DUCT DETECTOR TROUBLE. PROVIDE WITH REMOTE TEST STATION AND RESET CAPABILITY. PROVIDE SMOKE DETECTORS ON BOTH SUPPLY AND RETURN AIR DUCT LOCATIONS.

PRIOR TO ANY EXCAVATION WORK BEING PERFORMED FOR INSTALLATION OF UTILITIES OR FOUNDATION WORK, THE CONTRACTOR AND/OR THEIR SUBCONTRACTORS SHALL NOTIFY LOUISIANA ONE-CALL AT 1-800-272-3020 OR DIAL 811 TO VERIFY LOCATIONS OF ALL SUB-SURFACE UTILITIES. ALL NOTIFICATIONS SHALL COMPLY WITH THE LOUISIANA UNDERGROUND UTILITIES AND FACILITIES DAMAGE PREVENTION LAW.

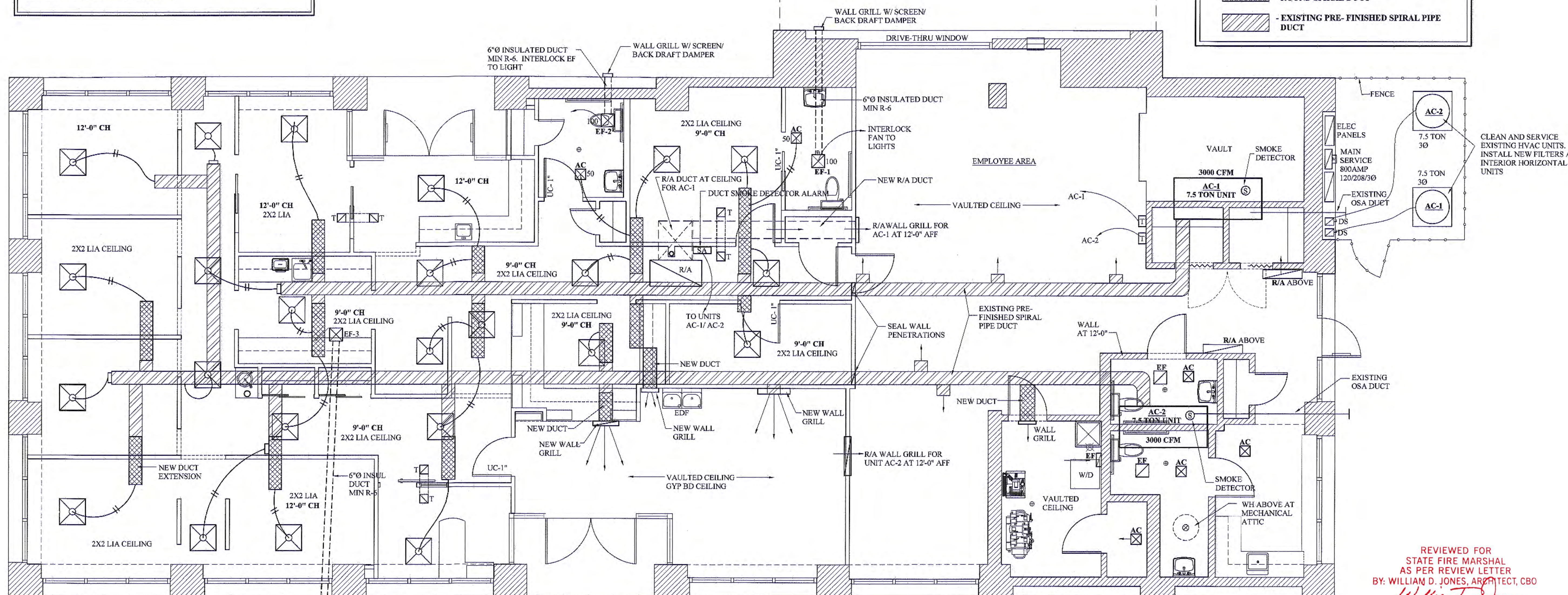
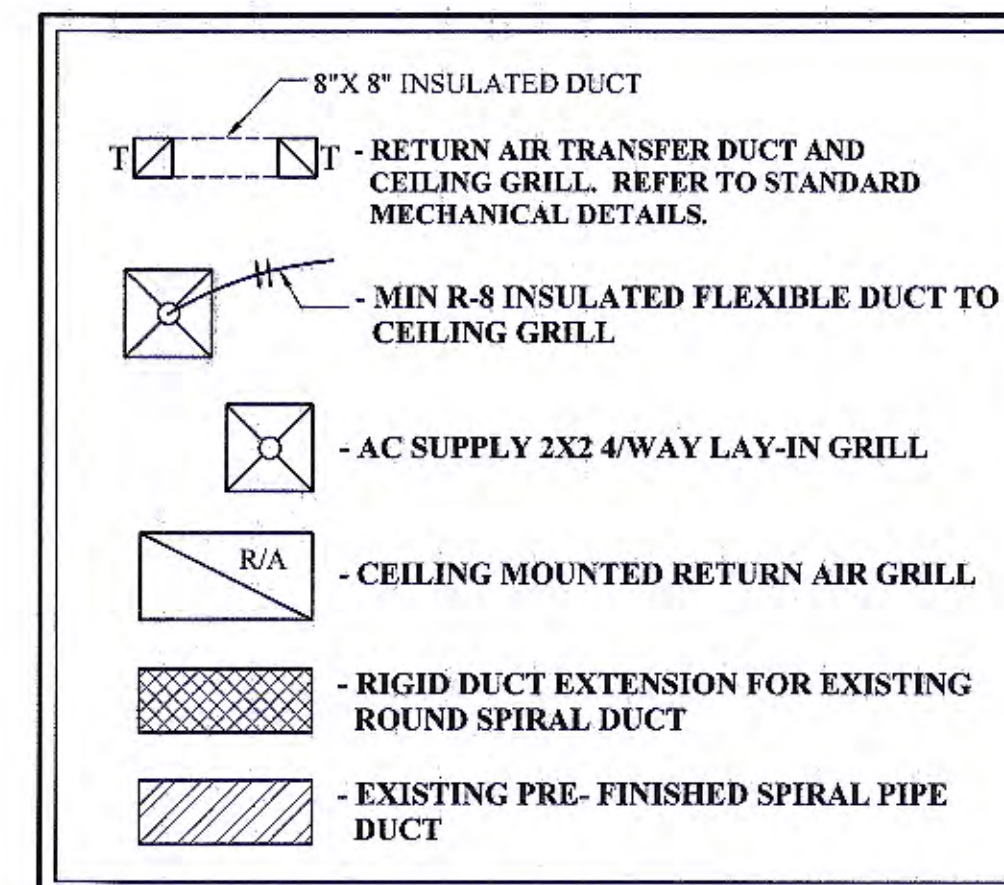

CLEAN AND SERVICE EXISTING HVAC UNITS. INSTALL NEW FILTERS AT INTERIOR HORIZONTAL UNITS

REVIEWED FOR STATE FIRE MARSHAL AS PER REVIEW LETTER BY: WILLIAM D. JONES, ARCHITECT, CBO
William D. Jones

NOTE: REBALANCE ALL HVAC UNITS AND DUCTWORK AFTER NEW WORK COMPLETED

HVAC PLAN - NEW WORK

SCALE: 1/4" = 1'-0"

A-11

THESE DESIGN AND CONSTRUCTION DOCUMENTS AT THE SOLE PROPERTY OF JOSEPH F. SCHNEIDER, JR. AIA, ARCHITECT. NO USE OR REPRODUCTION OF THESE DOCUMENTS OR PARTIAL USE OR PARTIAL REPRODUCTION IS ALLOWED. NO USE OF THESE DRAWINGS WITHOUT THE WRITTEN EXPRESSED PERMISSION OF JOSEPH F. SCHNEIDER, JR. ARCHITECT IS ALLOWED.



INTERIOR RENOVATIONS
LEVEL-2 (LESS THEN 50%)
DR. PAMELA DAIGLE, DDS
2130 GAUSE BLVD WEST
SLIDELL, LOUISIANA 70460

JOSEPH F. SCHNEIDER JR., AIA
ARCHITECT
LA #4206 MS #3020 AL #6724 FL #AR95908 TX #24294
105 EVANGELINE DRIVE, SLIDELL, LOUISIANA 70460
(985) 847-0714
jfsarchitect@charter.net

DRAWN	H. SCHNEIDER
CHECKED	J. SCHNEIDER
DATE	06/07/2022
SCALE	AS NOTED
JOB NO.	
SHEET	A-11
OF SHEETS	

ELECTRICAL NOTES:

- ELECTRICAL WORK SHALL BE IN ACCORDANCE WITH THE NATIONAL ELECTRICAL CODE, STATE AND CITY REGULATIONS AND ORDINANCES.
- MATERIALS SHALL BE NEW AND U.L. APPROVED, EXCEPT AS INDICATED.
- CONTRACTOR SHALL APPLY FOR PERMITS AND PAY INSPECTION FEES. NO WORK SHALL BE CONCEALED UNTIL APPROVED BY LOCAL INSPECTOR UPON COMPLETION, FURNISH CERTIFICATE OF APPROVAL FROM DIVISION OF REGULATORY INSPECTION AS APPLICABLE.
- CONDUCTORS SHALL BE COPPER WITH TYPE THHN/THWN INSULATION, AND SHALL BE #12 AWG OR LARGER.
- WIRING INSTALLED OUTDOORS SHALL BE CONTAINED IN PVC CONDUIT OR ELECTRIC METALLIC TUBING WITH SET SCREW FITTINGS, UNLESS INDICATED OTHERWISE.
- WIRING INSTALLED EXPOSED IN DRY LOCATIONS SHALL BE CONTAINED IN ELECTRIC METALLIC TUBING WITH SET SCREW FITTINGS, UNLESS INDICATED OTHERWISE.
- RACEWAYS SHALL BE CONCEALED UNLESS INDICATED OTHERWISE.
- OUTLET BOXES SHALL BE GALVANIZED STEEL 4" SQUARE X 1 1/2" DEEP, OR LARGER BOX WITH RAISED DEVICE COVER. CEILING BOXES SHALL BE 4" OCTAGONAL X 1 1/2" DEEP OR LARGER, BOXES IN WALLS SHALL NOT BE INSTALLED BACK-TO-BACK.
- OUTLET BOXES FOR EXPOSED WORK AT DRY LOCATIONS IN MECHANICAL AND ELECTRICAL ROOMS (WHERE EXPOSED RACEWAYS ARE INSTALLED) SHALL BE 4" SQUARE X 1 1/2" DEEP OR LARGER WITH APPLETON 1/2" DEEP RAISED SURFACE METAL COVERS TO ACCOMMODATE THE DEVICES INDICATED. OUTLET BOXES FOR EXPOSED WORK EXPOSED TO WEATHER OR IN DAMP LOCATIONS SHALL BE OF CAST OR MALLEABLE IRON, SIMILAR TO CROUSE-HINDS TYPE FS OR FD CONDUITS, BOXES SHALL HAVE METAL COVERS TO ACCOMMODATE THE DEVICES INDICATED.
- EACH BRANCH CIRCUIT AND FEEDER SHALL BE PROVIDED WITH A GROUND CONDUCTOR INSTALLED WITH THE CIRCUIT CONDUCTORS. EACH GROUND CONDUCTOR SHALL BE GREEN INSULATED BOPPER CONDUCTOR, SIZED IN ACCORDANCE WITH TABLE 250.122 OF THE NATIONAL ELECTRICAL CODE NFPA 70. THESE GROUNDING CONDUCTORS ARE NOT SHOWN ON THE DRAWINGS.
- AFTER COMPLETION OF BRANCH CIRCUIT WORK, NEW CORRECTED TYPEWRITTEN DIRECTIONS SHALL BE PROVIDED IN PANEL BOARDS AND LOAD CENTERS SERVING THE AREA.
- ELECTRICAL CONTRACTOR SHALL INSTALL POWER WIRING REQUIRED FOR MECHANICAL SYSTEMS. CONTROL WIRING SHALL BE BY MECHANICAL CONTRACTOR.
- CONNECTION TO MOTORS SHALL BE MADE WITH A SHORT PIECE OF FLEXIBLE METAL CONDUIT BETWEEN RIGID CONDUIT SYSTEM AND MOTOR TERMINAL BOX.
- PROVIDE BONDING AROUND CONCENTRIC AND ECCENTRIC KNOCKOUTS ON EQUIPMENT.
- PROVIDE ADDITIONAL BOXES IN RACEWAYS AS NECESSARY, LOCATIONS SHALL MEET NFPA 70.

Rating or Setting of Automatic Overcurrent Device in Circuit Ahead of Equipment, Conduit, etc., Not Exceeding (Amperes)	SIZE (AWG or kcmil)	
	Copper	Aluminum or Copper-Clad Aluminum*
15	14	12
20	12	10
30	10	8
40	10	8
60	10	8
100	8	6
200	6	4
300	4	2
400	3	1
500	2	1/0
600	1	2/0
800	1/0	3/0
1000	2/0	4/0
1200	3/0	250
1600	4/0	350
2000	250	400
2500	350	600
3000	400	600
4000	500	800
5000	700	1200
6000	800	1200

NOTE: Where necessary to comply with 250.4(A)(5) or (B)(4), the equipment grounding conductor shall be sized larger than given in this table.
*See installation restrictions in 250.120.

BREAKER SIZE	WIRE SIZE
15 AMP	#14
20 AMP	#12
30 AMP	#10
40 AMP	#8
50 AMP	#6
*60 AMP	#6
70 AMP	#4
100 AMP	#2
125 AMP	#1/0
150 AMP	#2/0
200 AMP	#3/0

Based on copper THHN wire
-Increase one size when using aluminum conductors
75°C

LIGHT FIXTURE SCHEDULE	
F-1	EXISTING WALL MOUNTED "EXIT" 90 MINUTE BATTERY BACK-UP FIXTURE TO REMAIN- 120V.
F-2	EXISTING COMBO "EXIT/ EMERGENCY" 90 MINUTE BATTERY BACK-UP FIXTURE TO REMAIN- 120V.
F-3	NEW LED COMBO "EXIT/ EMERGENCY" FIXTURE WITH 90 MINUTE BACK-UP EMERGENCY FIXTURE- 120V.
F-3A	NEW 90 MINUTE BATTERY BACK-UP LED "EXIT" LIGHT CEILING MOUNTED.
F-4	EXISTING DUAL HEAD BATTERY BACK-UP 90 MINUTE EMERGENCY FIXTURE TO REMAIN- 120V.
F-5	NEW DUAL HEAD LED "EMERGENCY" FIXTURE WITH 90 MINUTE BACK-UP BATTERY - 120V.
F-6	NEW LAY-IN TROFFER 2X2 LED WITH PRISMATIC LENS, 120V, 3500K, 2000 LUMENS, WHITE STEEL FRAME.
F-7	NEW LAY-IN LED TROFFER 2X4 WITH PRISMATIC LENS, 120V, 3500K, 3000 LUMENS, WHITE STEEL FRAME.
F-8	4" DIAMETER LED RECESSED CAN LIGHT WITH WHITE BAFFLES AND WHITE TRIM. PROVIDE WITH IC HOUSING, 3000K, 90 CRI, 570 LUMENS.
F-9	6" DIAMETER LED RECESSED CAN LIGHT WITH WHITE BAFFLES AND WHITE TRIM. PROVIDE WITH IC HOUSING, 3000K, 90 CRI, 600 LUMENS.
F-10	EXISTING PENDENT LED LIGHTS AT NEW WAITING AREA RELOCATED TO NEW LOCATIONS.

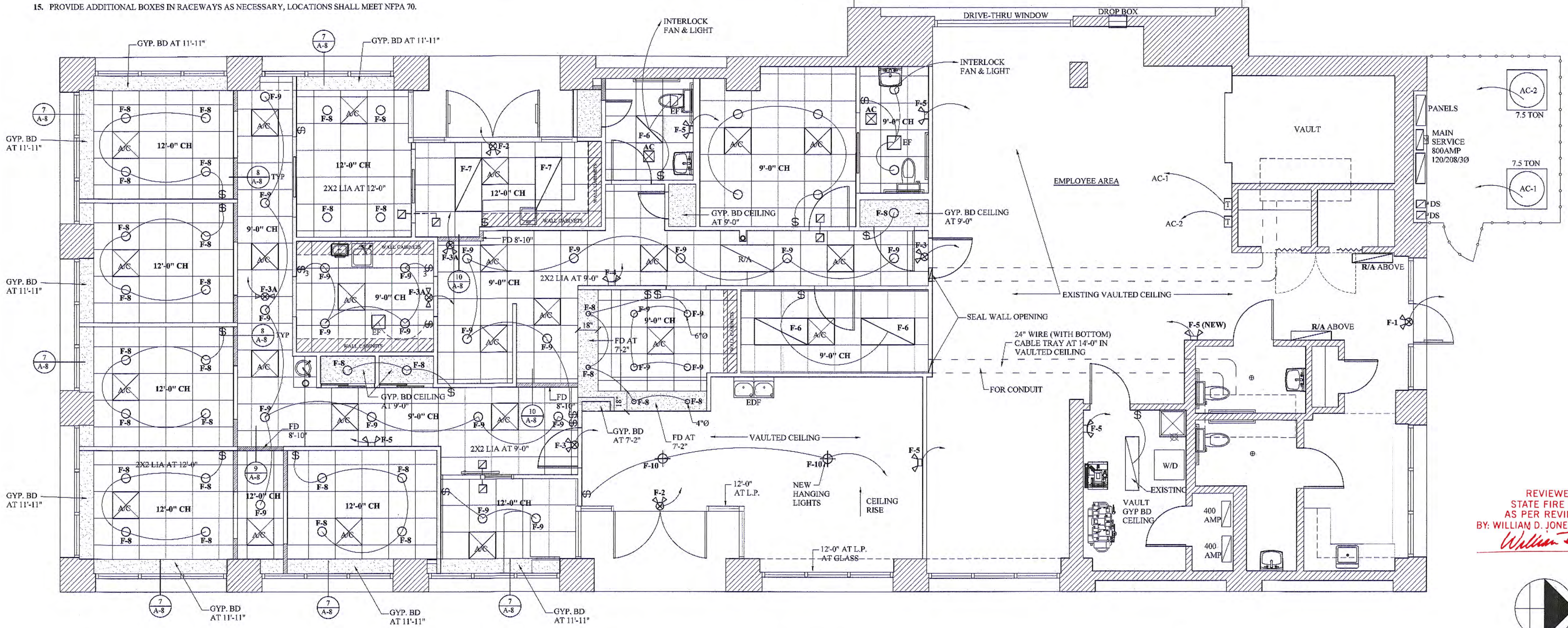

REVIEWED FOR STATE FIRE MARSHAL AS PER REVIEW LETTER BY: WILLIAM D. JONES, ARCHITECT, CBO
William D. Jones

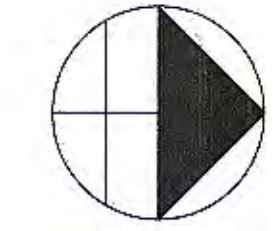

REFLECTIVE CEILING/ LIGHTING PLAN- NEW WORK

SCALE: 1/4" = 1'-0"

A-12

THESE DESIGN AND CONSTRUCTION DOCUMENTS AT THE SOLE PROPERTY OF JOSEPH F. SCHNEIDER, JR. AIA, ARCHITECT. NO USE OR REPRODUCTION OF THESE DOCUMENTS OR PARTIAL USE OR PARTIAL REPRODUCTION IS ALLOWED. NO USE OF THESE DRAWINGS WITHOUT THE WRITTEN EXPRESSED PERMISSION OF JOSEPH F. SCHNEIDER, JR. ARCHITECT IS ALLOWED.

REVISIONS	BY



INTERIOR RENOVATIONS
LEVEL-2 (LESS THEN 50%)
DR. PAMELA DAIGLE, DDS
2130 GAUSE BLVD WEST
SLIDELL, LOUISIANA 70460

JOSEPH F. SCHNEIDER JR., AIA
ARCHITECT
LA #4206 MS #3020 AL #8724 FL #AR95908 TX #24294
105 EVANGELINE DRIVE, SLIDELL, LOUISIANA 70460
(985) 847-0714
jfsarchitect@charter.net

DRAWN
H. SCHNEIDER
CHECKED
J. SCHNEIDER
DATE
06/07/2022
SCALE
AS NOTED
JOB NO.

SHEET
A-12
OF SHEETS

REVISIONS	BY



INTERIOR RENOVATIONS
LEVEL-2 (LESS THEN 50%)
DR. PAMELA DAIGLE, DDS
2130 GAUSE BLVD WEST
SLIDELL, LOUISIANA 70460

JOSEPH F. SCHNEIDER JR., AIA
ARCHITECT
L.A. #4206 MS #3020 AL #8724 FL #AR95908 TX #24294
105 EVANGELINE DRIVE, SLIDELL, LOUISIANA 70460
(985) 847-0714
jfsarchitect@charter.net

DRAWN
H. SCHNEIDER
CHECKED
J. SCHNEIDER
DATE
06/07/2022
SCALE
AS NOTED
JOB NO.
SHEET
A-13
OF SHEETS

ELECTRICAL SYMBOLS

SW	WALL SWITCH
SW3	3-WAY WALL SYSTEM
SWD	DIMMER SWITCH
WR	DUPLEX WALL RECEPTACLE
WRQ	QUAD WALL RECEPTACLE
WRGFI	WATERPROOF GFI WALL DUPLEX RECEPTACLE
WRIGFI	INTERIOR GROUND FAULT WALL RECEPTACLE
PHJ	PHONE JACK
DCW	DATA/ COMMUNICATION WALL BOX
CTV	CABLE/ TV
WL	WALL LIGHT
CL	CEILING LIGHT
CF	CEILING FAN/ LIGHT
CFAN	CEILING FAN
RF	2X4 RECESSED FLUORESCENT LIGHT
RC	RECESSED CAN LIGHT
PL	PENDENT LIGHT
DFL	DUAL SOFFIT MOUNTED EXTERIOR FLOOD LIGHTS
HV	HEAT-VENT-LIGHT
HVO	HEAT-VENT ONLY
SD	SMOKE DETECTOR
HD	HEAT DETECTOR
EEL	EXIT/ EMERGENCY LIGHT
EL	EMERGENCY LIGHT
M	MOTOR

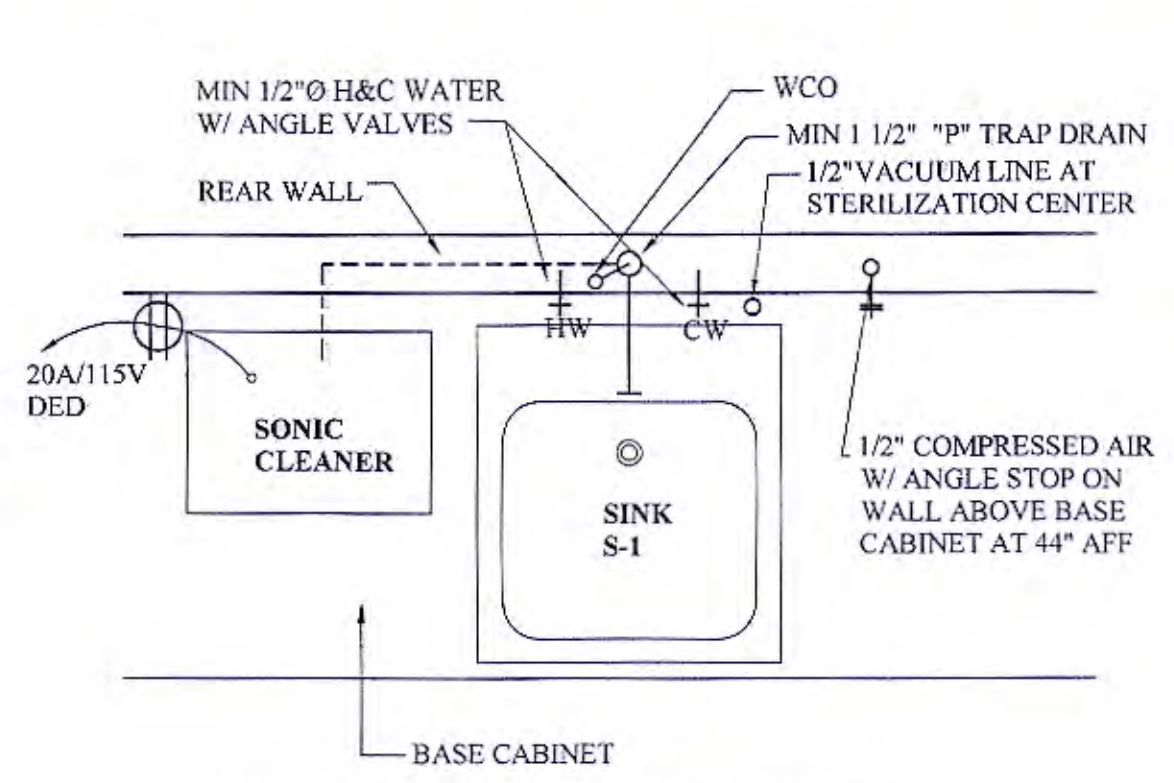

NOTE: PROVIDE 1/2" AIR LINE AT LAB ROOM
1. ADJACENT TO CABINET SINK
2. REFER TO ELECTRICAL PLAN FOR POWER REQUIREMENTS
3. REFER TO DENTAL SHOP DRAWINGS FOR UTILITIES

STERILIZATION CABINET- "SC"

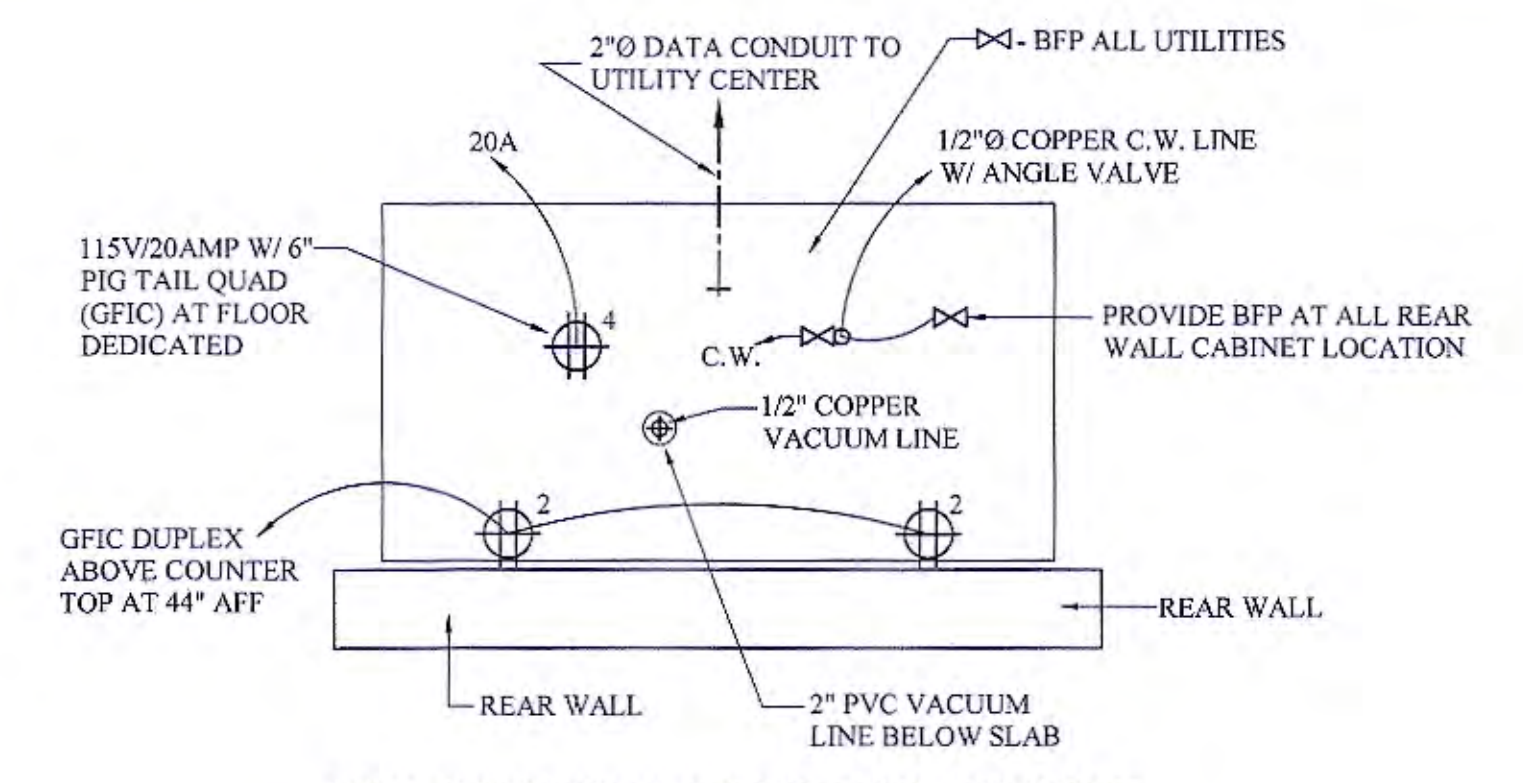

NOTE: PROVIDE BFP ALL UTILITIES AS REQUIRED BY CODE
REFER TO ELECTRICAL PLAN FOR POWER REQUIREMENTS
ABOVE CABINET TOP AT BACK WALL

TYPICAL REAR CABINET- "RC"

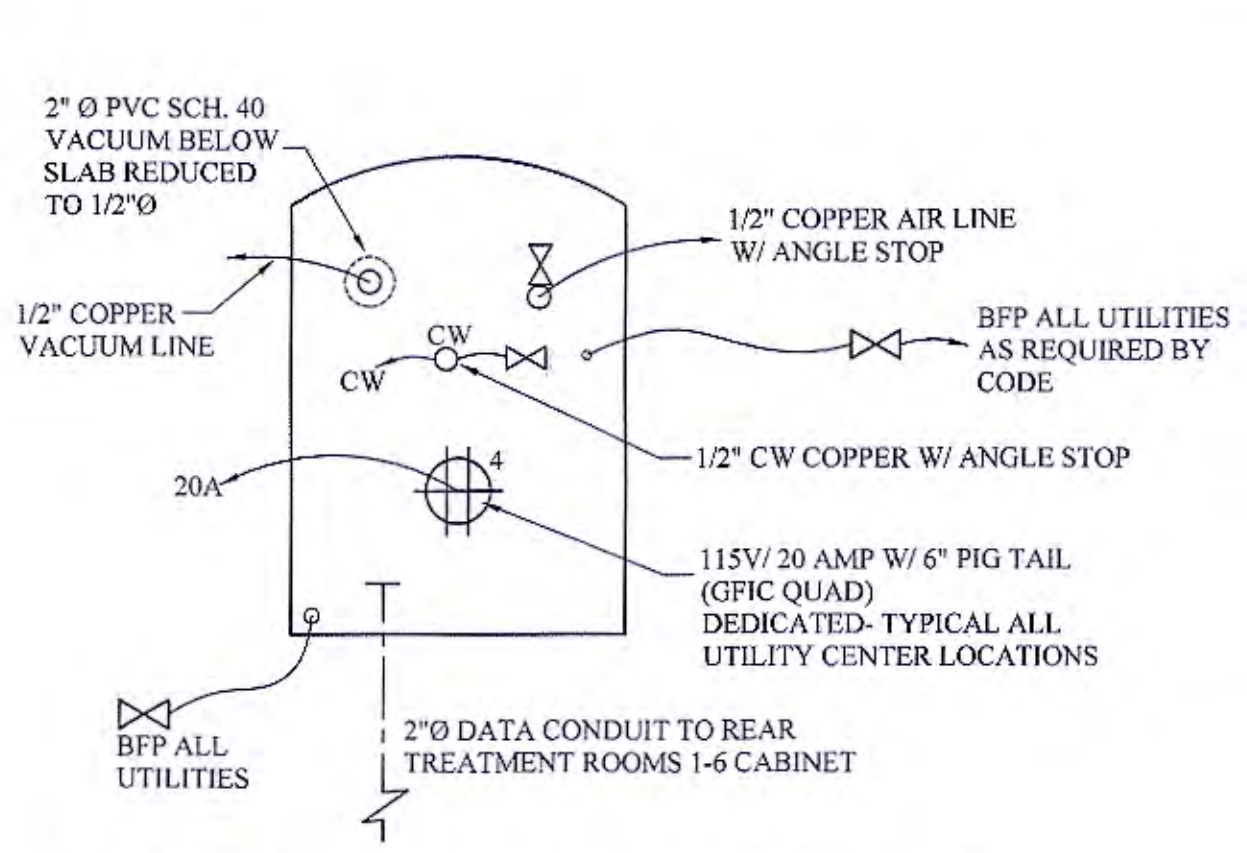

TYPICAL UTILITY CABINET- "UC"
(TREATMENT ROOMS 1-6)

GENERAL NOTES FOR CODES AND KAIC RATINGS:

- ALL ELECTRICAL WORK SHALL COMPLY WITH NEC 2011 EDITION.
- ALL ELECTRICAL MECHANICAL COMPONENTS SHALL BE INSTALLED AT ESTABLISHED BFE ELEVATIONS ESTABLISHED BY THE LOCAL GOVERNMENT JURISDICTION OF AUTHORITY.
- ALL ELECTRICAL DISTRIBUTION SYSTEM COMPONENTS SHALL BE RATED FOR FAULT AMPERAGE INTERRUPTING CAPACITY, OR KAIC RATING COMPLYING WITH NEC 2011 ARTICLES 110.9, 110.10, 225.52(B), 230.208, 240.12, AND 240.92 (C)(1). ALL PANELS AND SUB-PANELS SHALL BE MARKED AS REQUIRED BY NEC 2011, ARTICLE 110.24A. ELECTRICAL CONTRACTOR SHALL VERIFY WITH THE LOCAL UTILITY COMPANY THE EXISTING FULL LOAD CURRENT ENTERING THE NEW MAIN SERVICE FOR DETERMINATION OF THE REQUIRED KAIC RATING OF THE MAIN AND SECONDARY PANELS.

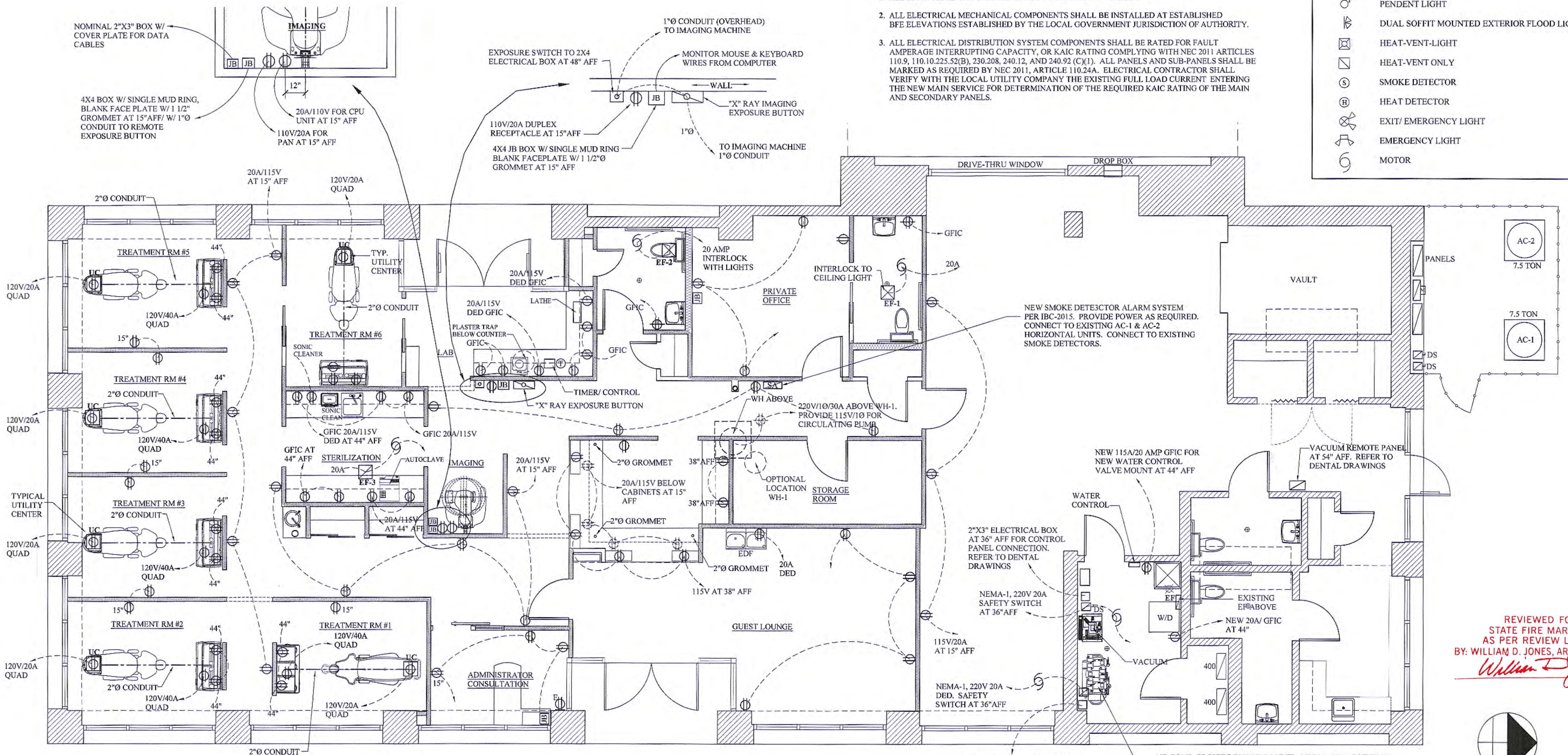

REVIEWED FOR
STATE FIRE MARSHAL
AS PER REVIEW LETTER
BY: WILLIAM D. JONES, ARCHITECT, CBO
William D. Jones

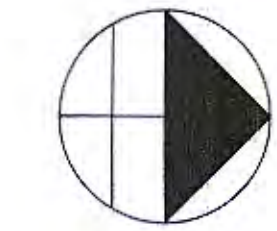

POWER PLAN - NEW WORK

SCALE: 1/4" = 1'-0"

A-13

THESE DESIGN AND CONSTRUCTION DOCUMENTS AT THE SOLE PROPERTY OF JOSEPH F. SCHNEIDER, JR. AIA, ARCHITECT. NO USE OR REPRODUCTION OF THESE DOCUMENTS OR PARTIAL USE OR PARTIAL REPRODUCTION IS ALLOWED. NO USE OF THESE DRAWINGS WITHOUT THE WRITTEN EXPRESSED PERMISSION OF JOSEPH F. SCHNEIDER, JR. ARCHITECT IS ALLOWED.