



Medical Air Solutions, Inc.

Marietta, GA 30068, 800-645-1059, Fax 770-977-9964

Technology & Service

MAS Project: P-10-30-12

for

Our Lady of the Lake Regional Medical Center
Medical Oncology LLC Building

Client: 8119 Picardy Avenue

Baton Rouge, LA 70809

Pharmacy Compounding Area Upgrade

Project Document Date: December 27, 2012

Project Participants

Project Coordinator

Mr. Chuck Dammon

Dammon A&E, Slidell, LA

(985) 649-5832

Medical Air Solutions, Inc.

Design/Supplier

Mr. Bob Wiltbank, V. P.

(770) 377-3884 Cell

(770) 977-1407 (Corporate)

(800) 645-1059 (Toll Free)

General Contractor (GC)

ARC Mechanical Ctrs., Slidell, LA

Mechanical Contractor

TBD by GC

Electrical Contractor

TBD by GC

Other Contractors

TBD by GC

Revised drawing as requested by Mark Sybrandt

Medical Oncology Infusion Center

Proposed CSP Area Configuration

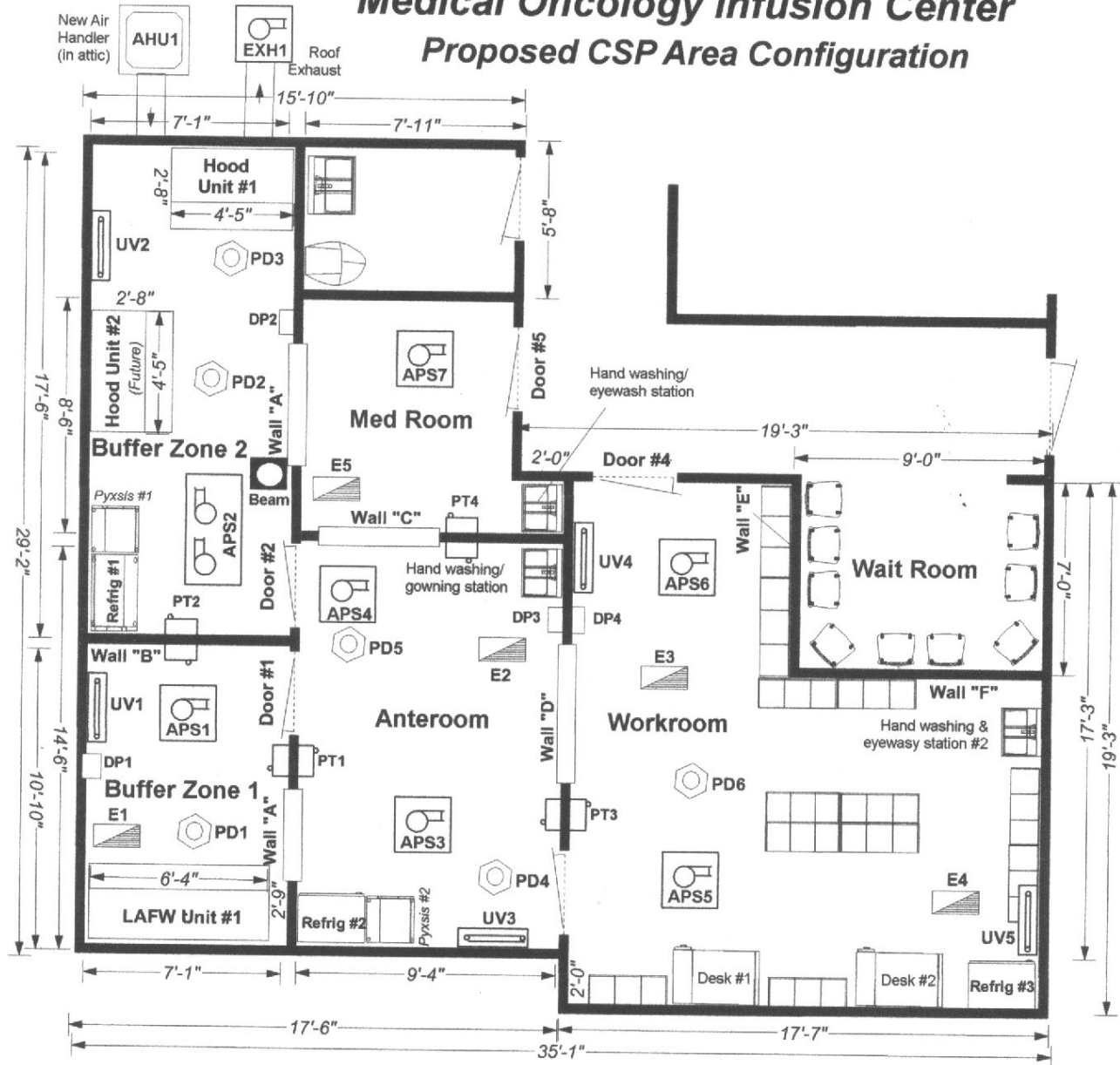

Legend

- Hood - Biological Safety Cabinet (BSC) provided by MAS
- LAFW - Laminar Airflow Workstation (LAFW) provided by MAS
- APS# - Air Purification Systems (APS) provided by MAS
- PT# - Pass-through (PT) provided by MAS
- DP# - Differential Pressure, Temperature & Relative Humidity (DP) monitor provided by MAS
- UV# - Ultraviolet Germicidal Irradiation (UVGI) wall mounted units provided by MAS
- PD# - Particle Detection Monitor - provided by MAS
- E# - Air Return Grill (E) - provided by ARC Mechanical
- Wall "X" - Walls (with windows) to be constructed by ARC Mechanical
- Door# - Automatic Swing Doors provided by MAS
- AHU - Air Handling Unit provided by MAS
- EXH - Exhaust Blower provided by MAS
- Refrig# - Professional Reach-in Refrigerators Provided by MAS
- Desk# - Computer Desks provided by MAS
- Pyxis# - Pyxis Units provided by Client
- Beam - Support for Beam provided by GC

Items Not Shown

- Ceiling - Sealed Ceiling System provided by MAS
- Lighting - Sealed lighting units
- PCs - Two (2) PCs for desks provided by Client (includes software)
- Carts - 304 SS tables provided by MAS
- Stools - 304 SS stools provided by MAS
- Walls - Fiberglass Reinforced PVC wall covering provided by MAS
- Racks - 304 SS wire rack storage units (on casters) provided by MAS
- Dryer - Hand Dryers for Anteroom hand washing provided by MAS

Medical Air Solutions, Inc.	
Drawing History	
Drawing P-10-30-12-1-2	Author
Original: 11/14/2012	RHW
Revised: 12/06/2012	RHW
Revised: 12/22/2012	RHW
Revised:	
Revised:	

Medical Oncology Infusion Center

Proposed CSP Area Configuration - Detailed Descriptions

Equipment, Instrument and Materials Notes

1. APS (7) - These air purification units are direct drive "green" air purification systems with the HEPA filter accessible from the room side of the unit. It has a "replace filter" indicator and a "lockout" key to disallow changes. It will "remember" its speed setting and return to speed if a power interruption occurs. Power to the unit is VAC 110/1/60 which is inverted to VDC to operate the unit's blower and is controlled by a wall mounted controller.
2. DP = Room Pressure Monitors (4) - These measure the differential pressure between the rooms in the CSP Area. They will also monitor the temperature and humidity via a sensor unit installed in the ceiling. They are fully programmable and will communicate with a BAS (Building Automation System) via the BACnet communications protocol. They are flush wall mounted and shipped with a NEMA 4 enclosure to accept 110/1/60 power for a 24 VDC power supply.
3. UV Units (5) - Upper wall mounted ultraviolet units will eradicate or deactivate airborne pathogens. Lamp life is 9,000 hours (1 year of continuous use). These unit utilize 110/1/60 power.
4. Hood (1) - GermFree Biological Safety Cabinets to perform chemo compounding utilize 110/1/60 power and is four (4) feet wide. These units will exhaust to the outside via a common exhaust duct.
5. EXH1 - Exhaust blower to exhaust a minimum of 1,000 CFM from the chemo hood. Make and model to be determined.
6. AHU - Air Handler to supply conditioned air the the CSP Area. Model to be determined.
7. LAFW (1) - GermFree Laminar Airflow Workstation to perform IV compounding utilize 110/1/60 power and is six (6) feet wide.
8. Partical Counters (6) - Individual Particle Counters that sample 0.1 feet/minute that are ceiling mounted. The communication hardware and software are included. Also included is an instrument for testing and calibration. Power is 110/1/60 to a NEMA 4 enclosure to be terminated to a 24 VDC power supply.
9. 304 SS Furniture Supplied - (3) stools, (3) tables (on casters), (3) wall shelves and (3) wire rack storage units.
10. FRP Wall Covering - Fiberglass Reinforced PVC white wall covering for all rooms except the Med Room.
11. Doors (3 automatic) - Automatic swing doors require a eix (6) foot wall opening. There will a "hand pass sensor" to open these doors. Power is 110/1/60.
12. Sealed Ceiling System - The sealing will have a gasketed heavy duty grid with the gaskets on all sides of the grid. They will have "hold down" clips to prevent movement. This will be a 4' x 4' grid with cross tees for smaller panels as required.
13. Computer Desks - (2) computer desks for data entry. Assembly will required.
14. Pass-throughs - (4) pass-throughs with interlocking doors. (4) units 18" x 18" x 16".
15. Wash Stations - (3) 304 SS wash stations for the Anteroom, Workroom and Med Room. These are hands free wash stations.
16. Hand Dryers - (3) 304 SS wall mounted hand dryer requiring 110/1/60.

Buffer Zone 1	Buffer Zone 2	Anteroom	Workroom
Sealed Ceiling height = 8'-0" Hard Ceiling height = 11'-6" Total Room Area = 78 ft. ² Total Room Volume = 624 ft. ³ To obtain minimum 35 ACH: $\frac{624 \text{ ft.}^3 \times 35 \text{ ACH}}{60 \text{ Min./hr.}} = 100 \text{ CFM (Supply)}$ Positive offset of 300 CFM Offset air to be exhausted under access door.	Sealed Ceiling height = 8'-0" Hard Ceiling height = 11'-6" Total Room Area = 125 ft. ² Total Room Volume = 1,000 ft. ³ To obtain minimum 35 ACH: $\frac{1000 \text{ ft.}^3 \times 35 \text{ ACH}}{60 \text{ Min./hr.}} = 583 \text{ CFM (Exhaust)}$ Negative offset of 300 CFM. Offset air to be exhausted by Hood to OE1.	Sealed Ceiling height = 8'-0" Hard Ceiling height = 11'-6" Total Room Area = 135 ft. ² Total Room Volume = 1,080 ft. ³ To obtain minimum 15 ACH: $\frac{1080 \text{ ft.}^3 \times 15 \text{ ACH}}{60 \text{ Min./hr.}} = 270 \text{ CFM (Supply)}$ Positive offset of 200 CFM Offset air to be exhausted under access door.	Sealed Ceiling height = 8'-0" Hard Ceiling height = 11'-6" Total Room Area = 240 ft. ² Total Room Volume = 1,920 ft. ³ To obtain minimum 10 ACH: $\frac{1920 \text{ ft.}^3 \times 10 \text{ ACH}}{60 \text{ Min./hr.}} = 320 \text{ CFM (Supply)}$ Positive offset of 200 CFM Offset air to be exhausted under access door.

Med Room
Sealed Ceiling height = 8'-0" Hard Ceiling height = 11'-6" Total Room Area = 68 ft. ² Total Room Volume = 544 ft. ³ To obtain minimum 15 ACH: $\frac{544 \text{ ft.}^3 \times 15 \text{ ACH}}{60 \text{ Min./hr.}} = 54 \text{ CFM (Supply)}$ Positive offset of 200 CFM Offset air to be exhausted under access door.

See Table 1 of the detailed proposal for actual CFM requirements.

Medical Air Solutions, Inc.	
Drawing History	
Drawing P-10-30-12-1-3	Author
Original: 11/10/2012	RHW
Revised: 12/22/2012	RHW
Revised:	
Revised:	
Revised:	